

All affected land now being reclaimed.

Coal Creek Resources
Schmidt Construction Co.
permit: M-1988-044
Arapahoe County

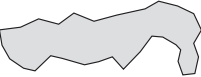
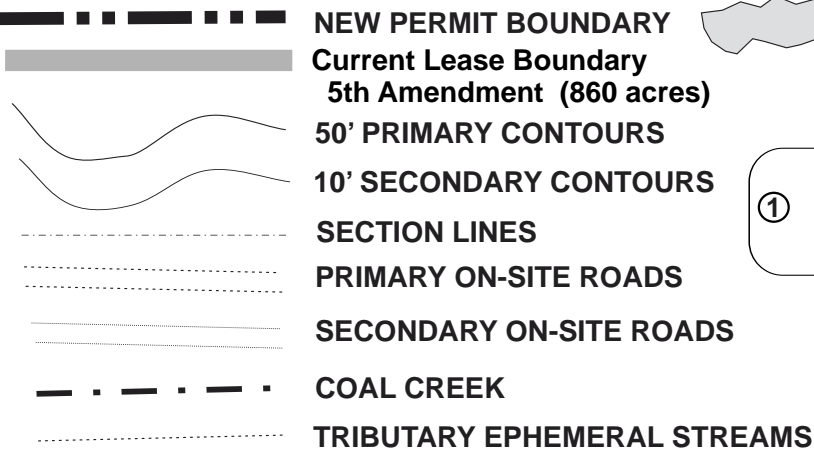

2002 FORESTED (RIPARIAN) LANDS

● OIL OR GAS WELL

① LAND BETWEEN MINING AREA AND ADJACENT POWER LINE AND WATER LINE: CURRENTLY NOT APPROVED FOR USE
SEE "VERY IMPORTANT NOTE" ON PAGE 7 OF EXHIBIT D.

