

HARD ROCK / METAL MINING
LIMITED IMPACT OPERATION (110(2))
RECLAMATION PERMIT CO DRMS M-2018-036

Ten Percenter Claim (CMC254209)
BLM CMC254209
USFS File Code 2810
USFS 2810-021210-MPO 2018-004

Annual Report – Supplemental Information

The Ten Percenter Claim is a valid, active unpatented lode mining claim located in the NE4NW4 and NW4NE4 Section 02, T12S, R71W, 6th Prime Meridian, Teller County, Colorado in the Pike National Forest on federal lands administered by the US Forest Service as described below:

CMC Serial Number	Claim Name	Meridian	Township	Range	Section	Aliquot Part	Teller County Document
CMC 254209	TEN PERCENTER	6 th P. M.	12 South	71 West	02	NE ⁴ & NW ⁴	579722

The North Side Center 4 x 4" wooden claim post is located at the government brass cap marking the North Quarter Section Corner for Section 02, T12S, R71W, 6th P.M.

The claim is in good standing and the BLM annual maintenance fee paid for the 2019 - 2020 assessment year.

The current entrance to the claim is located at: 474,173 E, 4,321,100 N, UTM NAD 27 (CONUS), Zone 13 S.

Total Proposed "Affected Area" is 396,400 square feet or 9.100 Acres. All 2017 Disturbance (now "Monitored Reclamation") is entirely within Proposed Affected Area.

There is substantial existing disturbance at areas 4.10 Upper, 4.20 Middle, and 4.30 Lower. This existing disturbance, consisting of two track roads, hand dug pits and partially reclaimed bulldozer excavations, may be re-excavated then later reclaimed. In 2019, most of the old, existing disturbance (pre-2000) in the Upper Area was reclaimed along with all work disturbance created in 2019. The existing disturbance reclaimed as part of 2019 operations included the old "Upper Cut" and associated dump and trenching. This reclamation totaled approximately 0.19 acres (8,350 square feet).

Location Maps and photos of 2019 recontouring and seeding/raking are attached.

Location Maps

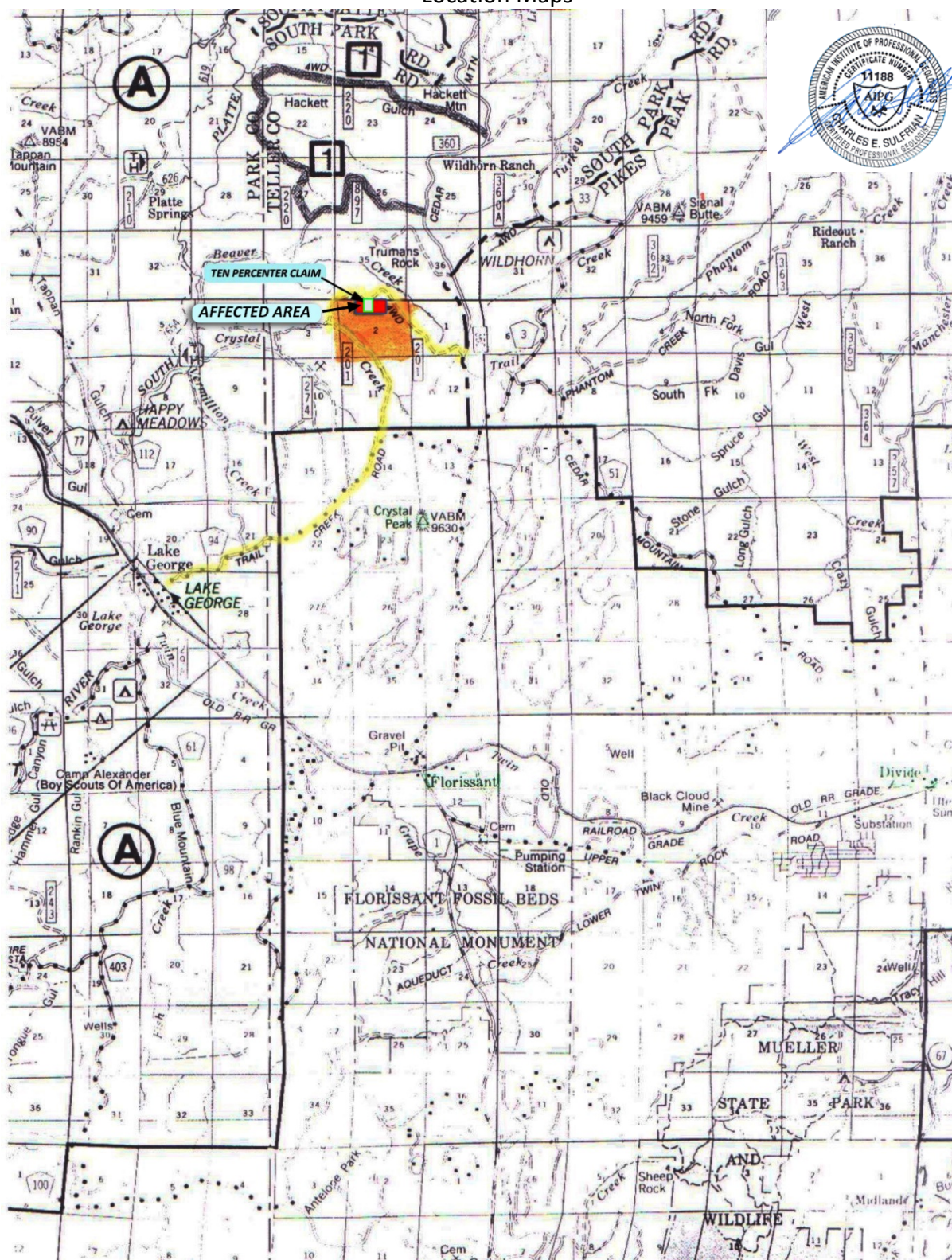

Area Location Map

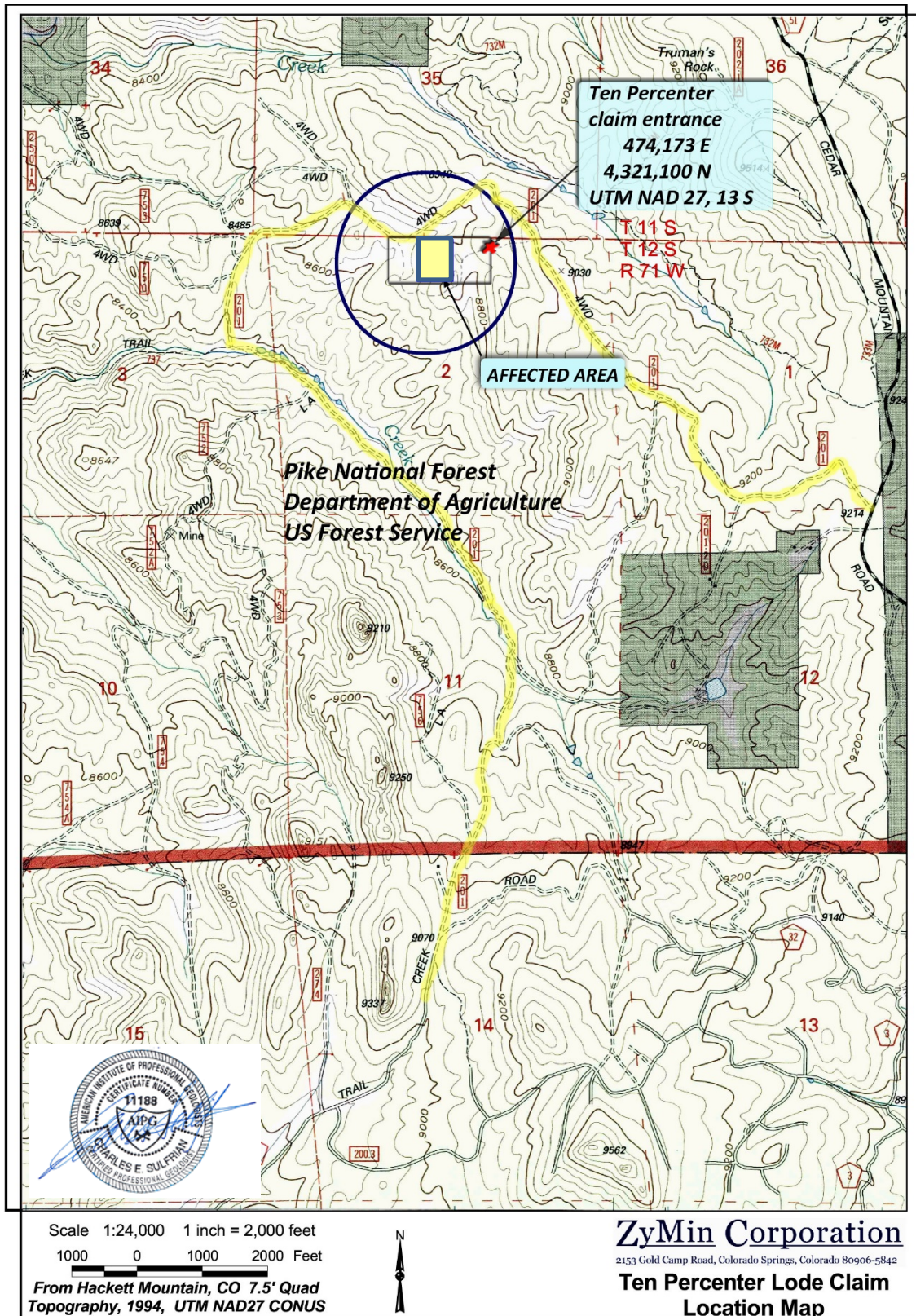

Claim Location Map showing Affected Area

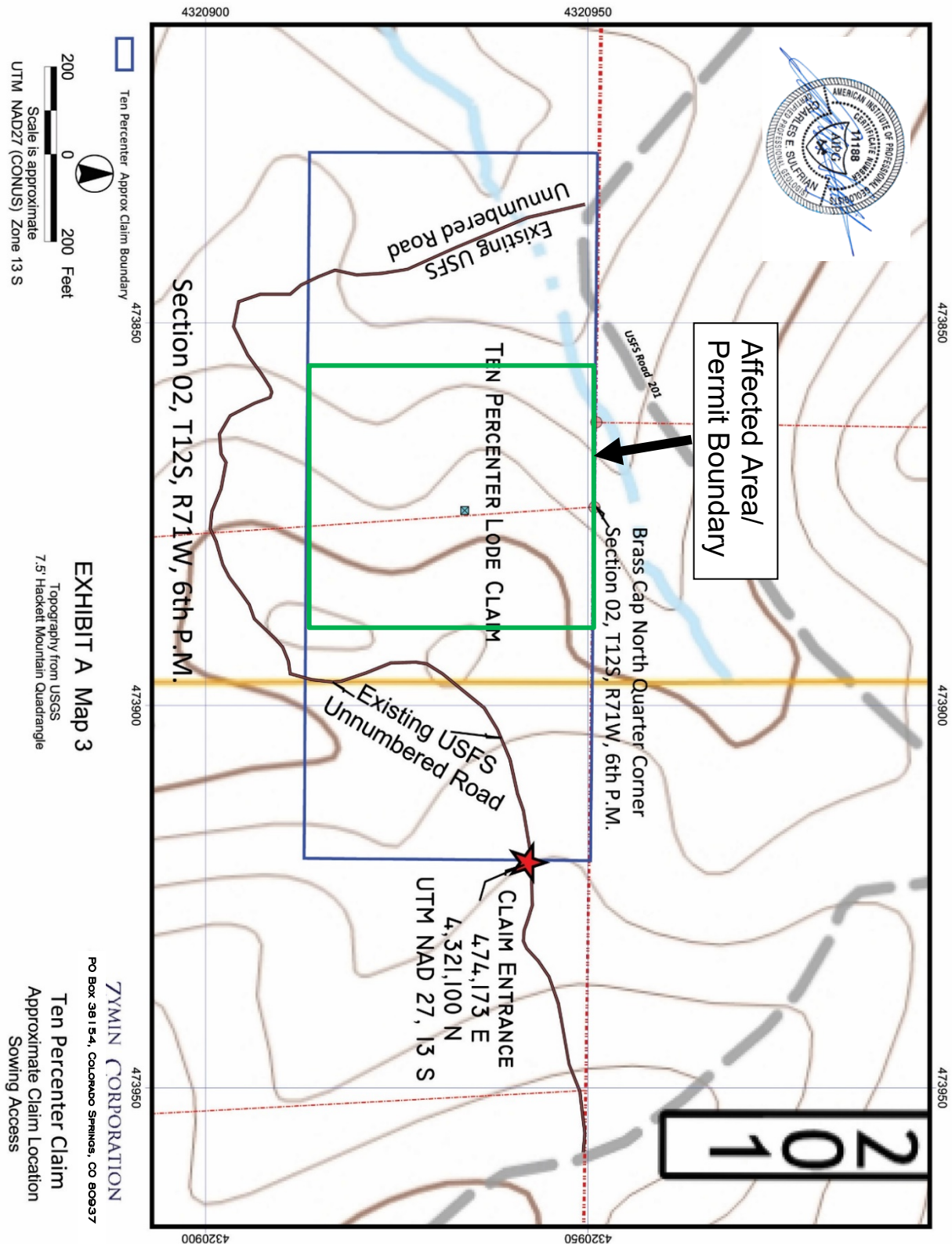

Claim Map showing Affected/Permit Area

Photos from October 2019

