

RECEIVED
11/20/01

NOTE: This map was prepared by ROCKY MOUNTAIN CONSULTANTS, INC. in cooperation with AGGREGATE INDUSTRIES, INC. The EXACT CONTOURING OF THE MINING AREAS AND RECLAIMED FIELDS MAY CHANGE TO RESPOND TO FIELD CONDITIONS. AGGREGATE INDUSTRIES - INC. WILL KEEP THE DIVISION OF MINERALS AND GEOLOGY INFORMED OF ANY CHANGES THROUGH ANNUAL REPORTS AND FILE TECHNICAL REVISIONS AND AMENDED APPLICATIONS AS NECESSARY THROUGHOUT THE LIFE OF THE MINE.

Donna Shible
Donna Shible
ROCKY MOUNTAIN CONSULTANTS, INC.
DATE: 11/20/01

- NOTE:
1. WETLAND INFORMATION FROM SAVANNAH SAVANNAH WETLAND DELINEATION APPROVED ACTION BY THE U.S. ARMY CORPS OF ENGINEERS.
 2. THE MINING FLOOD CONTOURS ARE FOR ILLUSTRATION ONLY. AGGREGATE INDUSTRIES WILL MINE AT 1:1 MINIMUM SLOPE TO THE BOTTOM OF THE RECLAMATION.
 3. AGGREGATE INDUSTRIES WILL DETEST THROUGHOUT MINE RECLAMATION WITHIN 200' OF ANY STRUCTURE NOT INCLUDED IN THE STABILITY ANALYSIS.
 4. THERE SHALL BE A MINIMUM 100' MINING SETBACK ON ONE SIDE OF ANY EXISTING GAS WELLS AND A MINIMUM 20' SETBACK ON THE REMAINING SIDE.
 5. THERE SHALL BE A MINIMUM MINING SETBACK OF 30 FEET FROM GAS LINES.
 6. THE MINING RIGHTS CHARGES AND LESSEES SHALL HAVE 24 HOUR ACCESS TO THEIR OIL AND GAS FACILITIES.
 7. AGGREGATE INDUSTRIES - INC. SHALL LIMIT DRAINAGE OVER FLOOD LINES.

FLOOD HAZARD LEGEND:

ZONE A 100 YR FLOOD AREAS, NO BASE ELEVATIONS DETERMINED.

ZONE C AREAS OF MINIMAL FLOODING.

FLOOD HAZARD INFORMATION:

FLOODPLAIN INFORMATION IS FROM FIRM FLOOD INSURANCE RATE MAP, MAP NO. 02-02-00-01, DATED SEPT. 28, 1992.

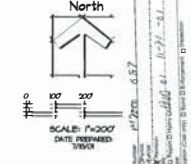

- LEGEND:
- PERMIT BOUNDARY
 - 100 YEAR FLOODPLAIN
 - EXISTING DITCH
 - EXISTING CONTOURS
 - EXISTING OVERHEAD POWER
 - EXISTING RAILROAD
 - EXISTING GAS LINE
 - EXISTING FENCE
 - EXISTING TREE
 - EXISTING STRUCTURES
 - LIMITS OF MINING AREAS
 - MINING SEQUENCE
 - ON-SITE HAIL ROAD
 - PROPOSED ACCESS
 - SLOSH WALL
 - WATER WELL WITH WELL ID & QUANTITY
 - PROPOSED PIEZOMETER
 - RAILROAD ROW
 - JURISDICTIONAL WETLANDS
 - WATER/SEDIMENTARY WETLANDS

ANNUAL REPORT MAP-2
JANUARY 12, 2020
NO DISTURBANCES TO DATE AND NONE PROJECTED DURING COMING YEAR.

ROCKY MOUNTAIN CONSULTANTS, INC.
830 DELAWARE AVE., SUITE 500, LOVELAND, CO 80501
(303) 778-0888 FAX (303) 778-0889

REVISIONS

NO.	DESCRIPTION	DATE BY
1	DATE PREPARED	11/20/01
2	DATE PREPARED	11/20/01
3	DATE PREPARED	11/20/01

AMENDMENT TO MLRB 112 PERMIT #M-2000-087
MILLIKEN RESOURCE MINING PLAN
AGGREGATE INDUSTRIES - INC.

PLOTTED: 11/14/01
DESIGNED BY: BB
DRAWN BY: SR
CHECKED BY: BB
JOB NUMBER:
80-3919.007.00
SHEET:
4 of 6