

McATEE CONSTRUCTION CO.

HARLEY PIT #1 - M-1986-147

ANNUAL REPORT 2018-19

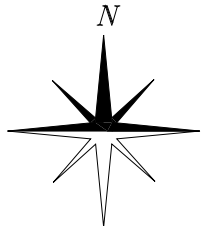
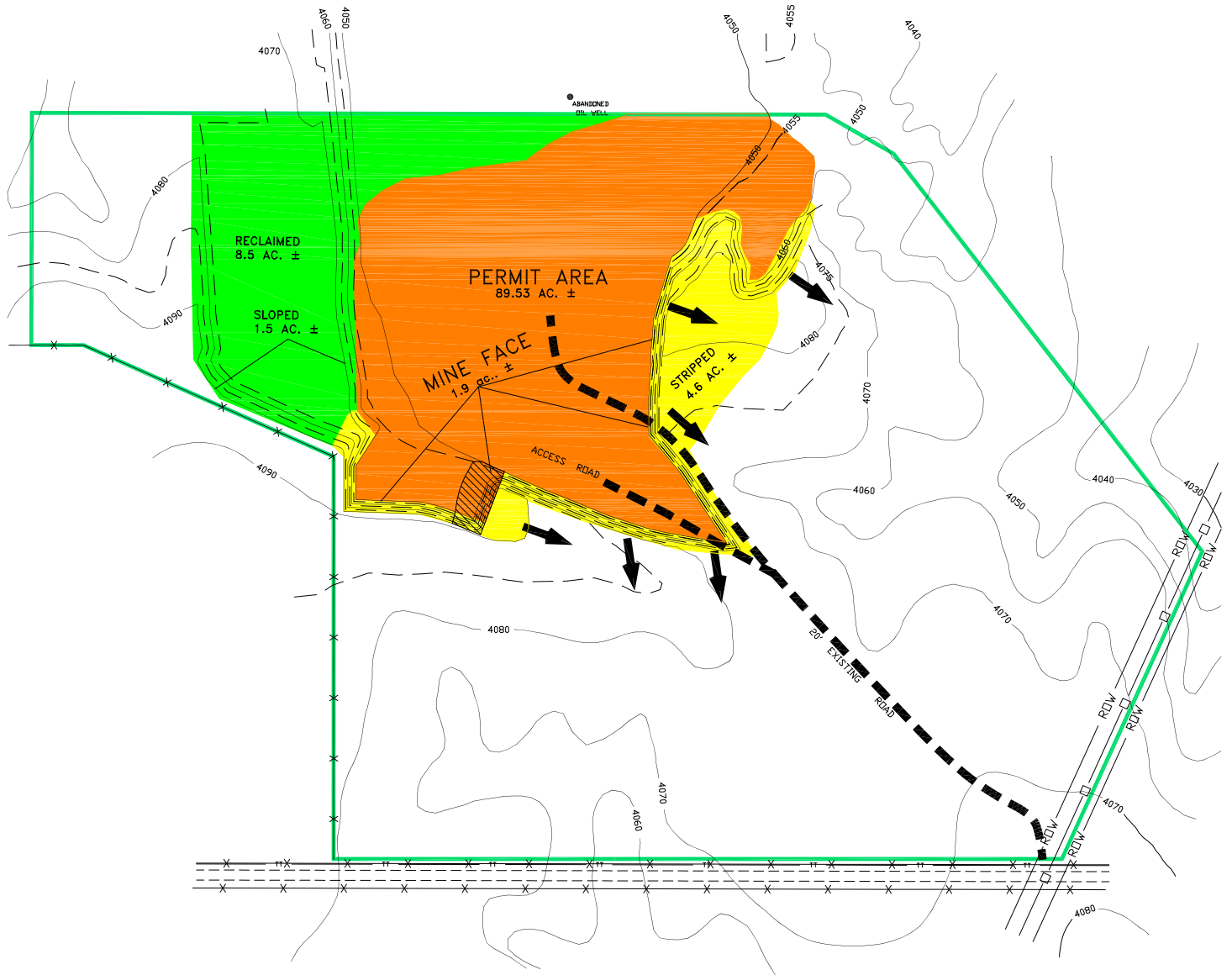

NOV 22, 2019 - 09:27:36

PREPARED BY: *ENVIRONMENT, INC.*
7985 VANCE DR., # 205A
ARVADA, CO 80003
(303) 423-7297



MINING DIRECTION



17.6 AC. ±



0.3 AC. ±



4.6 AC. ±



8.5 AC. ±

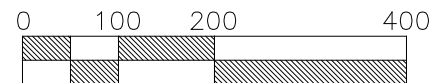

SCALE 1"=200'

LEGEND

- AFFECTED LANDS
- ROADS
- ABANDONED OIL WELL
- WINDMILL
- FENCE