

# LEGEND:

	ORIGINAL PERMIT BOUNDARY
	AMENDED PERMIT BOUNDARY
	PARCEL LINE
	MINING AREA/PIT BOUNDARY (ACTIVE)
	MATERIAL PROCESSING AREA
	TOPSOIL STOCKPILE
	PRODUCT STOCKPILE

## NOTES

- ON THE QUARRY SITE, THERE IS SPARSE EXISTING VEGETATION CONSISTING OF ANNUALS, SAGE AND A FEW HARDY GRASSES. NEARBY THE SITE EXISTING VEGETATION CONSISTS OF GREYTHS WHEATGRASS, BIG AND LITTLE BLUESTEM, BLUE GRAMA, SIDE OATS GRAMA GRASSES, MOUNTAIN MAHOGANY, PONDEROSA PINE AND SHRUBS.
- THE ACCESS ROAD GOES THROUGH THE OLD BERTHOUD PINK QUARRIES (SAME OWNER) TO ACCESS THIS AREA AND CONNECTS TO OLD ACCESS ROADS THAT HAVE BEEN THERE FOR OVER 50 YEARS. NO IMPROVEMENT OR WIDENING IS NECESSARY ON THE EXISTING ROAD BEDS. THIS ACCESS ROAD WILL REMAIN IN PLACE AFTER THE FINAL MINING AND RECLAMATION PROCESS IS COMPLETE.
- AFFECTED AREA LAND OWNER: J A M QUARRIES, LLC
- MINED SUBSTANCE OWNER: BLM
- THERE ARE NO SIGNIFICANT, VALUABLE OR PERMANENT MAN-MADE STRUCTURES WITHIN 200 FEET OF THE AFFECTED AREA.
- OVERBURDEN AND WASTE ROCK AREAS AREA WITHIN THE MINING AREA/PIT BOUNDARY.



DESIGNED BY: [Redacted]  
 DRAWN BY: [Redacted]

Sheet: 1 of 2

EXHIBIT: E



**MINING PLAN MAP**  
**SUNSET QUARRY**  
 APPLICANT: ARKINS PARK STONE, [Redacted]  
 LOCATED IN THE SE/4 OF SECTION 28, TOWNSHIP 4 NORTH, RANGE 70 WEST  
 OF THE 6TH P.M., COUNTY OF LARIMER, STATE OF COLORADO

Project: 2186.02  
 Drawing: SS-EPH  
 Drafted By: C.D.  
 Date Prep: 11/20/17  
 Checked By: LWC



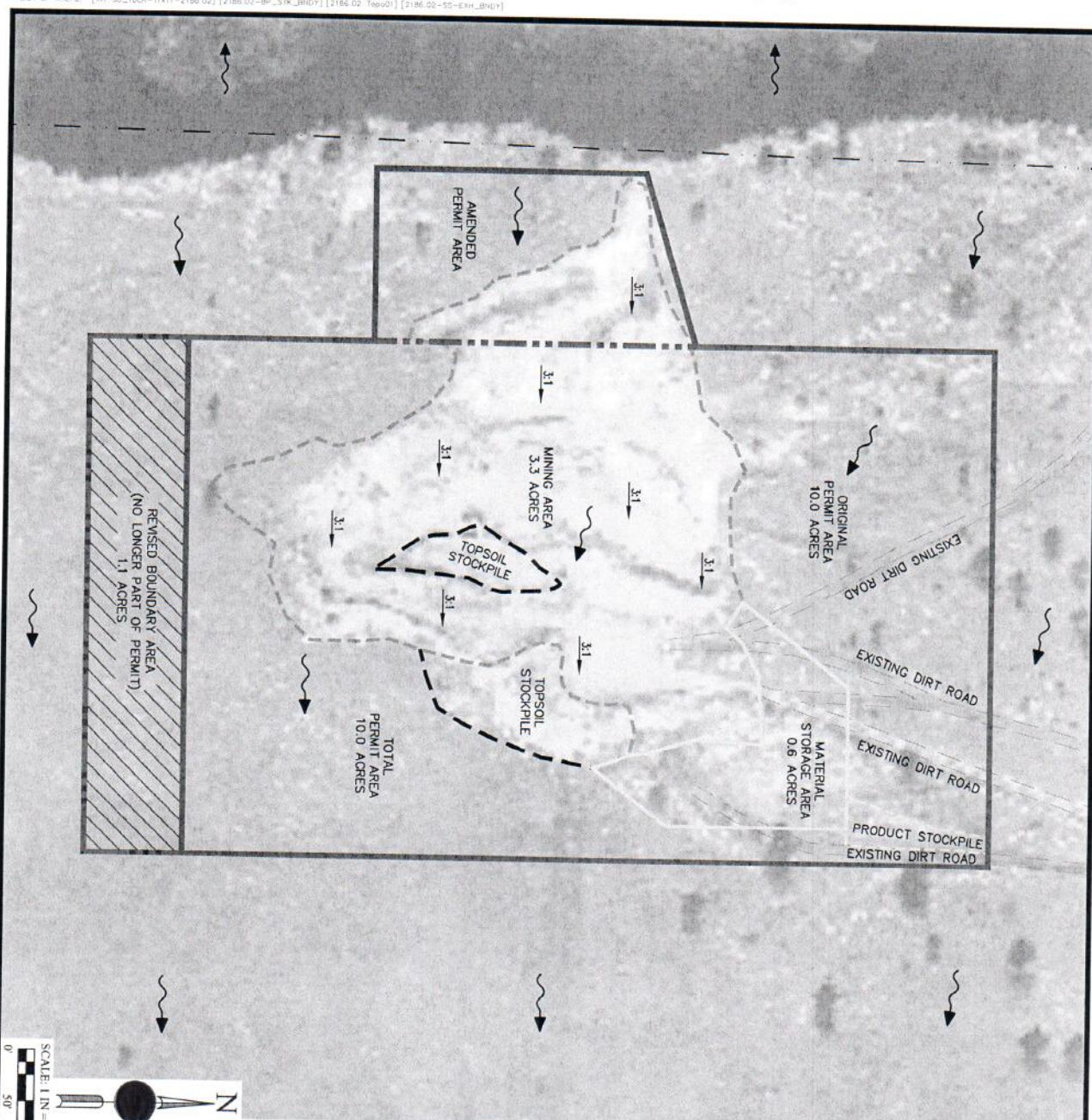

# LEGEND:

	ORIGINAL PERMIT BOUNDARY	10.0 ACRES
	AMENDED PERMIT BOUNDARY	10.0 ACRES
	PARCEL LINE	
	MINING AREA/PIT BOUNDARY (ACTIVE)	3.3 ACRES
	MATERIAL STORAGE AREA	0.6 ACRES
	REVISED BOUNDARY AREA	1.1 ACRES
	TOPSOIL STOCKPILE	0.5 ACRES
	PRODUCT STOCKPILE	0.1 ACRES

3:1  
FLOW ARROW  
TOPOGRAPHIC SLOPE

## AREA SUMMARY

ORIGINAL PERMIT AREA:	10.0 ACRES
AMENDED PERMIT AREA:	10.0 ACRES
TOTAL PERMIT AREA PROPOSED:	10.0 ACRES

## NOTES

- ON THE QUARRY SITE THERE IS SPARSE EXISTING VEGETATION CONSISTING OF ANNUALS, SAGE AND A FEW HARDY GRASSES. NEARBY THE SITE EXISTING VEGETATION CONSISTS OF GREYHORN WHEATGRASS, BIG AND LITTLE BLUESTEM, BLUE GRAMA, SIDE OATS GRAMA GRASSES, MOUNTAIN MAHOGANY, PONDROSA PINE AND SHRUBS.
- THE ACCESS ROAD GOES THROUGH THE OLD BERTHOUD PINK QUARRIES (SAME OWNER) TO ACCESS THIS AREA AND CONNECTS TO OLD ACCESS ROADS THAT HAVE BEEN EXISTING FOR OVER 50 YEARS. NO IMPROVEMENT OR WIDENING IS NECESSARY ON THE EXISTING ROAD BEDS. THIS ACCESS ROAD WILL REMAIN IN PLACE AFTER THE FINAL MINING AND RECLAMATION PROCESS IS COMPLETE.
- STRIPPED TOPSOIL AND CRUSHER FINES TAKEN FROM THE ACTIVE WORKING DECKS WILL BE STORED IN THE DESIGNATED AREA UNTIL IT IS NEEDED FOR RECLAMATION. IT WILL BE PROTECTED WITH "J" DAMS AROUND THE PERIMETER. IF THE TOPSOIL IS NOT NEEDED FOR RECLAMATION WITHIN A YEAR OF ITS PLACEMENT, IT WILL BE RE-SEEDING WITH THE APPROVED "HIGH PLAINS/TOOTHILLS GRASS MIX" TO HELP PREVENT EROSION.
- OVERBURDEN AND WASTE ROCK AREAS WITHIN THE MINING AREA/PIT BOUNDARY.
- RECLAIMED AREAS WILL BE GRADED TO SUBSTANTIALLY MATCH TOPOGRAPHY PRIOR TO MINING AND BE TO EXISTING GRADE AT EDGES.
- THE AVERAGE THICKNESS OF REPLACED OVERBURDEN BY RECLAMATION AREA OR PHASE IS 2 INCHES.
- THE AVERAGE THICKNESS OF REPLACED TOPSOIL BY RECLAMATION AREA OR PHASE IS 2 INCHES.
- EXISTING SLOPES SHOWN ARE APPROXIMATE.

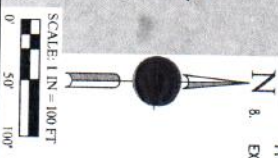

## RECLAMATION PLAN MAP SUNSET QUARRY

APPLICANT: ARKINS PARK STONE, NEWBY, COLORADO  
 LOCATED IN THE SE/4 OF SECTION 28, TOWNSHIP 4 NORTH, RANGE 70 WEST  
 OF THE 6TH P.M., COUNTY OF LARIMER, STATE OF COLORADO

EXHIBIT  
E