

2018-2019

Current Mining Area.

Hogue River Pit, 62.7 Acres

LR & WC Sandelin

Notes:
Railway R-O-W follows fence line
Location of HW, RL, SH, P, R, Berm, BT Ditches, and Product Stockpiles are approximate.
Rail Line R-O-W Union Pacific
Excess Overburden and mine wastel will be used for reclamation of the Bettger Pit.
Not shown in the expansion area are two abandoned irrigation ditches crossing the area from east to west.
Mining setback from the permit boundary in the expansion area will be up to 75 ft. in the area of the new BT, 10 ft along the west side of the pit and 60 ft. from the Yampa River bank or 10 ft. from the south permit boundary, which ever is greater.
Fence along railway R-O-W owned by Union Pacific
Fence on the west end of the Hogue River Pit owned by Duckels Const. Co.
Trailer and out building at the northeast corner of the existing Hogue River Pit on Duska Family property addressed in the original Hogue River Pit application

Operations Access

N4485092
E13 336994 NAD 83

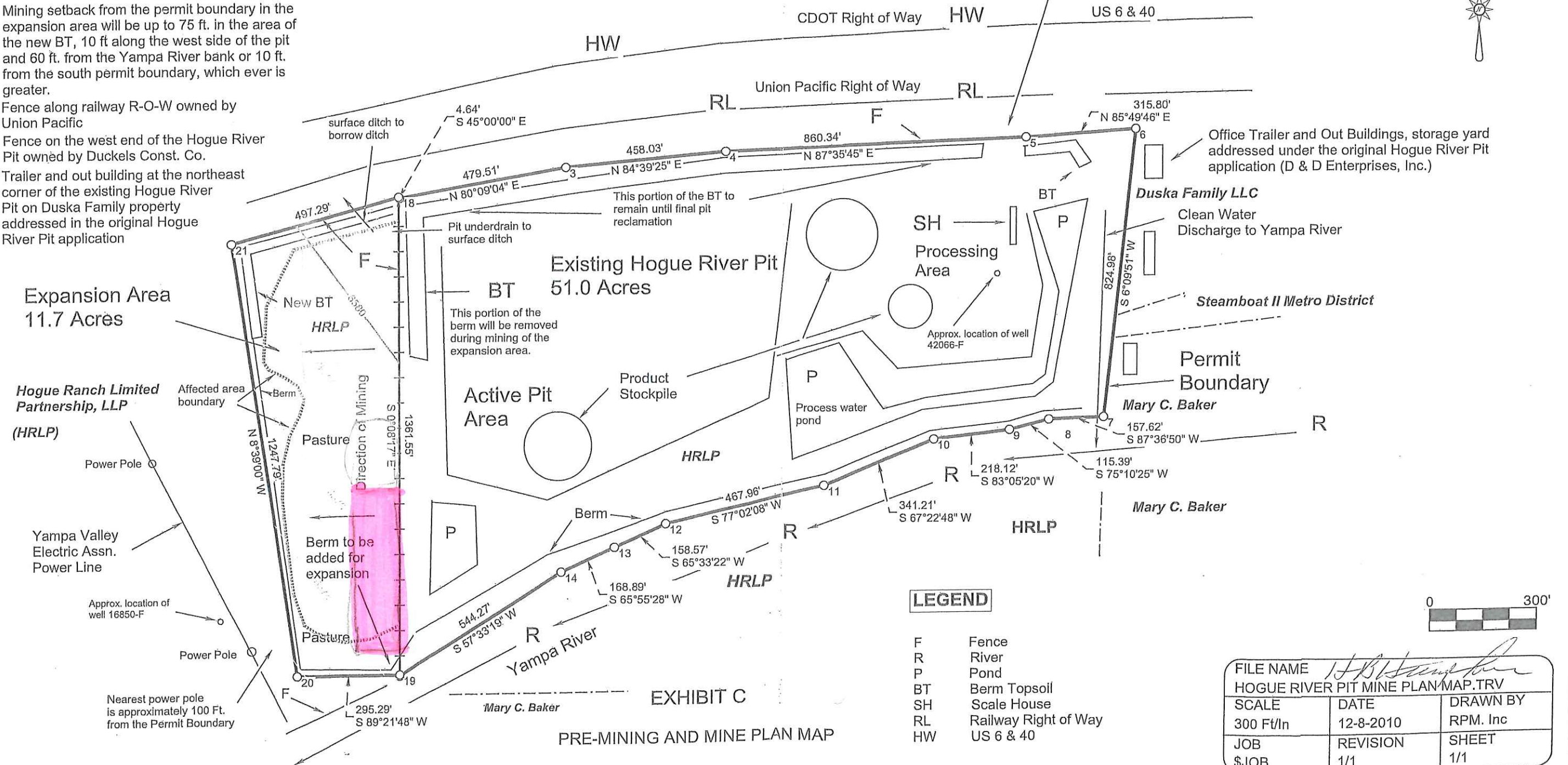

LEGEND

- F Fence
- R River
- P Pond
- BT Berm Topsoil
- SH Scale House
- RL Railway Right of Way
- HW US 6 & 40



FILE NAME <i>HBSandelin</i>		
HOGUE RIVER PIT MINE PLAN MAP.TRV		
SCALE	DATE	DRAWN BY
300 Ft/In	12-8-2010	RPM, Inc
JOB	REVISION	SHEET
\$JOB	1/1	1/1

This map drawn with TRAVERSE PC, Software

EXHIBIT C

PRE-MINING AND MINE PLAN MAP