

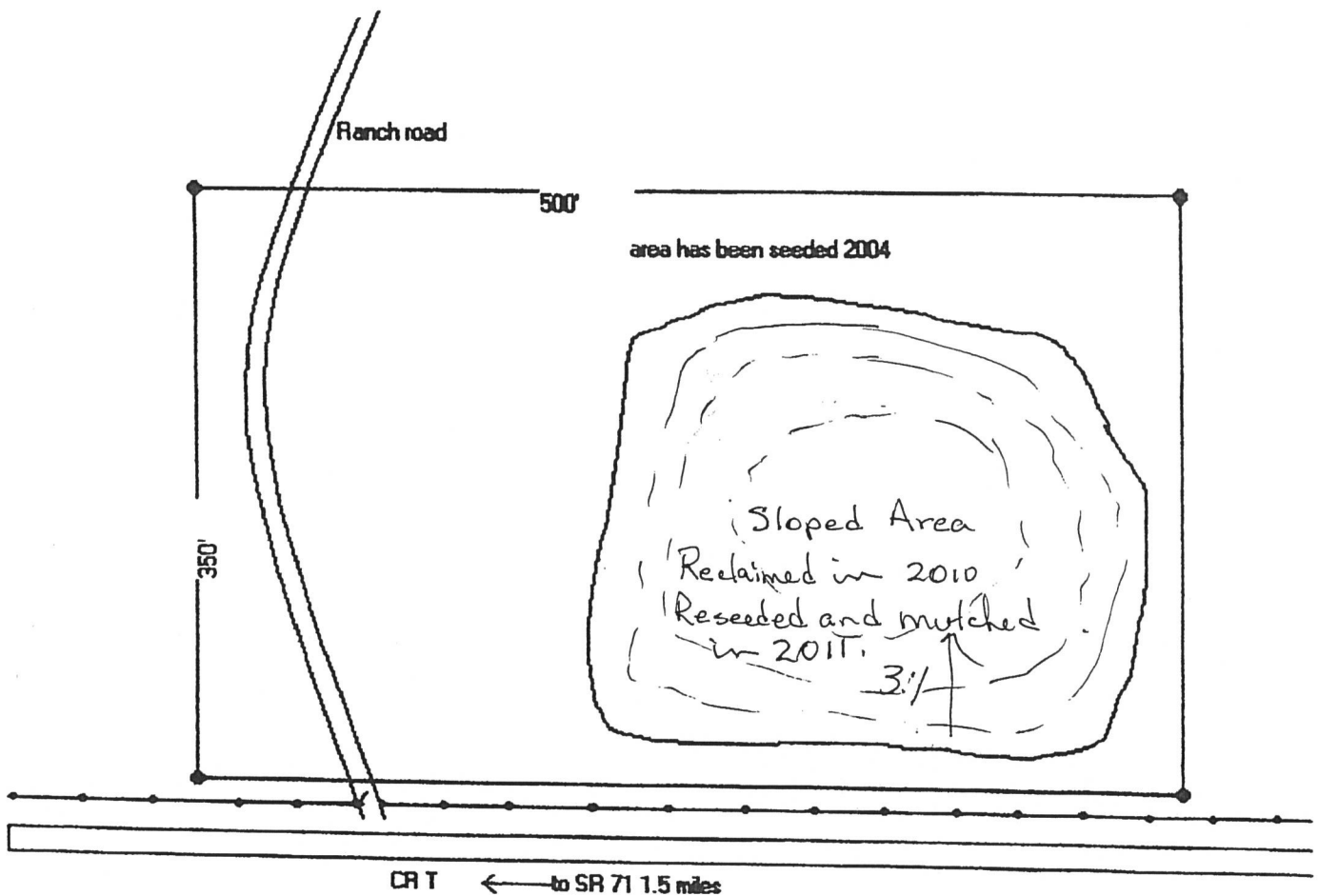

Smith Ranch Pit No.2 SW 1/4 SW 1/4 Sec 10 TS 15 So. Range 56 W. In reclamation, seeded in both 2004 and spring of 2005 with approved seed mixture. Area sloped at 3:1 or less to be reclaimed to rangeland.
Not to scale.

Map by: Ken Morrison
4-5-2012

SMITH RANCH PIT #2 (M-1988-022)



MAP CURRENT AS OF 4/7/15