

Operation ceased in mid November. All sales since were from stockpiled material and ended in late January.

All affected land now being reclaimed.

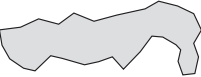
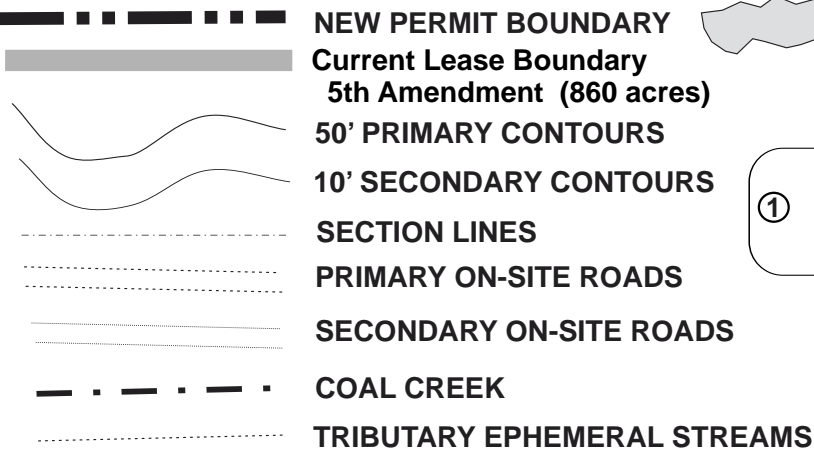

2002 FORESTED (RIPARIAN) LANDS

OIL OR GAS WELL

① LAND BETWEEN MINING AREA AND ADJACENT POWER LINE AND WATER LINE: CURRENTLY NOT APPROVED FOR USE  
SEE "VERY IMPORTANT NOTE" ON PAGE 7 OF EXHIBIT D.

