

# McATEE CONSTRUCTION CO.

HARLEY PIT #1 - M-1986-147

ANNUAL REPORT 2017-18

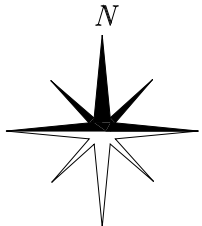
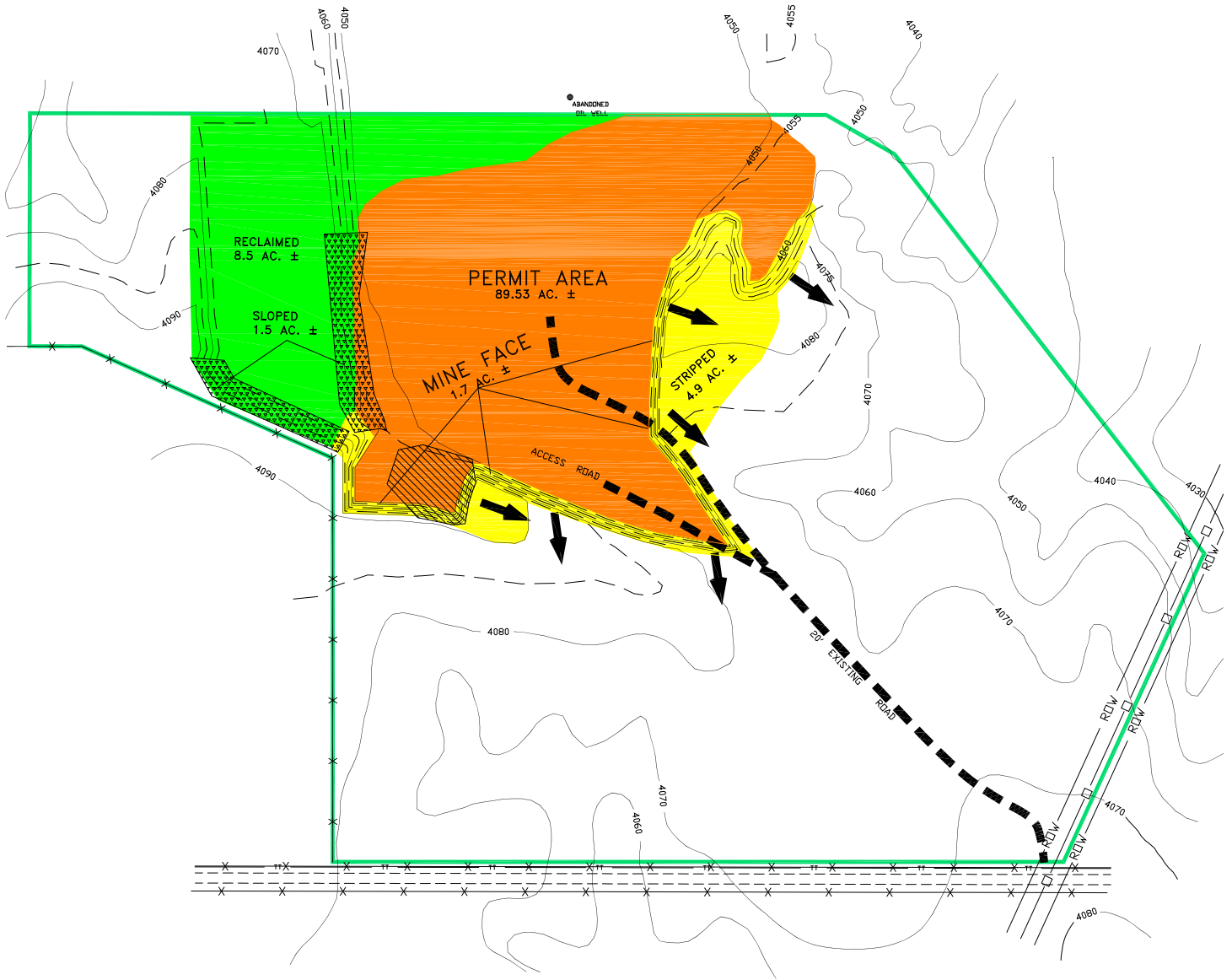

NOV 15, 2018 - 12:08:26

PREPARED BY: *ENVIRONMENT, INC.*  
7983 VANCE DR., # 205A  
ARVADA, CO 80003  
(303) 423-7297



MINING DIRECTION



MINE FLOOR AREA - 17.4 AC. ±



PARTIALLY MINED 2018 - 0.7 AC. ±



STRIPPED & PARTIALLY MINED - 4.9 AC. ±

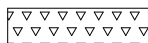

SLOPED 2018 - 1.5 AC. ±



RECLAIMED & SEEDDED AREA - 8.5 AC. ±

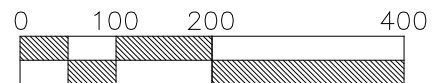

SCALE 1"=200'

## LEGEND

- AFFECTED LANDS
- ROADS
- ABANDONED OIL WELL
- ⊕ WINDMILL
- x— FENCE