

BYRON & LALANI WEATHERS

WEATHERS MINE #1 Permit # M-1999-089

ANNUAL REPORT - 2018

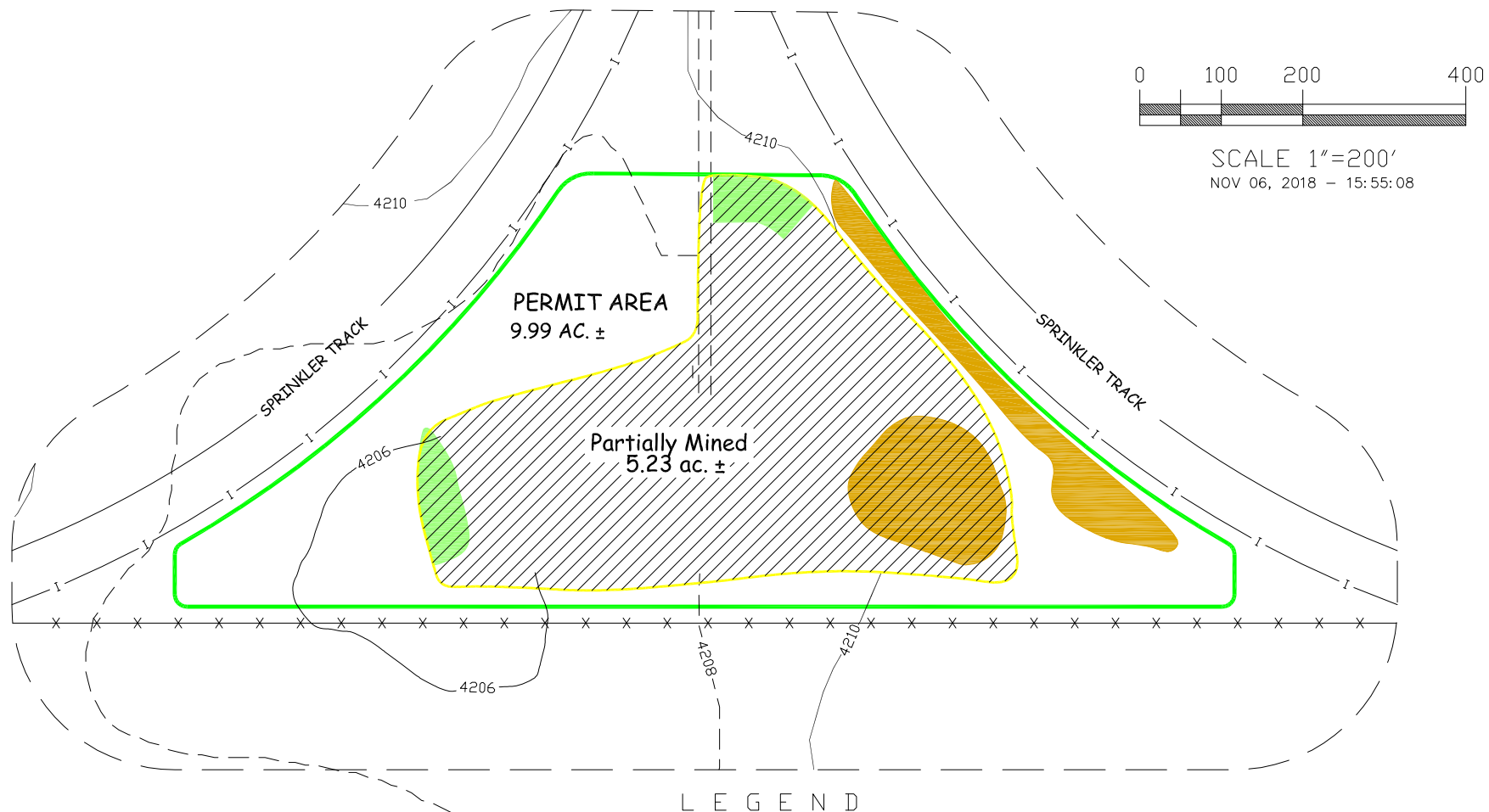

LEGEND

- AFFECTED LANDS/PERMIT AREA
- 200 FOOT LINE
- EDGE OF IRRIGATED FIELD
- == ROAD
- x-x FENCE
- TOPSOIL/OVERBURDEN PILE
- 3:1 SLOPE AREA - 270 FEET
- ▨ STRIPPED & PARTIALLY MINED AND STOCKPILE AREA 5.23 AC ±

PART OF THE SW/4NE/4 AND SE/4NW/4 SECTION 9,
TOWNSHIP 1 SOUTH, RANGE 48 WEST, 6th P.M.,
YUMA COUNTY, COLORADO

PREPARED BY: *ENVIRONMENT, INC.*
7955 VANCE DR., # 205A
ARVADA, CO 80003
(303) 423-7297

DATE REVISION BY

