

REYNOLDS PIT
M-2006-028 ANNUAL REPORT MAP 2018
 PART OF THE NE1/4 SE1/4, SECTION 15, T15S, R96W, 6th P.M., DELTA COUNTY, COLORADO

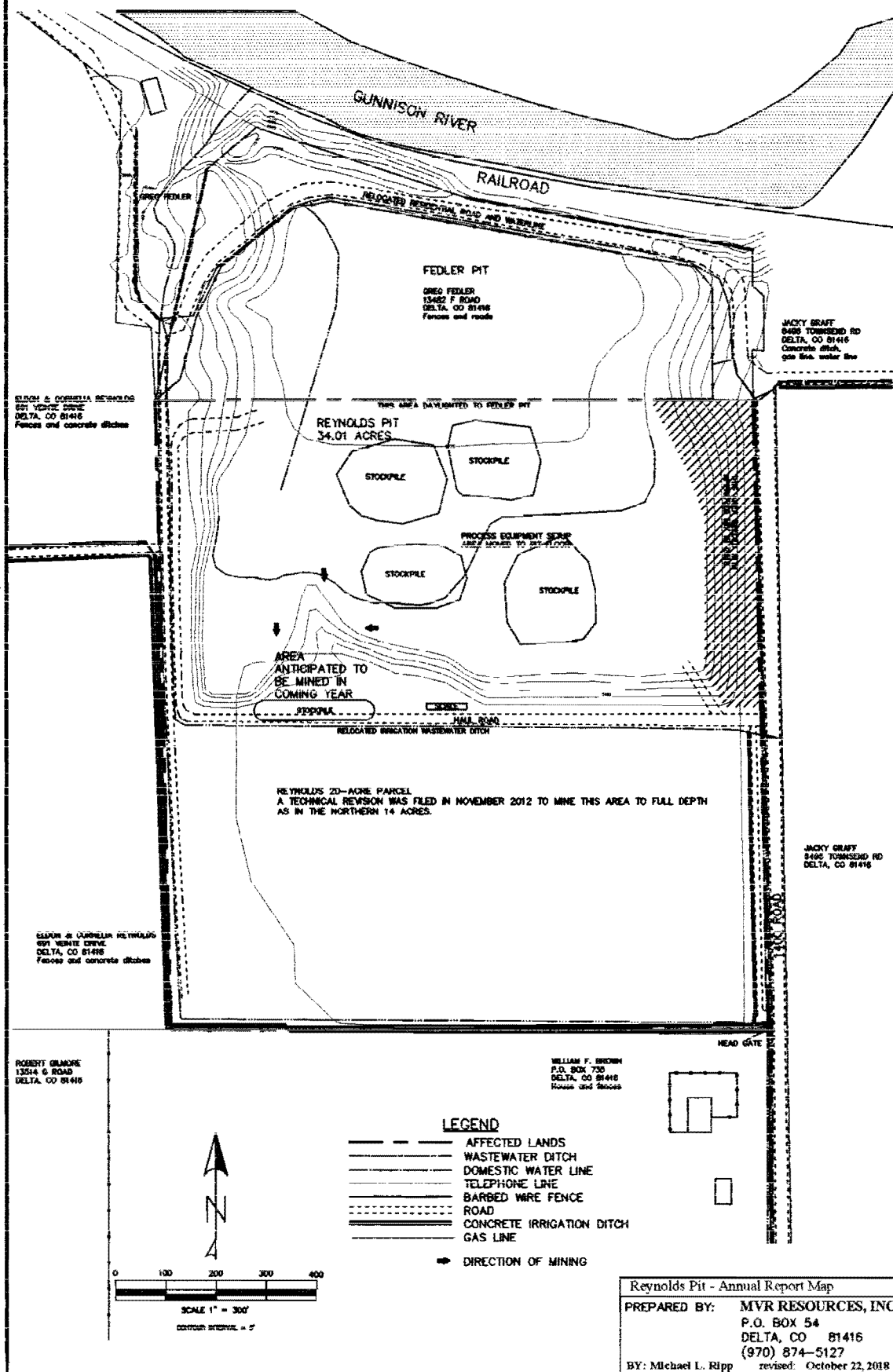

Reynolds Pit - Annual Report Map
 PREPARED BY: MVR RESOURCES, INC.
 P.O. BOX 54
 DELTA, CO 81416
 (970) 874-5127
 BY: Michael L. Ripp revised: October 22, 2018

Michael L. Ripp