

**FORREST MINING PROJECT
AMAZONITE MINING, LLC**

**HARD ROCK / METAL MINING
LIMITED IMPACT OPERATION (110(2))
RECLAMATION PERMIT**

**2018
ANNUAL REPORT MAP**

PERMIT NUMBER M-2017-012

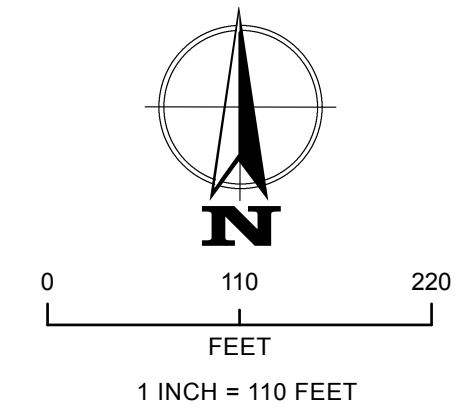

REVISED SEPTEMBER 3, 2018

LEGEND

- FOREST SERVICE ROAD 273
- ACCESS ROUTE CURRENTLY USING
- ACCESS ROUTE PROPOSED
- DRMS PERMIT BOUNDARY
- EXISTING DISTURBANCES PRE-PERMIT
- ACTIVE MINING AREA
- OVERBURDEN SPOIL PILE
- TOPSOIL SPOIL PILE
- GROWTH MEDIUM SPOIL PILE
- SILT FENCE PLACEMENT
- RECLAIMED AND REVEGETATED AREA

NOTES:
1. AREA 4 HAS BEEN DUG ON THIS YEAR.
IT HAS BEEN BACKFILLED AND GRADED TO ORIGINAL SLOPE.
THIS AREA WILL BE DUG ON AGAIN THIS FALL OR NEXT YEAR.

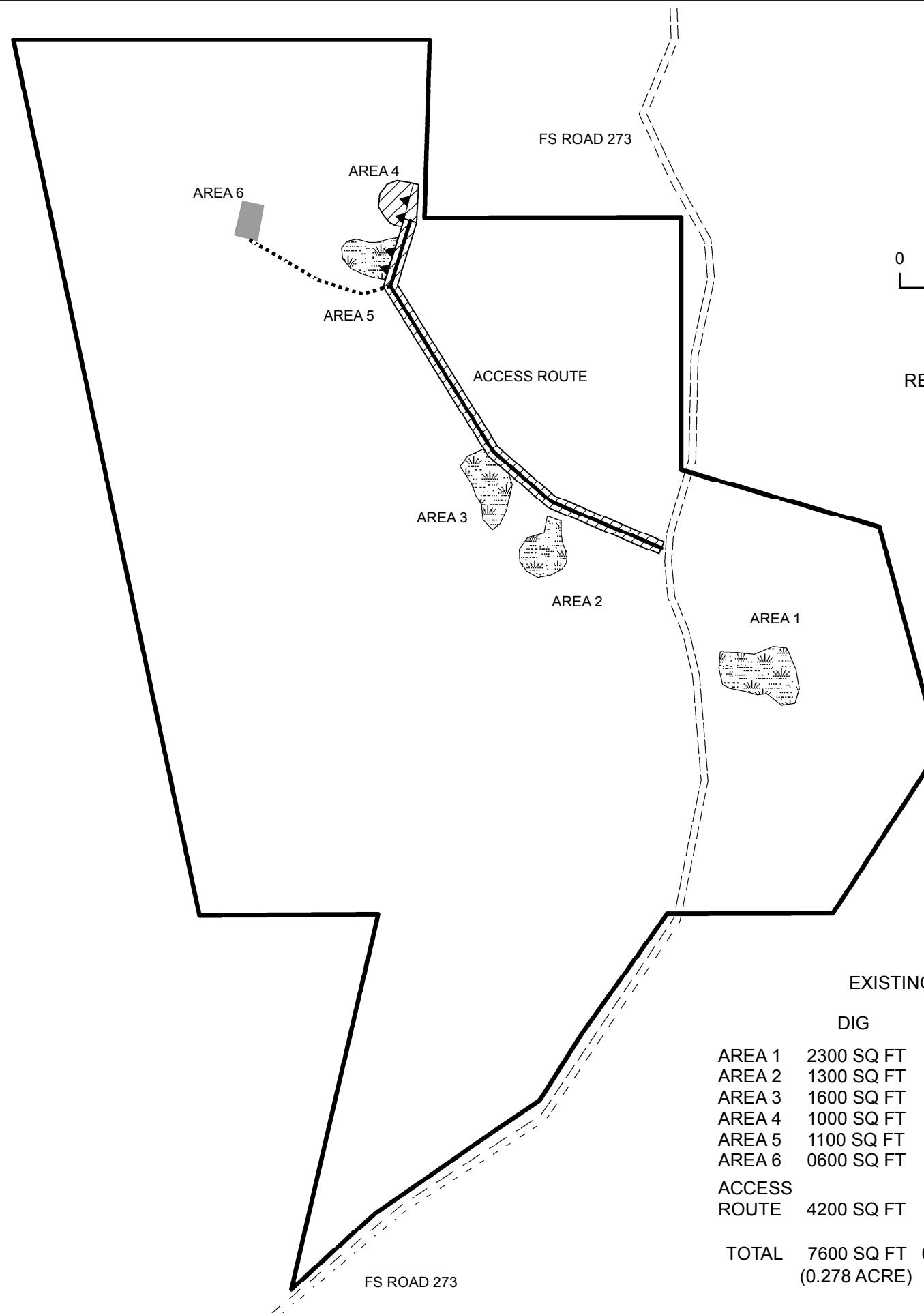

	EXISTING DISTURBANCES			
	DIG	OVER BURDEN	GROWTH MEDIUM	TOPSOIL
AREA 1	2300 SQ FT	000 SQ FT	000 SQ FT	000 SQ FT
AREA 2	1300 SQ FT	000 SQ FT	000 SQ FT	000 SQ FT
AREA 3	1600 SQ FT	000 SQ FT	000 SQ FT	000 SQ FT
AREA 4	1000 SQ FT	000 SQ FT	000 SQ FT	000 SQ FT
AREA 5	1100 SQ FT	000 SQ FT	000 SQ FT	000 SQ FT
AREA 6	0600 SQ FT	000 SQ FT	000 SQ FT	000 SQ FT
ACCESS ROUTE	4200 SQ FT			
TOTAL	7600 SQ FT	0000 SQ FT	0000 SQ FT	0000 SQ FT
	(0.278 ACRE)			