



STATE OF
COLORADO

Cunningham - DNR, Michael <michaela.cunningham@state.co.us>

Lombard #4 & 5 Review #3 Response

1 message

Jeff Carter <jeff.carter@mountainpropertybuilders.com>

Fri, Jun 29, 2018 at 10:55 AM

To: "Cunningham - DNR, Michael" <michaela.cunningham@state.co.us>

Here are my review & 3 comments and documents.

1. Attached
2. Applicant shall notify DRMS immediately if water is encounter in either audit.
3. Revised maps with additional notes attached.
4. DRMS and US Forest Service will be notified if bats are found in the Audits.
5. Financial Warranty calculation received.
6. Slope gradient added to maps.
7. Requested changes made to maps.
8. Access Rd label added to maps
9. Note added to map
10. Vegetation note added to Reclamation Map

Jeff Carter
15954 Jackson Ck Pkwy B281
Monument CO, 80132
719-237-5914
jeff.carter@mountainpropertybuilders.com



Review #3 Docs.pdf
548K

Operator Name: Jeff Carter Mine Plan Map

Site Name: Lamba J 415

All Area owned by
US Forest Service
adjacent to Clump

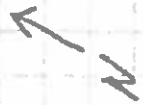

Direction of
Slope



280'



Upper Audit
Mineral Extraction

280'

Existing Road



Access RD
From Cumberland
Gulch Rd

280'

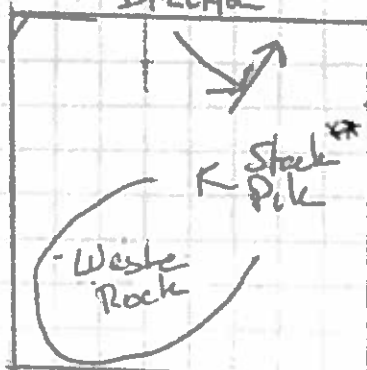

Lower Audit
Mineral Extraction



1 inch = 140 Feet

280'

** Excavated
Material will be stored
in the collapsed Audit
Entrance and will Not
Disturb any Top Soil

Jeff Carter
Signature

6/18/18
Date

Operator: Jeff Carter Reclamation Plan Map Site Name: Lombard 345

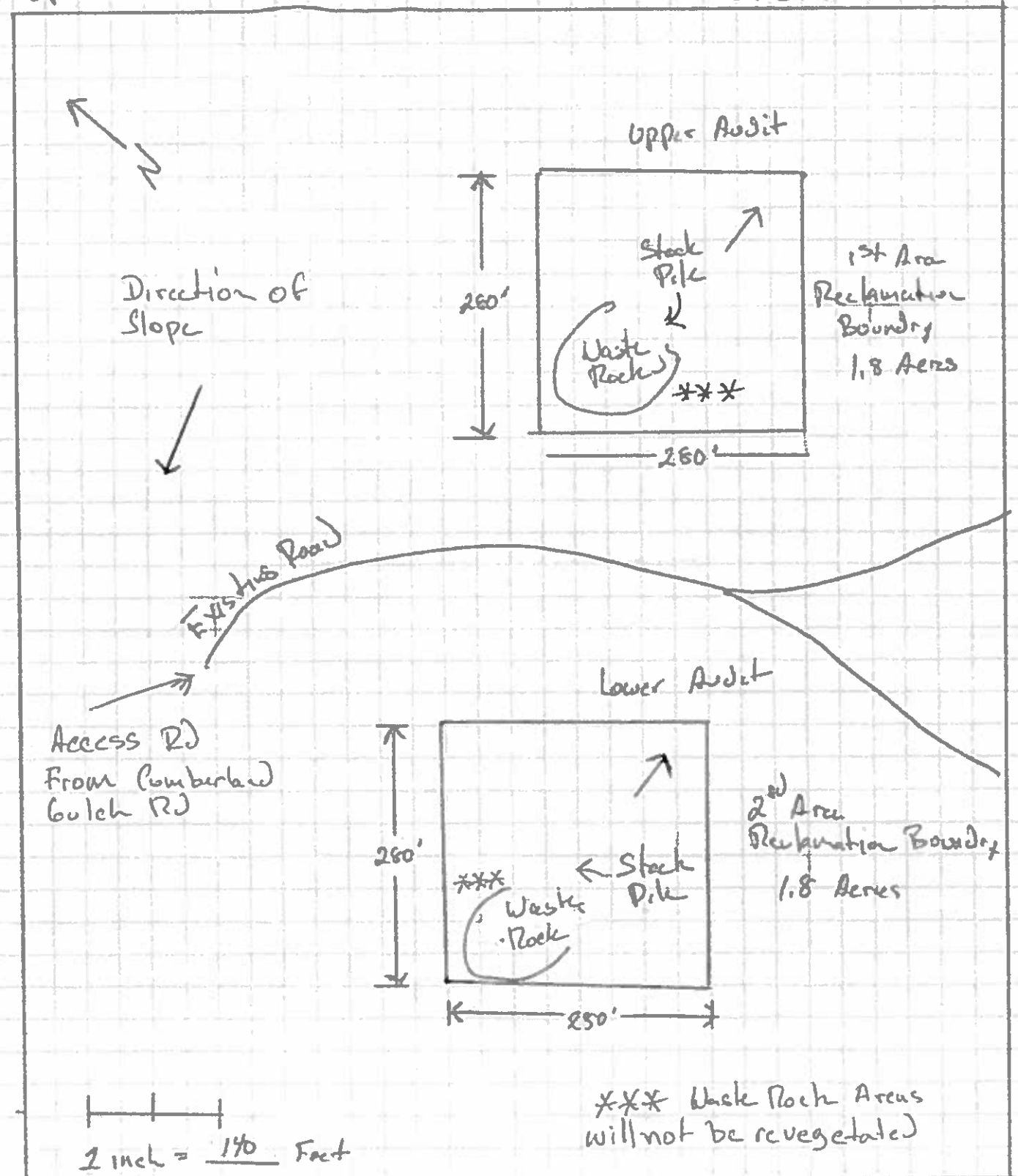

Jeff Carter
Signature

6/18/18
Date



COLORADO

Division of Reclamation,
Mining and Safety

Department of Natural Resources

1313 Sherman Street, Room 215
Denver, CO 80203

LIMITED IMPACT OPERATION (110(1)) RECLAMATION PERMIT APPLICATION FORM

CHECK ONE:



New Application

Permit # M- _____ - _____ (provide for conversions and amendments of existing permits)

The application for a Limited Impact 110(1) Mining Operation Reclamation Permit contains three major parts: (1) the application form; (2) Exhibits A-J, any required sections of Exhibit S and Geotechnical Stability Exhibit, as required by the Office, and outlined in Rules 6.1, 6.2, 6.3, and 6.5; and (3) the application fee. When you submit your application, be sure to include one (1) signed and notarized original and one (1) copy of the application form, two (2) copies of Exhibits A-J, and 6.5 (Geotechnical Stability Exhibit), as required, and a check for the application fee described under (4) below. Exhibits should not be bound or in a 3-ring binder; maps should be folded to 8 1/2" X 11" or 8 1/2" X 14" size. To expedite processing, please provide the information in the format and order described in this form.

GENERAL OPERATION INFORMATION

Type or print clearly, in the space provided, all information described below

1. Applicant/operator or company name (name to be used on the permit): Jeff Carter
 - 1.1 Type of organization (corporation, partnership, etc.): _____
2. Operation name (pit, mine or site name): Lombard #4+5
3. Permitted acreage (new or existing): (must be 5 acres or less) 3.6 permitted acres
4. Fees:
 - 4.1 New Application \$288.00 application fee
5. Primary commodity(ies) to be mined: Gold + Silver
6. Name of owner to the surface of affected land: US Forest Service
7. Name of owner to the subsurface rights of affected land: Jeff Carter
8. Type of mining operation: ☐ Surface ☒ Underground ☐ Placer

