

LAKE COUNTY GRAVEL PIT EXPANSION

A TRACT OF LAND IN THE NORTH 1/2 OF THE SOUTHEAST 1/4 OF SECTION 7, TOWNSHIP 10 SOUTH, RANGE 80 WEST OF THE 6TH PRINCIPAL MERIDIAN, LAKE COUNTY, COLORADO

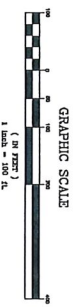

VICINITY MAP
N.T.S.

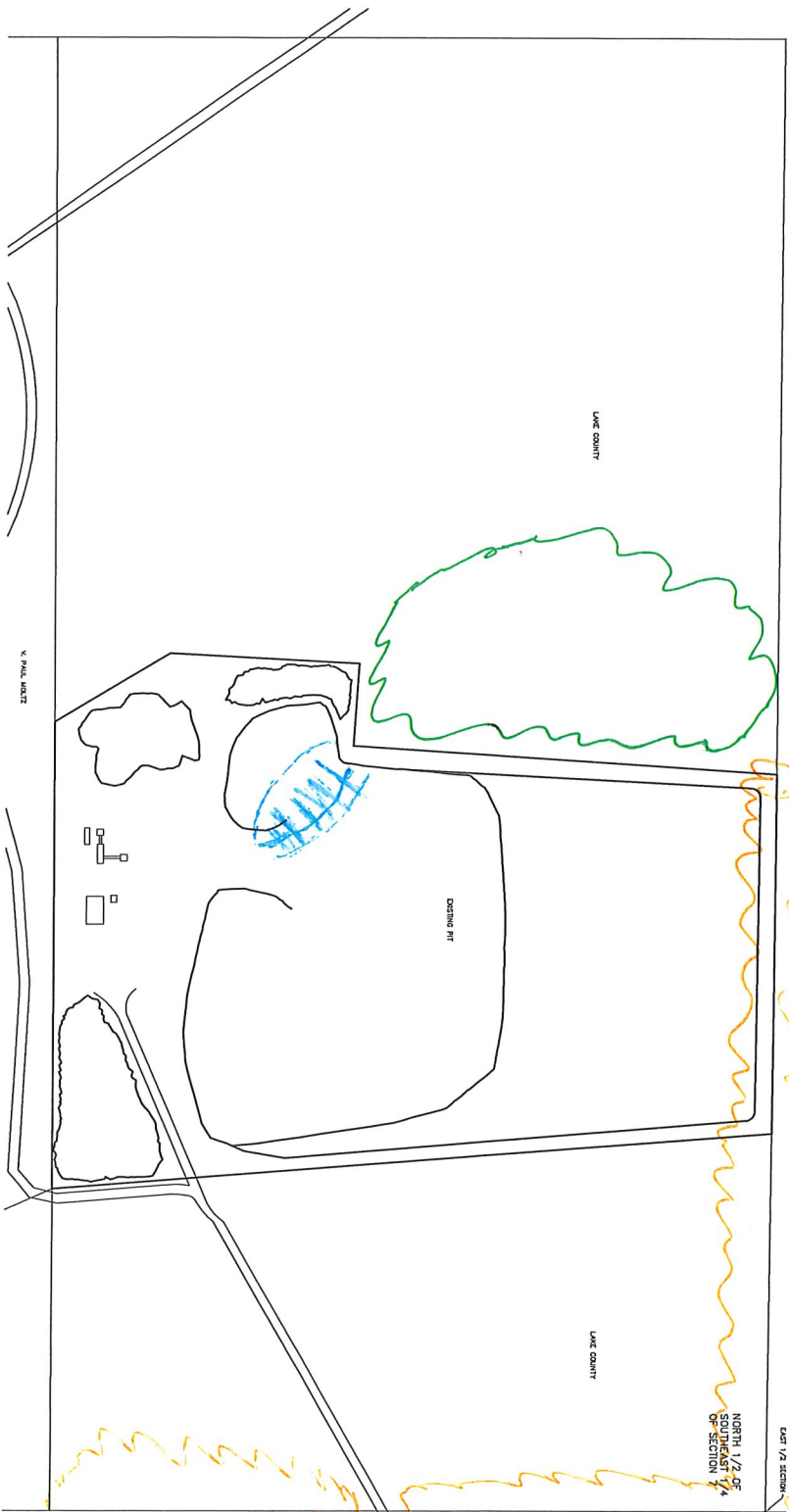

LEGEND
FOUND MONUMENT AS NOTED

- GENERAL NOTES:
- 1) BASIS OF BEARING IS
 - 2) THIS SURVEY WAS PERFORMED TO
 - 3) THE AREA OF
 - 4) THIS SURVEY WAS PERFORMED WITHOUT THE BENEFIT OF A TITLE REPORT. NO RESEARCH WAS PERFORMED OR REQUESTED FOR THIS SURVEY. DEED DOCUMENTATION PROVIDED BY OWNERS.

SURVEYOR'S CERTIFICATION
I, CHARLES E. BEAR, A REGISTERED LAND SURVEYOR, DO HEREBY CERTIFY THAT THIS SURVEY WAS PERFORMED UNDER MY DIRECT SUPERVISION, AND IS TRUE AND CORRECT TO THE BEST OF MY KNOWLEDGE.

CHARLES E. BEAR P.E. 31544

BEAR SURVEYING SERVICES
P.O. Box 441, Berthoud, CO 80513
781-395-3933 Colorado

LAKE COUNTY
GRAVEL PIT EXPANSION
A TRACT OF LAND IN THE NORTH 1/2 OF THE SOUTHEAST 1/4 OF SECTION 7, TOWNSHIP 10 SOUTH, RANGE 80 WEST OF THE 6TH PRINCIPAL MERIDIAN, LAKE COUNTY, COLORADO

PROJECT: 07238 Date: 28 March 2007

Area of Disturbance
- 1005000
- 5700000
- Tree Removal
- Fee New Mining
- 80.0 Acres
- 1.502 Tons
- 7.002 Miles
- 7.002 Miles