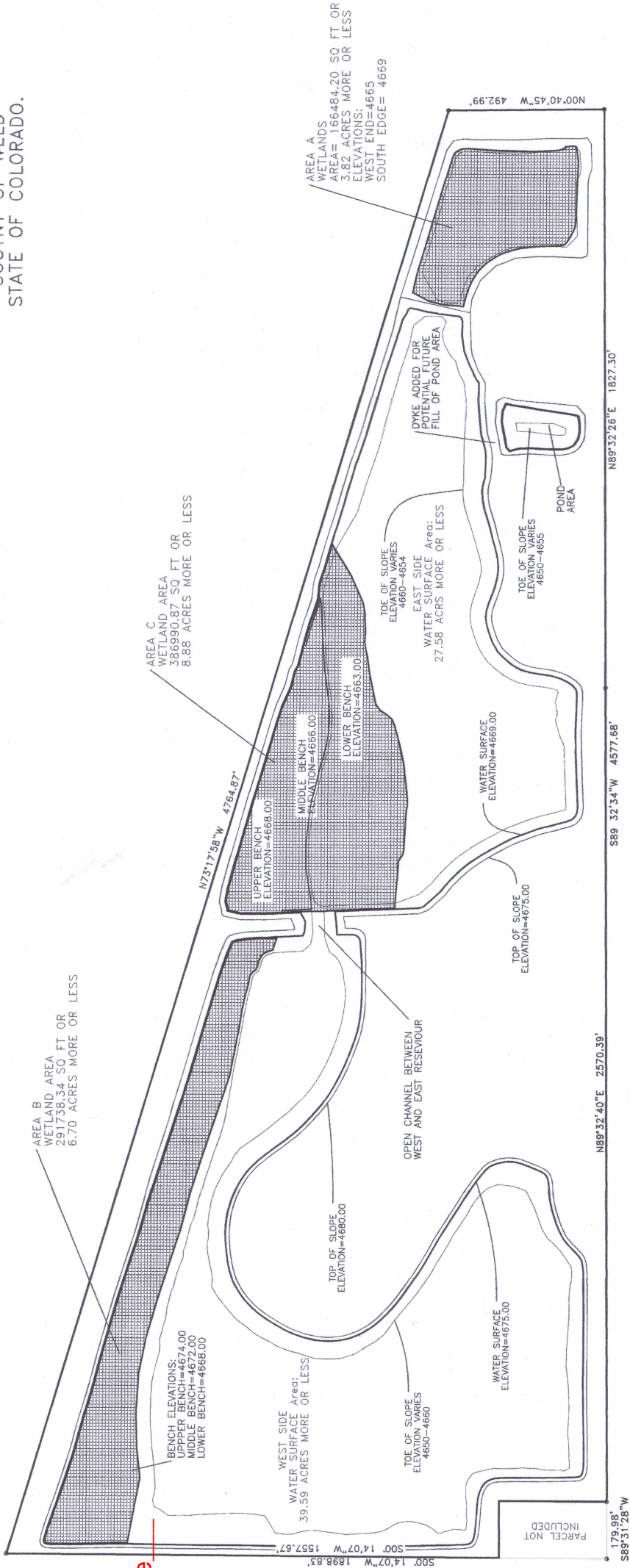

Exhibit F – Reclamation Plan
M-1992-069 – 83rd Joint Venture
Technical Revision

FOR A PARCEL OF LAND LOCATED
IN THE SOUTH HALF OF
SECTION 35, TOWNSHIP 6 NORTH,
RANGE 66 WEST OF THE 6TH P.M.
COUTNY OF WELD
STATE OF COLORADO.

Apx. location of slope
breach from 2013-14
floods/ditch pipe failure



TOTAL SITE ACREAGE: 124.09 +/-
WATER SURFACE ACRES: 67.17 +/-
WETLAND MITIGATION ACRES: 19.40 +/-
UPLAND (site perimeters and
future development areas): 37.52 +/-

Annual Report Map
Year Ended January 26, 2018

PREPARED FOR:
AGGREGATE INDUSTRIES
1507 COLE BLVD. SUITE 100
GOLDEN, CO 80401

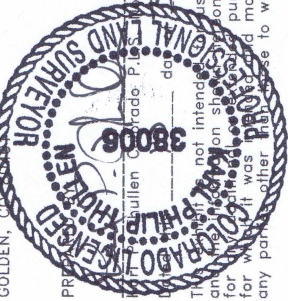

This plan was prepared by the undersigned and is not intended to be used as a survey plat, and no representation shall be made for any purpose beyond that for which it was prepared, and no other party shall be held responsible for any errors or omissions to which it is certified.

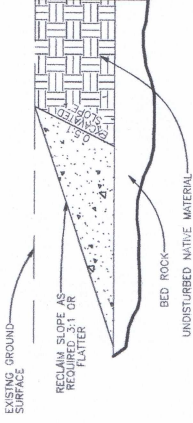

TYPICAL CROSS SECTION
(PRIOR TO BACKFILL)

NIS

NO	DATE	BY	CHK'D	DESCRIPTION
1	02MAR09	KPT		ADD TOE AND BREECH, DYKE
2	11JUL11	KPT		RESHALE
3	18JUL11	KPT		REVISE AREA STATEMENT
REVISIONS				

DATE: 23SEP08	SUB NO: 1
DRAWN: K. THULLEN	CHECKED: 1/200