

A TRACT OF LAND LOCATED IN THE NE1/4,  
SW1/4 AND SE1/4 OF SECTION 1  
AND THE NE1/4 OF THE NW1/4 OF SECTION 12,  
TOWNSHIP 1 SOUTH, RANGE 67 WEST  
OF THE 6TH P.M.,  
COUNTY OF ADAMS, STATE OF COLORADO.  
CONTAINING 290.71± ACRES  
TOTAL AFFECTED LAND 291.54/- ACRES

1. REFER TO COVERSHEET/OVERALL PLAN FOR ADJACENT PROPERTY OWNERS. REFER TO EXISTING CONDITIONS SHEET FOR SOURCE OF SURVEY/TOPOGRAPHY, BENCHMARK, FLOODPLAIN AND WETLANDS INFORMATION.
2. ALONG THE SOUTH PLATTE RIVER, THE LIMIT OF MINING SHALL BE 100' FROM THE TOP OF IMPROVED WEST BANK OF THE SOUTH PLATTE RIVER ALLOWED BY URBAN DRAINAGE AND FLOOD CONTROL DISTRICT JUDFCD.
3. INSTALLATION OF THE PIPES UNDER 160TH AVENUE (SH 7) FOR TRANSPORT OF AGGREGATE MATERIALS TO THE PROCESSING PLANT SHALL REQUIRE APPROVAL OF THE COLORADO DEPARTMENT OF TRANSPORTATION (CDOT). TRUCK EXPORT OF AGGREGATE MATERIALS BELOW THE PLANT SHALL ONLY BE ALLOWED BY APPROVAL OF THE COLORADO DEPARTMENT OF TRANSPORTATION (CDOT) OF AN ACCESS PERMIT THAT MAY INCLUDE CONSTRUCTION OF ROADWAY IMPROVEMENTS DEEMED NECESSARY BY CDOT.
4. AN ENGINEERING STABILITY ANALYSIS HAS BEEN PERFORMED TO ENSURE ANY MINING OCCURRING WITHIN 200' OF A MAN-MADE STRUCTURE NOT OWNED BY THE APPLICANT/OPERATOR HAS ADEQUATE SETBACK. THE DISTANCES REQUIRED BY THE STABILITY ANALYSIS ARE INCLUDED ON THIS PLAN.
5. FOR PHASE 2 AND 3, THE OPERATOR WILL USE DRY MINING TECHNIQUES AND EXCAVATE MATERIAL BY BACKHOE, BULLDOZERS, AND SIMILAR EQUIPMENT. THE MINING FOR THESE PHASES WILL INVOLVE INSTALLATION OF A SLURRY WALL DE-WATERING ACTIVE MINING AREAS, AND PUMPING WATER FROM DE-WATERED AREAS IN ACCORDANCE WITH THE DISCHARGE PERMIT. THE PHASE 1 MINE AREA WILL BE WET MINED.
6. TOPSOIL AND OVERBURDEN STOCKPILES SHALL BE TEMPORARILY STORED IN THE AREAS SHOWN. THE STOCKPILES IN THE FLOODPLAIN SHALL BE ALLEL TO THE CENTERLINE OF THE SOUTH PLATTE RIVER HAVE A MAXIMUM HEIGHT OF 30', A MAXIMUM LENGTH OF 300', MAXIMUM 3:1V SLOPES, AND A MINIMUM OF 100' BETWEEN STOCKPILES.
7. OVERBURDEN AND TOPSOIL STOCKPILES ABOVE EXISTING GRADE, THAT ARE EXPECTED TO BE PRESENT FOR OVER 1 YEAR, WILL BE SEEDDED WITH A TEMPORARY SEED MIX AS WEATHER PERMITS.
8. STOCKPILED TOPSOIL WILL BE SEGREGATED FROM OTHER SOIL.
9. THE OPERATION WILL INVOLVE CONCURRENT MINING AND RECLAMATION. ALL FINAL SLOPES BEING 3:1V AND PLACEMENT OF 6" TOPSOIL ON ALL RECONSTRUCTED AREAS ABOVE THE PROPOSED HIGH WATER LEVEL OF THE FUTURE RESERVOIR; AND OTHER DISTURBED AREAS AS NECESSARY.
10. TETRA TECH RMC INC. IS NOT RESPONSIBLE FOR SAFETY, IN, ON, OR ABOUT THE PROJECT SITE, NOR FOR COMPLIANCE BY THE APPROPRIATE PARTY OF ANY REGULATIONS THERETO.
11. A MINIMUM OF TEN (10) FEET OF CLEARANCE FROM ANY EXISTING POWERLINE OR FUTURE POWERLINE SHALL BE MAINTAINED AT ALL TIMES AS OUTLINED BY STATE STATUTES.
12. UTILITIES SHOWN ON THIS PLAN WERE FIELD LOCATED AT THE TIME OF PLAN PREPARATION. FOR SAFETY, THE OPERATOR SHOULD LOCATE UTILITIES PRIOR TO SLURRY WALL CONSTRUCTION, OR MINING ACTIVITY.
13. SLURRY WALL SHOWN HEREIN IS GENERAL LOCATION ONLY. REFER TO THE SLURRY WALL DESIGN PLANS AND SPECIFICATIONS FOR DESIGN LOCATION.
14. PRIOR TO DISTURBANCE OF ANY WATERS OF THE U.S., A1 WILL GET APPROPRIATE APPROVALS FROM THE U.S. ARMY CORPS OF ENGINEERS.
15. NO IRRIGATION DITCHES WILL BE DISTURBED UNTIL AN AGREEMENT HAS BEEN REACHED WITH THE DITCH COMPANY.
16. MINING OR FILL PLACEMENT IN THE "WEST FILL AREA" WILL BEGIN IN DECEMBER THROUGH FEBRUARY. IF MINING OR FILL ACTIVITY MUST BEGIN DURING THE MONTHS OF MARCH TO NOVEMBER, AGGREGATE SUPPLIER BROWN, INC. WILL SURVEY TO DETERMINE IF BURROW OWLS ARE PRESENT.

	PROPERTY BOUNDARY
	AFFECTED LAND/PERMIT BOUNDARY
	AFFECTED LAND IN ADJACENT R.O.W.
	100 YR. FLOODPLAIN
	EXISTING WATER
	EXISTING 2' CONTOURS
	EXISTING FENCE
	EXISTING TREES
	UTILITY POLE
	ELECTRIC LINE
	GAS LINE
	WATER LINE
	TELEPHONE LINE
	TELEPHONE RISER
	WATER METER
	EXISTING NON-JURISDICTIONAL WETLANDS
	MONITORING WELL LOCATION
	SLURRY WALL
	RELOCATED DITCH LATERAL
	LIMIT OF MINING EXCAVATION
	MINING PHASE LINES
	PROCESSING AREA
	ON SITE HAIL ROAD/CONVEYOR
	PROPOSED ACCESS
	OVERBURDEN & TOPSOIL STOCKPILES
	TOPSOIL BERM W/ GRASS COVER SCREENING
	FINISHED PRODUCT STOCKPILES
	SETTLING POND/DISCHARGE POINT

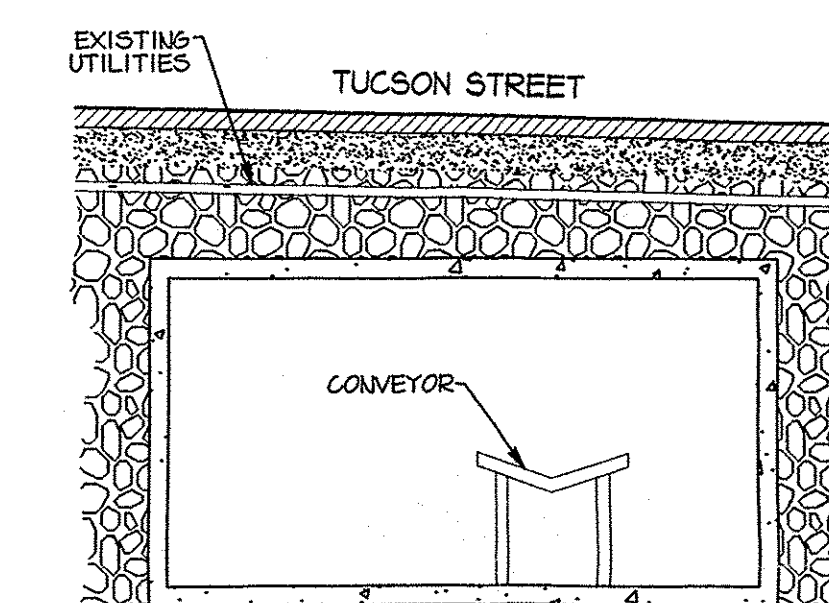
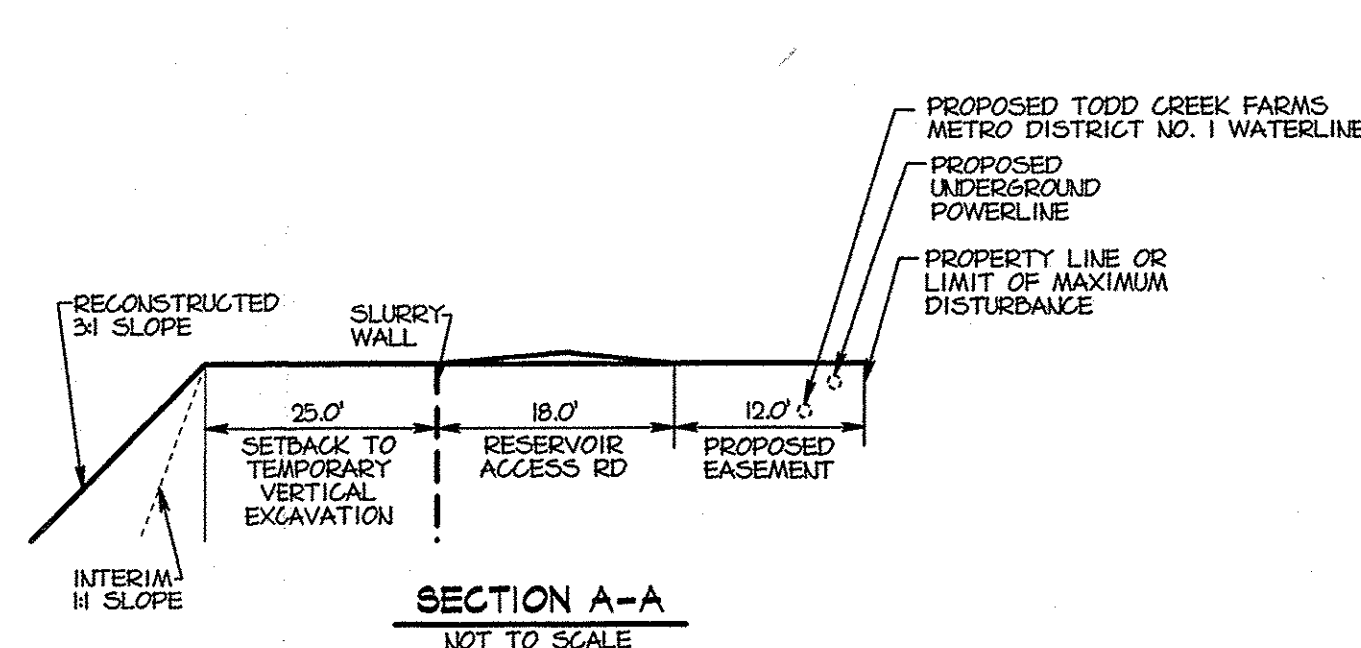
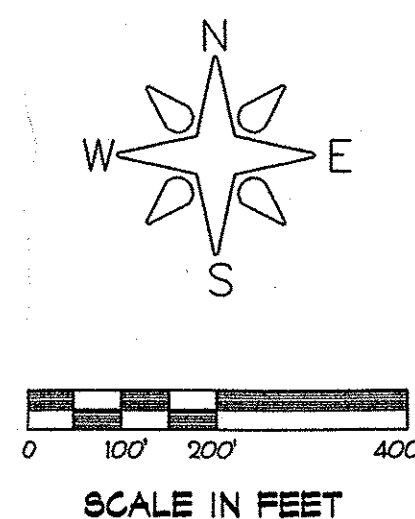

TUCSON STREET CONVEYOR CROSSING DETAIL  
NOT TO SCALE

NOTE:  
THIS DETAIL IS INTENDED TO BE CONCEPTUAL DESIGN. INSTALLATION  
OF THE CONVEYOR CROSSING BOX UNDER TUCSON STREET IS SUBJECT  
TO APPROVAL OF ADAMS COUNTY PUBLIC WORKS DEPT. AND COORDINATION  
WITH EXISTING UTILITIES.

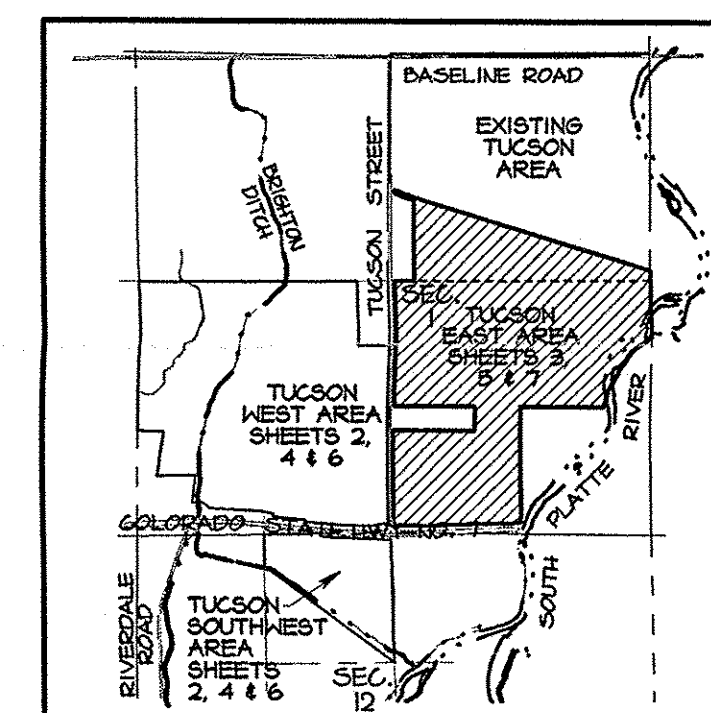

KEY MAP

NOT TO SCALE

<b>RECORD</b>	<b>DATE</b>	DESIGNED BY: KF
ADEQUACY REVIEW 10-20-04	11-17-04	PREPARED BY: DP/SR
ADAMS COUNTY REFERRAL RESPONSE	12-14-04	CHECKED BY: KF
		JOB NO:
		80-3919.019.01



**TETRA TECH RMC**  
1900 S. SUNSET ST., SUITE 1-F, LONGMONT, CO 80501  
TEL 303.772.5282 METRO 303.665.6283 FAX 303.665.6050

TUCSON SOUTH RESOURCE  
MINING PLAN