



File Code: 2810
Date: December 19, 2017

James Thomas
3506 Mesa Grande Drive
Colorado Springs, Colorado 80918

Dear Mr. Thomas and Ms. Stacey Hale:

I received your Notice of Intent (NOI) on November 14, 2017, to conduct prospecting activities on the Crystal Falls No. 1 and Crystal Falls No. 2 (CMC 289863/64) unpatented mining claims on National Forest System lands administered by the Pikes Peak Ranger District in section 20, T. 14 S., R. 67 W., 6th Principal Meridian, El Paso County, Colorado.

In reviewing your NOI, it has been determined that a Mining Plan of Operations (MPO) is not needed at this time. However, when spring conditions return and your operation begins in May 2018, I have asked Jeff Hovermale of my staff to coordinate an on-site field inspections with you to evaluate conditions. An MPO and a reclamation performance bond will be required for my review and approval if you *create significant resource disturbance to surface resources* as a result of proposing or doing any of the following:

- Failing to backfill any holes, pits or trenches;
- Cutting any trees;
- Using mechanized equipment;
- Using roads that are not National Forest System (NFS) roads with mechanized vehicles (including OHV);
- Creating new access routes or roads;
- Constructing any structures or facilities;
- Placing signage other than mine claim corner post identification;
- Do anything that might cause a significant disturbance.

No deviation from this NOI is authorized without my prior written approval. Your notice of intent is valid for 2018 or until December 31, 2018. You will need to submit a new NOI for any proposed activities after December 31, 2018.

Please note that where not otherwise restricted, it is prohibited to camp more than 28 days within a continuous 60 day period, and/or occupy any campsite for more than 14 days during this 60 day continuous period within three miles of the previous campsite. In addition, Forest Service Motor Vehicle Use Map (MVUM) rules and regulations require vehicles to park in areas immediately adjacent to NFS roads.



Enclosed is information on the reclamation standards for this district for your review. You are required to follow these standards to be in compliance with your NOI.

Additionally, the claims are located on National Forest are also located within the Municipal Watershed of Colorado Springs as designated in Cooperative Agreement dated, January 9, 1924 for the purpose of conserving and protecting the water supply of the City of Colorado Springs. As required by the 1924 agreement, use and activities within the agreement (watershed) area will not be permitted without the approval of the proper city authorities. In consultation with City/Colorado Springs Utilities representatives, they understand your rights and responsibilities under mining laws and agency policies and regulations. The City highlights to following practices to help protect source water areas:

1. Safe handling, storage, and use of contaminants that could potentially reach source waters. Operators could provide detail on the contaminants found on site including those possibly generated or imported in case of a spill.
2. Eliminating stormwater runoff from mine tailings, pits, trenches and other land disturbances through the use of straw wattles, silt fencing and site restoration after operations cease.
3. All waste products being removed from the site for disposal at appropriate facilities.

Finally, as a reminder, you are required to follow all State and Federal mining and water quality rules and regulations.

If you have further questions, please contact Jeff Hovermale of my staff at, 719-477-4201 or email jhovermale@fs.fed.us.

Sincerely,

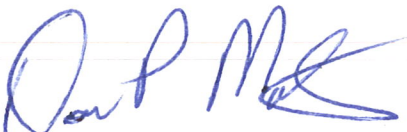

OSCAR MARTINEZ
District Ranger

Enclosures: As noted
cc: Kim Gortz, Tim Cazier



NOTICE OF INTENT FOR MINING ACTIVITIES

Pursuant to 36 CFR §228
(Use of this form is optional)

USFS PIKES PEAK RANGER DISTRICT

Received By: _____
Date Received: _____
15-day Response Date: _____

I/We, JAMES THOMAS STACEY HALE DOUGLAS HIRDLER
declare my/our intent to conduct mining operations on unpatented National Forest System Lands within the Pikes
Peak Ranger District of the Pike National Forest. This mining activity will be in the form(s) of:

DEVELOPMENT AND OR PRODUCTION

Prospecting, Exploration, Development, or Production

Name: JAMES THOMAS Phone Number: (719) 344-1370

Mailing Address: 3506 MESA GRANDE DR

City: COLORADO SPRINGS State: COLORADO Zip Code: 80918

Email: HARDLUCKMINING@GMAIL.COM

Claim #	Claim Name	Township (North or South)	Range (East or West)	Section(s)	Quarter Section (NE, SE, SW, NW)
<u>1</u>	<u>CRYSTAL FALLS #1</u>	<u>16S</u>	<u>67W</u>	<u>20</u>	<u>NW</u>
<u>2</u>	<u>CRYSTAL FALLS #2</u>	<u>16S</u>	<u>67W</u>	<u>20</u>	<u>NW</u>

Surface disturbance resulting from this mining activity will be in the form of: _____

HANDTOOL CUTS AND PITS

Cuts, pits, trenches, drilling, shafts, tunneling, tree cutting, road/trail construction, tailings deposit, etc.

Reclamation Plan: FOLLOWING ALL GUIDELINES AND PLAN OF OPERATIONS BY U.S.F.S. & B.L.M.

Estimated Acres of Disturbance: ONE OR LESS ACRES ON CLAIM #1 & LESS ON #2

Work will be implemented by: HANDWORK, PICK, SHOVEL, HAMMER, CHISEL

Specify handwork, type of tool and/or machinery, etc.

Travel to the operation(s) will be by: FOOT TRAVEL, FROM ROAD TO TRAIL TO HISTORIC FOOT PATHS.

Specify type of vehicle, foot travel, animal, etc.

Owners of claims other than operator: STACEY HALE - 3506 MESA GRANDE DR. 80918

DOUGLAS HIRDLER 677 AUTUMN PL. 80817

List names and addresses of individuals, companies, etc.

Proposed start-up date and duration of mining activities (mm/dd/yy): 05/01/18 - AT LEAST 2028

SIGNATURE OF OPERATOR(S):

James Thomas
Stacey Hale

11-13-17
(mm/dd/yy)
11-13-17
(mm/dd/yy)

****A Plan of Operations (form FS-2800-5) will be required for all activities that involve machinery, tree felling, road construction, and other activities that cause significant disturbance (36 CFR 228.4)**

ATTACH MAP TO NOTICE: Map must show mining claim, both road and off-road access to work site. Road access is shown in **BLACK**, off-road access is shown in **BLUE**, and proposed road and/or trail construction is shown in **RED**.

#3 The Nature Of The Proposed Operations

We will begin mining the Crystal Falls #1 in the spring of 2018. We will only be surface collecting on the Crystal Falls #2 for the immediate future. We are to begin planned operations on 05/01/18 to be performed at hand tool level as long as it is economically viable to continue to do so.

We will hike in our tools, and take both single day trips, and extended camping trips as weather permits, not to exceed reasonable occupation, in order to properly maintain economic viability of the mine. We will be digging by hand with non-mechanized hand tools as defined by U.S.F.S. & B.L.M. as casual usage. All operations will consist of digging to extract the crystals and other valuable minerals, once extracted they will be removed from the mine to a private residence for cleaning and processing. No chemicals of any kind will be used in extracting materials or for any other purpose. If no bond were to be requested, we still would wish to provide a reclamation bond voluntarily to ensure that as operators, we have done everything within our power to operate responsibly and with safe ecological practices.

At the current time, there are three owners involved, as well as three laborers who participate in limited capacities. Equipment used will be hand tools only, consisting of picks, shovels, hammers, chisels, or other hand carried and hand operated tools.

Digs will be excavated to varying depths depending on the depth of the vein structures. This could range up to 12 ft. in depth or possibly further if deposits are being located at such depths. There will be a series of digs made over the life of the mine to be no more square footage than consists in a square acre of land.

When a dig is considered no longer viable, it will be backfilled and reclaimed independently of the other active digs. Each site would be on average 600 to 800 square ft. in total disturbance. In a single calendar year, no more material will be removed than is allowed by our subsequent reclamation bond for 1.00 acres. Waste or tailings will be secured in appropriate structured containment berms, and will be replaced back into digs when closing individual sites prior to reclamation on a case by case basis. The only vegetation to be removed is small mountain shrubs, and grasses. We put a priority to avoiding the removal of any trees.

Small primitive tent sites will be the method of camping during operations. These sites will be placed within the boundaries of active dig sites, to minimize surface disturbance, and will be on top of inactive berms containing tailings. Tent sites will be buried with the dig when closing a site, and will be reclaimed as well.

The method of sewage and waste removal will be done to whatever standard or desired outcome the U.S.F.S. finds acceptable.

LOCATION MAP
(Optional template)

Operator Name: James Thomas

Site Name: Crystal Falls #1
Crystal Falls #2

#4. MAP OF ACCESS

WE HIKE WEST ON HIGH DR TO THE SOUTH TRAILHEAD OF SEC. 16/ RED ROCK LOOP TRAIL, HEADING NORTH FROM THERE, AS INDICATED ON THIS MAP, WHEN AT THE INTERSECTION OF SEC. 16/ RED ROCK LOOP AND THE STREAM HUNTER'S RUN, WE HIKE A DISTANCE OF ABOUT 270 FEET WEST USING HISTORIC FOOT TRAILS THAT PRE-DATE OUR ENTRY TO ARRIVE ON THE CRYSTAL FALLS #2. NO PRIVATE LANDS ARE CROSSED, AND NO NEW TRAIL OR OFF TRAIL ACCESS IS NEEDED.

Crystal

Falls

#1

Crystal

Falls

#2

Foot Trails

≈ 270 FEET

HUNTER'S RUN

Section 16/ Red Rock Loop Trail

0 N/A Feet or Miles
1 in = NOT TO SCALE Feet or Miles

Signature

Date

11-13-17

JAMES THOMAS
STACEY HALE
DOUGLAS HIRDLER

LOCATION MAP
(Optional template)

OWNER
Operator Name:

Site Name: Crystal Falls #1
Crystal Falls #2

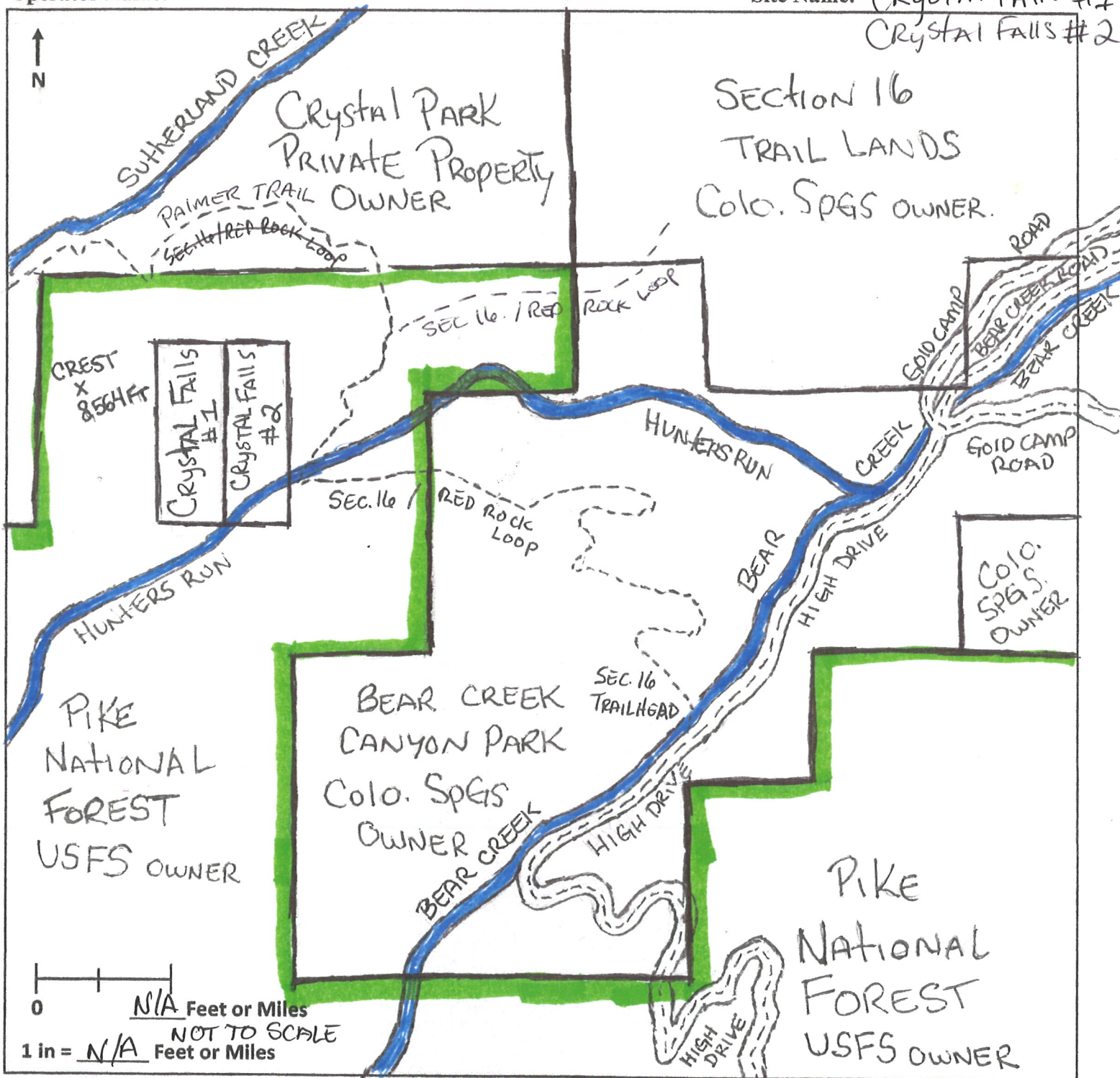

James Thomas 9-19-17
Signature Date
Stacey Hale 9-19-17
Douglas Hirdler 9-19-17



STATE OF
COLORADO

Cazier - DNR, Tim <tim.cazier@state.co.us>

FW: Crystal Falls No. 1 and 2 Mine Claim

1 message

Hovermale, Jeff -FS <jhovermale@fs.fed.us>

Tue, Dec 19, 2017 at 11:16 AM

To: "Kim Gortz (kgortz@csu.org)" <kgortz@csu.org>, "Cazier - DNR, Tim (tim.cazier@state.co.us)" <tim.cazier@state.co.us>

Tim and Kim,

I did visit the site yesterday Dec. 18, although not a complete gird/walk of the claims as areas are steep and frozen. I did not observe any open pits or mining activity. But note Tim and I did receive a voice message from a forest users that had concerns of trenching in this area. This claim was not filed with the BLM until recently in September 2017 and the mine claimants state they will begin in May 2018. I hope to visit the site this spring with the mine claimant and will coordinate with both of you if interested.

Thank you,



Jeffrey Hovermale
Lands and Minerals Staff Officer

Forest Service

Pike National Forest, Pkes Peak Ranger District

p: 719-477-4201

f: 719-477-4233

jhovermale@fs.fed.us

601 S. Weber Street
Colorado Springs, CO 80903

www.fs.fed.us



Caring for the land and serving people

From: pikenationalforestpikespeakrangerdistrict@fs.fed.us [mailto:pikenationalforestpikespeakrangerdistrict@fs.fed.us]

Sent: Tuesday, December 19, 2017 10:39 AM

To: Hovermale, Jeff -FS <jhovermale@fs.fed.us>

Subject: Attached Image

This electronic message contains information generated by the USDA solely for the intended recipients. Any unauthorized interception of this message or the use or disclosure of the information it contains may violate the law and subject the violator to civil or criminal penalties. If you believe you have received this message in error, please notify the sender and delete the email immediately.

2 attachments



2018 NOI_Crystal Falls 1 and 2.pdf

2146K



NOI Crystal Falls Letter_12_19_2017.pdf

627K