

# J. E. STOVER & ASSOCIATES, INC.

2352 NORTH 7<sup>TH</sup> STREET, UNIT B  
GRAND JUNCTION, COLORADO 81501  
PHONE: (970) 245-4101, FAX: (970) 242-7908

MINE ENGINEERING  
MINE RECLAMATION

CIVIL ENGINEERING  
CONST. MANAGEMENT

September 8, 2017

Ms. Janet Binns  
Colorado Division of Reclamation, Mining & Safety  
1313 Sherman Street, Rm 215  
Denver, CO 80203

Re: Snowcap Coal Company, Inc. (SCC)  
Technical Revision No. 70 (TR-70)  
Adequacy Review Comments  
Permit No. C-1981-041

Dear Ms. Binns:

The DRMS' letter dated September 6, 2017, transmitted its adequacy comments regarding TR-70. Following are SCC's responses to the DRMS' comments and concerns:

1. **DRMS:** The Divisions records show that the current permit area contains 306.4 acres that have been affected by mining. TR70 proposes to reduce the affected acreage by 4.0 acres. The remaining affected acres will be 302.4 acres after TR70 approval. Table 3-7 submitted with the TR70 application reports this value as 300.9 acres.

**Please correct the affected acres value on Table 3-7, or provide an explanation for the 1.5 acre difference between Snowcap Coal Company's records and the Division's value.**

**SCC:** As per out phone conversation this morning enclosed is revised Table 3-7 correcting the affected acres value to 302.3. Also enclosed is the revised "Affected Area Acreage" map as backup to Table 3-7. Please note that the map is not to be included in SCC's permit.

If you have any questions please give me a call.

Sincerely,

*Tonya K. Hammond*

Tonya K, Hammond  
Owner's Representative

cc: Mesa County Clerk, BLM, SCC File

**SNOWCAP COAL COMPANY, INC.**  
**TABLE 3-7**

**ROADSIDE NORTH & SOUTH MINES**  
**PERMIT AREA ACREAGES**

<b>Permit Area</b>	<b>Surface Acreage</b>	<b>Mineral Acreage</b>
Federal	44.7	44.7
Private	472.3	503.3
State	31.0	0.0
<b>Total Permit Area</b>	<b>548.0</b>	<b>548.0</b>

<b>Disturbed Area*</b>	<b>Acreage</b>
Roadside Borrow Area	1.1
S Portal Light Use Road #1	1.9
Outfall 002 Piping	0.2
North Decline	6.6
Conveyor Corridor	0.3
A Substation	0.2
B Substation	0.3
S Portal Hydrologic Communication Repair	0.4
<b>Total Disturbed</b>	<b>11.0</b>

<b>Affected Area</b>	<b>Acreage</b>
Underground Mining Activities & Disturbed Areas	<b>302.3</b>

\*Acres approved for Phase III Bond release have been removed from total.

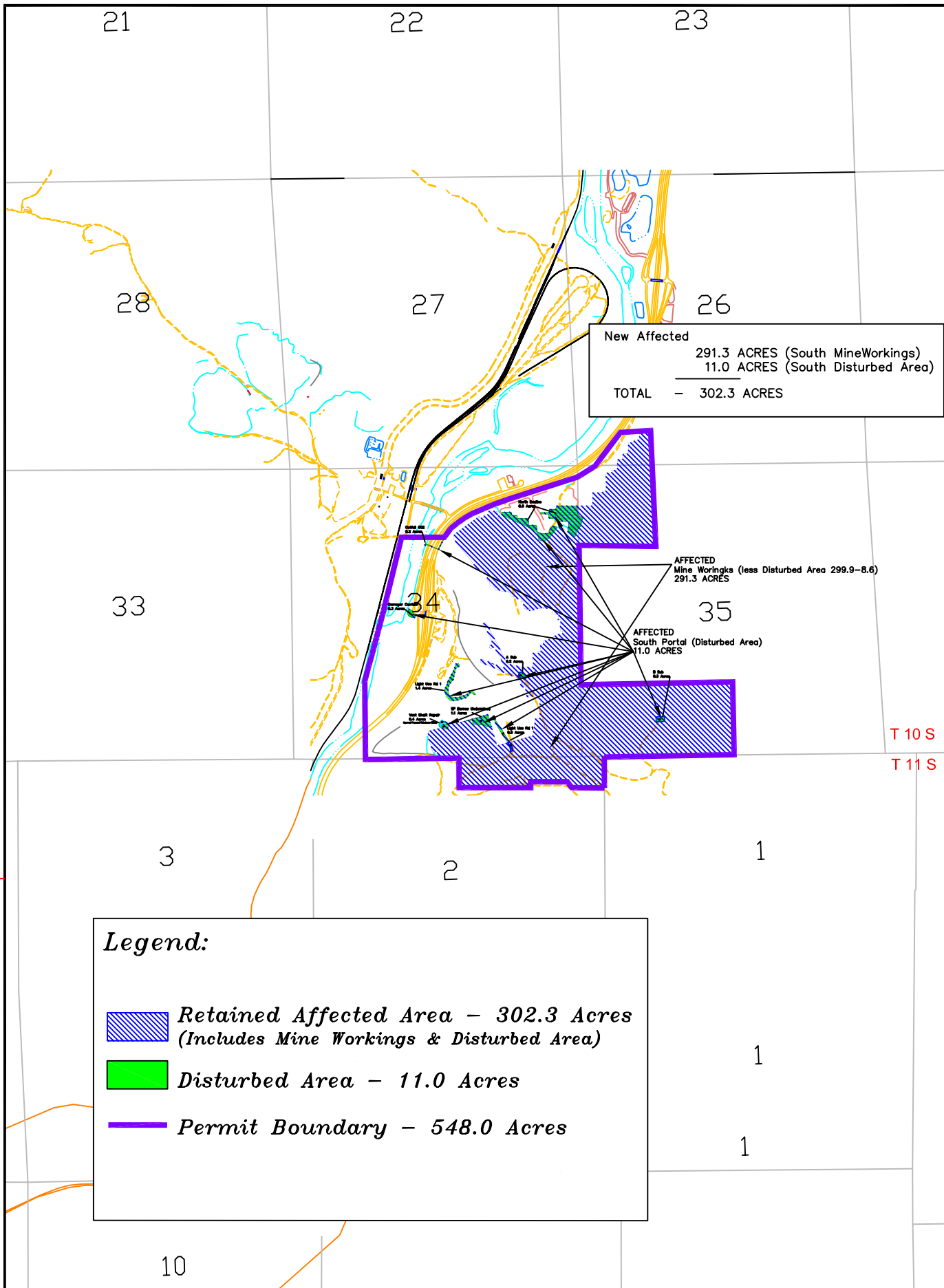

### Legend:

- Retained Affected Area - 302.3 Acres  
(Includes Mine Workings & Disturbed Area)
- Disturbed Area - 11.0 Acres
- Permit Boundary - 548.0 Acres

PROJECT: SNOWCAP COAL COMPANY, INC. TITLE: Affected Area Acreage Based on SL-9 & 10 & TR-69 NOT A PERMIT MAP		PREPARED FOR: SNOWCAP COAL COMPANY, INC. P.O. Box 1430 Palisade, CO 81526 (970) 241-8118		 ONE INCH		REVISIONS <table border="1" style="width: 100%; border-collapse: collapse;"> <tr> <th style="width: 5%;">NO.</th> <th style="width: 85%;">DESCRIPTION</th> <th style="width: 10%;">DATE</th> </tr> <tr> <td>02</td> <td>Change Permit Boundary, Affected Acres - TR-70</td> <td>TKH 9/17</td> </tr> <tr> <td>01</td> <td>Change Permit Boundary, Affected Acres - TR-67</td> <td>TKH 11/15</td> </tr> </table>		NO.	DESCRIPTION	DATE	02	Change Permit Boundary, Affected Acres - TR-70	TKH 9/17	01	Change Permit Boundary, Affected Acres - TR-67	TKH 11/15
NO.	DESCRIPTION	DATE														
02	Change Permit Boundary, Affected Acres - TR-70	TKH 9/17														
01	Change Permit Boundary, Affected Acres - TR-67	TKH 11/15														
DWG. NAME: DRMS I.D. No. C - 1981-041 SCALE: NTS		PREPARED BY: J. M. STOVER & ASSOCIATES 1000 N. 1st Street, Suite 100 Palisade, CO 81526 (970) 241-8118		DIGITIZED: TKH 02/01/06 DRAWN: GB 10/06/01 CHECKED: JES 02/01/06		REFERENCES										