

3B ENTERPRISES LLC

SAND, GRAVEL & ROCK PRODUCTS

1200 E. 1ST STREET, CRAIG, CO PO BOX 1665, CRAIG, CO 81626

June 23, 2017

Amy Yeldell
Division of Reclamation & Mining Safety
1313 Sherman Street, Room 215
Denver, CO 80203

RE: Rock Pit Mine M-1985-082

Amy, following is the response to your letter dated 6-8-17:

- 1) Enclosed is the map showing the scale and scale house location.
- 2) No additional roads will be constructed to access the scale and scale house.
- 3) Yes the scale and scale house will be removed upon final reclamation. The scale is 11' x 70' and sets on 4 concrete piers that measure 4' x 12' and are 12" in the ground. The scale house will be a 10' x 20' wood frame house that sets on the ground.
- 4) The crusher to be used will be a mobile jaw crusher and will not utilize any concrete pads.

Sincerely,



Steve Baker
(970) 326-7356 (cell)



SCALE: 1" = 200'

3B Enterprises, llc - ROCK pit M-1985-082

SW1/4SE1/4 SECTION 9, T6N, R90W

EXISTING CONTOUR MAP Date: 4/22/17

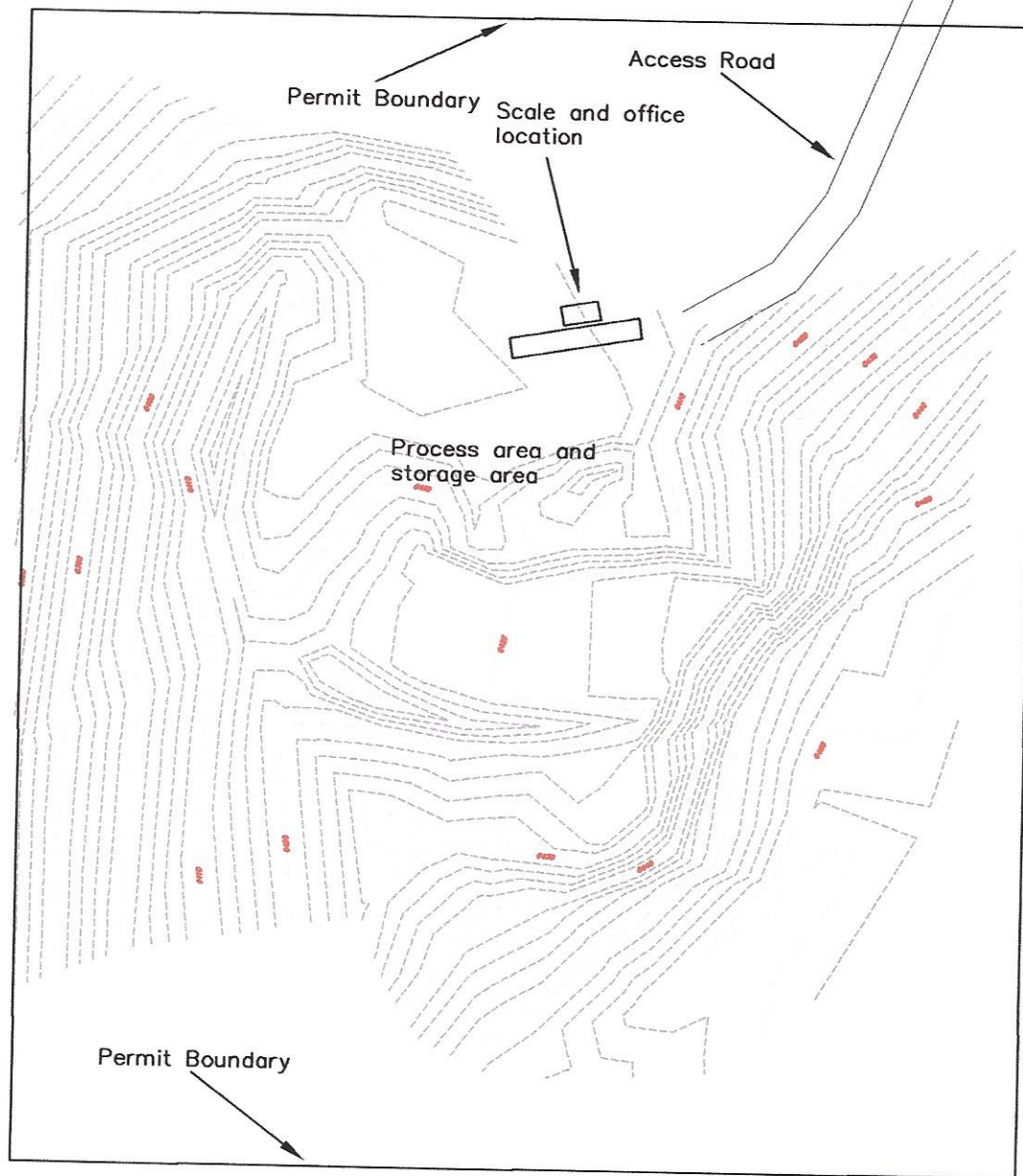

Map prepared by:

Steve Baker

Steve Baker 6-23-17