

110c Annual Report

<p>RECEIVED</p> <p>MAR 22 2016</p> <p>DIVISION OF RECLAMATION, MINING & SAFETY-MINERALS</p> <p>FEE REPORT MAP</p> <p>(DRMS Office Use Only)</p>	Permit Number:	M-1980-012
	Permittee Name:	Park County
	Operation Name:	Valley of the Sun
	County:	Park
	Anniversary Date:	April 1, 2016
	Current Bond Amt:	\$0.00
	Annual Fee Due:	\$323.00
	Permit Acreage:	2.50
	DRMS Specialist	MAC

According to C.R.S. 34-32.5-116 or 34-32-116, each year, on the anniversary date of the permit, an operator shall submit the Annual Fee, an Annual Report and map showing the extent of current disturbances to affected land, required monitoring information, reclamation accomplished to date and during the preceding year, any new disturbance that is anticipated to occur during the upcoming year, any reclamation that will be performed during the upcoming year, the dates for the beginning of active operations, and the date active operations ceased for the year.

Information contained in this report will be reviewed by the Division upon receipt and prior to the next compliance inspection of the site. If, while completing this report, you learn that your site is not in compliance with the rules and the act, it is advisable that the issues be rectified promptly to avoid possible enforcement action.

1. Is the site identification sign posted in accordance with Rule 3.1.12(1)? YES NO
2. Is the affected area boundary clearly marked in accordance with Rule 3.1.12(2)? YES NO
3. Is the mine site in final reclamation (all material extraction and stockpile removal is complete)? YES NO
If "YES," please note time limits related to completion of reclamation, Rule 3.1.3.
4. What was the date of last excavation, processing or hauling activity at the mine? Unknown
5. Does the mine operate more than 180 days per year YES NO
If "NO", please review Rule 1.13 to assure that your mine is in compliance.
6. Has this mine been granted: YES NO
a) approval of TEMPORARY CESSATION Status? YES NO
b) approval for INTERMITTENT OPERATION?
7. Number of acres currently affected (mining + incomplete and or unreleased reclamation): 2.486
8. Number of acres that were newly affected during the current report year: 0
9. Number of acres that were reclaimed during the current report year: 0
10. Estimated new acreage to be affected in the next report year: 0
11. Estimated acres to be reclaimed in the next report year: 0
12. **Total acres** in various stages of reclamation, since permitted mining activities began:

Total acres backfilled:		Total acres seeded w/ approved mix:		Total acres w/topsoil replaced:		Total acres mulched w/ approved mulch:	
Total acres graded:		Total acres fertilized w/ apvd fertilizer:		Topsoil replacement depth (in.):		Mulch application rate (tons):	
Seed application method:		Fertilizer application method:		Mulch application method:			

13. Is weed control being conducted in accordance with an approved Weed Control Plan? YES NO N/A
If "YES", indicate the weed species, control area, control type, application rate and treatment date on the report map.
14. Is adequate topsoil reserved for reclamation, based on your approved permit? YES NO N/A
If "NO", please explain:
15. Is the reserved topsoil vegetated/stabilized in accordance with Rule 3.1.9(1)? YES NO N/A
If "NO" please explain:
16. If mining has exposed groundwater, is the site in compliance with the approved mining plan and Office of the State Engineer (Well Permit, S.W.S.P., and/or Permanent Augmentation Plan)? YES NO N/A
17. Are all hazardous materials stored within approved spill containment structures? YES NO N/A
18. Is your financial warranty value sufficient to cover the cost to complete reclamation? YES NO N/A
19. Is your basis for legal right to enter still valid? YES NO
20. Does your permit require you to submit monitoring information annually? YES NO N/A
If "Yes", please attach the required monitoring results to this Annual Report.
21. As required by Colorado Mined Land Reclamation Act and/or Colorado Land Reclamation Act for the Extraction of Construction Materials (C.R.S. 34-32-116 or 34-32.5-116), attach a map to this report that accurately depicts the permit boundary, current affected area boundary and location of the acreages specified in items 7- 12 and 14. UPDATED

MAP ATTACHED:

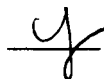

Division records indicate the following permittee contact information. If this information is not current, please type or print **current** contact information:

Permittee Contact:	Tammie Crawford	
Permittee Company:	Park County	
Address:	P.O. Box 147 Fairplay, CO 80440	
Phone Number:	(719) 836-4283	
Fax Number:	(719) 836-4275	
Email Address:	Tcrawford@parkco.us	

I, the undersigned, hereby state that the information provided in this report is true and accurate, and that site operations are being conducted in accordance with the Division approved mining and reclamation plans.

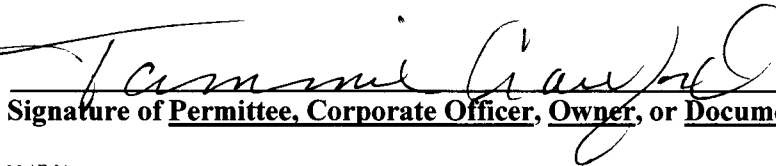
Signature of Permittee, Corporate Officer, Owner, or Documented Designee

Date

SPADCO STATE HIGHWAY NO. 9
(100' P.O.V.)

S 88°21'47" E
238.61

S 54°22'06" E
73.51
E INTERSECTION SURVEY LINE

No Disturbance in 2014

NW 1/4 NE 1/4 SE 1/4 SW 1/4
SECTION 29, T. 9 S., R. 77 W.
RECLAMATION GRAVEL PERMIT # M-80-012
2.486 ACRES

NOTES:

"BASIS OF BEARINGS"

THE EAST LINE OF THE NW 1/4 NE 1/4 SE 1/4 SW 1/4 WHICH BEARS N 00°31'08" E (ASSUMED) MONUMENTS AS SHOWN ON THIS PLAT

"BASIS OF BEARINGS"
S 00°31'08" W
292.00

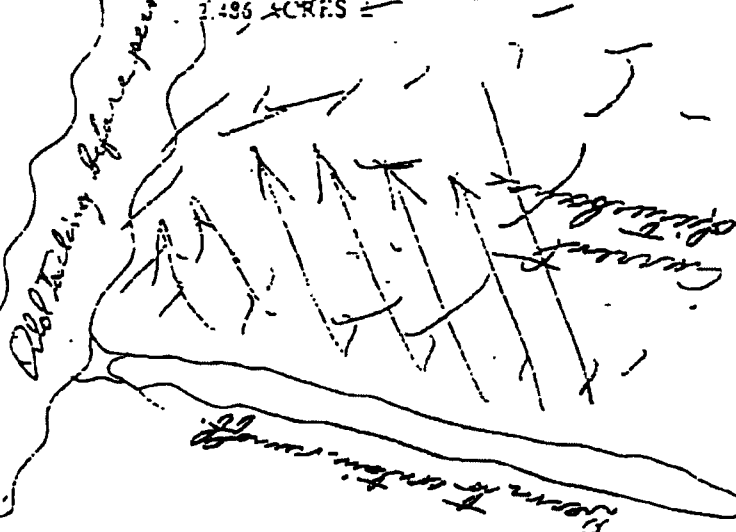

N 88°27'52" W
129.65

N 79°02'00" E
124.00

TITLE INFORMATION WAS PROVIDED BY THE CLIENT AS FOLLOWS

Valley of the Sun Pit

M 1980 012

RECEIVED

MAR 22 2016

DIVISION OF RECLAMATION



Park County Public Works Department

1246 CR 16 P.O. Box 147
Fairplay, Colorado 80440
719-836-4283 (office), 719-838-0560 (cell)
Tcrawford@parkco.us

March 16, 2016

Division of Reclamation, Mining and Safety
Attn: Michelle Ramirez
Department of Natural Resources
1313 Sherman St. Room 215
Denver CO 80203

Re: Valley of the Sun Pit, Permit M 1980-012, Annual Report & Fee

Ms. Ramirez,

Please find attached the Annual Report for the Valley of the Sun Pit, Permit M 1980-012.

This pit was not used in 2015 and will be reviewed to place in reclamation in 2016.

Please let me know if there is any further information needed.

Thank you,

Tammie Crawford
Transportation Manager

Park County
Public Works Department

2016

VOUCHER

Prepared by: cc

COMPANY: DIVISION OF RECLAMATION, MINING & SAFETY

ADDRESS: 1313 SHERMAN ST ROOM 215

CITY: DENVER STATE: CO ZIP: 80203

DATE: March 7, 2016

PRESENT OF EXPLANATION	AMOUNT
Pit Fees	
Permit: M-1995-021, Chapparral Pit	\$ 323.00
Permit: M-1986-140, Wright Pit	\$ 323.00
Permit: M-1980-013, Elkhorn Springs Pit	\$ 323.00
Permit: M-1977-365, Sulphur Mtn Grav Pit	\$ 323.00
Permit: M-1980-014, Eleven Mile Pit	\$ 791.00
Permit: M-1980-019, Hall Gulch Pit	\$ 323.00
Permit: M-1980-012, Valley of the Sun Pit	\$ 323.00
Permit: M-1980-252, Jefferson Flat Pit	\$ 791.00
Permit: M-1980-251, Ansley Flat Pit	\$ 323.00

PLEASE RETURN CHECK TO PUBLIC WORKS. DO NOT MAIL.

TOTAL	\$ 3,843.00

Approval	Account Code	Amount
Department:	11.3141.645200	\$ 3,843.00
Bocc:		
Bocc:		
Bocc:		
Vendor #	4975	
Oblig. #		
Warrant #		
	TOTAL	\$ 3,843.00

PARK COUNTY

VOID 90 DAYS AFTER DATE OF ISSUE

62-340

ROAD & BRIDGE 3,843.00

BY ORDER OF BOARD OF COUNTY COMMISSIONERS
P.O. BOX 1373
FAIRPLAY, COLORADO 80440
719-836 4206

ALPINE BANK
GLENWOOD SPRINGS CO 81601

DATE

CHECK NO

AMOUNT

03/10/2016

\$3,843.00

THREE THOUSAND EIGHT HUNDRED FORTY THREE AND 00/100 DOLLARS

PAY TO
THE
ORDER
OF

DIVISION OF RECLAMATION
MINING & SAFETY
1313 SHERMAN ST ROOM 215
DENVER CO 80203

CHAIRMAN BOARD OF COUNTY COMMISSIONERS

ATTEST

COUNTY CLERK

VENDOR 004975 DIVISION OF RECLAMATION

03/10/2016

Warrant

FUND & ACCOUNT

P.O.#

INVOICE

DESCRIPTION

AMOUNT

M PMTS

ANNUAL FEE

3,843.00

TOTAL

3,843.00



COLORADO

Division of Reclamation,
Mining and Safety

Department of Natural Resources

1313 Sherman St. Room 215
Denver, CO 80203

RECEIVED

MAR - 4 2016

BY: Cmc



March 1, 2016

Tammie Crawford
Park County
P.O. Box 147
Fairplay, CO 80440

Valley of the Sun, Permit M-1980-012, Annual Fee Invoice and Report Request

PLEASE READ CAREFULLY – ACTION REQUIRED

Please attach your COMPLETED written Annual Report and Annual Report Map to this form

Under the terms of your Reclamation Permit and Colorado Statutes, you must submit an Annual Fee and Annual Report (including a map). You must pay the Annual Fee and submit an Annual Report each year until reclamation responsibility release is granted. The Annual Fee is not a renewal fee. The Fee and Report are for LAST YEAR'S mining and reclamation season, and MUST be paid even if your operation was inactive.

The Annual Report and Fee requirement will be considered submitted when we have received the following components:

1. APPROPRIATE ANNUAL FEE
2. COMPLETED ANNUAL REPORT
3. ASSOCIATED MAP as required by rule

If you have requested reclamation responsibility release from the Division of Reclamation, Mining and Safety (the "Division") but your permit is not released by the anniversary date listed below, the Annual Fee MUST be paid. If the permit is released before the anniversary date, then by Statute, it is not necessary to pay an Annual Fee or submit an Annual Report for that year.

Division records indicate the \$323.00 fee is due for the following:

Permit: M-1980-012
Operation Name: Valley of the Sun
Anniversary Date: April 1, 2016
Total Fee Due: \$323.00 (Due on or before your Anniversary Date)

Return the enclosed Annual Report FORM, a MAP, and a CHECK or MONEY ORDER made payable to: Division of Reclamation, Mining and Safety, 1313 Sherman St., Room 215, Denver, CO 80203. If your records indicate these documents and fees have already been submitted, please notify the Division.

If you have additional comments and/or information that should be provided to the Division, please provide it below or attach it to this form along with your written report and map. Annual Report instructions are enclosed. If you have

any questions, please feel free to contact Scottie Tate ((303) 866-3567 ext 8166) or Michelle Ramirez ((303) 866-3567 ext 8114). Thank you for your cooperation in this matter.

IF THE ANNUAL FEE SUBMITTALS ARE NOT RECEIVED ON OR BEFORE YOUR ANNIVERSARY DATE, THE ENFORCEMENT PROCESS WILL BE AUTOMATICALLY INITIATED. ENFORCEMENT ACTIONS MAY RESULT IN CIVIL PENALTIES AND/OR REVOCATION OF YOUR PERMIT.

Division of Reclamation, Mining, and Safety

Fee Receipt for M1980012

Park County

000000000

Receipt #: 21207

Date: 04/01/2016

Permit: M1980012

Payment Method	Revenue Code	Fee Description/Notes	Amount
026580 msr	4300-MAF0	Minerals Annual Fees M1980-012	\$323.00
Receipt Total:			\$323.00