

EXHIBIT P

Owner of record of the affected
land and mineral to be mined.

The county court records of Garfield County were researched for ownership. The mineral to be mined is under mineral claim on Federal BLM Land. The claims are legally recorded and filed in Garfield County.

The entire area affected is included in Federal Land. The surface area to the west is privately owned. These are depicted on the accompanying map.

EXHIBIT P

Owner(s) of Record

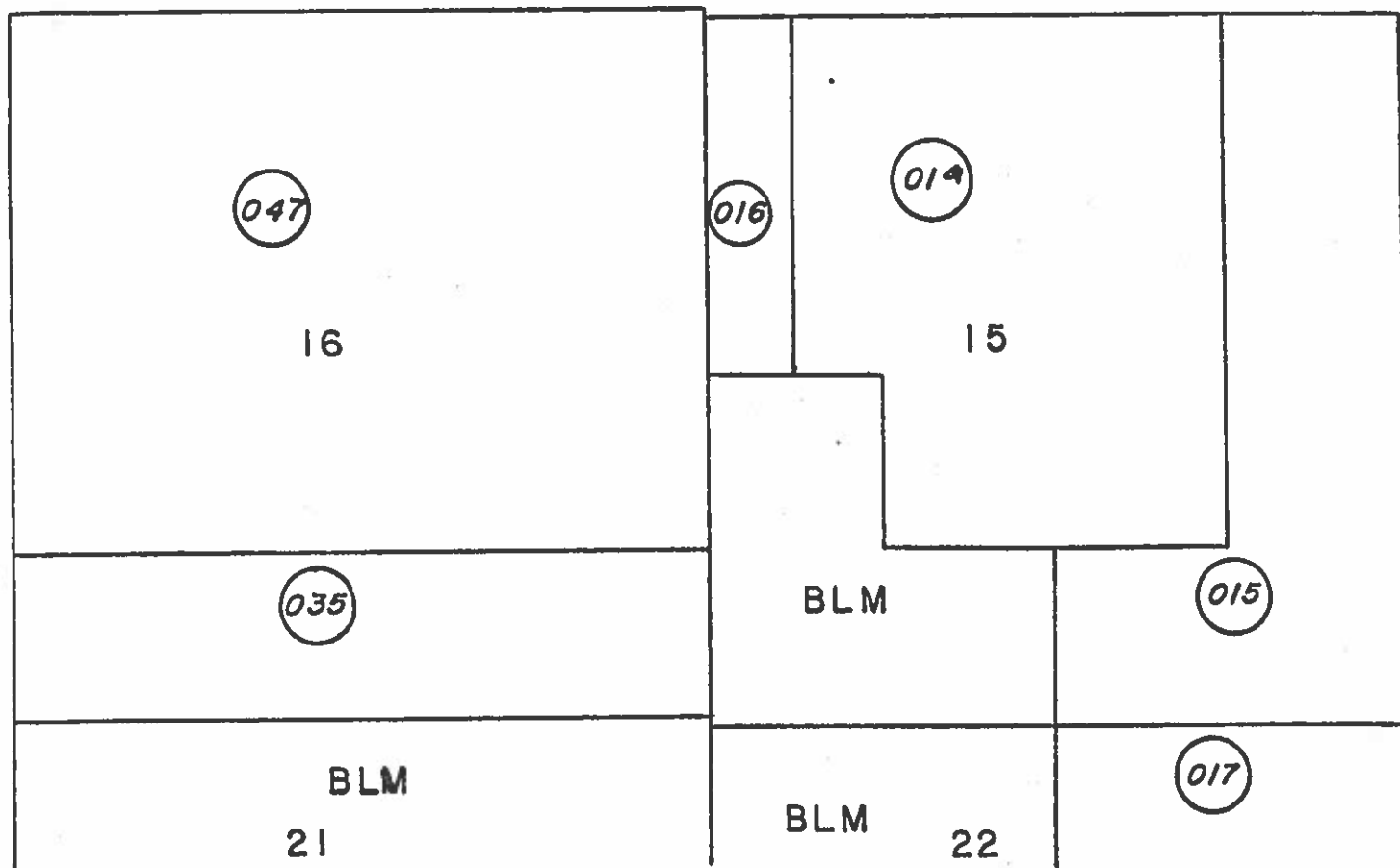

- 14 - Thurlow, R.J. Sr. & R.J. Jr., 421 Colorado Avenue, Grand Junction, CO 81501.
- 15 - State of Colorado Game and Fish.
- 16 - Coulter, Harold M. & Phillis V., 5908 Highway 325, Rifle, CO 81650.
- 17 - State of Colorado Game and Fish.
- 35 - Jones-Wade-Peters - A Partnership. Sect. 16, S 1/2, S 1/2.
c/o I. H. Peters, 927 American National Bank Bldg., Denver, CO 80202.
- 47 - Schaefer, Allen A., 3900 Morrison Road, Denver, CO 80219.