

RECEIVED

JAN 06 1995

GRAND JUNCTION FIELD OFFICE
DIVISION OF
RECLAMATION MINING & SAFETY

Structure Agreement

This letter has been provided to you as the owner of a structure on or within two hundred (200) feet of a proposed mine site. The State of Colorado, Division of Reclamation, Mining and Safety ("Division") requires that where a mining operation will adversely affect the stability of any significant, valuable and permanent man-made structure located within two hundred (200) feet of the affected land, the Applicant shall either:

- a) Provide a notarized agreement between the Applicant and the Person(s) having an interest in the structure, that the Applicant is to provide compensation for any damage to the structure; or
- b) Where such an agreement cannot be reached, the Applicant shall provide an appropriate engineering evaluation that demonstrates that such structure shall not be damaged by activities occurring at the mining operation; or
- c) Where such structure is a utility, the Applicant may supply a notarized letter, on utility letterhead, from the owner(s) of the utility that the mining and reclamation activities, as proposed, will have "no negative effect" on their utility. (*Construction Materials Rule 6.3.12 and Rule 6.4.19 & Hard Rock/Metal Mining Rule 6.3.12 and Rule 6.4.20*)

The Colorado Mined Land Reclamation Board ("Board") has determined that this form, if properly executed, represents an agreement that complies with Construction Materials Rule 6.3.12(a), Rule 6.4.19(a), and C.R.S. § 34-32.5-115(4)(e) and with Hard Rock/Metal Mining Rule 6.3.12(a), Rule 6.4.20(a), and C.R.S. § 34-32-115(4)(d). This form is for the sole purpose of ensuring compliance with the Rules and Regulations and shall not make the Board or Division a necessary party to any private civil lawsuit to enforce the terms of the agreement or create any enforcement obligations in the Board or the Division.

The following structures are located on or within 200 feet of the proposed affected area:

1. Irrigation Ditches
2. Fences + gates
3. USGS Gauging Station
4. _____
5. _____

(Please list additional structures on a separate page)

CERTIFICATION

The Applicant, C+B Sand and Gravel Inc (print applicant/company name),
by Donald R Corson (print representative's name), as President (print
representative's title), does hereby certify that _____ (structure owner) shall
be compensated for any damage from the proposed mining operation to the above listed structure(s)
located on or within 200 feet of the proposed affected area described within Exhibit A, of the Reclamation
Permit Application for C+B Sand and Gravel Inc (operation name),
File Number M- 2007 058

*This form has been approved by the Colorado Mined Land Reclamation Board pursuant to its
authority under the Colorado Land Reclamation Act for the Extraction of Construction Materials and
the Colorado Mined Land Reclamation Act for Hard Rock, Metal, and Designated Mining Operations.
Any alteration or modification to this form shall result in voiding this form.*

NOTARY FOR PERMIT APPLICANT

ACKNOWLEDGED BY:

Applicant _____ Representative Name Donald R Corson
Date _____ Title President

STATE OF Wyoming)
COUNTY OF Carbon) ss.

The foregoing was acknowledged before me this 30th day of September, 2015, by
DONALD R CORSON as PRESIDENT of C+B SAND + GRAVEL.

Alethea Foster My Commission Expires: 6/18/18
Notary Public

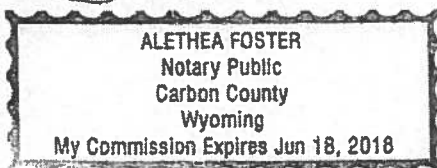

NOTARY FOR STRUCTURE OWNER

ACKNOWLEDGED BY:

Structure Owner J & Glynda Sheehan Name J & Glynda Sheehan

Date Oct 28 / 2015 Title Owner

STATE OF Wyoming)
) ss.

COUNTY OF Carbon)

The foregoing was acknowledged before me this 28th day of OCTOBER, 2015, by

J & GLYNDA SHEEHAN as OWNER of _____.

[Signature]
Notary Public

My Commission Expires: 10/18/18

**Baxter Ranch LLC
J and Glynda Sheehan
P.O. Box 55
Slater, Co 81653**

RECEIVED

JAN 06 2016
GRAND JUNCTION FIELD OFFICE
DIVISION OF
RECLAMATION MINING & SAFETY

January 6, 2016

Via email

C&B Sand and Gravel,

This letter serves as permission to store no more than 20 gallons (4x 5 gallon containers) of hydrocarbon/petroleum products (i.e. hydraulic oil and/or grease) at the Sheehan Pit (T12N, R89W, Sec 21, NW1/4 of SW1/4 of NE1/4) on location in a portable storage building. Products will be stored in spill containers to prevent any contamination of premises and a 'spill kit' will be available inside building. No diesel or gasoline will be stored on Sheehan Pit location.

Baxter Ranch LLC is not responsible for any container spills and/or clean up required of a spill. Building and all products will be removed from the location following completion of contract.

Baxter Ranch LLC
J Douglas Sheehan



Glynda S. Sheehan



**AFFIDAVIT OF PUBLICATION
CRAIG DAILY PRESS**

**STATE OF COLORADO
COUNTY OF MOFFAT**

I, Diane Hutton, do solemnly swear that I am Legal Notice Representative of the Craig Daily Press, that the same is a daily newspaper printed, in whole or in part, and published in the County of Moffat, State of Colorado, and has a general circulation therein; that said newspaper has been published continuously and uninterruptedly in said County of Moffat for a period of more than fifty-two weeks prior to the first publication of the annexed legal notice or advertisement; that said newspaper has been admitted to the United States mails as second-class matter under the provisions of the Act of March 3, 1879, or any amendments thereof, and that said newspaper is a daily newspaper duly qualified for publishing legal notices and advertisements within the meaning of the laws of the State of Colorado. That the annexed legal notice or advertisement was published in the regular and entire issue of every number of said daily newspaper for the period of 1 consecutive insertions; and that the first publication of said notice was in the issue of said newspaper dated 12/25/2015, and that the last publication of said notice was in the issue of said newspaper dated 12/25/2015.

Diane Hutton

Subscribed and sworn to before me, a Notary Public in and for the County of Moffat,

State of Colorado

the 25th day of Dec. A.D. 2015

Holly Hunter
Notary Public

Customer #: 10032266
Order #: 10416730
Customer Name & Address: C & B SAND & GRAVEL
PO BOX 147
BAGGS, WY 82321

Publication Charges \$ 61.11

HOLLY HUNTER
NOTARY PUBLIC
STATE OF COLORADO
NOTARY ID 20054032733
MY COMMISSION EXPIRES 08/19/2017

11724 1

Public Notice

C&B Sand and Gravel Inc.; PO Box 147, Baggs WY 82321, has filed an application for a Construction Materials Limited Impact (110) Reclamation Permit with the Colorado Mined Land Reclamation Board under provisions of the Colorado Land Reclamation Act for the Extraction of Construction Materials. The proposed mine is known as the Sheehan Pit, and is located at or near Section 21, Township 12.0, Range 89.0, Prime Meridian.

The proposed date of commencement is September 15, 2007, and the proposed date of completion is September 15, 2027. The proposed future use of the land is Rangeland.

Additional information and tentative decision date may be obtained from the Division of Reclamation, Mining, and Safety, 1313 Sherman Street, Room 215, Denver, Colorado 80203, (303) 866-3567, or at the Moffat County Clerk and Recorder's office; 221 W. Victory Way, Suite 200, or the above named applicant. A complete copy of the application is available at the above-named County Clerk and Recorder's office and at the Division's office.

Comments concerning the application and exhibits must be in writing and must be received by the Division of Reclamation, Mining, and Safety by 4:00 p.m. on January 4th, 2016.

Please note that under the provisions of C.R.S. 34-32.5-101 et seq. Comments related to noise, truck traffic, hours of operation, visual impacts, effects on property values and other social or economic concerns are issues not subject to this Office's jurisdiction. These subjects, and similar ones, are typically addressed by your local governments, rather than the Division of Reclamation, Mining, and Safety or the Mined Land Reclamation Board.

Published in the Craig Daily Press
Publication Date: December 25, 2015

10416730

RECEIVED

JAN 05 2016

GRAND JUNCTION FIELD OFFICE
DIVISION OF
RECLAMATION MINING & SAFETY

RECEIVED

NOV 02 2016

GRAND JUNCTION FIELD OFFICE
DIVISION OF
RECLAMATION MINING & SAFETY

Affidavit of Receipt

We, J Douglas & Glynda S. have received upon this day the 6 of
December, 2015 a copy of the public notice for permit # M 2007-058 that was ran in the Craig Daily
Press. January 2016

J Douglas Sheehan

Signature

1.6.2016

Date

Glynda S Sheehan

Signature

1.6.2016

Date

The foregoing was acknowledged before me this 6th JANUARY 2016 day of December, 2015, by

J DOUGLAS SHEEHAN and GLYNDA S SHEEHAN of Baxter Ranch LLC.

Alethea Foster

Notary Public

My Commission Expires: 10/18/18

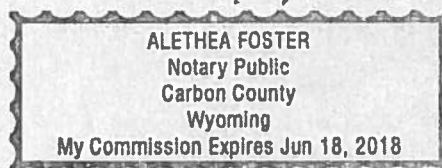

RECEIVED

JAN 06 2016
GRAND JUNCTION FIELD OFFICE
DIVISION OF
RECLAMATION MINING & SAFETY

Via email

JAN 06 2015

GRAND JUNCTION FIELD OFFICE
DIVISION OF
RECLAMATION MINING & SAFETYExhibit C – Mining Plan

(a) Mining Dates

Mining will commence upon completion of the entire permitting process, which may be on or before September 15, 2007. Mining is anticipated to last of 20 years with an initial possible immediate production of 20,000 to 30,000 ton during the first year. Production at the site will be mainly for rip-rap and larger boulders for river stabilization projects. The site is remote with a limited commercial market and rock and boulder production for local projects may place as materials are needed and then selectively scaled from the outcrop.

Mining will begin along the reclaimed margins of the previous DRM&S Permit # M-1994-022. The flatter elevation area at the top of the access ramp will be used as before for an operations/temporary stockpiling area. Mining will start and follow the limits of the previously disturbed areas and will move along the general existing slope and (rock) high-wall (very slowly) extending the disturbed area to the west and north. The fractured and weathered rock (possible upper 2 to 4 feet to solid un-weathered bedrock) will be removed off the slopes or scaled off eh more sheer faces as/when necessary. Due to the nature of the outcrop, the sheer faces and limited annual production from the site the total disturbed area at the end of 20 years would be less than 6 acres. (Note: the 20 yr. limit line on Exhibit E Map)

Process equipment operation at the site would be temporary. The operations area is restricted so equipment may be mobilized as contracted material or stockpiles are needed. Estimated mining activities at the site would average less than 180 days per year. The number of days the mine operates depends on demand for the material that are sold. As demands increase the days of operation increase, as the demand decreases the days of operations will also decrease. Weather such as cold, rain, snow, and heat will affect days of operation. These materials are used mainly for river stabilization projects.

(b) Topsoil – soil suitable as a plant growth medium

All of the soil within the 8.14 proposed permit area, as mapped and described by the U.S.D.A. Soil Conservation Service in this area of Moffat County consists of soils belonging to the **Ustorthents, Fridgid – Borolls Complex, 25 – 75% slopes**. These soils at the site are very well drained and have very little water holding capacity. Soil depth is shallow and thin and grades to un-weathered bedrock. Permeability is slow and runoff is high. Due to the steep slopes and limited soils and vegetation the area is unsuitable for livestock grazing although wildlife and livestock do occasionally use some of the side and upper slopes. There is very little topsoil/surface soil at the site. The proposed mine area is predominately weathered basalt outcrop and bedrock and has been assigned a “none” rating as an ecological site by the NRCS. Any and all topsoil and/or suitable surface material including some possible crusher fines will be reserved for site reclamation. The folded bedded basalt outcrop material at the site forms very high angle slopes and cliffs of bare rock with no topsoil. (see photos)

All of the soil within the .62 proposed permit storage area the **Evabot Yamo Complex** of soil is a loam soil that has H1 – H3 as a loam soil that is 60” deep. With the depth of topsoil being that deep and being a storage area and not a mining area the plan is to clean up all the storage from the surface with 2-3 inches of topsoil removal. Removed topsoil will be wind rowed on the south side of the storage area. After the removal of all stored material the soil surface will be ripped, disced and the stored top soil will be bladed onto the disturbed site. The disturbed site will be seeded.

(c) Thickness of overburden or quantity of waste rock

Overburden within the 8.14 proposed permit area is minimal and is sufficient quality (fractured and weathered basalt mixed rock) to be used in base course and fill material. Material below the salvageable surface/topsoil horizon will be mined and hauled unless used onsite for access ramps or storm-water berms. There will be no stockpiles of waste rock or overburden. Boulders and large rip-rap may be mined and/or scaled from steeper areas as needed. Some scaling and rock fall mitigation will be done as necessary on the

higher angle slopes and cliffs above the county road. Rock fall and slide rock will be collected from the slope toe and roadside to assist in county maintenance.

(d) Thickness of deposit to be mined

Material to be mined consists of the upper fractured and weathered surfaces of the basalt outcrop and loose rock from sheer faces and gullies on the outcrop. The fractured and weathered rock (possible upper 2 to 4 feet to solid un-weathered bedrock) will be removed off the slopes or scaled off the more sheer faces as/when necessary. As stated above in (c); some scaling and rock fall mitigation will be done as necessary on the higher angles slopes and cliffs above the county road. Rock fall and slide rock will be collected from the slope toe and roadside to assist in county maintenance. Rock-fall cleaned from the road would be moved to the operations area for temporary stockpiling. The unweathered bedrock is 170' high wall and runs in variable thickness seams and intermixed with soil. The depth/elevation will be mines to 6600 feet, level on the mine floor. Approximately 100 -120 feet of unweather rock to be removed.

(e) Major components of the mining operation.

1. Access to the site will be off Moffat County Road 1 using the land owner's private road/ramp, which was used for the previous site mining operation, to access the site operations area. This access will be utilized for the duration of the mining activities. The access will also be part of the Moffat County Special Use Permit.
2. The 1.34 acre "previously mined area" will be used for temporary process operations and stockpiling. In the future if demand for rock is needed we will mine under the previous mined area.
3. There is no shop, office or maintenance buildings presently onsite. There is a small storage shed used for tool and oil storage.
4. There are plans to provide for portable crushing or screening plants to process material at this site as needed. All material will be handled onsite using tracked excavators, bulldozers and front-end loaders to temporarily stockpile and load to haul trucks. Material stockpiles may be temporary or may be produced and reduced on a daily basis and will be conveniently located adjacent to active mine pit areas as excavation activities precede. The .62 acre site which is 500 feet to the west of the 8.14 acres of Moffat County Road 1 will be used to store stockpile materials.
5. There will be no underground opening such as ventilations facilities or adits. The operations will be an open pit operation. The permit boundary is located right next to Moffat County Road 1. As we move the material away from the County Road we will load trucks in permit boundary.

(f) Dimensions of any significant disturbance to land surface

1. Mining will start at and follow the limits of the previously disturbed area (1.34 acre) and will move along the general existing slope and (rock) high-wall (very slowly) extending the disturbed area to the west and north. The fractured and weathered rock (a possible upper 2 to 4 feet to solid un-weathered bedrock) will be removed off the slope or scaled off the more sheer faces as/when necessary. Due to the nature of the outcrop, the sheer faces and limited annual production from the site the total disturbed area at end of 20 years would be less than 6 acres. (Note: the 20 yr. limit line on Exhibit E Map) including the current 1.34 previously mined. Slopes would be 3:1 or less when possible, however remnant high-walls will resemble the current steep to sometimes vertical in places outcrop profile.
2. Since the bedrock runs in seams the benches are variable. (ex. Seam we are working on now is 60' – 5' wide and the depth is not yet determined. The bench width will be from 60' – 15' in width. The depth of the bench will vary depending on the depth of the seam of the rock. The depth has been 38'- 40' in height and will vary from a straight high wall to a slope because of loose rock and fines at the site. The hard rock is mined from top of the mine site down in 40' increments.

3. Material stockpiles could be temporary or produced and reduced on a daily basis and will be conveniently located adjacent to the active mine area as excavation activities proceed or on land next to the mine site owned by land owner.

The stockpile material will be stored on the .62 acre site which is 500' to the east of the 8.14 site area. The processed material will be stored 207'x207'x12' high, stacked with a haul truck and loader with a 2 to 1 slope.

4. The 8.14 proposed permit area is mostly a rock outcropping with very little fines as shown in the picture. The fines have been used to help make benches to mine the solid rock. If too many fines are in the way they will be moved to the .62 acre site or stored for reclamation.

- (g) Dimensions of any existing or proposed roads that will be used for the mining operations.

The existing private road/ramp accesses the owners property at the southeast side of the proposed permit area is 15 feet wide and has a good gravel surfaces. Total length up and into the operations area is approximately 150 feet. Silt fences and sediment retentions berms or ditches will be maintained alongside road and excavation area to reduce erosion and limit runoff from storm events. Besides the access road/ramp there are no other new or improved roads to be included as part of the permitted acreage.

The road to the .62 acres storage site is approximately 500' East of the main 8.14 acre mining site along Moffat County Road 1. The access road is approximately 30 ft wide with a good gravel road covering a 12' pipe. The length of the access road off Moffat County Road 1 is 50' to the landowners fence and private land.

- (h) Water to be used in conjunction with the operations and the source. Water will be used for dust control if needed.

Water required, if any, would be for occasional watering of the haul road and ramp areas. It is estimated that 1000 to 2000 gallons of water per day would be necessary for watering haul roads and ramp areas depending on weather conditions and the length of haul road. The owner has sufficient available water rights to supply this minimal amount. The water for dust control will be from the Morgan Slater Ditch which is held by the Baxter Ranch with J and Glynda Sheehan as owners. The water will be used for dust control.

- (i) Ground water encountered and /or surface intercepted

As stated in Site Description (c), this will be a dry pit operation with no effect on water rights, drainage or hydrology of the area. No surface will be intercepted disturbed or stored in the pit area. Silt fences and sediment retention berms or ditches will be maintained alongside roads and excavation areas to reduce erosion and limit runoff from storm events.

- (j) Compliance with applicable Colorado water laws and regulations governing injury to existing water rights.

See (i) about and Site Description (c).

- (k) Refuse and acid forming or toxic materials exposed handling and disposal.

No refuse and acid forming or toxic materials will be involved in this operation. The operation will be a dry pit operation producing boulders, rock, sand, gravel, and soil materials with no chemicals required for processing and refuse will not be generated. Rock, Sand and gravel are basically inert materials.

- (l) Measures to minimize disturbance to the hydrological balance, prevent offsite drainage, and provide for a stable configuration of the reclaimed area consistent with the proposed future land use.

The hydrologic balance issue has been addressed previously in Site Description (c), and items (i) and (j) above. A stable configuration will be accomplished by the 3:1 back slopping of the pit faces on the west and northwest sides of the pit area into the more sheer rock high-walls.

- (m) Specify whether the deposit will be processed on-site.

As stated in (e) 4 above, there are plans to provide for a portable crusher or screening plant to process material at this site. All material will be handled onsite using tracked excavators bulldozers and front-end loaders to temporarily stockpile and load to haul trucks. Material stockpiles may be produced and reduced on a daily basis or will be conveniently located adjacent to or on land owned by owner which is next to the active mine pit areas as excavation activities proceed. One storage shed will be on proposed site. Hydro carbons will be stored in storage shed.

- (n) Primary and secondary commodities to be mined/extracted and intended use.

The primary commodities to be mined onsite will be large boulders, rock, and crushed rock for sand and gravel and backfill soil. The intended use of these materials will be as river stabilization boulders, structural rip-rap, crushed rock and road gravel base course and fill material for road construction activities. There are no secondary commodities to be mined and/or extracted at this site.

- (o) Incidental products to be mined and/or extracted.

There are no incidental products to be mined and/or extracted by the proposed operations

- (p) Blasting

Blasting will be used to loosen rock so it may be moved with tracked excavators, bulldozers and front-end loaders. An outside third party will be hired for blasting.

On recommendation by Division of Reclamation Mining and Safety the geotechnical stability exhibit will not be required because of the location and type of rock.

RECEIVED

JAN 06 2011

GRAND JUNCTION FIELD OFFICE
DIVISION OF
RECLAMATION MINING & SAFETY

Exhibit D – Reclamation Plan

(a) Timing, procedure, criteria and materials for overburden replacement

As stated above in Exhibit C – (c) overburden is minimal and is sufficient quality to be used as a course and fill material. Fractured/weathered basalt blocks and un-graded talus/colluvial material will be mined and hauled unless used onsite for the access ramps or storm-water berms. There will be no stockpiles of waste rock or overburden. Any topsoils/usable surface material or usable crusher fines will be stockpiled for reclamation. If topsoil stockpiles are to be left for more than 1 growing season, they will be seeded with the recommended seed mix provided by the DRM&S for the M-1994-022 permit. (DMG 5-12-94 Pre-Operation Inspection Report, attached) Mr. Charles Peacock (and the SCD Supervisors) with the Colorado First SCD-NRCD in Craig, Colorado, have been contacted as to comments and recommendations. A copy of the DRM&S Reclamation recommendations made for the previous operator was sent for SCD approval. The SCD recommendation is to continue to use the DMG's 5-12-94 recommendations. Find copies of the communication with SCD in Exhibit J- Mailing Notices

Reclamation will commence when the floor of the pit is level with County Road 1 on the 8.14 acre site, which is 6600 feet level on the elevation map. Overburden is minimal so it will be spread with a trackhoe, loader or dozer. If it is to be hauled it will be loaded into trucks. Since overburden is minimal it will be spread at a 4 inch depth on 65% of the mining disturbance, especially on flats surfaces and unconsolidated surfaces.

The .62 acre site will be reclaimed when it will not be needed as a storage site. The site will have the top 2-3 inches of topsoil removed and wind rowed with a blade to the south side of the storage site.

(b) The maximum gradient of reclaimed slopes.

The maximum gradient of reclaimed slopes will be 2:1. These slopes will be located along the western and northern pit perimeters as shown on the Exhibit E – Reclamation Plan Map, and will have an average slope length of 30 to 40 feet. These slopes are expected to grade into possible high angle to near vertical un-weathered outcrop similar to the current reclaimed existing site topographic profile only slightly expanded to the west and north of the 1.34 "previously mined and reclaimed area" shown on the map and photographs. Possible total length of stabilized un-weathered high angle slopes to sheer face high wall along the (western and) mostly north side of an ultimate 6 acre disturbed area would be approximately 500 feet in length. The residual high wall would be located generally along the "east-west" 20 year limit line shown on the Exhibit E Map.

The vertical walls will be left vertical walls, and will not be seeded. The 2:1 slopes with fines and rock will be hydro seeded according to the specification. The 3:1 slopes in non-consolidated material will have a high percent of rock with very little fines and it will be hydro seeded. The 8.14 acres to be mined is not fenced. The proposed slope configuration for the .62 acre stockpile area is the slope that is present now.

(c) Specific measures to be taken to re-vegetate the site.

1. Stockpiled surface material is minimal so it will be spread even. Fines and useable other crusher fines will be replaced over the final grade surface on the lower grade slopes and flatter operations area. Steep higher angle slopes and rock face will be mined at this time to un-weathered rock and scaled and stabilized similar to the current site topographic profile.

The .62 acre storage area will have, 2-3 inches of top soil removed, which will be wind rowed on the south side of the disturbed area. The rock and other materials will be bladed with a blade and removed. The number of acres in the lower grade will be an estimated 2 acres and the flatter operation area will be an estimated 2 acres.

The quality of fines will not be soil sampled. At present, a healthy grass and shrub community are growing on the fines from the 1.34 acres that was previously mined and reseeded.

2. Any surface material/topsoil stockpiles will be seeded if left longer than one growing season. **The method of reclamation will be as per the attached pre-mine application recommendation supplies by the DRM&S for the M-1994-022 permit. (The 5-12-94 Pre-Operation Inspection Report): 2-ton of straw mulch/acre and weed control will be as necessary. Seedbeds will be firm and clean tilled as possible with the limited rocky surface material available at the site. Final slopes in unconsolidated material graded to no steeper than 2:1. Steeper slopes in competent bedrock may be steeper but should blend-in with the natural terrain and must be stable. All level areas and graded slopes to be seeded and vegetated.**

3. Species recommended or reclamation and Stockpiles: (Rate should be doubled for broadcast seeding)

6 Acres (8.14 acre site)

Bluebunch Wheatgrass	5.0 PLS per acre
Western Wheatgrass	2.9 PLS per acre
Crested Wheatgrass	2.0 PLS per acre
Indian Ricegrass	1.0 PLS per acre

Double if Broadcast

.62 Acre Storage Site Plue Stockpiles

Needle and Thread	5.5 PLS per acre
Western Wheatgrass	2.9 PLS per acre
Basin Wildrye	1.0 PLS per acre
Indian Ricegrass	1.0 PLS per acre

Double if Braodcast

A total of 10.9 PLS will be required per acre of reclamation on the 6.0 using a drill. (Rate should be doubled for broadcast seeding)

Stockpiled storage area, access roads and processing areas will be ripped and disced before seeding. No soil amendments or fertilizer will be used on the reclamation areas. As we observe the amount of fines at the mine site there will be adequate soil material to support plant growth. (Look at pictures of the site behind the final configuration for reclamation)

4. The seeding operation shall be drill seeded on the flat surfaces. **(but will more likely be hydro seeded due to steep rocky slopes)** As stated above in 2, **1-ton straw crimped mulch/acre and weed control will be surface material available at the site. Final slopes in unconsolidated material graded to no steeper than 3:1. Steeper slopes in competent bedrock may be steeper but should blend with the natural terrain and must be stable. All level areas and graded slopes to be seeded and vegetated.** The adjacent .62 acres is used as a storage area. A blade will be used to remove the top 2-3 inches and windrowed on the south side of the disturbed area. The storage site area will be ripped, disced and stored topsoil will be added to the

storage site. The site will then be drilled and mulched with above material. The site and seeding will be prepared and seeded in late Fall or early Spring with available moisture.

5. (a) The fines from the mine site will be moved no more than 150'. The volume is hard to estimate since we are working in rock walls. 400-500 yards of material will be with a dozer. 40 hrs at \$175/hr = \$7000. Hydro seeding will be used on the 6 acres that will be needed to be reclaimed. The cost is per acre which includes seed and equipment. Six acres is a high estimate that will be disturbed.
- (b) Trackhoes will be used to remove small debris and scale back rock. Sheer walls that are on the west and south will be left as is. We will not work under there as it is too dangerous. Rock scaling will take a trackhoe 1 day @\$500/day. Consolidate rock will meet final reclamation grade. The cost to remove shed is \$250 to pick up with skidsteer and loader and put on a trailer and haul to one of our other pits. Cost of installing permanent storm water controls is \$2500. No fence was ever constructed so a new one will not be constructed.
- (d) There will be no ponds, streams or other impoundments constructed as part of reclamation activities. The future use of the site is planned as rangeland/wildlife habitat. All permanent man-made structures shown on the Exhibit E and Exhibit L Maps will remain. There has never been a fence on the east boundary of the permit. So no fence will be built upon reclamation.
- (e) There will be no waste rock dumps, underground openings, and plant facilities constructed or used during the mining activities and as such no reclamation treatment is necessary for these items. Storage shed on the mine site will be removed for reclamation. Storm-water control features such as berms ditches and silt fences will be used as part of the active mining activities. Silt fencing will be removed prior to the final grade operation of reclamation and disposed of offsite. Berms, ditches and haul roads will be incorporated into the final grade prior to topsoil application. The final grade as possible at such a vertically outcropping site will have a general slope of 3:1 max in unconsolidated material. Natural BMP's will remain past reclamation. The benches will use berms and swaled and sediment traps constructed out of rock from the site to aide in storm-water control and erosion. It is not planned to completely mine the entire proposed 8.14 acres. Activities will disturb approximately 6 acres total. Since large boulders and rock may be lifted from the surface anywhere in the 8.14 acres (if desired and accessible).
- (f) Reclamation Costs: After a period of 20 years the site will have reached a point of approximately 6 acres maximum disturbance. Generally, by the date, lower slopes will have already been graded up to a final high-wall location and final reclamation activities will commence. It is estimated that a total of one week will be required for the final reclamation of the site. Most reclamation at the site will be scaling the high-wall and re-grading the flatter operations area and lower slopes (and less), remove and incorporate any sediment berms and ditches, and provide a final grade and place surface material/topsoil. An additional 2 days is estimated for seedbed preparation and seeding. Rock scaling may take a single day as most weathered rock would have been removed already down to the competent bedrock via the mining.

Total reclamation costs are as follows:

Bulldozer (d-6 incl. mob)	-	40 hours @ 175/hour	=\$7000.00
Remove Shed	-		=\$ 250.00
Rock Scaling	-	1 day @ 800/day	=\$ 800.00
Install Permeant Storm-Water	-		=\$2500.00
Hydro Seed 2 Acres	-		=\$1600.00
Monitoring	-		<u>=\$1250.00</u>
Drill Seeded and Mulched	-		=\$ 500.00
Straw	-		=\$ 400.00
Total estimated reclamation cost			=\$14,300.00

This cost estimate includes fuel, mobilization, operator and associated labor

Cross Section of Shehan.
Final Reclamation Config.

GRAND JUNCTION FIELD OFFICE
DIVISION OF
RECLAMATION MINING & SAFETY

Via email

GRAND JUNCTION FIELD OFFICE
DIVISION OF
RECLAMATION MINING & SAFETY



RECEIVED
JAN 06 2016
GRAND JUNCTION FIELD OFFICE
DIVISION OF
RECLAMATION MINING & SAFETY

Via
email

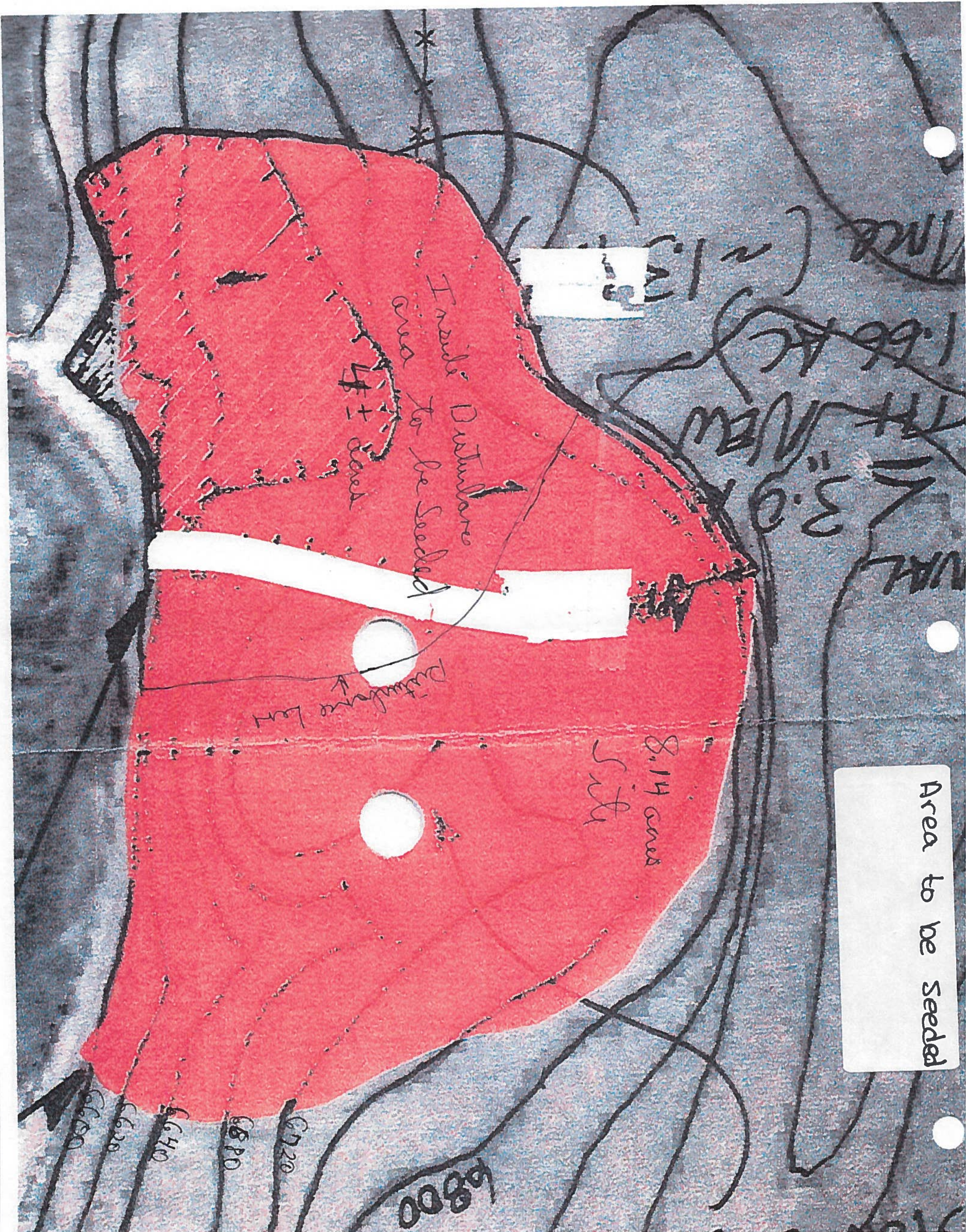

RECEIVED
JAN 06 2007
GRAND JUNCTION FIELD OFFICE
DIVISION OF
RECLAMATION MINING & SAFETY

Via Email

Soil Depth

