



**COLORADO DIVISION OF RECLAMATION, MINING AND SAFETY**  
**MINERALS PROGRAM INSPECTION REPORT**  
**PHONE: (303) 866-3567**

The Division of Reclamation, Mining and Safety has conducted an inspection of the mining operation noted below. This report documents observations concerning compliance with the terms of the permit and applicable rules and regulations of the Mined Land Reclamation Board.

<b>MINE NAME:</b> Ute Trail	<b>MINE/PROSPECTING ID#:</b> M-2015-044	<b>MINERAL:</b> Sand & Gravel	<b>COUNTY:</b> Delta
<b>INSPECTION TYPE:</b> Illegal(Unpermitted Operation)	<b>INSPECTOR(S):</b> Stephanie J. Mitchell	<b>INSP. DATE:</b> November 12, 2015	<b>INSP. TIME:</b> 11:00
<b>OPERATOR:</b>	<b>OPERATOR REPRESENTATIVE:</b>	<b>TYPE OF OPERATION:</b> ILL - Illegal	

<b>REASON FOR INSPECTION:</b> Citizen Complaint	<b>BOND CALCULATION TYPE:</b> None	<b>BOND AMOUNT:</b>
<b>DATE OF COMPLAINT:</b> NA	<b>POST INSP. CONTACTS:</b> None	<b>JOINT INSP. AGENCY:</b> None
<b>WEATHER:</b> Clear	<b>INSPECTOR'S SIGNATURE:</b> 	<b>SIGNATURE DATE:</b> December 8, 2015

**GENERAL INSPECTION TOPICS**

This list identifies the environmental and permit parameters inspected and gives a categorical evaluation of each. No problems or possible violations were noted during the inspection. The mine operation was found to be in full compliance with Mineral Rules and Regulations of the Colorado Mined Land Reclamation Board for the Extraction of Construction Materials and/or for Hard Rock, Metal and Designated Mining Operations. Any person engaged in any mining operation shall notify the office of any failure or imminent failure, as soon as reasonably practicable after such person has knowledge of such condition or of any impoundment, embankment, or slope that poses a reasonable potential for danger to any persons or property or to the environment; or any environmental protection facility designed to contain or control chemicals or waste which are acid or toxic-forming, as identified in the permit.

(AR) RECORDS----- <u>Y</u>	(FN) FINANCIAL WARRANTY----- <u>N</u>	(RD) ROADS----- <u>N</u>
(HB) HYDROLOGIC BALANCE----- <u>N</u>	(BG) BACKFILL & GRADING----- <u>N</u>	(EX) EXPLOSIVES----- <u>N</u>
(PW) PROCESSING WASTE/TAILING---- <u>N</u>	(SF) PROCESSING FACILITIES----- <u>N</u>	(TS) TOPSOIL----- <u>N</u>
(MP) GENL MINE PLAN COMPLIANCE- <u>N</u>	(FW) FISH & WILDLIFE----- <u>N</u>	(RV) REVEGETATION---- <u>N</u>
(SM) SIGNS AND MARKERS----- <u>N</u>	(SW) STORM WATER MGT PLAN---- <u>N</u>	(CI) COMPLETE INSP---- <u>N</u>
(ES) OVERBURDEN/DEV. WASTE----- <u>N</u>	(SC) EROSION/SEDIMENTATION--- <u>N</u>	(RS) RECL PLAN/COMP-- <u>N</u>
(AT) ACID OR TOXIC MATERIALS----- <u>N</u>	(OD) OFF-SITE DAMAGE----- <u>N</u>	(ST) STIPULATIONS----- <u>N</u>

Y = Inspected and found in compliance / N = Not inspected / NA = Not applicable to this operation / PB = Problem cited / PV = Possible violation cited

### OBSERVATIONS

This was an inspection of a possible illegal mining operation being conducted by Mr. Bill Vezzosa. The Division received a complaint on November 10, 2015. The complaint indicated that materials, rock, gravel and topsoil, had been removed from an area and transported to the Aspen Trails Campground in Cedaredge, Co. The area of concern is on Ute Trail Road northeast of the Town of Cedaredge, Colorado in Delta County.

The landowner, Rebecca Kramer, could not be contacted. Bill Vezzosa, the Operator who removed the materials from the site was contacted at the Aspen Trails Campground. Because the landowner could not be contacted the site was not inspected but observed from a nearby distance.

According the complaint letter the time of the work was initiated in April of 2015 and was complete in October of 2015. At the time of inspection no work was being done at the site.

According to Mr. Vezzosa, Ms. Kramer had asked him to build a road for a potential homesite and storage for vehicles and some storage sheds. Mr. Vezzosa did indeed transport gravel like material from the Ute Trail site to his campground. **Because the site was for a potential homesite and upgrading of a road, the Division does not consider this to be a mine site for aggregate materials at the present time.**

The disturbed area is estimated at about 10 acres. The landowner is encouraged to utilize proper erosion control methods surrounding the site to decrease siltation and disturbance to adjacent areas including Ute Trail Road.

Responses to this inspection report should be directed to Stephanie Mitchell at the Division of Reclamation, Mining and Safety, Grand Junction Field Office, 101 South 3rd Street, Room 301, Grand Junction, Colorado 81501, phone number (970) 242-5025.

## PHOTOGRAPHS



Disturbed Area in Orange Dashed



Area used for storage



Material used for fill at Aspen Trails Campground

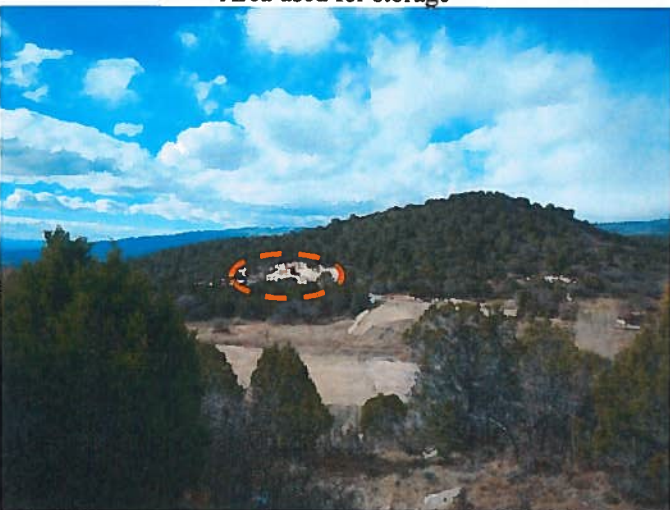

**Inspection Contact Address**

CC: Bill Vezzosa  
19991 HWY 65  
Cedaredge, CO 81413

Rebecca Kramer  
615 Columbia Street  
Delta, CO 81416