



Monadnock Mineral Services, L.L.C.

Mining - Geology - Land Surveying

342 7th Avenue / PO Box 85, Ouray, CO 81427 mmsouray.com 970.325.4600

November 24, 2015

Travis Marshall
DRMS
101 South 3rd, Suite 301
Grand Junction, CO 81501

ID # M-1979-181

Travis,

As per your discussion with Mickey Tine, principal of 42 Mining Company Ltd., operator of the Ruby Trust Mine in Ouray County, Colorado, this is to request approval for moving the 250 ton Ore Stockpile, as shown on the recent Ruby Trust Topographic Plat, to a location approximately 300 ft to the northwest of the present location and within the current permit boundary. This stockpile will remain covered with tarps in the new area until such time as a milling agreement is reached and the stockpile can be transported from the property for processing.

The present location of the stockpile is needed for muck that is being generated in the new adit/crosscut that is being driven to explore one of the veins recently intersected by core drilling. Thank you for your help with this since the immediate area is becoming muck-bound by the amount of material being generated in the crosscut. Please call if any additional information is needed for this request.

Very truly yours,

Robert A. Larson

Robert A. Larson, CPG-PLS

RECEIVED

NOV 24 2015

GRAND JUNCTION FIELD OFFICE
DIVISION OF
RECLAMATION MINING & SAFETY

Ruby Trust Mine

M-1979-181

October 29, 2015

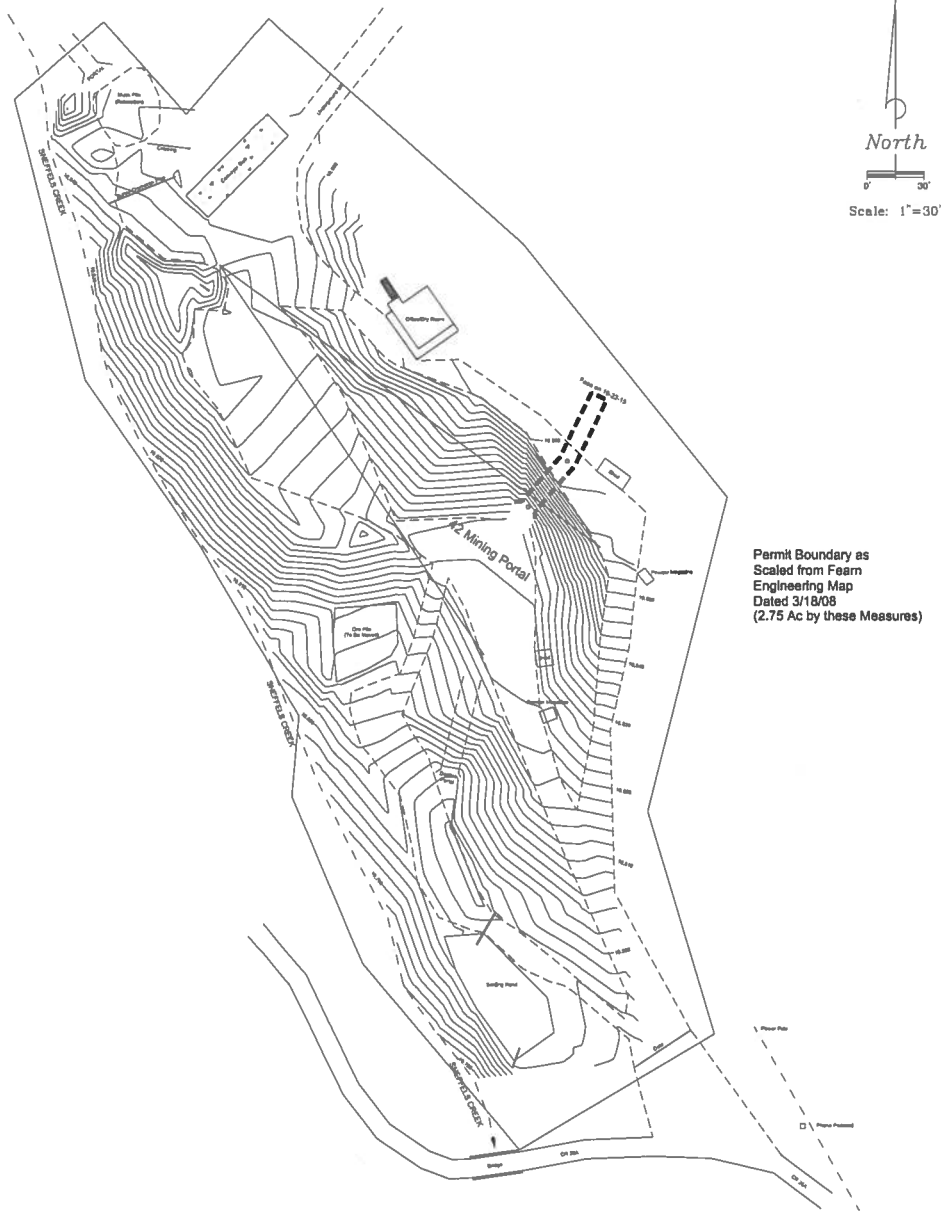

Permit Boundary as
Scaled from Feem
Engineering Map
Dated 3/18/05
(2.75 Ac by these Measures)

Ruby Trust Mine Permit No. M-1979-181		42 Mining Company Ltd. 300 E. Commerce St. Jacksonville, TX 75766	
SURVEYED BY R.A.L.	DATE 10/15	MONADNOCK MINERAL SERVICES 2400-1712 Ave. - P.O. Box 10, Spring, Georgia 30151	
SCALE R.A.L.	1"=30'	J15064	SHEET 1 of 1