



COLORADO DIVISION OF RECLAMATION, MINING AND SAFETY
MINERALS PROGRAM INSPECTION REPORT
PHONE: (303) 866-3567

The Division of Reclamation, Mining and Safety has conducted an inspection of the mining operation noted below. This report documents observations concerning compliance with the terms of the permit and applicable rules and regulations of the Mined Land Reclamation Board.

MINE NAME: Williams Fork Pit	MINE/PROSPECTING ID#: M-1984-168	MINERAL: Sand and gravel	COUNTY: Moffat
INSPECTION TYPE: Monitoring	INSPECTOR(S): Amy C. Yeldell	INSP. DATE: September 10, 2015	INSP. TIME: 10:00
OPERATOR: Williams Fork Mining Company	OPERATOR REPRESENTATIVE: Graham Roberts	TYPE OF OPERATION: 112c - Construction Regular Operation	

REASON FOR INSPECTION: Normal I&E Program	BOND CALCULATION TYPE: Complete Bond	BOND AMOUNT: \$123,400.00
DATE OF COMPLAINT: NA	POST INSP. CONTACTS: None	JOINT INSP. AGENCY: None
WEATHER: Clear	INSPECTOR'S SIGNATURE: <i>Amy Yeldell</i>	SIGNATURE DATE: September 18, 2015

GENERAL INSPECTION TOPICS

This list identifies the environmental and permit parameters inspected and gives a categorical evaluation of each. No problems or possible violations were noted during the inspection. The mine operation was found to be in full compliance with Mineral Rules and Regulations of the Colorado Mined Land Reclamation Board for the Extraction of Construction Materials and/or for Hard Rock, Metal and Designated Mining Operations. Any person engaged in any mining operation shall notify the office of any failure or imminent failure, as soon as reasonably practicable after such person has knowledge of such condition or of any impoundment, embankment, or slope that poses a reasonable potential for danger to any persons or property or to the environment; or any environmental protection facility designed to contain or control chemicals or waste which are acid or toxic-forming, as identified in the permit.

(AR) RECORDS----- <u>Y</u>	(FN) FINANCIAL WARRANTY----- <u>Y</u>	(RD) ROADS----- <u>Y</u>
(HB) HYDROLOGIC BALANCE----- <u>Y</u>	(BG) BACKFILL & GRADING----- <u>Y</u>	(EX) EXPLOSIVES----- <u>NA</u>
(PW) PROCESSING WASTE/TAILING---- <u>NA</u>	(SF) PROCESSING FACILITIES----- <u>Y</u>	(TS) TOPSOIL----- <u>Y</u>
(MP) GENL MINE PLAN COMPLIANCE- <u>Y</u>	(FW) FISH & WILDLIFE----- <u>Y</u>	(RV) REVEGETATION---- <u>Y</u>
(SM) SIGNS AND MARKERS----- <u>Y</u>	(SW) STORM WATER MGT PLAN---- <u>Y</u>	(CI) COMPLETE INSP---- <u>Y</u>
(ES) OVERBURDEN/DEV. WASTE----- <u>NA</u>	(SC) EROSION/SEDIMENTATION--- <u>Y</u>	(RS) RECL PLAN/COMP-- <u>Y</u>
(AT) ACID OR TOXIC MATERIALS----- <u>N</u>	(OD) OFF-SITE DAMAGE----- <u>NA</u>	(ST) STIPULATIONS----- <u>Y</u>

Y = Inspected and found in compliance / N = Not inspected / NA = Not applicable to this operation / PB = Problem cited / PV = Possible violation cited

OBSERVATIONS

This inspection was conducted as part of the Colorado Division of Reclamation, Mining and Safety normal monitoring program. The Williams Fork Pit is a 112c permitted site that includes a total of 83.3 permitted acres of which nearly all has been mined. The pit is 4 miles southwest of Craig Colorado and is accessed from highway 13. Graham Roberts represented the Williams Fork Mining Co. and accompanied Amy Yeldell of the Division on the inspection.

The site is currently in Temporary cessation as of October 26, 2012. The operator has internally been discussing if they wish to finish mining the remaining land or go into final reclamation. This choice will likely be made towards the end of their five year cessation term, which is October 26, 2017.

The mine identification sign and affected area boundary markers are in place and in compliance with Rule 3.1.12. The mine sign is posted at the entrance along the access road. T-posts with white PVC tops clearly delineate the permit boundary.

At the entrance of the pit along access road there is a load scale supported by concrete footers. Also an 8' x 8' scale house. No other permanent structures have been erected.

Since the site is in TC, no equipment or fuel storage of any kind was observed. No material is stockpiled and only a topsoil pile pulled from the current pit remains. The final mining phase is nearly mined out according to Graham Roberts. The pit is partially reclaimed but some slopes still require grading and seeding. If no additional mining is completed the operator may need to submit Technical Revision if pond configuration does not match the final reclamation plan.

Lots of thistle is present in the undisturbed ox bow wetlands. Some thistle has volunteered into the mined areas to the south adjacent to the current mining phase. This late in the year weeds have already gone to seed and it is too late to treat. The operator is encouraged to more aggressively manage weeds next spring and throughout the year to control the infestation within the permit boundary. If left untreated such weed populations could delay releasing of the permit in the future.

All of the other previously mined phases are reclaimed. All ponds have the proper sloping and are well established with desirable vegetation. Only the access roads, scale house area and the final mining phase have incomplete reclamation. Bases on this inspection it is determined that the Operator has successfully complied with the requirements of the Act, Rules and Regulations, and the approved Reclamation Plan, and that a portion of the site is ready to be released from any further reclamation responsibility. If the operator submits an acreage release request within 60 days, this inspection will count as the acreage release inspection.

In an effort to ensure the Financial Warranty adequately, reflects the actual current cost of fulfilling the requirements of the approved reclamation plan the Division will be updating the reclamation cost estimate.

Responses to this inspection report should be directed to: Amy Yeldell at the Division of Reclamation, Mining and Safety, 1313 Sherman St., Room 215, Denver, CO 80203. Direct contact can be made by phone at 970-254-8511 or via email at amy.yeldell@state.co.us

PHOTOGRAPHS

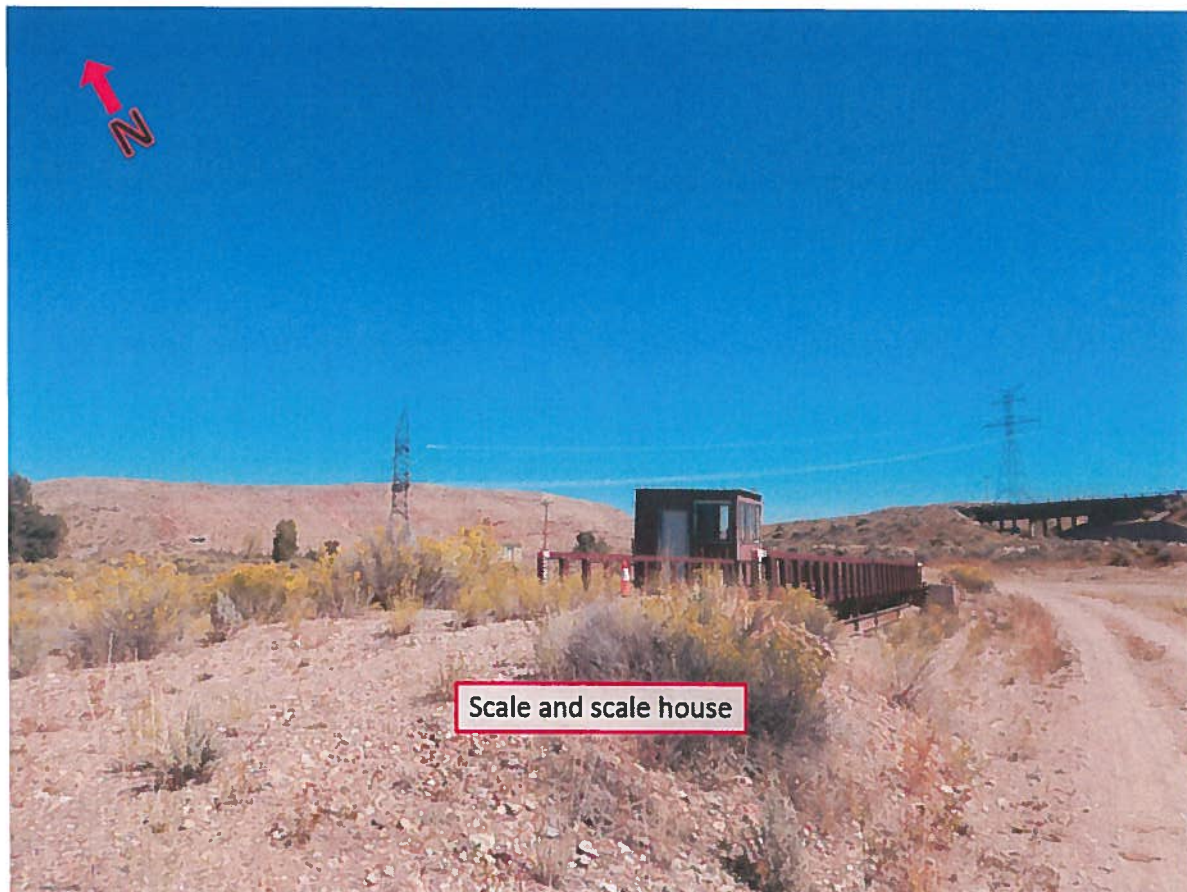



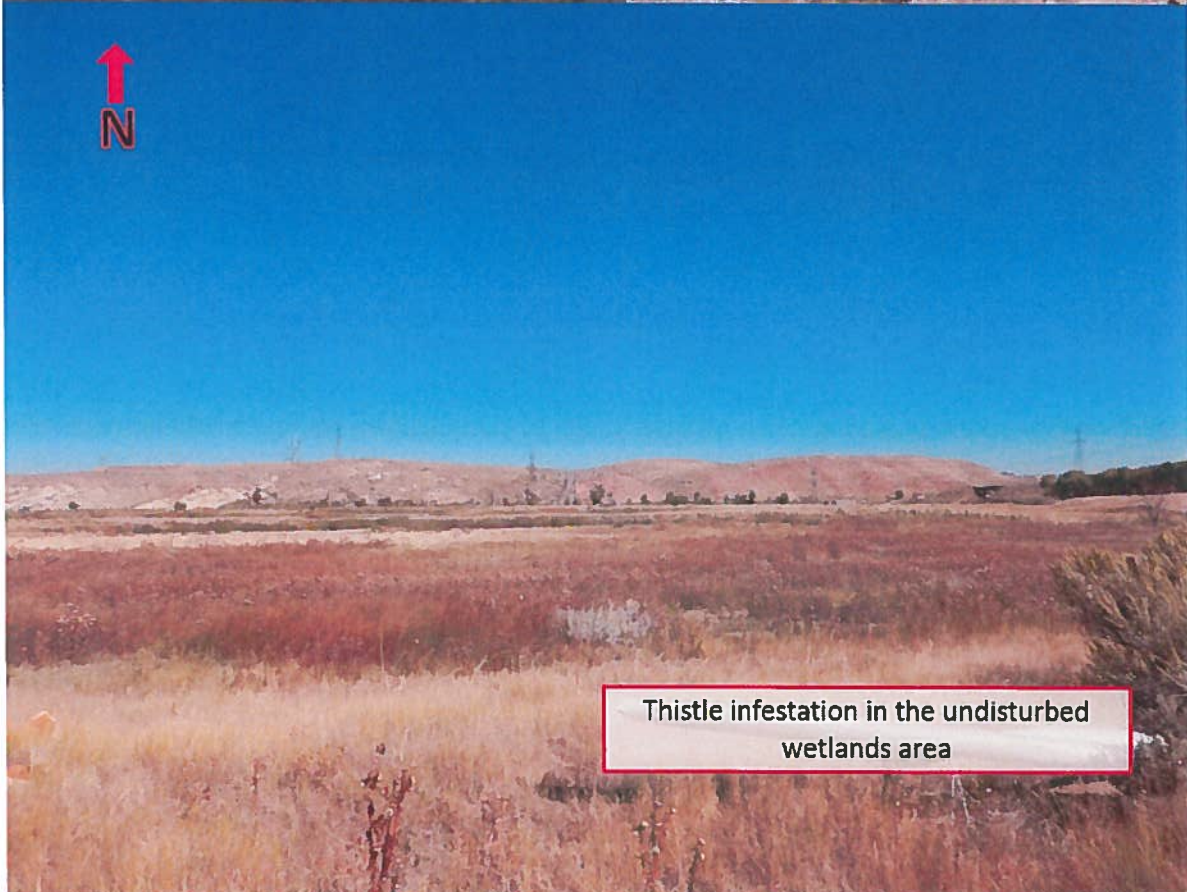

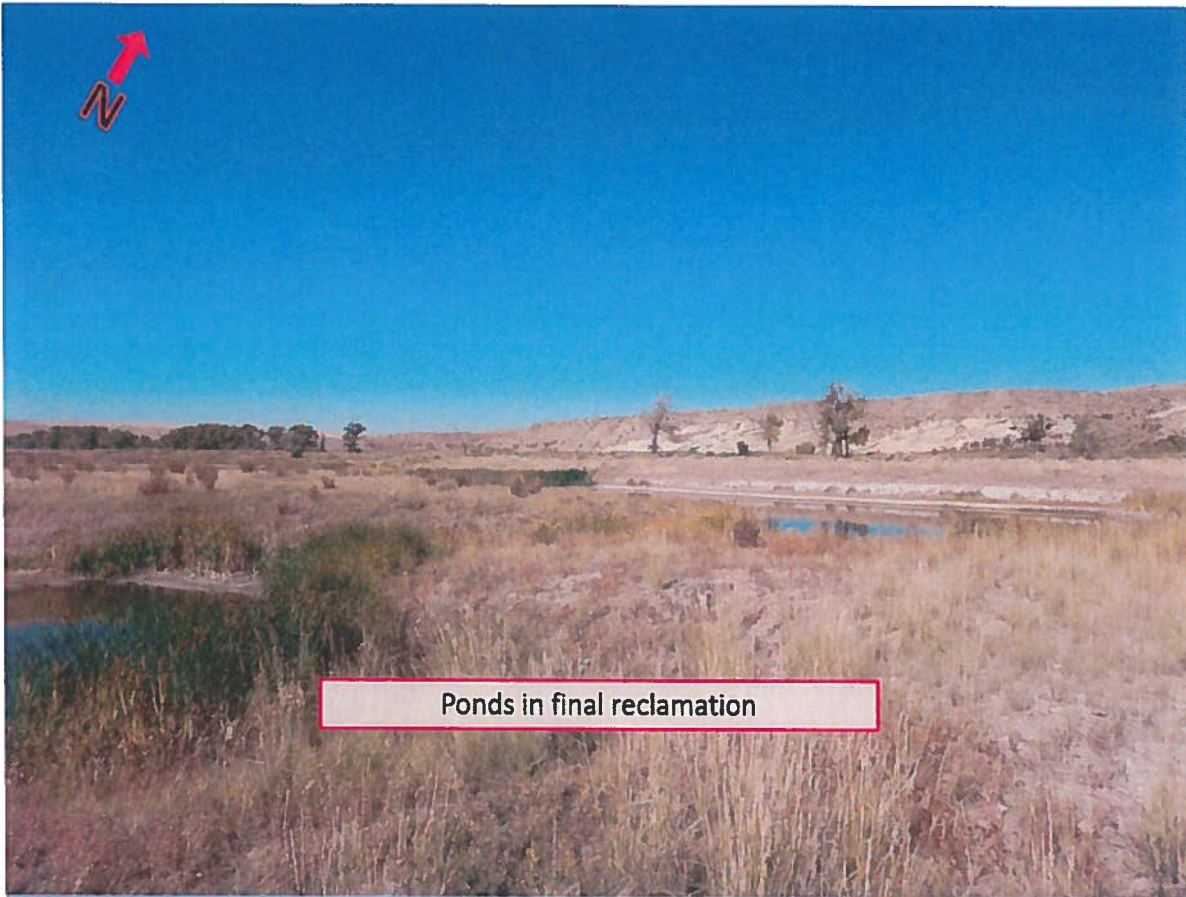

Ponds in final reclamation



Ponds in final reclamation

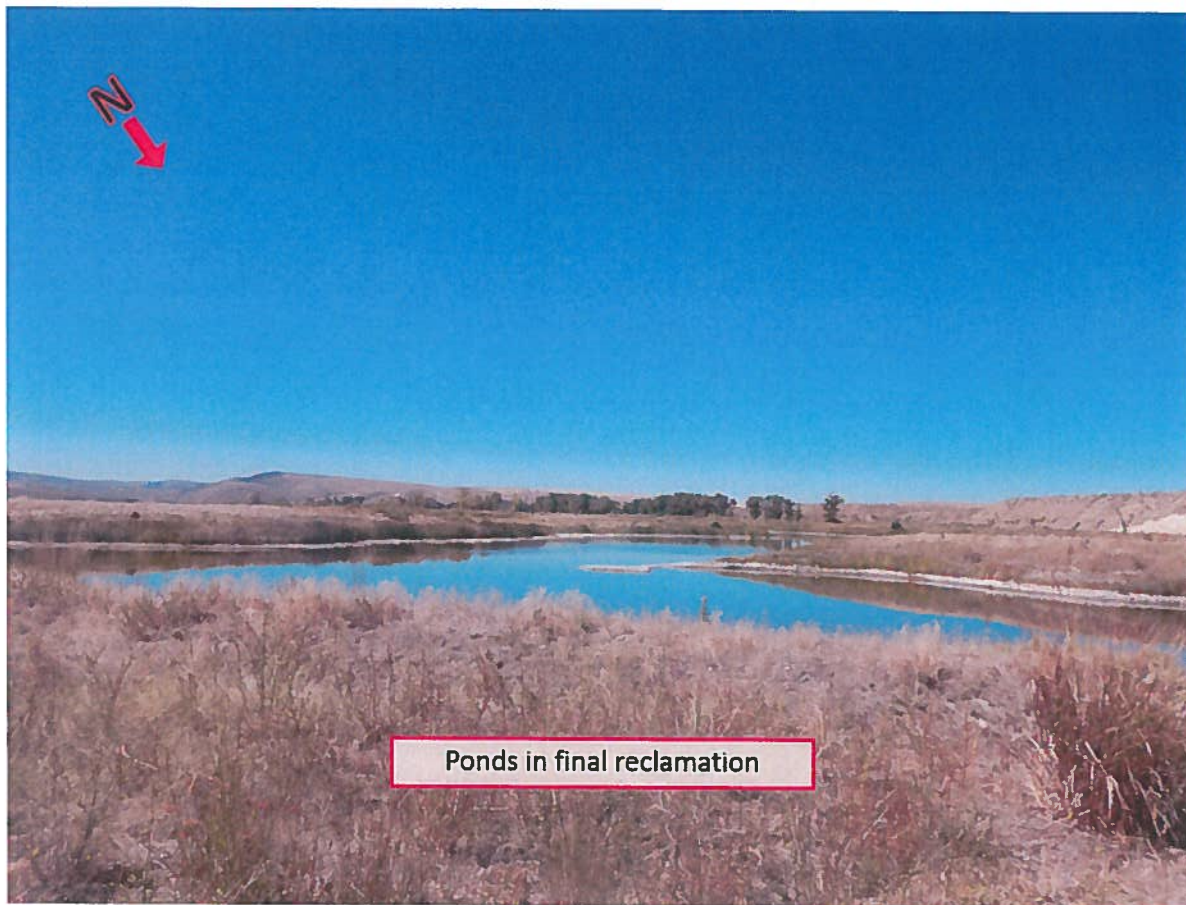

Inspection Contact Address

Graham Roberts
Williams Fork Mining Company
P.O. Box 187
Craig, CO 81626

Enclosure

EC:
Russ Means, Senior EPS / Field Office Supervisor, Grand Junction DRMS