

**RECEIVED**

AUG 04 2015

Page 3 of 5

DIVISION OF RECLAMATION,  
MINING & SAFETY-MINERALSFEE REPORT MAP FW**110(2) Annual Report**

Permittee Name:	Destiny Mining, LLC	Permit Number:	M-2009-056
Operation Name:	Destiny Pit	County:	Park
Annual Fee Due:	\$259.00	Anniversary Date:	July 31, 2015
Permit Acreage:	4.00	Current Bond Amt:	\$15,814.82

According to C.R.S. 34-32.5-116 or 34-32-116, each year, on the anniversary date of the permit, an operator shall submit the Annual Fee, an Annual Report and Map showing the extent of current disturbances to affected land, required monitoring information, reclamation accomplished to date and during the preceding year, any new disturbance that is anticipated to occur during the upcoming year, any reclamation that will be performed during the upcoming year, the dates for the beginning of active operations, and the date active operations ceased for the year.

Information contained in this report will be reviewed by the Division upon receipt and prior to the next compliance inspection of the site. If, while completing this report, you learn that your site is not in compliance with the rules and the act, it is advisable that the issues be rectified promptly to avoid possible enforcement action.

1. Is the site identification sign posted in accordance with Rule 3.1.12(1)? YES NO

2. Is the affected area boundary clearly marked in accordance with Rule 3.1.12(2)? YES NO

3. Is the mine site in final reclamation (all material extraction and stockpile removal is complete)? YES NO  
If "YES," please note time limits related to completion of reclamation, Rule 3.1.3.

4. What was the date of last excavation, processing or hauling activity at the mine?

HAS NOT BEEN MINED

5. Does the mine operate more than 180 days per year YES NO  
If "NO", please review Rule 1.13 to assure that your mine is in compliance.

6. Has this mine been granted: a) approval of TEMPORARY CESSATION Status? YES NO  
b) approval for INTERMITTENT OPERATION? YES NO

7. Number of acres currently affected (mining + incomplete and or unreleased reclamation): 0

8. Number of acres that were newly affected during the current report year: 0

9. Number of acres that were reclaimed during the current report year: 0

10. Estimated new acreage to be affected in the next report year: 0

11. Estimated acres to be reclaimed in the next report year: 0

## 12. Total acres in various stages of reclamation, since permitted mining activities began:

Total acres backfilled:	0	Total acres seeded w/ approved mix:	0	Total acres w/topsoil replaced:	0	Total acres mulched w/ approved mulch:	0
Total acres graded:	0	Total acres fertilized w/ apvd fertilizer:	0	Topsoil replacement depth (in.):	0	Mulch application rate (tons):	0
Seed application method:	0	Fertilizer application method:	0	Mulch application method:	0		

13. Is weed control being conducted in accordance with an approved Weed Control Plan? YES NO N/A  
If "YES", indicate the weed species, control area, control type, application rate and treatment date on the report map.

14. Is adequate topsoil reserved for reclamation, based on your approved permit? YES NO N/A  
If "NO", please explain:

15. Is the reserved topsoil vegetated/stabilized in accordance with Rule 3.1.9(1)? YES NO N/A  
If "NO" please explain:

16. If mining has exposed groundwater, is the site in compliance with the approved mining plan and Office of the State Engineer (Well Permit, S.W.S.P., and/or Permanent Augmentation Plan)? YES NO N/A

17. Are all hazardous materials stored within approved spill containment structures? YES NO N/A

18. Is your financial warranty value sufficient to cover the cost to complete reclamation? YES NO N/A

19. Is your basis for legal right to enter still valid? YES NO

20. Does your permit require you to submit monitoring information annually? YES NO N/A  
If "Yes", please attach the required monitoring results to this Annual Report.

21. As required by Colorado Mined Land Reclamation Act and/or Colorado Land Reclamation Act for the Extraction of Construction Materials (C.R.S. 34-32-116 or 34-32.5-116), attach a map to this report that accurately depicts the permit boundary, current affected area boundary and location of the acreages specified in items 7- 12 and 14.  
UPDATED

MAP ATTACHED: YES

Division records indicate the following permittee contact information. If this information is not current, please type or print **current** contact information:

Permittee Contact:	Boyd Astemborski	
Permittee Company:	Destiny Mining, LLC	
Address:	902 Collins Rd. Colorado Springs, CO80920	
Phone Number:	(719) 290-4205	
Fax Number:	<del>(719) 260-1296</del>	NO FAX NUMBER
Email Address:		

I, the undersigned, hereby state that the information provided in this report is true and accurate, and that site operations are being conducted in accordance with the Division approved mining and reclamation plans.

Boyd Astemborski  
Signature of Permittee, Corporate Officer, Owner, or Documented Designee

7/25/2015  
Date



**COLORADO**  
 Division of Reclamation,  
 Mining and Safety  
 1415 Sherman Street, Room 215  
 Denver, CO 80203

Permit Procedures - Effective July 1, 2014  
 Page 3, Note  
 New Procedures - Effective July 1, 2014

The Division of Reclamation, Mining and Safety will no longer send out second or final notices for past due Annual Fees. In accordance with the Colorado Mined Land Reclamation Act for the Extration of Construction Materials (C.R.S. 34-32.5-101), the Office will send out a single notice for the payment of Annual Fees and submital of an Annual Report and Map. The report and fee are due on the anniversary date of the permit issuance. Where an operator is late in payment of the Annual Fee by more than sixty (60) days, the Division Board will automatically issue a violation and set the matter for a hearing before the Mined Land Reclamation Board for permit revocation and forfeiture. If a violation is issued, civil penalties equal to the amount of the annual fee will also be assessed.

For sites covered under the Colorado Mined Land Reclamation Act (C.R.S. 34-32-101), the same procedure will apply, however, if payment is late by more than sixty (60) days, the operator will be issued a "Reason to Believe that a Violation Exists" letter, which will set the matter for a hearing before the Mined Land Reclamation Board for consideration of a possible violation.

Thank you for your cooperation in implementing these new procedures and if you have any questions, please contact: Tony Waldron, Minerals Program Supervisor at 303-866-3567 x8150.

**COLORADO**Division of Reclamation,  
Mining and Safety

Department of Natural Resources

1313 Sherman St. Room 215  
Denver, CO 80203

June 1, 2015

Boyd Astemborski  
Destiny Mining, LLC  
902 Collins Rd.  
Colorado Springs, CO 80920**Destiny Pit, Permit M-2009-056, Annual Fee Invoice and Report Request****PLEASE READ CAREFULLY – ACTION REQUIRED****Please attach your COMPLETED written Annual Report and Annual Report Map to this form**

Under the terms of your Reclamation Permit and Colorado Statutes, you must submit an Annual Fee and Annual Report (including a map). You must pay the Annual Fee and submit an Annual Report each year until reclamation responsibility release is granted. The Annual Fee is not a renewal fee. The Fee and Report are for LAST YEAR'S mining and reclamation season, and MUST be paid even if your operation was inactive.

The Annual Report and Fee requirement will be considered submitted when we have received the following components:

1. **APPROPRIATE ANNUAL FEE**
2. **COMPLETED ANNUAL REPORT**
3. **ASSOCIATED MAP as required by rule**

If you have requested reclamation responsibility release from the Division of Reclamation, Mining and Safety (the "Division") but your permit is not released by the anniversary date listed below, the Annual Fee MUST be paid. If the permit is released before the anniversary date, then by Statute, it is not necessary to pay an Annual Fee or submit an Annual Report for that year.

Division records indicate the \$259.00 fee is due for the following:

Permit: M-2009-056  
Operation Name: Destiny Pit  
Anniversary Date: July 31, 2015  
Total Fee Due: \$259.00 (Due on or before your Anniversary Date)

Return the enclosed Annual Report FORM, a MAP, and a CHECK or MONEY ORDER made payable to: Division of Reclamation, Mining and Safety, 1313 Sherman St., Room 215, Denver, CO 80203. If your records indicate these documents and fees have already been submitted, please notify the Division.



If you have additional comments and/or information that should be provided to the Division, please provide it below or attach it to this form along with your written report and map. Annual Report instructions are enclosed. If you have any questions, please feel free to contact Michelle Ramirez (303) 866-3567 ext 8114. Thank you for your cooperation in this matter.

IF THE ANNUAL FEE SUBMITTALS ARE NOT RECEIVED ON OR BEFORE YOUR ANNIVERSARY DATE, THE ENFORCEMENT PROCESS WILL AUTOMATICALLY BE INITIATED. ENFORCEMENT ACTIONS MAY RESULT IN CIVIL PENALTIES AND/OR REVOCATION OF YOUR PERMIT.

WE HAVE NOT TOUCHED THIS PROPERTY AT ALL  
AT THIS TIME



RECEIVED

AUG 04 2015

DIVISION OF RECLAMATION  
MINING AND SAFETY

11-2009-056

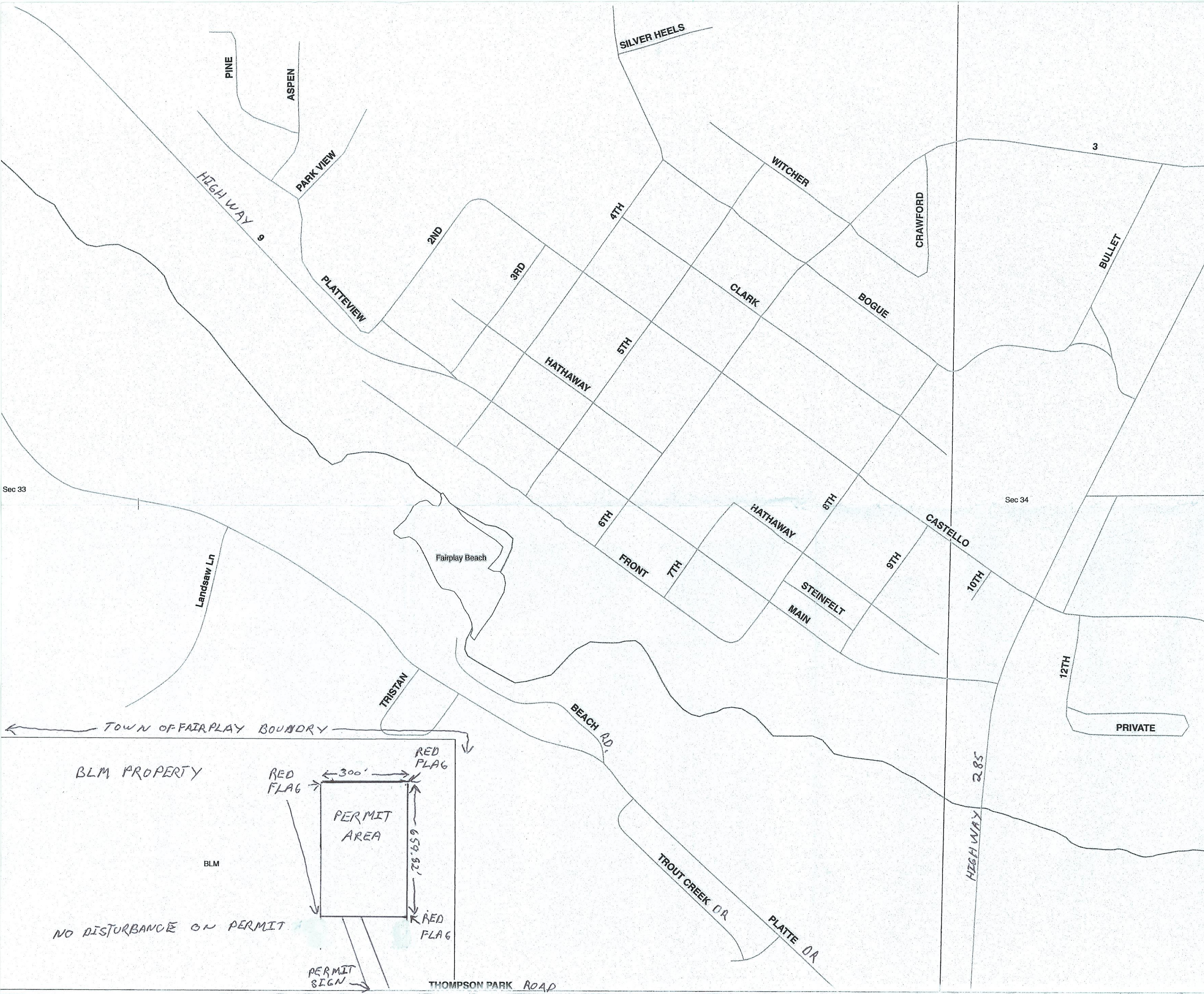



Division of Reclamation, Mining, and Safety

Fee Receipt for M2009056

Destiny Mining, LLC

000000000

Receipt #: 20021

Date: 08/04/2015

Permit: M2009056

Payment Method	Revenue Code	Fee Description/Notes	Amount
1214 SDT	4300-MAF0	Minerals Annual Fees M2009-056	\$259.00
Receipt Total:			\$259.00