

July 22, 2015

Gilbert Lee  
Central Aggregates, Inc.  
P.O. Box 1877  
Rifle, CO 81650



**COLORADO**  
Division of Reclamation,  
Mining and Safety  
Department of Natural Resources

1313 Sherman Street, Room 215  
Denver, CO 80203

***RE: West Rifle Pit, Permit No. M-1981-006, Acreage Reduction (AR-2), Approval***

Dear Mr. Lee:

On July 22, 2015, the Colorado Division of Reclamation, Mining and Safety approved your request for release of a portion of the permit area from further reclamation responsibility.

The permit was reduced from 41.59 acres to 29.39 acres.

On June 26, 2015 the Division requested an updated map clarifying acreages within each parcel and boundaries for which the operator was requesting release. On July 16, 2015 the Division received notification that at this time the operator is unable to supply additional data and documentation. In an effort to resolve this matter Division staff used Google Earth imagery to make a map depicting the north and west shore line area that the operator requested release and additional parcel boundaries were to calculate released and current affected acreages.

The Divisions map is attached. A total of 12.2 acres was released based on information supplied in the request. This includes 4.32 acres of the remainder of Parcel A, 2.59 acres from Parcel B, 0.08 acres from parcel D, and 5.11 acres from Parcel E as shown on Jerry Bauer's map, revision dated July 31, 2012.

Please note that because there permit is not totally released, you are still liable for filing annual reports and fees and maintaining the financial warranty in good standing.

If you require additional information, or have questions or concerns, please feel free to contact me. Amy Yeldell at the Division of Reclamation, Mining and Safety, 1313 Sherman St., Room 215, Denver, CO 80203. Direct contact can be made by phone at 970-254-8511 or via email at amy.yeldell@state.co.us

Sincerely,

**Amy Yeldell**

Environmental Protection Specialist  
Department of Natural Resources  
Division of Reclamation, Mining and Safety  
Phone: (970) 254-8511  
Fax: (970) 241-1516

Cc: Russ Means, Senior EPS / Field Office Supervisor, Grand Junction DRMS



**West Rifle Pit**

Acreage Reduction Staff Estimates

Red line  
delineates  
AR-2  
approval  
boundary

Parcel E

Tree With Marker

Parcel B

Parcel A

Parcel D

Steel Pin

2012 Acreage Release



Rebar and yellow plastic cap set near 8" dia. elm tree on pond bank at edge of native vegetation thick growth along bank.

Parcel "E" Permit M-81-006

See Exhibit 1 of application drawings dated December of 1980 and amended September of 1982. This parcel of land is shown thereon as "Villa, Iver M." in the NW 1/4 of Sec. 17.

This Parcel of land was added to the permit by Technical Revision # 001 issued April 20, 1993. Area = 10.1 acres  
Mined Area = 3.9 acres

This area was originally permitted as Parcel "A" of Permit M-81-006 according to Exhibit 1 of application drawings dated December of 1980 and amended September of 1982. It was removed from the permit by Technical revision 001 April 20, 1993.

Existing outlet structure

Area = 4.32 acres  
Mined Area = 2.28 acres

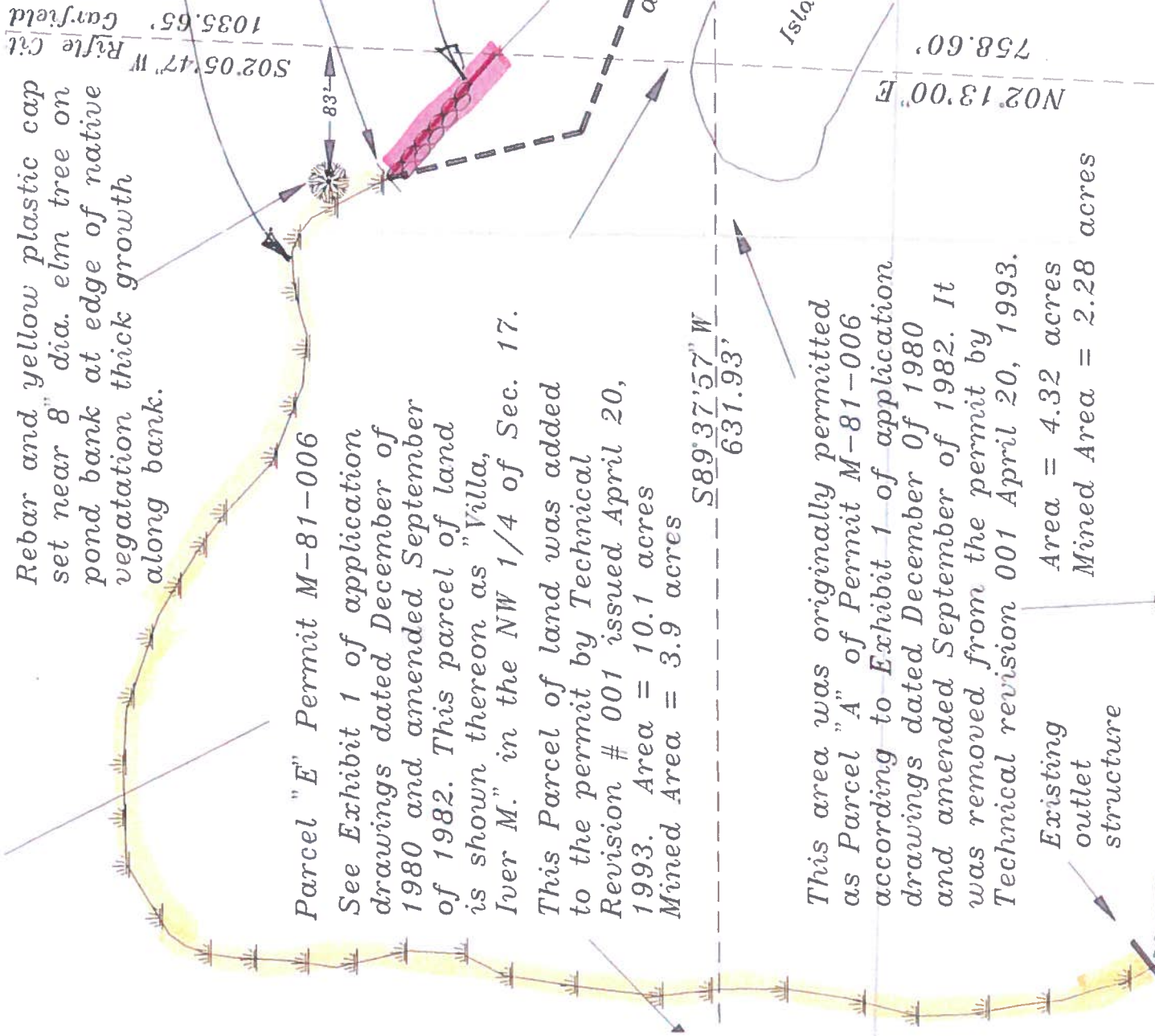

1291' — 93%

102' — 7%

Total 1393 ft  
of shoreline  
in Parcels A & E

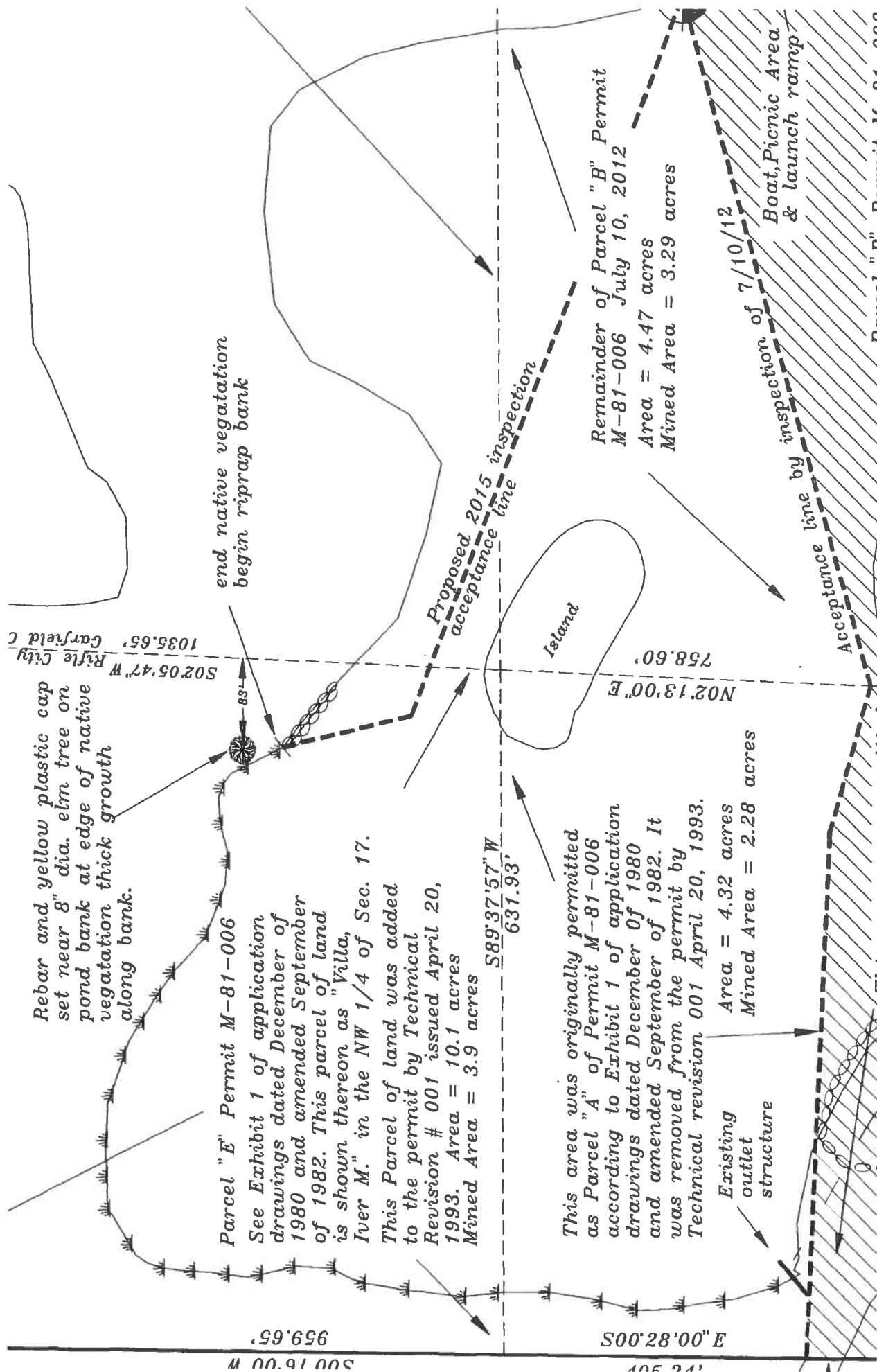

Rebar and yellow plastic cap set near 8" dia. elm tree on pond bank at edge of native vegetation thick growth along bank.

Parcel "E" Permit M-81-006

See Exhibit 1 of application drawings dated December of 1980 and amended September of 1982. This parcel of land is shown thereon as "Villa, Iver M." in the NW 1/4 of Sec. 17. This Parcel of land was added to the permit by Technical Revision # 001 issued April 20, 1993. Area = 10.1 acres Mined Area = 3.9 acres

This area was originally permitted as Parcel "A" of Permit M-81-006 according to Exhibit 1 of application drawings dated December of 1980 and amended September of 1982. It was removed from the permit by Technical revision 001 April 20, 1993. Area = 4.32 acres Mined Area = 2.28 acres

Existing outlet structure

end native vegetation begin riprap bank

Proposed 2015 inspection acceptance line

Island

Remainder of Parcel "B" Permit M-81-006 July 10, 2012 Area = 4.47 acres Mined Area = 3.29 acres

Boat, Picnic Area & launch ramp

Acceptance line by inspection of 7/10/12

Rifle City  
Garfield  
S02°05'47" W  
1035.65'

N02°13'00" E  
758.60'

S00°28'00" E  
959.65'

S00°28'00" E  
105.24'

Remainder "B" Permit M-81-006