



COLORADO DIVISION OF RECLAMATION, MINING AND SAFETY
MINERALS PROGRAM INSPECTION REPORT
PHONE: (303) 866-3567

The Division of Reclamation, Mining and Safety has conducted an inspection of the mining operation noted below. This report documents observations concerning compliance with the terms of the permit and applicable rules and regulations of the Mined Land Reclamation Board.

MINE NAME: Blue Jet Mine	MINE/PROSPECTING ID#: M-1978-135-HR	MINERAL: Gold, silver and copper	COUNTY: Moffat
INSPECTION TYPE: Monitoring	INSPECTOR(S): Amy Yeldell, Russ Means	INSP. DATE: July 9, 2015	INSP. TIME: 09:00
OPERATOR: Blue Jet Mining Inc	OPERATOR REPRESENTATIVE: Orvie Zimmerman	TYPE OF OPERATION: 110(2) - Hard Rock Limited Impact	

REASON FOR INSPECTION: Normal I&E Program	BOND CALCULATION TYPE: Complete Bond	BOND AMOUNT: \$2,500.00
DATE OF COMPLAINT: NA	POST INSP. CONTACTS: Jennifer Maiolo, BLM	JOINT INSP. AGENCY: U.S.BLM
WEATHER: Clear	INSPECTOR'S SIGNATURE: 	SIGNATURE DATE: July 14, 2015

GENERAL INSPECTION TOPICS

This list identifies the environmental and permit parameters inspected and gives a categorical evaluation of each. No problems or possible violations were noted during the inspection. The mine operation was found to be in full compliance with Mineral Rules and Regulations of the Colorado Mined Land Reclamation Board for the Extraction of Construction Materials and/or for Hard Rock, Metal and Designated Mining Operations. Any person engaged in any mining operation shall notify the office of any failure or imminent failure, as soon as reasonably practicable after such person has knowledge of such condition or of any impoundment, embankment, or slope that poses a reasonable potential for danger to any persons or property or to the environment; or any environmental protection facility designed to contain or control chemicals or waste which are acid or toxic-forming, as identified in the permit.

(AR) RECORDS----- <u>N</u>	(FN) FINANCIAL WARRANTY----- <u>Y</u>	(RD) ROADS----- <u>Y</u>
(HB) HYDROLOGIC BALANCE----- <u>Y</u>	(BG) BACKFILL & GRADING----- <u>Y</u>	(EX) EXPLOSIVES----- <u>NA</u>
(PW) PROCESSING WASTE/TAILING---- <u>N</u>	(SF) PROCESSING FACILITIES----- <u>NA</u>	(TS) TOPSOIL----- <u>Y</u>
(MP) GENL MINE PLAN COMPLIANCE- <u>Y</u>	(FW) FISH & WILDLIFE----- <u>Y</u>	(RV) REVEGETATION---- <u>Y</u>
(SM) SIGNS AND MARKERS----- <u>Y</u>	(SP) STORM WATER MGT PLAN---- <u>Y</u>	(SB) COMPLETE INSP---- <u>Y</u>
(ES) OVERBURDEN/DEV. WASTE----- <u>Y</u>	(SC) EROSION/SEDIMENTATION--- <u>Y</u>	(RS) RECL PLAN/COMP-- <u>Y</u>
(AT) ACID OR TOXIC MATERIALS----- <u>N</u>	(OD) OFF-SITE DAMAGE----- <u>Y</u>	(ST) STIPULATIONS----- <u>N</u>

Y = Inspected and found in compliance / N = Not inspected / NA = Not applicable to this operation / PB = Problem cited / PV = Possible violation cited

OBSERVATIONS

This inspection was conducted as part of the Colorado Division of Reclamation, Mining and Safety normal monitoring program. The Blue Jet Mine is a 110(2) permitted site located off County Road 168, approximately 27 miles northwest of Craig in Moffat County. Amy Yeldell of the Division conducted the inspection. Mr. Orvie Zimmerman, the operator, Jennifer Maiolo of the BLM Little Snake Field Office and Russ Means of DRMS accompanied the inspector.

The permitted area is 9.9 acres. The site is largely reclaimed or undisturbed. It is estimated that less than one acre is disturbed at this time.

The mine identification sign and affected area boundary markers are in place and in compliance with Rule 3.1.12. The sign is located at the entrance to the site where the access road meets county road 168. The permit boundary is marked with several t-posts. Currently no mining activities occur near the permit boundary.

There is no equipment on site. Nor is there any fuel or other materials being stored on site. All scrap material noted in previous reports has been removed and the site remains clean. The operator is actively mining and testing material off site for mineral viability. It is estimated that 1000 lbs of material will be tested over the next year.

Late this fall the operator plans to conduct maintenance to the site by cleaning out the pond and removing sediment tracked in by livestock. No changes to the size or shape of the pond are anticipated. The operator has a valid well permit and water quality remains good.

Vegetation in the previously reclaimed areas is coming in well and remains stable. There is a high species diversity which includes grasses, forbs and shrubs. Due to good vegetation establishment there is little erosion site wide. Volunteer species have stabilized the active access road and pad, very little foot print of mining operations is evident. There are some thistles within the permit area, specifically the riparian areas. It is evident that the operator is actively spraying and digging out the undesirable species. Mr. Zimmerman is encouraged to continue his efforts to promote reclamation success and avoid future infestations.

In an effort to ensure the Financial Warranty adequately reflects the actual current cost of fulfilling the requirements of the approved reclamation plan the Division will be updating the reclamation cost estimate. A copy of the staff calculations will be sent under separate cover.

No problems or violations were noted during this inspection.

Responses to this inspection report should be directed to: Amy Yeldell at the Division of Reclamation, Mining and Safety, 1313 Sherman St., Room 215, Denver, CO 80203. Direct contact can be made by phone at 970-254-8511 or via email at amy.yeldell@state.co.us.

PHOTOGRAPHS



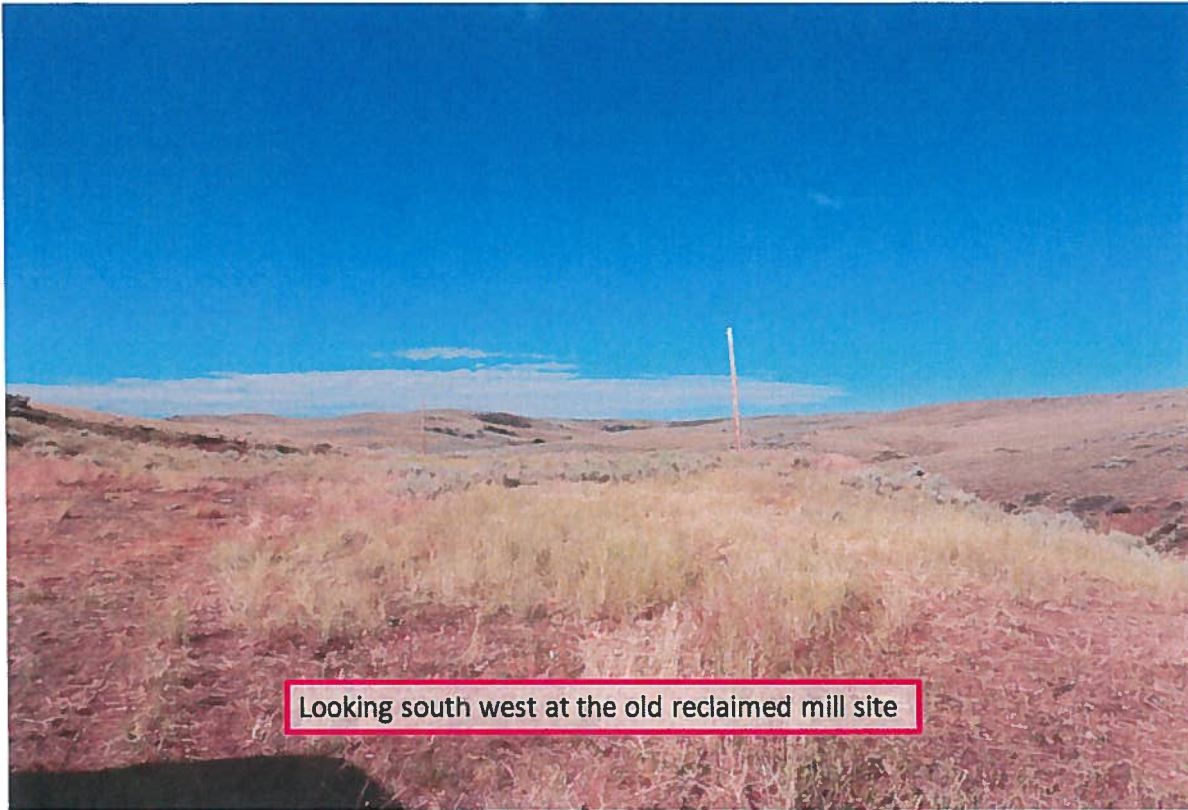

Looking south west at the old reclaimed mill site

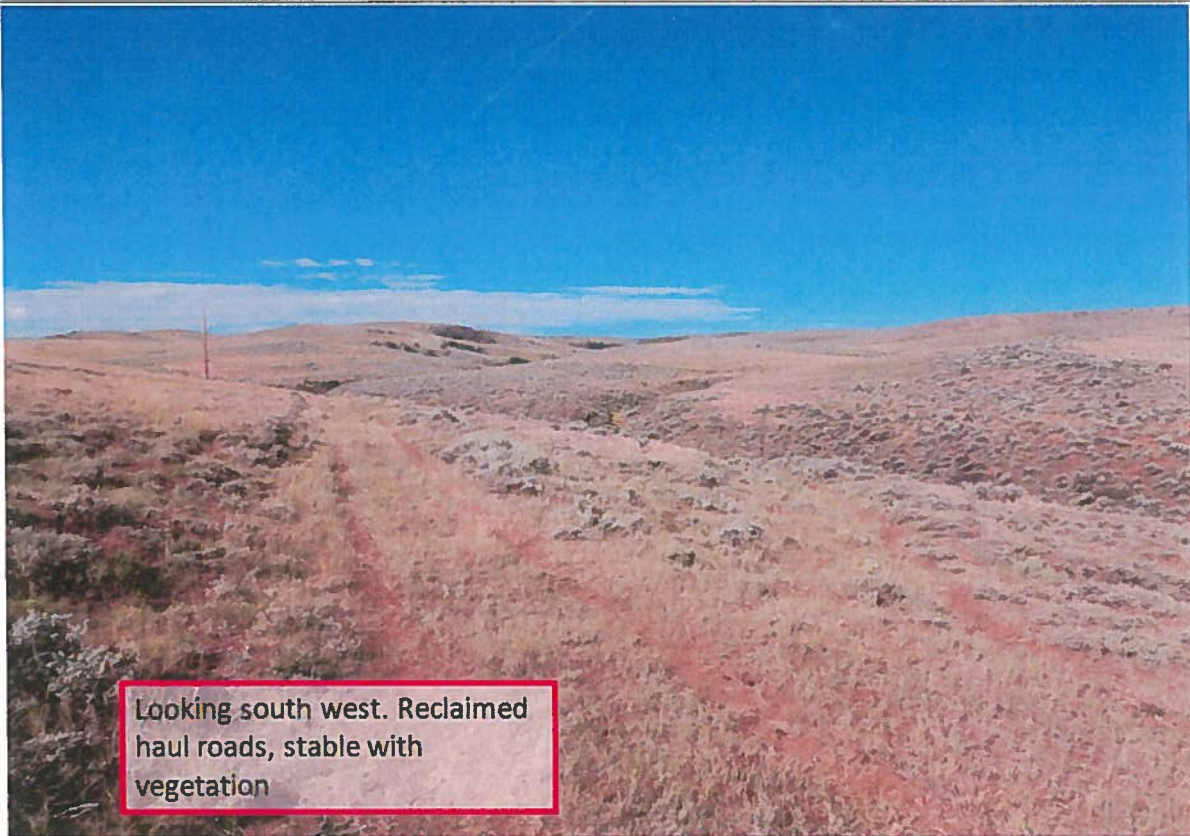

Looking south west. Reclaimed
haul roads, stable with
vegetation

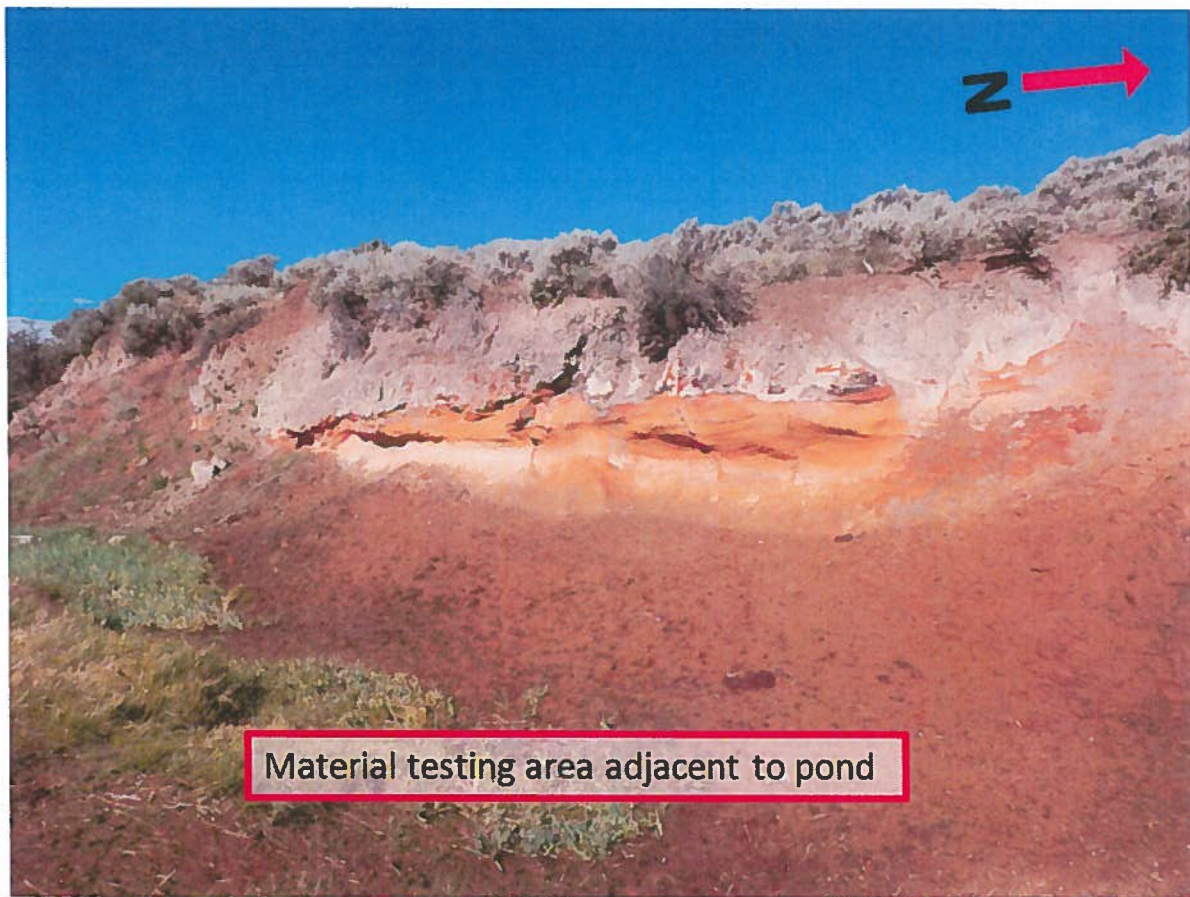
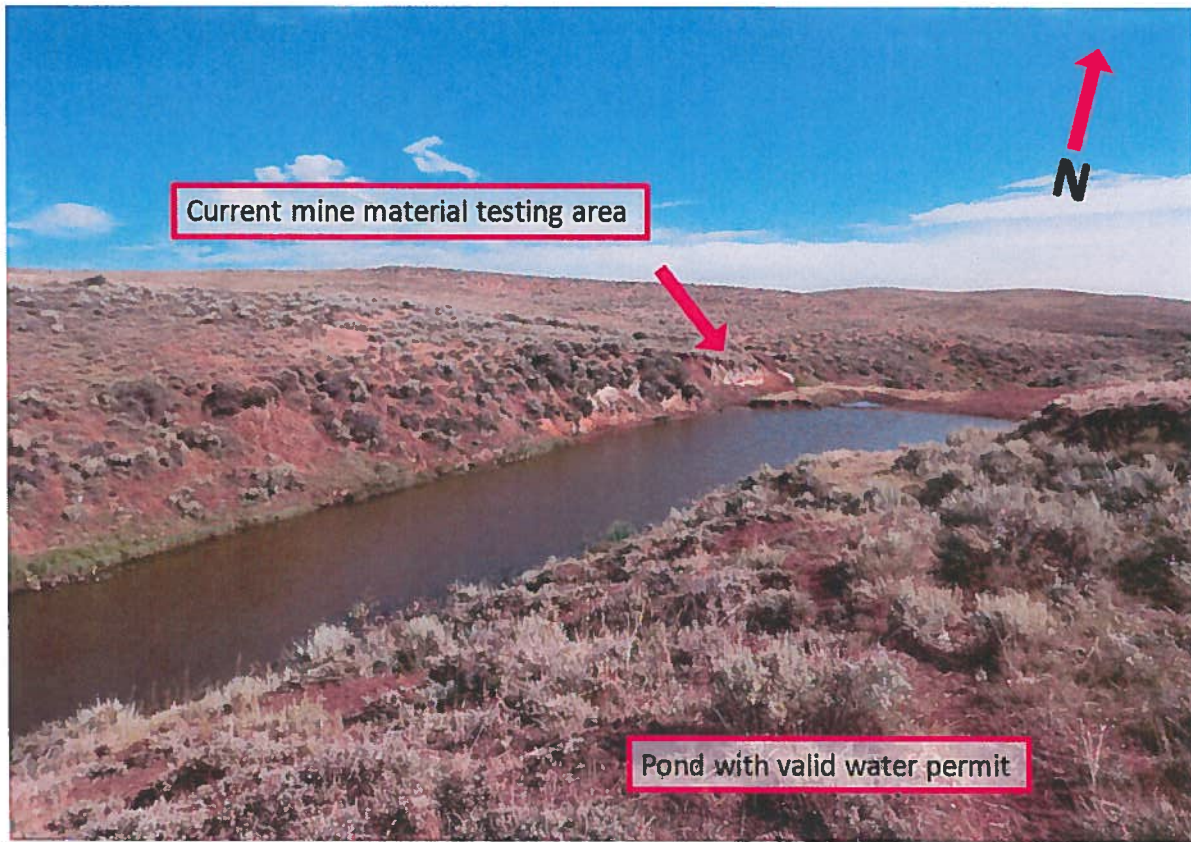

Inspection Contact Address

Orvie Zimmerman
Blue Jet Mining Inc
P.O. Box 181
Craig, CO 81626

Enclosure

CC:
Jennifer Maiolo, Little Snake BLM
Russ Means, Senior EPS / Field Office Supervisor, Grand Junction DRMS