

**DIVISION OF RECLAMATION,  
MINING & SAFETY-MINERALS  
FEE REPORT MAP PW**

<b>Permittee Name:</b>	CRG Mining, LLC	<b>Permit Number:</b>	M-1987-143
<b>Operation Name:</b>	Gold Links Mine	<b>County:</b>	Gunnison
<b>Annual Fee Due:</b>	\$259.00	<b>Anniversary Date:</b>	July 13, 2015
<b>Permit Acreage:</b>	6.20	<b>Current Bond Amt:</b>	\$2,800.00

Information contained in this report will be reviewed by the Division upon receipt and prior to the next compliance inspection of the site. If, while completing this report, you learn that your site is not in compliance with the rules and the act, it is advisable that the issues be rectified promptly to avoid possible enforcement action.

1. Is the site identification sign posted in accordance with Rule 3.1.12(1)?
2. Is the affected area boundary clearly marked in accordance with Rule 3.1.12(2)?
3. Is the mine site in final reclamation (all material extraction and stockpile removal is complete)?  
If "YES," please note time limits related to completion of reclamation, Rule 3.1.3.
4. What was the date of last excavation, processing or hauling activity at the mine?
5. Does the mine operate more than 180 days per year  
If "NO", please review Rule 1.13 to assure that your mine is in compliance.
6. Has this mine been granted:     a) approval of TEMPORARY CESSATION Status?  
  b) approval for INTERMITTENT OPERATION?
7. Number of acres currently affected (mining + incomplete and or unreleased reclamation):
8. Number of acres that were newly affected during the current report year:
9. Number of acres that were reclaimed during the current report year:
10. Estimated new acreage to be affected in the next report year:
11. Estimated acres to be reclaimed in the next report year:

(YES) NO

☒ YES ☐ NO

YES (NO

4-14-15

YES NO

YES YES NO NO

S.O



12. Total acres in various stages of reclamation, since permitted mining activities began: N/A

Total acres backfilled:	<u>0</u>	Total acres seeded w/ approved mix:	<u>0</u>	Total acres w/topsoil replaced:	<u>0</u>	Total acres mulched w/ approved mulch:	<u>0</u>
Total acres graded:	<u>0</u>	Total acres fertilized w/ apvd fertilizer:	<u>0</u>	Topsoil replacement depth (in.):	<u>0</u>	Mulch application rate (tons):	<u>0</u>
Seed application method:	<u>0</u>	Fertilizer application method:	<u>0</u>	Mulch application method:	<u>0</u>		

13. Is weed control being conducted in accordance with an approved Weed Control Plan? YES NO N/A  
If "YES", indicate the weed species, control area, control type, application rate and treatment date on the report map.

14. Is adequate topsoil reserved for reclamation, based on your approved permit? YES NO N/A  
If "NO", please explain:

15. Is the reserved topsoil vegetated/stabilized in accordance with Rule 3.1.9(1)? YES NO N/A  
If "NO" please explain:

16. If mining has exposed groundwater, is the site in compliance with the approved mining plan and Office of the State Engineer (Well Permit, S.W.S.P., and/or Permanent Augmentation Plan)? YES NO N/A

17. Are all hazardous materials stored within approved spill containment structures? YES NO N/A

18. Is your financial warranty value sufficient to cover the cost to complete reclamation? YES NO N/A

19. Is your basis for legal right to enter still valid? YES NO

20. Does your permit require you to submit monitoring information annually? YES NO N/A  
If "Yes", please attach the required monitoring results to this Annual Report.

21. As required by Colorado Mined Land Reclamation Act and/or Colorado Land Reclamation Act for the Extraction of Construction Materials (C.R.S. 34-32-116 or 34-32.5-116), attach a map to this report that accurately depicts the permit boundary, current affected area boundary and location of the acreages specified in items 7- 12 and 14.  
UPDATED

MAP ATTACHED:

YES

SW

Division records indicate the following permittee contact information. If this information is not current, please type or print **current** contact information:

Permittee Contact:	Robert Gydesen	
Permittee Company:	CRG Mining, LLC	
Address:	502 S. Wisconsin Street Gunnison, CO81230	
Phone Number:	(970) 596-4520	
Fax Number:		
Email Address:		

I, the undersigned, hereby state that the information provided in this report is true and accurate, and that site operations are being conducted in accordance with the Division approved mining and reclamation plans.

\_\_\_\_\_  
**Signature of Permittee, Corporate Officer, Owner, or Documented Designee**

\_\_\_\_\_  
Date

If you have additional comments and/or information that should be provided to the Division, please provide it below or attach it to this form along with your written report and map. Annual Report instructions are enclosed. If you have any questions, please feel free to contact Michelle Ramirez (303) 866-3567 ext 8114. Thank you for your cooperation in this matter.

IF THE ANNUAL FEE SUBMITTALS ARE NOT RECEIVED ON OR BEFORE YOUR ANNIVERSARY DATE, THE ENFORCEMENT PROCESS WILL AUTOMATICALLY BE INITIATED. ENFORCEMENT ACTIONS MAY RESULT IN CIVIL PENALTIES AND/OR REVOCATION OF YOUR PERMIT.

X Suz/Hill

6-16-2015

JACOB H. WILKINSON

MANAGER

970-417-3311

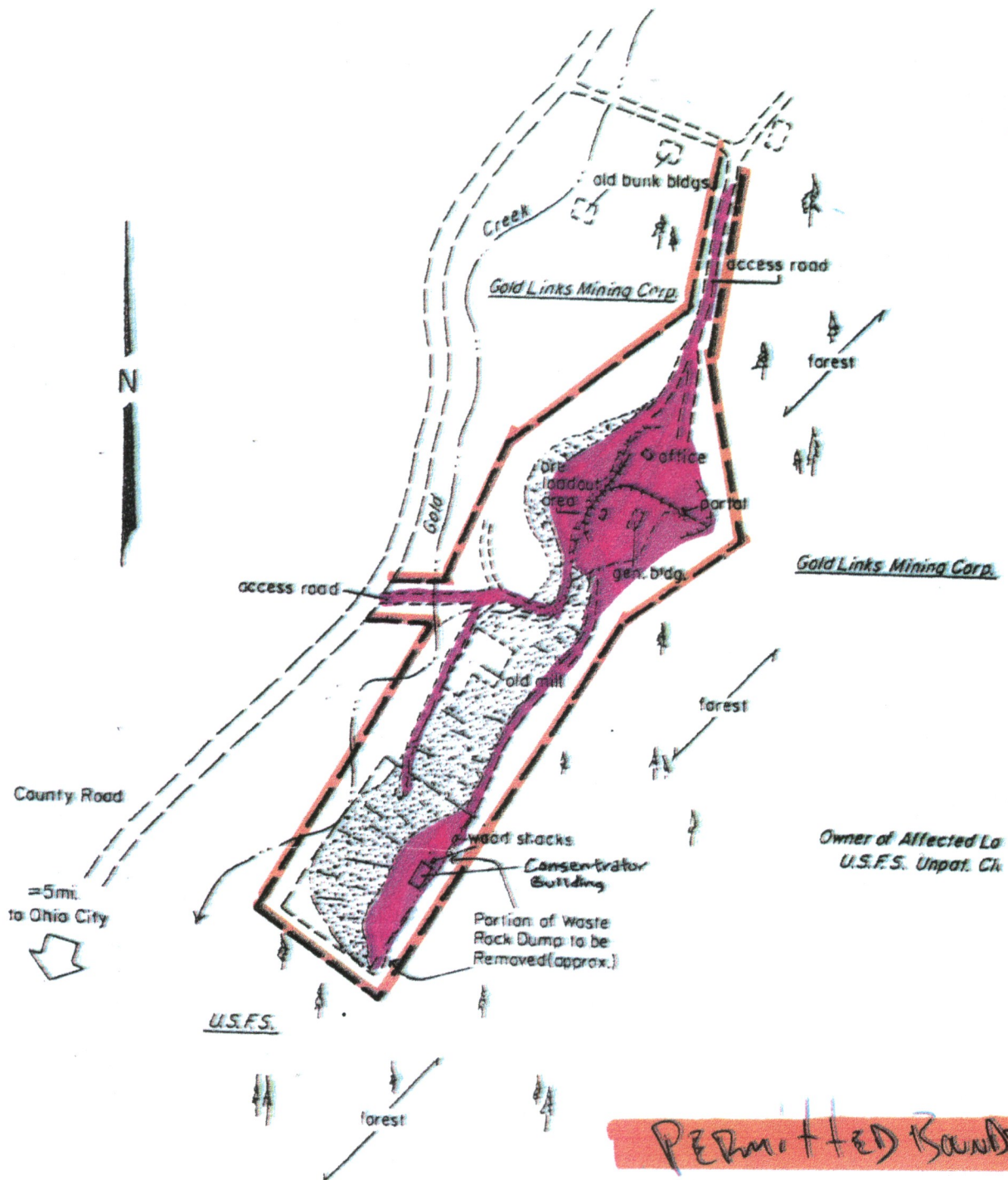

PERMITTED BOUNDARY  
CURRENT AFFECTED AREA

C-1-B





## COLORADO

Division of Reclamation,  
Mining and Safety

Department of Natural Resources

1313 Sherman St. Room 215  
Denver, CO 80203

June 1, 2015

Robert Gydesen  
CRG Mining, LLC  
502 S. Wisconsin Street  
Gunnison, CO 81230

### Gold Links Mine, Permit M-1987-143, Annual Fee Invoice and Report Request

#### **PLEASE READ CAREFULLY – ACTION REQUIRED**

**Please attach your COMPLETED written Annual Report and Annual Report Map to this form**

Under the terms of your Reclamation Permit and Colorado Statutes, you must submit an Annual Fee and Annual Report (including a map). You must pay the Annual Fee and submit an Annual Report each year until reclamation responsibility release is granted. The Annual Fee is not a renewal fee. The Fee and Report are for LAST YEAR'S mining and reclamation season, and MUST be paid even if your operation was inactive.

**The Annual Report and Fee requirement will be considered submitted when we have received the following components:**

1. **APPROPRIATE ANNUAL FEE**
2. **COMPLETED ANNUAL REPORT**
3. **ASSOCIATED MAP as required by rule**

If you have requested reclamation responsibility release from the Division of Reclamation, Mining and Safety (the "Division") but your permit is not released by the anniversary date listed below, the Annual Fee MUST be paid. If the permit is released before the anniversary date, then by Statute, it is not necessary to pay an Annual Fee or submit an Annual Report for that year.

Division records indicate the \$259.00 fee is due for the following:

Permit:	M-1987-143
Operation Name:	Gold Links Mine
Anniversary Date:	July 13, 2015
Total Fee Due:	\$259.00 (Due on or before your Anniversary Date)

Return the enclosed Annual Report FORM, a MAP, and a CHECK or MONEY ORDER made payable to: Division of Reclamation, Mining and Safety, 1313 Sherman St., Room 215, Denver, CO 80203. If your records indicate these documents and fees have already been submitted, please notify the Division.



If you have additional comments and/or information that should be provided to the Division, please provide it below or attach it to this form along with your written report and map. Annual Report instructions are enclosed. If you have any questions, please feel free to contact Michelle Ramirez (303) 866-3567 ext 8114. Thank you for your cooperation in this matter.

IF THE ANNUAL FEE SUBMITTALS ARE NOT RECEIVED ON OR BEFORE YOUR ANNIVERSARY DATE, THE ENFORCEMENT PROCESS WILL AUTOMATICALLY BE INITIATED. ENFORCEMENT ACTIONS MAY RESULT IN CIVIL PENALTIES AND/OR REVOCATION OF YOUR PERMIT.

Division of Reclamation, Mining, and Safety

Fee Receipt for M1987143

CRG Mining, LLC

000000000

Receipt #: 19804

Date: 06/26/2015

Permit: M1987143

Payment Method	Revenue Code	Fee Description/Notes	Amount
1590 SDT	4300-MAF0	Minerals Annual Fees M1987-143	\$259.00
Receipt Total:			\$259.00