



**COLORADO DIVISION OF RECLAMATION, MINING AND SAFETY
MINERALS PROGRAM INSPECTION REPORT
PHONE: (303) 866-3567**

The Division of Reclamation, Mining and Safety has conducted an inspection of the mining operation noted below. This report documents observations concerning compliance with the terms of the permit and applicable rules and regulations of the Mined Land Reclamation Board.

MINE NAME: Sunbeam Pit #1	MINE/PROSPECTING ID#: M-2002-059	MINERAL: Sand and gravel	COUNTY: Moffat
INSPECTION TYPE: Monitoring	INSPECTOR(S): Amy C. Yeldell, Stephanie Mitchell	INSP. DATE: June 16, 2015	INSP. TIME: 12:20
OPERATOR: Moffat County	OPERATOR REPRESENTATIVE: Billy Mack	TYPE OF OPERATION: 112c - Construction Regular Operation	

REASON FOR INSPECTION: Normal I&E Program	BOND CALCULATION TYPE: None	BOND AMOUNT: \$0.00
DATE OF COMPLAINT: NA	POST INSP. CONTACTS: None	JOINT INSP. AGENCY:
WEATHER: Windy	INSPECTOR'S SIGNATURE: 	SIGNATURE DATE: June 29, 2015

GENERAL INSPECTION TOPICS

This list identifies the environmental and permit parameters inspected and gives a categorical evaluation of each. No problems or possible violations were noted during the inspection. The mine operation was found to be in full compliance with Mineral Rules and Regulations of the Colorado Mined Land Reclamation Board for the Extraction of Construction Materials and/or for Hard Rock, Metal and Designated Mining Operations. Any person engaged in any mining operation shall notify the office of any failure or imminent failure, as soon as reasonably practicable after such person has knowledge of such condition or of any impoundment, embankment, or slope that poses a reasonable potential for danger to any persons or property or to the environment; or any environmental protection facility designed to contain or control chemicals or waste which are acid or toxic-forming, as identified in the permit.

(AR) RECORDS----- <u>N</u>	(FN) FINANCIAL WARRANTY----- <u>N</u>	(RD) ROADS----- <u>Y</u>
(HB) HYDROLOGIC BALANCE----- <u>Y</u>	(BG) BACKFILL & GRADING----- <u>Y</u>	(EX) EXPLOSIVES----- <u>NA</u>
(PW) PROCESSING WASTE/TAILING---- <u>Y</u>	(SF) PROCESSING FACILITIES----- <u>NA</u>	(TS) TOPSOIL----- <u>Y</u>
(MP) GENL MINE PLAN COMPLIANCE- <u>Y</u>	(FW) FISH & WILDLIFE----- <u>NA</u>	(RV) REVEGETATION---- <u>Y</u>
(SM) SIGNS AND MARKERS----- <u>Y</u>	(SP) STORM WATER MGT PLAN---- <u>N</u>	(SB) COMPLETE INSP---- <u>Y</u>
(ES) OVERBURDEN/DEV. WASTE----- <u>N</u>	(SC) EROSION/SEDIMENTATION--- <u>Y</u>	(RS) RECL PLAN/COMP-- <u>Y</u>
(AT) ACID OR TOXIC MATERIALS----- <u>NA</u>	(OD) OFF-SITE DAMAGE----- <u>Y</u>	(ST) STIPULATIONS----- <u>Y</u>

Y = Inspected and found in compliance / N = Not inspected / NA = Not applicable to this operation / PB = Problem cited / PV = Possible violation cited

OBSERVATIONS

This inspection was conducted as part of the Colorado Division of Reclamation, Mining and Safety normal monitoring program. The Sunbeam Pit #1 is a 112c permitted site. It is located approximately 5.5 miles northeast of Maybell and is accessed from Highway 318. Billy Mack represented Moffat County and accompanied Amy Yeldell and Stephanie Mitchell of the Division on the inspection.

The mine identification sign and affected area boundary markers are in place and in compliance with Rule 3.1.12. The sign is located at the entrance of the permit boundary. The perimeter has been mowed/cleared just within the boundary and t-posts have been placed to clearly delineate permit boundaries. The key corners are also marked with posts that state "permit boundary".

The site is active and work was being performed during inspection. Mining operations are moving east and are currently on the west portion of the permit area. The pit is mined to a depth of approximately 10-15 feet, with slopes noted during the inspection no steeper than 3H:1V. Several pieces of equipment were observed on site, present was a grader, crusher, loader, dozer and small crane. Also on site was a porta John and a mobile fuel tank located in a lined secondary containment.

Several stockpiles of materials were noted. All of which are stable with no erosion.

The topsoil piles are clearly marked with signage to prevent accidental loss. The piles were seeded approximately 10 years ago and have excellent vegetative cover. They are stabilized with the approved seed mix as well as other volunteer species.

No problems or violations were noted during this inspection.

Responses to this inspection report should be directed to Amy Yeldell at the Division of Reclamation, Mining and Safety, Grand Junction Field Office, 1010 South 3rd Street, Room 301, Grand Junction, Colorado 81501, phone no. 970-254-8511.

PHOTOGRAPHS

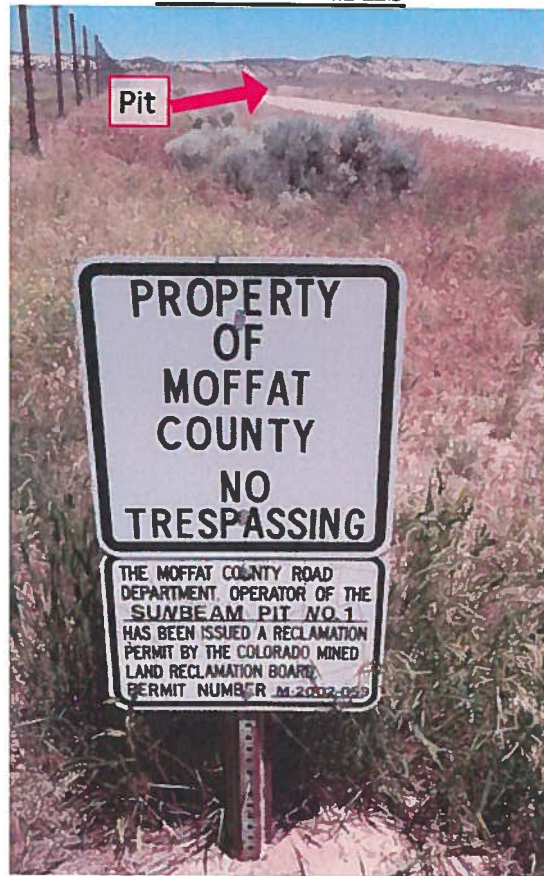

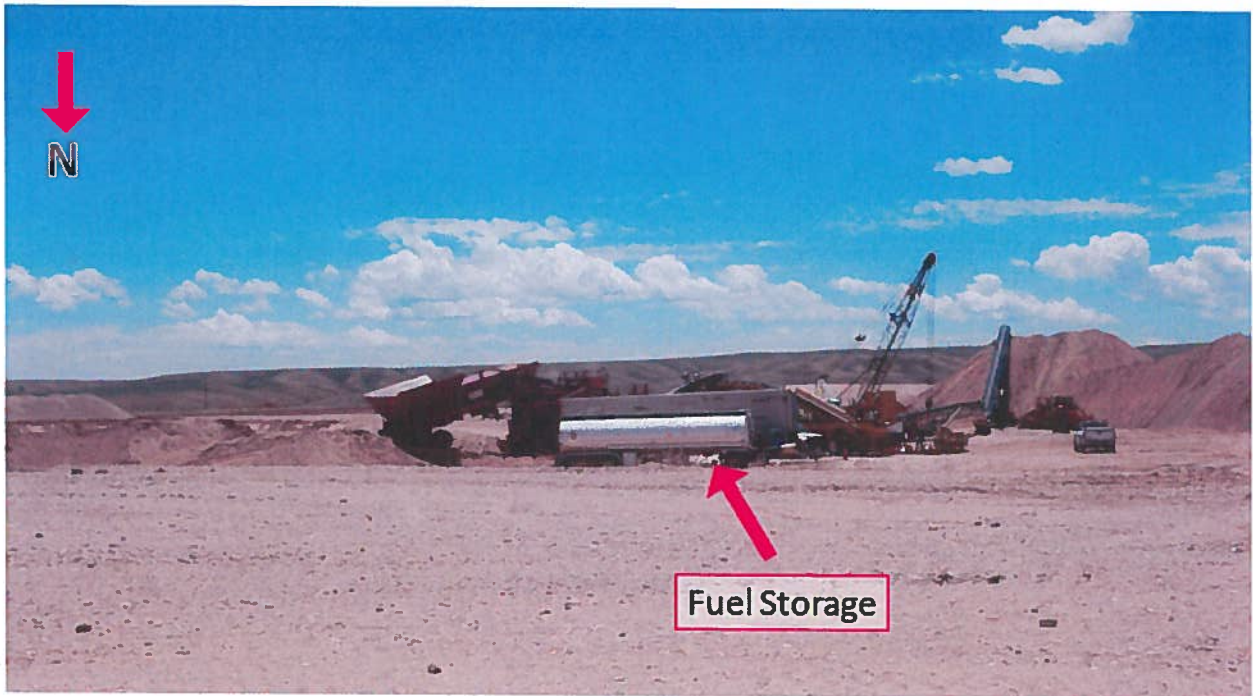

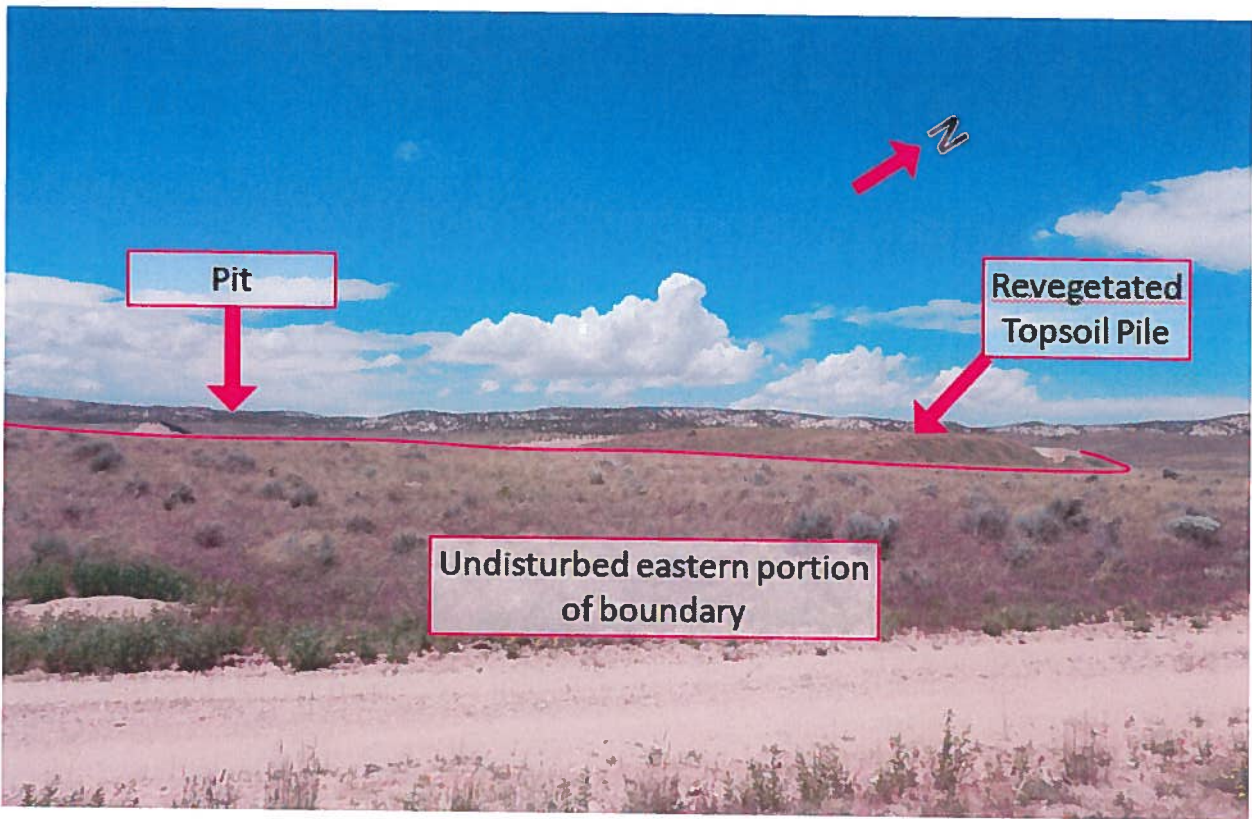

Inspection Contact Address

Billy Mack
Moffat County
P.O. Box 667
Craig, CO 81626

Enclosure

CC:

Russ Means, Senior EPS / Field Office Supervisor, Grand Junction DRMS
Stephanie Mitchell, EPS, Grand Junction DRMS