

Dmc

RECEIVED

JUN 04 2015

112c Annual Report

DIVISION OF RECLAMATION,  
MINING SAFETY MINERALS  
FEE REPORT  
West End Gravel Pit #1

Permittee Name:	West End Gravel Pit #1	Permit Number:	M-1994-011
Operation Name:	West End Gravel Pit #1	County:	Montrose
Annual Fee Due:	\$791.00	Anniversary Date:	April 5, 2015
Permit Acreage:	39.40	Current Bond Amt:	\$50,075.00

According to C.R.S. 34-32.5-116 or 34-32-116, each year, on the anniversary date of the permit, an operator shall submit the Annual Fee, an Annual Report and Map showing the extent of current disturbances to affected land, required monitoring information, reclamation accomplished to date and during the preceding year, any new disturbance that is anticipated to occur during the upcoming year, any reclamation that will be performed during the upcoming year, the dates for the beginning of active operations, and the date active operations ceased for the year.

Information contained in this report will be reviewed by the Division upon receipt and prior to the next compliance inspection of the site. If, while completing this report, you learn that your site is not in compliance with the rules and the act, it is advisable that the issues be rectified promptly to avoid possible enforcement action.

1. Is the site identification sign posted in accordance with Rule 3.1.12(1). YES NO
2. Is the affected area boundary clearly marked in accordance with Rule 3.1.12(2). YES NO
3. Is the mine site in final reclamation (all material extraction and stockpile removal is complete)?  
If "YES," please note time limits related to completion of reclamation, Rule 3.1.3. YES NO
4. What was the date of last excavation, processing or hauling activity at the mine? \_\_\_\_\_
5. Does the mine operate more than 180 days per year?  
If "NO", please review Rule 1.13 to assure that your mine is in compliance. YES NO
6. Has this mine been granted: a) approval of TEMPORARY CESSATION Status? YES NO  
b) approval for INTERMITTENT OPERATION? YES NO
7. Number of acres currently affected (mining + incomplete and or unreleased reclamation). 0
8. Number of acres that were newly affected during the current report year. 0
9. Number of acres that were reclaimed during the current report year. 0
10. Estimated new acreage to be affected in the next report year. 0
11. Estimated acres to be reclaimed in the next report year. 0
12. Total acres in various stages of reclamation, since permitted mining activities began:

Total acres backfilled:	39.40	Total acres seeded w/ approved mix:	39.40 per landowner	Total acres w/topsoil replaced:	39.40	Total acres mulched w/ approved mulch:	0
Total acres graded:	39.40	Total acres fertilized w/ apvd fertilizer:	per landowner	Topsoil replacement depth (in.):	6" 12"	Mulch application rate (tons/ac):	0
Seed application method:	Broad-cast	Fertilizer application method:	per landowner	Mulch application method:			0

All reclamation is complete - recontoured, stockpile removed.

13. Is weed control being conducted in accordance with an approved Weed Control Plan? YES NO N/A  
If "YES", indicate the weed species, control area, control type, application rate and treatment date on the report map.
14. Is adequate topsoil reserved for reclamation, based on your approved permit? YES NO N/A  
If "NO", please explain:
15. Is the reserved topsoil vegetated/stabilized in accordance with Rule 3.1.9(1)? YES NO N/A  
If "NO" please explain:
16. If mining has exposed groundwater, is the site in compliance with the approved mining plan and Office of the State Engineer (Well Permit, S.W.S.P., and/or Permanent Augmentation Plan)? YES NO N/A
17. Are all hazardous materials stored within approved spill containment structures? YES NO N/A
18. Is your financial warranty value sufficient to cover the cost to complete reclamation? YES NO N/A
19. Is your basis for legal right to enter still valid? YES NO
20. Does your permit require you to submit monitoring information annually? YES NO N/A  
If "Yes", please attach the required monitoring results to this Annual Report.
21. As required by Colorado Mined Land Reclamation Act and/or Colorado Land Reclamation Act for the Extraction of Construction Materials (C.R.S. 34-32-116 or 34-32.5-116), attach a map to this report that accurately depicts the permit boundary, current affected area boundary and location of the acreages specified in items 7- 12 and 14.  
UPDATED MAP ATTACHED: yes

Division records indicate the following permittee contact information. If this information is not current, please type or print current contact information:

Permittee Contact:	Bob Sutherland	
Permittee Company:	West End Gravel Company	
Address:	29703 Hwy 97 P.O. Box 889 Nucla, CO 81424	
Phone Number:	(970) 864-7662	
Fax Number:	(970) 864-7980	
Email Address:	CF.PR.email	

I, the undersigned, hereby state that the information provided in this report is true and accurate, and that site operations are being conducted in accordance with the Division approved mining and reclamation plans.

Bob Sutherland  
Signature of Permittee, Corporate Officer, Owner, or Documented Designee

5-31-15  
Date



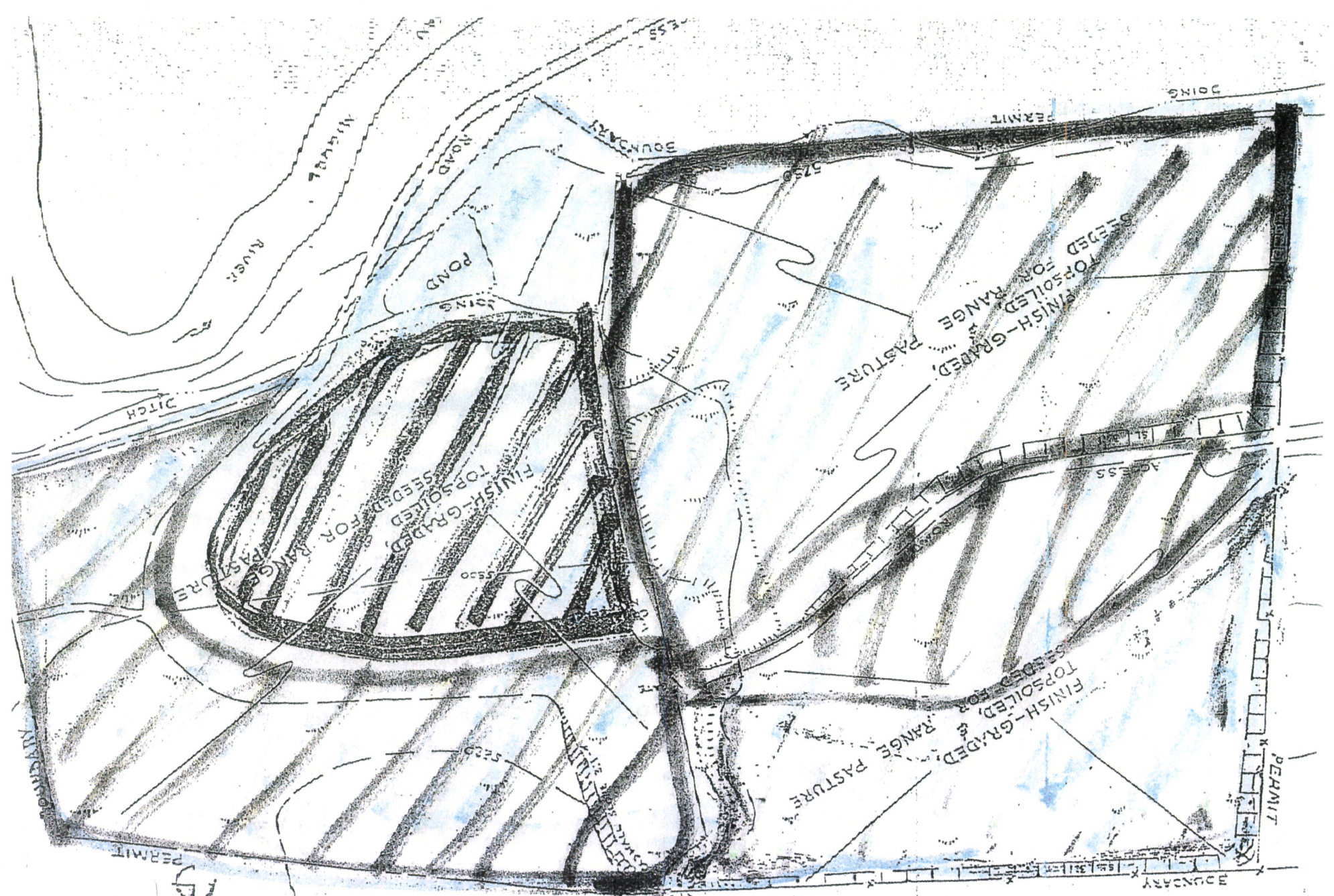

RECLAMATION  
MAP  
GRAVEL PIT  
ST. END

SCALE  
0 100 200 300  
FEET

BLUE = RECLAIMED AREA

**Division of Reclamation, Mining, and Safety**

**Fee Receipt for M1994011**

**West End Gravel Company**

000000000

**Receipt #:** 19661  
**Date:** 06/04/2015  
**Permit:** M1994011

Payment Method	Revenue Code	Fee Description/Notes	Amount
17985 SDT	4300-MAF0	Minerals Annual Fees M1994-011	\$791.00
Receipt Total:			\$791.00



Bob Sutherland  
West End Gravel Company  
29703 Hwy 97  
PO Box 889  
Mile, CO 81424

**CERTIFIED MAIL®**

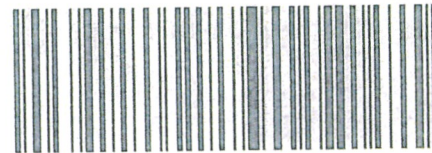

7015 0640 0007 9559 5029



UNITED STATES POSTAGE  
PITNEY BOWE  
\$ 006.74  
02 1P  
0001920010 JUN 01 201  
MAILED FROM ZIP CODE 8142

Division of Reclamation, Mining & Safety  
1313 Sherman St, Room 215  
Denver, CO 80203

8020332243

