

RECEIVED

MAY 05 2015

Page 2 of 3

DIVISION OF RECLAMATION,
MINING & SAFETY-MINERALS
FEE REPORT MAP

112c Annual Report

Permittee Name:	Carrizo Stone, LLC	Permit Number:	M-2005-067
Operation Name:	Carrizo Stone North	County:	Baca
Annual Fee Due:	\$791.00	Anniversary Date:	May 3, 2015
Permit Acreage:	28.00	Current Bond Amt:	\$42,000.00

According to C.R.S. 34-32.5-116 or 34-32-116, each year, on the anniversary date of the permit, an operator shall submit the Annual Fee, an Annual Report and Map showing the extent of current disturbances to affected land, required monitoring information, reclamation accomplished to date and during the preceding year, any new disturbance that is anticipated to occur during the upcoming year, any reclamation that will be performed during the upcoming year, the dates for the beginning of active operations, and the date active operations ceased for the year.

Information contained in this report will be reviewed by the Division upon receipt and prior to the next compliance inspection of the site. If, while completing this report, you learn that your site is not in compliance with the rules and the act, it is advisable that the issues be rectified promptly to avoid possible enforcement action.

1. Is the site identification sign posted in accordance with Rule 3.1.12(1). YES NO
2. Is the affected area boundary clearly marked in accordance with Rule 3.1.12(2). YES NO

3. Is the mine site in final reclamation (all material extraction and stockpile removal is complete)? YES NO
If "YES," please note time limits related to completion of reclamation, Rule 3.1.3.

4. What was the date of last excavation, processing or hauling activity at the mine?

4-30-15

5. Does the mine operate more than 180 days per year? YES NO
If "NO", please review Rule 1.13 to assure that your mine is in compliance.

6. Has this mine been granted: a) approval of TEMPORARY CESSATION Status? YES NO
b) approval for INTERMITTENT OPERATION? YES NO

NA

7. Number of acres currently affected (mining + incomplete and or unreleased reclamation).

9

8. Number of acres that were newly affected during the current report year.

8-3/8 Acre

9. Number of acres that were reclaimed during the current report year.

0

10. Estimated new acreage to be affected in the next report year.

0-1/2 Acre

11. Estimated acres to be reclaimed in the next report year.

0

12. **Total acres** in various stages of reclamation, since permitted mining activities began:

Total acres backfilled:		Total acres seeded w/ approved mix:		Total acres w/topsoil replaced:		Total acres mulched w/ approved mulch:	
Total acres graded:		Total acres fertilized w/ apvd fertilizer:		Topsoil replacement depth (in.):		Mulch application rate (tons/ac):	
Seed application method:		Fertilizer application method:		Mulch application method:			

* DUE TO SEVERE DROUGHT AGAIN,
UNABLE TO GET COVER CROP.

13. Is weed control being conducted in accordance with an approved Weed Control Plan? **YES** NO N/A
If "YES", indicate the weed species, control area, control type, application rate and treatment date on the report map.
14. Is adequate topsoil reserved for reclamation, based on your approved permit? **YES** NO N/A
If "NO", please explain:
15. Is the reserved topsoil vegetated/stabilized in accordance with Rule 3.1.9(1)? **YES** NO N/A
If "NO" please explain:
16. If mining has exposed groundwater, is the site in compliance with the approved mining plan and Office of the State Engineer (Well Permit, S.W.S.P., and/or Permanent Augmentation Plan)? YES NO **N/A**
17. Are all hazardous materials stored within approved spill containment structures? YES NO **N/A**
18. Is your financial warranty value sufficient to cover the cost to complete reclamation? **YES** NO N/A
19. Is your basis for legal right to enter still valid? **YES** NO
20. Does your permit require you to submit monitoring information annually? YES **NO** N/A
If "Yes", please attach the required monitoring results to this Annual Report.
21. As required by Colorado Mined Land Reclamation Act and/or Colorado Land Reclamation Act for the Extraction of Construction Materials (C.R.S. 34-32-116 or 34-32.5-116), attach a map to this report that accurately depicts the permit boundary, current affected area boundary and location of the acreages specified in items 7- 12 and 14.
UPDATED MAP ATTACHED: ✓

Division records indicate the following permittee contact information. If this information is not current, please type or print **current** contact information:

Permittee Contact:	Stephanie and Ray Sikes	
Permittee Company:	Carrizo Stone, LLC	
Address:	1425 County Road Q Pritchett, CO 81064	
Phone Number:	(719) 643-5325	
Fax Number:	(719) 643-5327	
Email Address:	CF.PR.email	

I, the undersigned, hereby state that the information provided in this report is true and accurate, and that site operations are being conducted in accordance with the Division approved mining and reclamation plans.

Ray Sikes
Signature of **Permittee, Corporate Officer, Owner, or Documented Designee**

5-1-15
Date

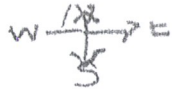

North
↑

Carrizo North
Stone
m-2005-064
5-1-2015

Exhibit C

Mining
Map

RECEIVED

MAY 05 2015

DIVISION OF RECLAMATION
MINING AND SAFETY

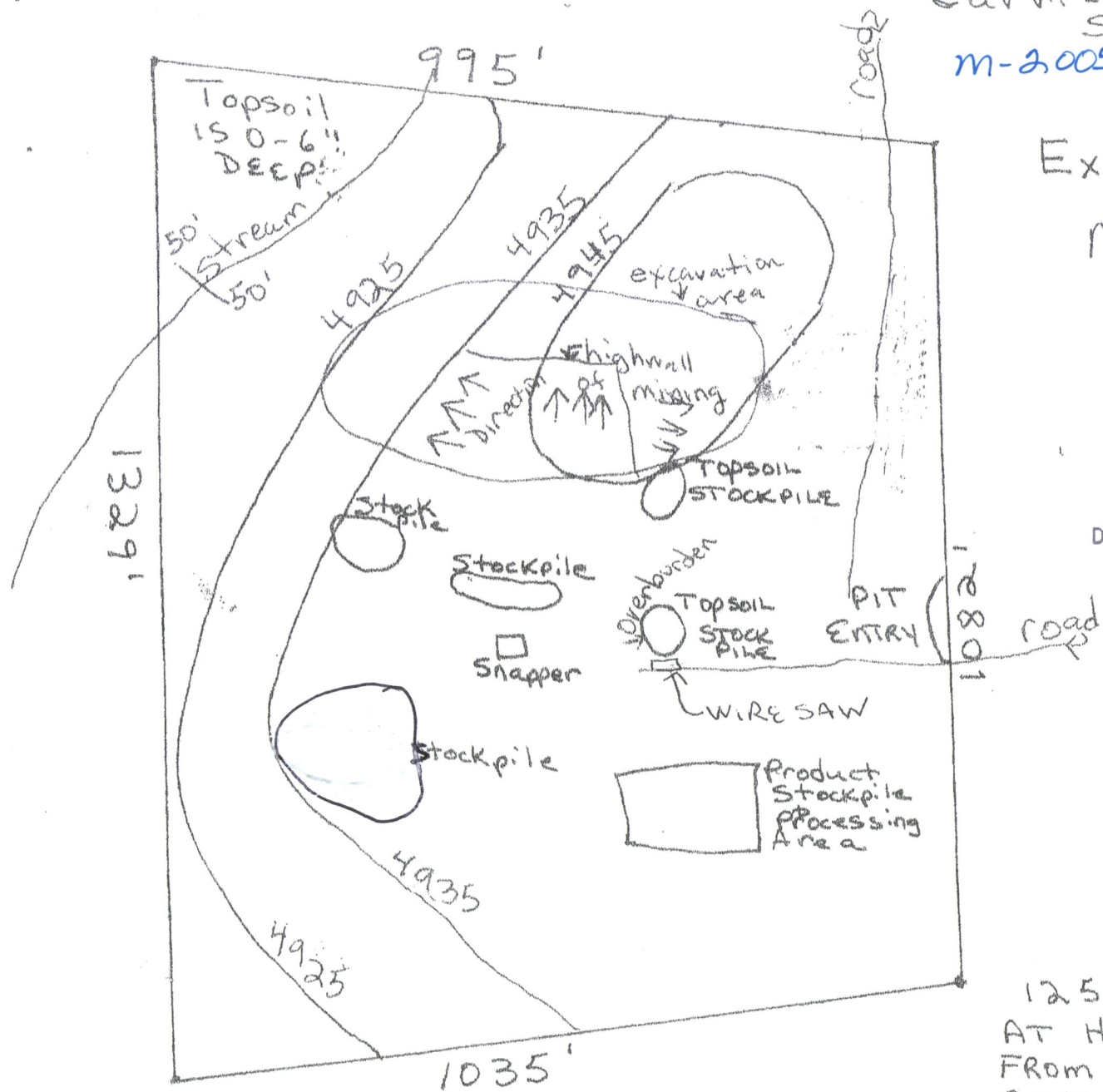

1256 FEET
AT HEADING 257.84'
FROM CORNER OF
SECTION 9 and 16
TO SE CORNER

Scale
1" = 200 Feet

Prepared by Ray & Stephanie Sikes *All surrounding lands owned by Ray & Stephanie Sikes

CARRIZO STONE, L.L.C.
1425 County Road Q
Pritchett, CO 81064

TO;

STATE OF COLORADO
Division of Reclamation, Mining and Safety
Department of Natural Resources
1313 Sherman Street, Room 215
Denver, CO 80203-2273

ANNUAL REPORT FOR CARRIZO STONE,NORTH:M-2005-067

This is the annual report for Carrizo Stone,North,M-2005-067. All forms have been filled out. Enclosed find an update map for 2015.

No reclamation has commenced since date of operation.

Enclosed find a check for \$791.00 for mining fee to the state.

Thank you.

Sincerely,

A handwritten signature in black ink, appearing to read "Ray and Stephanie Sikes", written in a cursive style.

Ray and Stephanie Sikes,owners and operators
Carrizo Stone,North

STATE OF COLORADO

DIVISION OF RECLAMATION, MINING AND SAFETY

Department of Natural Resources

1313 Sherman St., Room 215
Denver, Colorado 80203
Phone: (303) 866-3567
FAX: (303) 832-8106



April 1, 2015

Stephanie and Ray Sikes
Carrizo Stone, LLC
1425 County Road Q
Pritchett, CO 81064

John W. Hickenlooper
Governor

Mike King
Executive Director

Virginia Brannon
Director

Carrizo Stone North, Permit M-2005-067, Annual Fee Invoice and Report Request

PLEASE READ CAREFULLY – ACTION REQUIRED

Please attach your COMPLETED written Annual Report and Annual Report Map to this form

Under the terms of your NOI or Reclamation Permit and Colorado Statutes, you must submit Annual Fees and Annual Reports (including a map). You must pay the Annual Fee and submit an Annual Report each year until reclamation responsibility release is granted. The Annual Fee is not a renewal fee. The Fee and Report are for LAST YEAR'S mining and reclamation season, and MUST be paid even if your operation was inactive.

The Annual Report and Fee requirement will be considered submitted when we have received the following components:

1. **APPROPRIATE ANNUAL FEE**
2. **COMPLETED ANNUAL REPORT**
3. **ASSOCIATED MAP as required by rule**

If you have requested reclamation responsibility release from the Division of Reclamation, Mining and Safety ("Division") but your permit is not released by the anniversary date listed below, the Annual Fee MUST be paid. If the permit is released before the anniversary date, then by Statute, it is not necessary to pay an Annual Fee or submit an Annual Report for that year.

Division records indicate the \$791.00 fee is due for the following:

Permit: M-2005-067
Operation Name: Carrizo Stone North
Anniversary Date: May 3, 2015
Total Fee Due: \$791.00 (Due on or before your Anniversary Date)

Return the enclosed Annual Report FORM, a MAP, and a CHECK or MONEY ORDER made payable to: Division of Reclamation, Mining and Safety, 1313 Sherman St., Room 215, Denver, CO 80203. If your records indicate these documents and fees have already been submitted, please notify the Division.

If you have additional comments and/or information that should be provided to the Division, please provide it below or attach it to this form along with your written report and map. Annual Report instructions are enclosed. If you have any questions, please feel free to contact Michelle Ramirez (303) 866-3567 ext 8114. Thank you for your cooperation in this matter.

IF THE ANNUAL FEE SUBMITTALS ARE NOT RECEIVED ON OR BEFORE YOUR ANNIVERSARY DATE, THE ENFORCEMENT PROCESS WILL AUTOMATICALLY BE INITIATED. ENFORCEMENT ACTIONS MAY RESULT IN CIVIL PENALTIES AND/OR REVOCATION OF YOUR PERMIT.

Division of Reclamation, Mining, and Safety

Fee Receipt for M2005067

Carrizo Stone, LLC

000000000

Receipt #: 19491

Date: 05/05/2015

Permit: M2005067

Payment Method	Revenue Code	Fee Description/Notes	Amount
2472 msr	4300-MAF0	Minerals Annual Fees M2005-067	\$791.00
Receipt Total:			\$791.00