

RECEIVED

NOV 24 2014

DIVISION OF RECLAMATION,
MINING & SAFETY-MINERALS
FEE, REPORT, MAP

112c Annual Report

Permittee Name:	Asphalt Specialties Co., Inc.	Permit Number:	M-1983-176
Operation Name:	Speer Mining Resource	County:	Adams
Annual Fee Due:	\$791.00	Anniversary Date:	December 9, 2014
Permit Acreage:	75.50	Current Bond Amt:	\$678,169.00

According to C.R.S. 34-32.5-116 or 34-32-116, each year, on the anniversary date of the permit, an operator shall submit the Annual Fee, an Annual Report and Map showing the extent of current disturbances to affected land, required monitoring information, reclamation accomplished to date and during the preceding year, any new disturbance that is anticipated to occur during the upcoming year, any reclamation that will be performed during the upcoming year, the dates for the beginning of active operations, and the date active operations ceased for the year.

Information contained in this report will be reviewed by the Division upon receipt and prior to the next compliance inspection of the site. If, while completing this report, you learn that your site is not in compliance with the rules and the act, it is advisable that the issues be rectified promptly to avoid possible enforcement action.

- Is the site identification sign posted in accordance with Rule 3.1.12(1). YES NO
- Is the affected area boundary clearly marked in accordance with Rule 3.1.12(2). YES NO
NO LONGER APPLICABLE: MINED-OUT
- Is the mine site in final reclamation (all material extraction and stockpile removal is complete)? YES NO
If "YES," please note time limits related to completion of reclamation, Rule 3.1.3.
ONE SMALL AREA REMAINS IN S.E. CORNER
- What was the date of last excavation, processing or hauling activity at the mine? 2006
- Does the mine operate more than 180 days per year? YES NO
If "NO", please review Rule 1.13 to assure that your mine is in compliance.
- Has this mine been granted: a) approval of TEMPORARY CESSATION Status? YES NO
b) approval for INTERMITTENT OPERATION? YES NO
- Number of acres currently affected (mining + incomplete and or unreleased reclamation). ± 50
- Number of acres that were newly affected during the current report year. 0
- Number of acres that were reclaimed during the current report year. 3.0
- Estimated new acreage to be affected in the next report year. 0
- Estimated acres to be reclaimed in the next report year. 3.0
- Total acres in various stages of reclamation, since permitted mining activities began:

Total acres backfilled:	± 50	Total acres seeded w/ approved mix:	0	Total acres w/topsoil replaced:	0	Total acres mulched w/ approved mulch:	0
Total acres graded:	± 47	Total acres fertilized w/ apvd fertilizer:	0	Topsoil replacement depth (in.):	0	Mulch application rate (tons/ac):	0
Seed application method:	N/A	Fertilizer application method:	N/A	Mulch application method:	N/A		

13. Is weed control being conducted in accordance with an approved Weed Control Plan? ☒ YES ☐ NO ☐ N/A
If "YES", indicate the weed species, control area, control type, application rate and treatment date on the report map.
14. Is adequate topsoil reserved for reclamation, based on your approved permit? ☒ YES ☐ NO ☐ N/A
If "NO", please explain:
15. Is the reserved topsoil vegetated/stabilized in accordance with Rule 3.1.9(1)? YES ☒ NO ☐ N/A
If "NO" please explain: CONSTANTLY BEING ADDED TO FROM
OPPOSITE SOURCES
16. If mining has exposed groundwater, is the site in compliance with the approved mining plan and Office of the State Engineer (Well Permit, S.W.S.P., and/or Permanent Augmentation Plan)? ☒ YES ☐ NO ☐ N/A
17. Are all hazardous materials stored within approved spill containment structures? YES ☐ NO ☒ N/A
18. Is your financial warranty value sufficient to cover the cost to complete reclamation? ☒ YES ☐ NO ☐ N/A
19. Is your basis for legal right to enter still valid? ☒ YES ☐ NO
20. Does your permit require you to submit monitoring information annually? ☒ YES ☐ NO ☐ N/A
If "Yes", please attach the required monitoring results to this Annual Report.
21. As required by Colorado Mined Land Reclamation Act and/or Colorado Land Reclamation Act for the Extraction of Construction Materials (C.R.S. 34-32-116 or 34-32.5-116), attach a map to this report that accurately depicts the permit boundary, current affected area boundary and location of the acreages specified in items 7- 12 and 14.
UPDATED MAP ATTACHED: YES

Division records indicate the following permittee contact information. If this information is not current, please type or print current contact information:

Permittee Contact:	Rob Laird	
Permittee Company:	Asphalt Specialties Co., Inc.	
Address:	10100 Dallas St. Henderson, CO 80640	
Phone Number:	(303) 289-8555	
Fax Number:	(303) 289-7707	
Email Address:	CF.PR.email	

I, the undersigned, hereby state that the information provided in this report is true and accurate, and that site operations are being conducted in accordance with the Division approved mining and reclamation plans.

Robert Laird
Signature of Permittee, Corporate Officer, Owner, or Documented Designee

11-19-2014
Date

200 0 200 400
SCALE IN FEET
1" = 400'

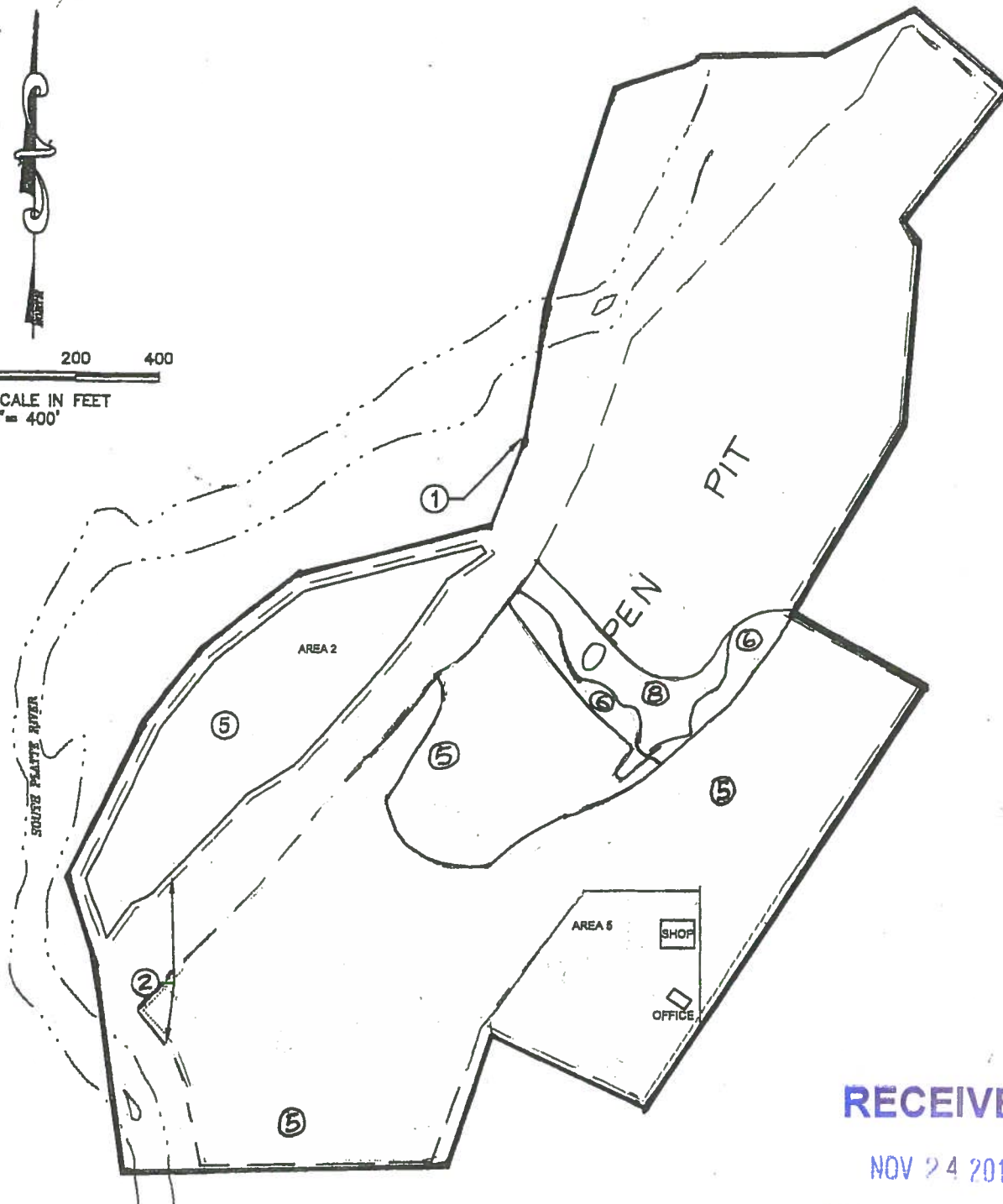

- ① TOTAL ACRES IN PERMIT AREA : 75.5
- ② TOTAL PERMITTED MINEABLE ACRES: 57.2
- ③ CURRENT TOTAL ACRES DISTURBED: APPROX. 53.5
- ④ TOTAL ACRES MINED DURING REPORT YEAR: APPROX. 0
- ⑤ CURRENT TOTAL ACRES IN VARIOUS STAGES OF RECLAMATION: APPROX. 50.0
- ⑥ TOTAL ACRES RECLAIMED DURING REPORT YEAR: 3.0
- ⑦ APPROXIMATE ACREAGE TO BE MINED IN NEXT REPORT YEAR: 0
- ⑧ APPROXIMATE ACREAGE TO BE RECLAIMED IN NEXT REPORT YEAR: 3.0

RECEIVED

NOV 24 2014

DIVISION OF RECLAMATION
MINING AND SAFETY

m-1983-176

ASPHALT
SPECIALTIES CO.
7321 East 88th Ave. • Henderson, CO 80640 • (303) 289-8555 • Fax (303) 289-7707

ANNUAL REPORT MAP: 12/9/13 TO 12/9/14
SPEER MINING RESOURCE
COLORADO
DIVISION OF MINERALS & GEOLOGY

PROJECT	DATE	SCALE	DRAWN BY	DESIGNED BY	APPROVED BY	REV	SHEET
	11/30/14	1"=400'	SSE	RBL			

COLORADO DIVISION OF MINERALS AND GEOLOGY
ANNUAL REPORT FOR
SPEER MINING RESOURCE
M-1983-176 AM-4
ASPHALT SPECIALTIES CO., INC.
DECEMBER 9, 2013 TO DECEMBER 9, 2014

1. TOTAL ACRES IN PERMIT AREA: 75.5
2. TOTAL PERMITTED MINEABLE ACRES: 57.2
3. CURRENT TOTAL ACRES DISTURBED: APPROX. 53.5
4. TOTAL ACRES MINED DURING REPORT YEAR: 0
5. CURRENT TOTAL ACRES IN VARIOUS STAGES OF RECLAMATION: APPROX. 50
6. TOTAL ACRES RECLAIMED DURING REPORT YEAR: 3.0
7. APPROXIMATE ACREAGE TO BE MINED IN NEXT REPORT YEAR: 0
8. APPROXIMATE ACREAGE TO BE RECLAIMED IN NEXT REPORT YEAR: 3.0

This permit site is in the process/stage of reclamation only for the remaining pit area. There is one small area near the entrance remaining to be mined, but that will only occur at the very end of the life of this site as an inert landfill. Amendment AM-4 was approved for this site in the beginning of 2010 allowing for the change in reclamation from a water-storage reservoir to complete backfilling with inert fill, other than a future 7-acre pond. Approximately 3 acres were backfilled during the report year.

No seeding or revegetation was implemented on this site during the report year, as the revised reclamation plan is to progressively backfill the site above the water-table first, then backfill further with a more mixed inert fill, before topsoiling and seeding.

Reclamation during the next reporting year will be as continued backfill in the southern and central area of the permit site.

Sufficiency of Value of Financial Warranty

The permittee holds a Financial Warranty for the permit through Great American Insurance Company in the full amount of \$678,169.00, a figure sufficient to achieve all reclamation requirements under the current permit.

A check in the amount of \$791.00 is being submitted with this report to cover the Annual Fee required to maintain this permit in good standing.



Title SPEER MINING RESOURCE M1983-17 Date 11-20-2014 Job no.

Subject UPGRADIENT MONT. WELL READINGS By R. LAIRD Sheet / of

MW3-AS (SOUTHERN WELL - BRIGHTON RD.) MH-9 (NORTHERN WELL - BRIGHTON RD.)

① MW3-AS

- DATE CONST.: 1-13-2000
- GRND. SURFACE ELEV.: 5027.0'
- T.O.C. (SEED): 5029.7'
- AVG. S.W.L.: 16' (H) - 19' (L)
- T.D. (from T.O.C.): 33.8'

<u>DATE</u>	<u>SWL</u>
6-9-14	14.05'
8-13-14	13.8'
9-2-14	16.0'
10-13-14	16.25'
11-6-14	14.9'

② MH-9

- DATE CONST.: 6-24-2004
- GRND. SURFACE ELEV.: 5021.4'
- T.O.C. (SEED): 5024'
- AVG. S.W.L.: 10' (H) - 13' (L)
- T.D. (from T.O.C.): 20.1'

<u>DATE</u>	<u>SWL</u>
6-9-14	7.3'
8-13-14	8.21'
9-2-14	13.75'
10-13-14	13.75'
11-6-14	13.65'

ASPHALT



SPECIALTIES CO.

10100 Dallas St. • Henderson, CO 80640 • (303) 289-8555 • Fax: (720) 289-7707

November 19, 2014

Ms. Christine Brookshire
Colorado Div. of Minerals and Geology
1313 Sherman Street, Room 215
Denver, Colorado 80203

RE: Annual Report and Fees for Speer Mining Resource Permit No. M-1983-176, December 9, 2013
to December 9, 2014

Dear Ms. Brookshire:

Enclosed please find the referenced complete report and map and annual report fee in the form of a check made out to the Division in the amount of \$791.00.

Please log-in the report and fees as being submitted within the time frame required and call me with any questions or concerns. Thank you for your attention to this matter and have a good year ahead.

Sincerely,

Rob Laird
Land Manager

cc: file

Division of Reclamation, Mining, and Safety

Fee Receipt for M1983176

Asphalt Specialties Co., Inc.

000000000

Receipt #: 18582

Date: 11/24/2014

Permit: M1983176

Payment Method	Revenue Code	Fee Description/Notes	Amount
31182 msr	4300-MAF0	Minerals Annual Fees M1983-176	\$791.00
Receipt Total:			\$791.00