

Report



QATESTOCR

DIVISION OF RECLAMATION, MINING & SAFETY-MINERALS

112c Annual Report

Permittee Name:	Lincoln County	Permit Number:	M-1977-163-SG
Operation Name:	Fisher Pit	County:	Lincoln
Annual Fee Due:	\$791.00	Anniversary Date:	November 21, 2014
Permit Acreage:	36.90	Current Bond Amt:	\$0.00

According to C.R.S. 34-32.5-116 or 34-32-116, each year, on the anniversary date of the permit, an operator shall submit the Annual Fee, an Annual Report and map showing the extent of current disturbances to affected land, required monitoring information, reclamation accomplished to date and during the preceding year, any new disturbance that is anticipated to occur during the upcoming year, any reclamation that will be performed during the upcoming year, the dates for the beginning of active operations, and the date active operations ceased for the year.

Information contained in this report will be reviewed by the Division upon receipt and prior to the next compliance inspection of the site. If, while completing this report, you learn that your site is not in compliance with the rules and the act, it is advisable that the issues be rectified promptly to avoid possible enforcement action.

- | | | |
|--|--|----------------------|
| 1. Is the site identification sign posted in accordance with Rule 3.1.12(1). | <u>YES</u> | NO |
| 2. Is the affected area boundary clearly marked in accordance with Rule 3.1.12(2). | <u>YES</u> | NO |
| 3. Is the mine site in final reclamation (all material extraction and stockpile removal is complete)?
If "YES," please note time limits related to completion of reclamation, Rule 3.1.3. | <u>YES</u> | NO |
| 4. What was the date of last excavation, processing or hauling activity at the mine? | <u>July 2010</u> | |
| 5. Does the mine operate more than 180 days per year
If "NO", please review Rule 1.13 to assure that your mine is in compliance. | YES | <u>NO</u> |
| 6. Has this mine been granted: | a) approval of TEMPORARY CESSATION Status? | <u>YES</u> <u>NO</u> |
| | b) approval for INTERMITTENT OPERATION? | <u>YES</u> <u>NO</u> |
| 7. Number of acres currently affected (mining + incomplete and or unreleased reclamation). | <u>35.92</u> | |
| 8. Number of acres that were newly affected during the current report year. | <u>0</u> | |
| 9. Number of acres that were reclaimed during the current report year. | <u>0</u> | |
| 10. Estimated new acreage to be affected in the next report year. | <u>0</u> | |
| 11. Estimated acres to be reclaimed in the next report year. | <u>0</u> | |
| 12. Total acres in various stages of reclamation, since permitted mining activities began: | | |

Total acres backfilled:	0	Total acres seeded w/ approved mix:	0	Total acres w/topsoil replaced:	0	Total acres mulched w/ approved mulch:	0
Total acres graded:	0	Total acres fertilized w/ apvd fertilizer:	0	Topsoil replacement depth (in.):	0	Mulch application rate (tons):	0
Seed application method:	N/A	Fertilizer application method:	N/A		Mulch application method:	N/A	

13. Is weed control being conducted in accordance with an approved Weed Control Plan? YES NO N/A
If "YES", indicate the weed species, control area, control type, application rate and treatment date on the report map.
14. Is adequate topsoil reserved for reclamation, based on your approved permit? YES NO N/A
If "NO", please explain:
15. Is the reserved topsoil vegetated/stabilized in accordance with Rule 3.1.9(1)? YES NO N/A
If "NO" please explain:
16. If mining has exposed groundwater, is the site in compliance with the approved mining plan and Office of the State Engineer (Well Permit, S.W.S.P., and/or Permanent Augmentation Plan)? YES NO N/A
17. Are all hazardous materials stored within approved spill containment structures? YES NO N/A
18. Is your financial warranty value sufficient to cover the cost to complete reclamation? YES NO N/A
19. Is your basis for legal right to enter still valid? YES NO
20. Does your permit require you to submit monitoring information annually? YES NO N/A
If "Yes", please attach the required monitoring results to this Annual Report.
21. As required by Colorado Mined Land Reclamation Act and/or Colorado Land Reclamation Act for the Extraction of Construction Materials (C.R.S. 34-32-116 or 34-32.5-116), attach a map to this report that accurately depicts the permit boundary, current affected area boundary and location of the acreages specified in items 7- 12 and 14.
UPDATED MAP ATTACHED:

Division records indicate the following permittee contact information. If this information is not current, please type or print current contact information:

Permittee Contact:	John DeWitt	
Permittee Company:	Lincoln County	
Address:	P.O. Box 39 Hugo, CO 80821	
Phone Number:	(719) 743-2337	
Fax Number:	(719) 743-2815	
Email Address:	CF.PR.email	

I, the undersigned, hereby state that the information provided in this report is true and accurate, and that site operations are being conducted in accordance with the Division approved mining and reclamation plans.

Signature of Permittee, Corporate Officer, Owner, or Documented Designee

10-20-14
Date

FISHER PIT
M-1977-163-SG

COLORADO DIVISION OF HIGHWAYS

MINING PLAN MAP

MAP 1 OF 2

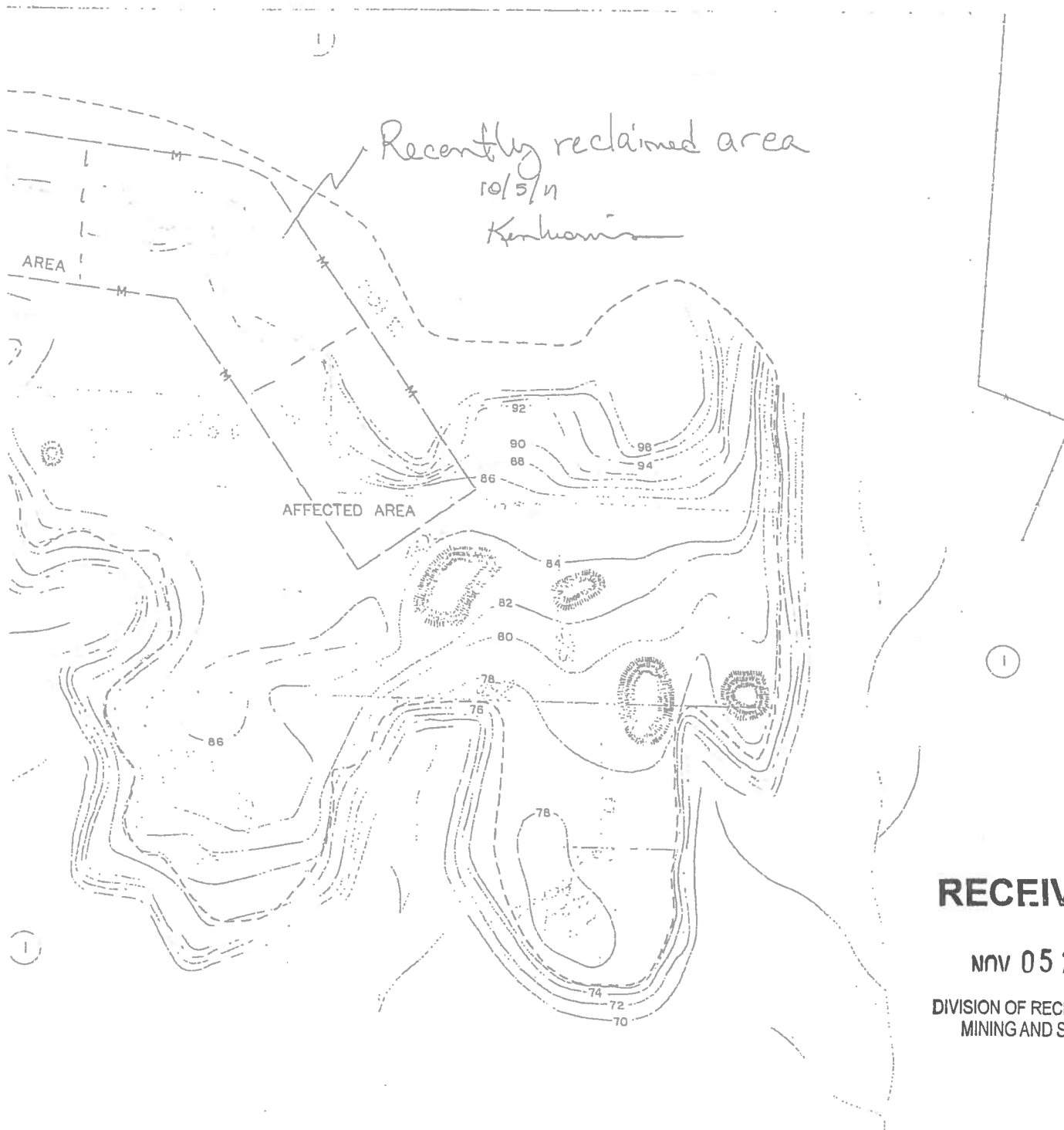

LEGEND



STOCKPILE



DRAINAGE AREA

E. C. CARD P.E.
MAP BY R. HORNER
5-24-78



RECEIVED

NOV 05 2014

DIVISION OF RECLAMATION
MINING AND SAFETY

AFFECTED AREA-----35.92 ACRES TOTAL

FISHER PIT
M-1977-163-SG

MAP 2 OF 2

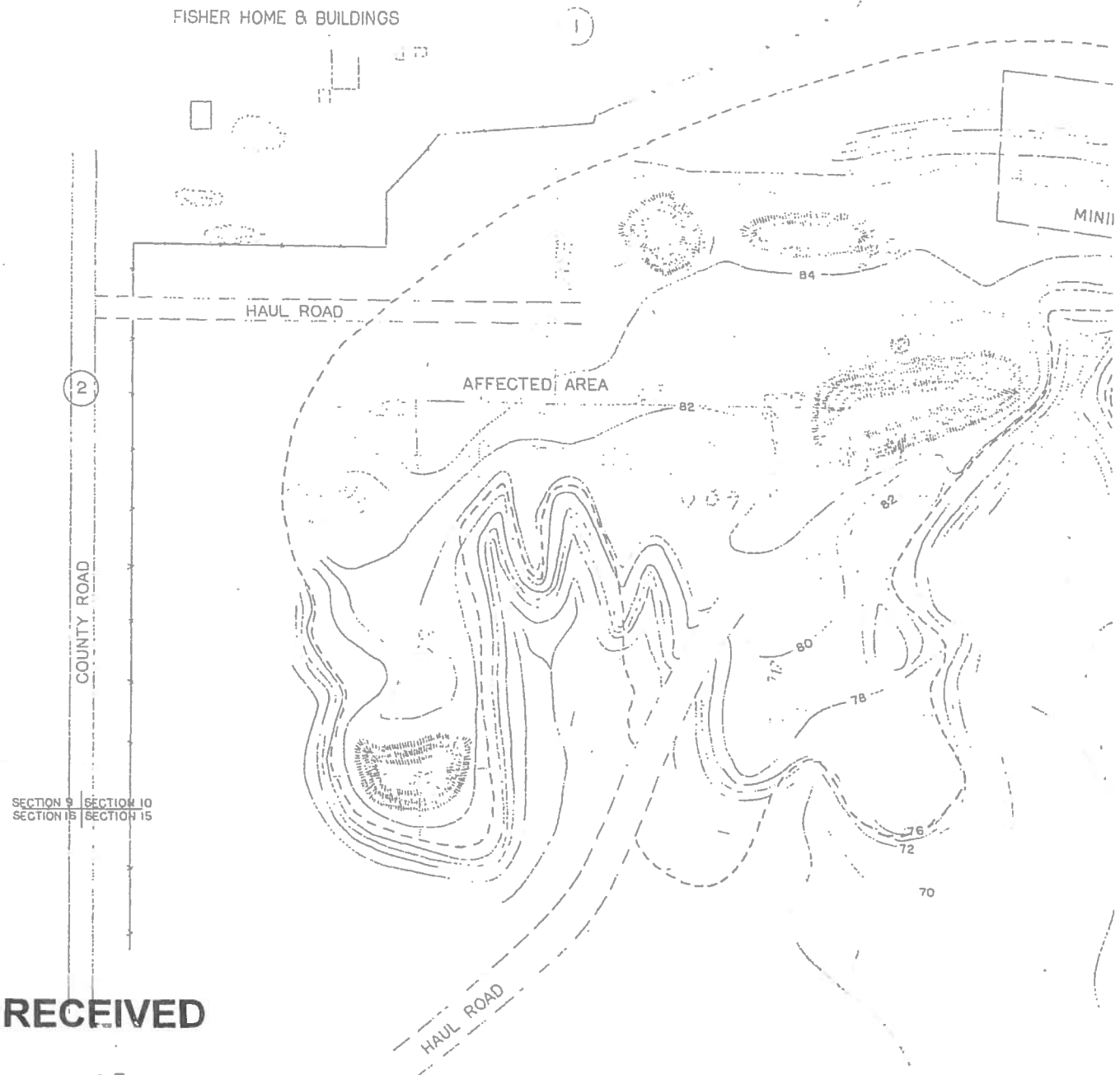

RECEIVED

NOV 05 2014

DIVISION OF RECLAMATION
MINING AND SAFETY

MAP CURRENT AS OF
10/20/14

FISHER PIT

LINCOLN COUNTY
NW 1/4 SECTION 15
SW 1/4 SECTION 10
T9 S, R55 W

OWNERS OF ADJACENT LAND : WAYNE FISHER⁽¹⁾ &
LINCOLN COUNTY⁽²⁾

VEGETATIVE COMMUNITY SURROUNDING THE MINED
AREA : BLUE GRAMA, YUCCA, SAND SAGE, MENT-
ZELIA. RUSSIAN THISTLE. SUNFLOWER. LOCOWEED

Division of Reclamation, Mining, and Safety

Fee Receipt for M1977163SG

Lincoln County

000000000

Receipt #: 18511

Date: 11/05/2014

Permit: M1977163SG

Payment Method	Revenue Code	Fee Description/Notes	Amount
26969 msr	4300-MAF0	Minerals Annual Fees M1977-163SG	\$791.00
Receipt Total:			\$791.00