

S:\CAD\1125G-Squaw VLF\Cadd\Drawings\FC Drawings\314-1125GD88.dwg 1/22/2013 8:50 AM

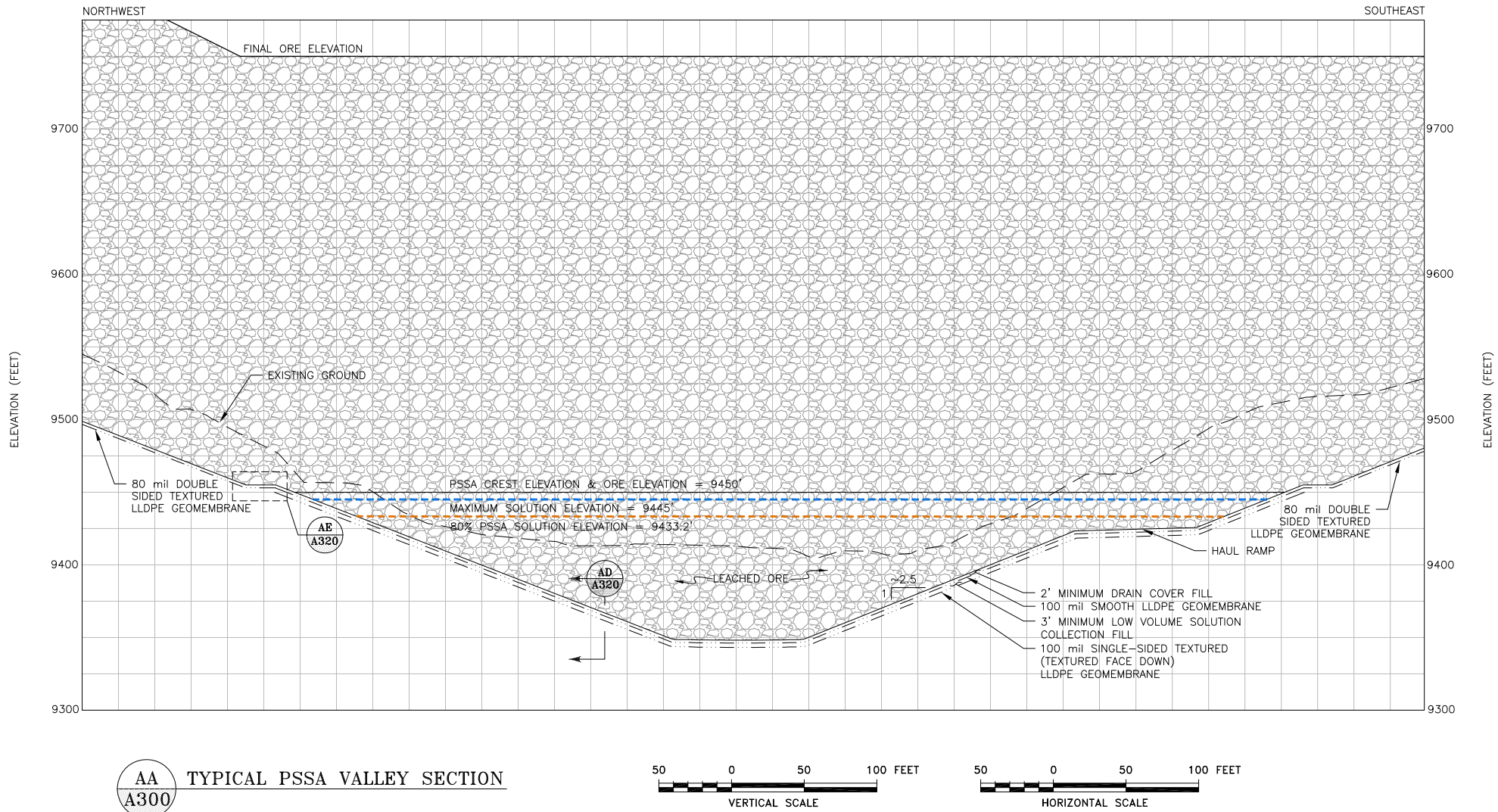

REFERENCE:

EXISTING GROUND TOPOGRAPHY WAS CREATED BY COMBINING THE FOLLOWING FILES
REC'D FROM FORESIGHT WEST SURVEYING, INC.:
SQUAW GULCH BASE TOPO - PHASE 1 - REVISED.DWG (REC'D MARCH 14, 2010)
SQUAW GULCH BASE TOPO - PHASE 2.DWG (REC'D APRIL 24, 2010)
SQUAW GULCH BASE TOPO - PHASE 3.DWG (REC'D MAY 4, 2010)
CCV TOPO EXPANSION 12-29-10 NORTH AREA.DWG (REC'D JANUARY 13, 2011)
CCV TOPO EXPANSION 01-28-11 SOUTH AREA.DWG (REC'D JANUARY 28, 2011)
SH67 TOPO 7-07-11.DWG (REC'D JULY 11, 2011)
VLF2 TOPO EXPANSION 8-05-11.DWG (REC'D AUGUST 9, 2011)
09028-COMPOSITE-TOPO MLE LIMITS.DWG (REC'D MAY 28, 2010 FROM CC&V)

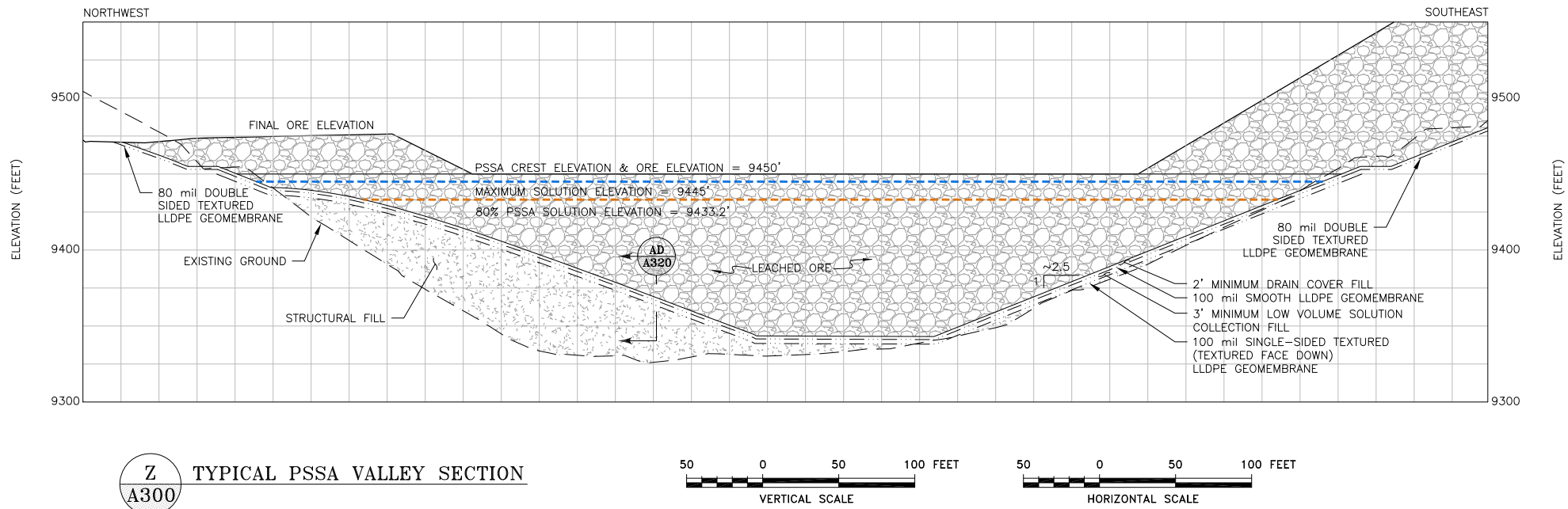

CLIENT	CRIPPLE CREEK & VICTOR GOLD MINING COMPANY		
PROJECT	SQUAW GULCH VLF		
TITLE	PSSA SECTIONS AND DETAILS SHEET 2 OF 4		
DESIGNED BY	JNM	CHECKED BY	JNM
DRAWN BY	ACW	APPROVED BY	KFM
FILENAME	1125GD88	DRAWING No.	A314
		REV	0

0	01/07/13	ISSUED FOR CONSTRUCTION	JNM
			CMT
DISCLAIMER			
AMEC PRODUCED THE INFORMATION PRESENTED ON THIS DRAWING THROUGH THE USE OF TECHNICAL INFORMATION AND PRACTICAL EXPERIENCE SPECIFIC TO ITS EFFORTS. RECEIVING THIS DRAWING DOES NOT GUARANTEE ANY RIGHTS TO SUCH TECHNICAL INFORMATION AND PRACTICAL EXPERIENCE. ANY ALTERATION OR ADAPTATION OF THE DATA OR CONTENTS OF THIS DRAWING SHALL BE AT USER'S SOLE RISK AND WITHOUT ANY LIABILITY OR LEGAL RESPONSIBILITY TO AMEC.			

