

LEGEND:

- EXISTING GROUND SURFACE CONTOUR AND EL, FEET (AERIAL SURVEY)
- EXISTING GROUND SURFACE CONTOUR AND EL, FEET (LAND SURVEY)
- PROPOSED GROUND SURFACE CONTOUR AND EL. FEET
- DAYLIGHT LINE
- CENTERLINE LINE
- NORTH PERIMETER ROAD CENTERLINE
- EXISTING UNIMPROVED ROAD/TRAILS

NOTE:

- REFER TO PHASE 2 SURFACE WATER DIVERSION CHANNEL PLAN AND PROFILE SHEETS ON DRAWINGS A520 AND A530 FOR HORIZONTAL AND VERTICAL ALIGNMENT DATA.

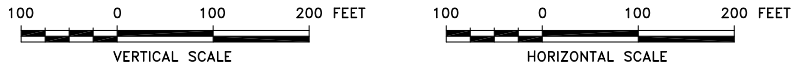
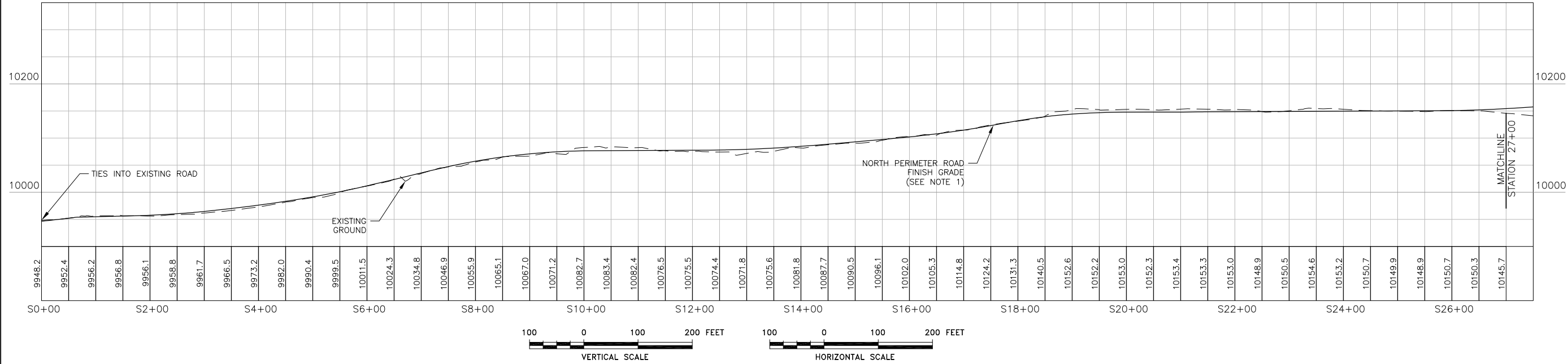
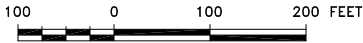

REFERENCE:

EXISTING GROUND TOPOGRAPHY WAS CREATED BY COMBINING THE FOLLOWING FILES  
REC'D FROM FORESIGHT WEST SURVEYING, INC.:  
SQUAW GULCH BASE TOPO - PHASE 1 - REVISED.DWG  
(REC'D MARCH 14, 2010)  
SQUAW GULCH BASE TOPO - PHASE 2.DWG  
(REC'D APRIL 24, 2010)  
SQUAW GULCH BASE TOPO - PHASE 3.DWG  
(REC'D MAY 4, 2010)  
CCV TOPO EXPANSION 12-29-10 NORTH AREA.DWG  
(REC'D JANUARY 13, 2011)  
CCV TOPO EXPANSION 01-28-11 SOUTH AREA.DWG  
(REC'D JANUARY 28, 2011)  
SH67 TOPO 7-07-11.DWG  
(REC'D JULY 11, 2011)  
VLF2 TOPO EXPANSION 8-05-11.DWG  
(REC'D AUGUST 9, 2011)  
09028-COMPOSITE-TOPO MLE LIMITS.DWG  
(REC'D MAY 28, 2010 FROM CC&V)



CLIENT	CRIPPLE CREEK & VICTOR GOLD MINING COMPANY			
PROJECT	SQUAW GULCH VLF			
TITLE	NORTH PERIMETER ROAD PLAN AND PROFILE SHEET 1 OF 2			
DESIGNED BY	JNM	CHECKED BY	JNM	
DRAWN BY	CMT	APPROVED BY	KFM	
FILENAME 1125GP86		DRAWING No.	A247	REV 0



0	01/07/13	ISSUED FOR CONSTRUCTION	JNM CMT
DISCLAIMER AMEC PRODUCED THE INFORMATION PRESENTED ON THIS DRAWING THROUGH THE USE OF TECHNICAL INFORMATION AND PRACTICAL EXPERIENCE SPECIFIC TO ITS EFFORTS. RECEIVING THIS DRAWING DOES NOT GUARANTEE ANY RIGHTS TO SUCH TECHNICAL INFORMATION AND PRACTICAL EXPERIENCE. ANY ALTERATION OR ADAPTATION OF THE DATA OR CONTENTS OF THIS DRAWING SHALL BE AT USER'S SOLE RISK AND WITHOUT ANY LIABILITY OR LEGAL RESPONSIBILITY TO AMEC.			