

← extraction direction

app section corner location
sw19 & nw30 T29S R55W

$$1 \text{ inch} = 250 \text{ feet}$$

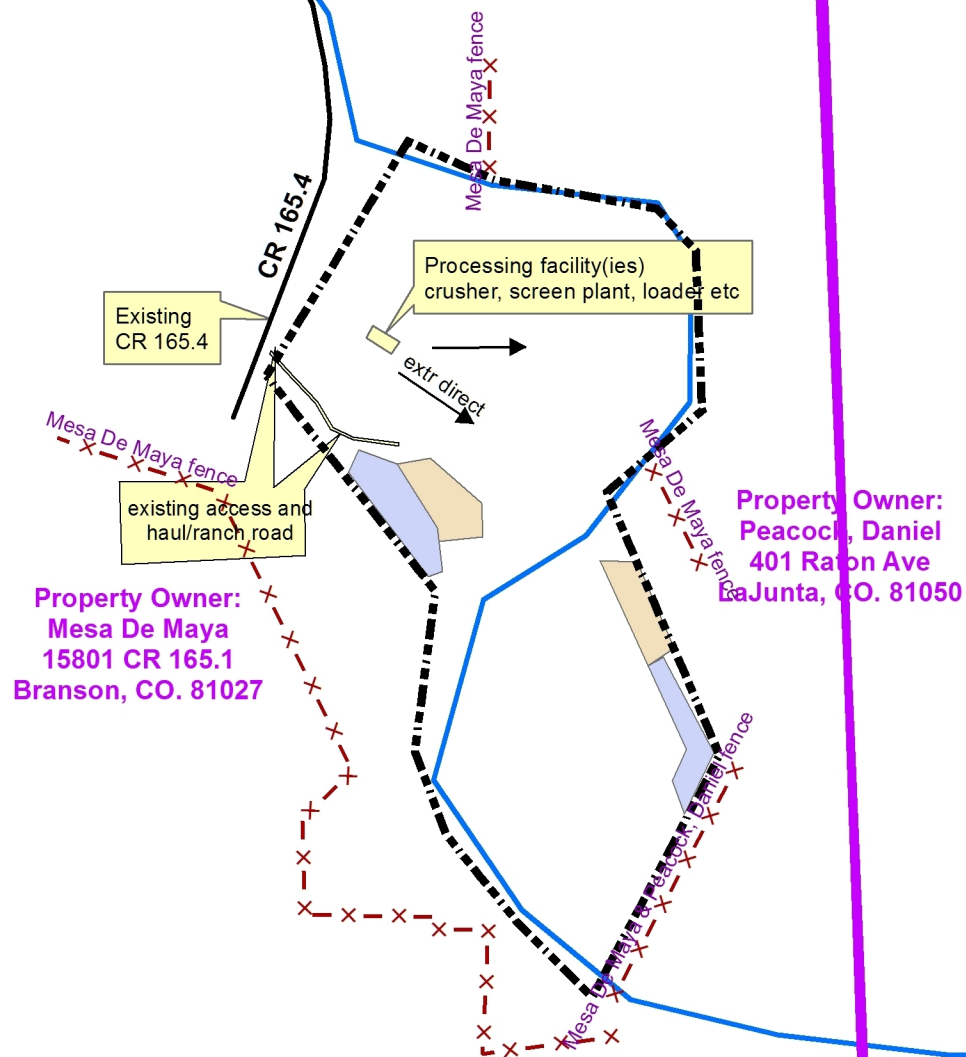

Exhibit E 3 - Reclamation Plan Map

Exhibit E 3

- grade arrows
- area to replace topsoil

Applicant: Las Animas County
Date: 5-8-2014 revised 5-14-14
Prepared By: Phil Dorenkamp

CR 165.4

all disturbed areas will not have
a reclaimed slope of steeper than 3:1

existing
vertical wall

overburden minimal
topsoil app 6"

overburden minimal
topsoil app 6"

existing
vertical wall



1 inch = 250 feet