

TOD

AFÉ RPT

RECEIVED

Page 2 of 3

DEC 06 2013

112c Annual ReportDivision of Reclamation,
Mining & Safety

Permittee Name:	TWK Enterprises, Inc.	Permit Number:	M-1988-090 ✓
Operation Name:	Deer Trail Pit	County:	Arapahoe
Annual Fee Due:	\$791.00 ✓	Anniversary Date:	December 7, 2013
Permit Acreage:	110.00	Current Bond Amt:	\$45,012.00

According to C.R.S. 34-32.5-116 or 34-32-116, each year, on the anniversary date of the permit, an operator shall submit the Annual Fee, an Annual Report and Map showing the extent of current disturbances to affected land, required monitoring information, reclamation accomplished to date and during the preceding year, any new disturbance that is anticipated to occur during the upcoming year, any reclamation that will be performed during the upcoming year, the dates for the beginning of active operations, and the date active operations ceased for the year.

Information contained in this report will be reviewed by the Division upon receipt and prior to the next compliance inspection of the site. If, while completing this report, you learn that your site is not in compliance with the rules and the act, it is advisable that the issues be rectified promptly to avoid possible enforcement action.

1. Is the site identification sign posted in accordance with Rule 3.1.12(1). ☐ YES ☐ NO
2. Is the affected area boundary clearly marked in accordance with Rule 3.1.12(2). ☐ YES ☐ NO
3. Is the mine site in final reclamation (all material extraction and stockpile removal is complete)?
If "YES," please note time limits related to completion of reclamation, Rule 3.1.3. YES ☐ NO ☐
4. What was the date of last excavation, processing or hauling activity at the mine? 2007
5. Does the mine operate more than 180 days per year?
If "NO", please review Rule 1.13 to assure that your mine is in compliance. YES ☐ NO ☐
6. Has this mine been granted: YES NO
a) approval of TEMPORARY CESSATION Status? YES NO
b) approval for INTERMITTENT OPERATION?
7. Number of acres currently affected (mining + incomplete and or unreleased reclamation). 66.5
8. Number of acres that were newly affected during the current report year. 0
9. Number of acres that were reclaimed during the current report year. 0
10. Estimated new acreage to be affected in the next report year. 0
11. Estimated acres to be reclaimed in the next report year. 0
12. **Total acres** in various stages of reclamation, since permitted mining activities began:

Total acres backfilled:		Total acres seeded w/ approved mix:		Total acres w/topsoil replaced:		Total acres mulched w/ approved mulch:	
Total acres graded:		Total acres fertilized w/ apvd fertilizer:		Topsoil replacement depth (in.):		Mulch application rate (tons/ac):	
Seed application method:		Fertilizer application method:		Mulch application method:			

ACCURATE INFORMATION UNAVAILABLE

SCANNED

15A

13. Is weed control being conducted in accordance with an approved Weed Control Plan? YES NO N/A
If "YES", indicate the weed species, control area, control type, application rate and treatment date on the report map.
14. Is adequate topsoil reserved for reclamation, based on your approved permit? YES NO N/A
If "NO", please explain:
15. Is the reserved topsoil vegetated/stabilized in accordance with Rule 3.1.9(1)? YES NO N/A
If "NO" please explain:
16. If mining has exposed groundwater, is the site in compliance with the approved mining plan and Office of the State Engineer (Well Permit, S.W.S.P., and/or Permanent Augmentation Plan)? YES NO N/A
17. Are all hazardous materials stored within approved spill containment structures? YES NO N/A
18. Is your financial warranty value sufficient to cover the cost to complete reclamation? YES NO N/A
19. Is your basis for legal right to enter still valid? YES NO
20. Does your permit require you to submit monitoring information annually? YES NO N/A
If "Yes", please attach the required monitoring results to this Annual Report.
21. As required by Colorado Mined Land Reclamation Act and/or Colorado Land Reclamation Act for the Extraction of Construction Materials (C.R.S. 34-32-116 or 34-32.5-116), attach a map to this report that accurately depicts the permit boundary, current affected area boundary and location of the acreages specified in items 7- 12 and 14.
UPDATED MAP ATTACHED: _____

Division records indicate the following permittee contact information. If this information is not current, please type or print **current** contact information:

Permittee Contact:	Sue Pipkin	
Permittee Company:	TWK Enterprises, Inc.	
Address:	P.O. Box 404 Byers, CO 80103	
Phone Number:	(303) 622-9491	
Fax Number:	(303) 622-9553	
Email Address:	CF.PR.email	

I, the undersigned, hereby state that the information provided in this report is true and accurate, and that site operations are being conducted in accordance with the Division approved mining and reclamation plans.

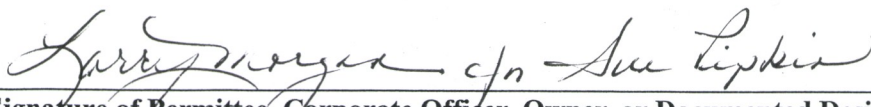
Signature of Permittee, Corporate Officer, Owner, or Documented Designee

12 04 13
Date

M-1988-090

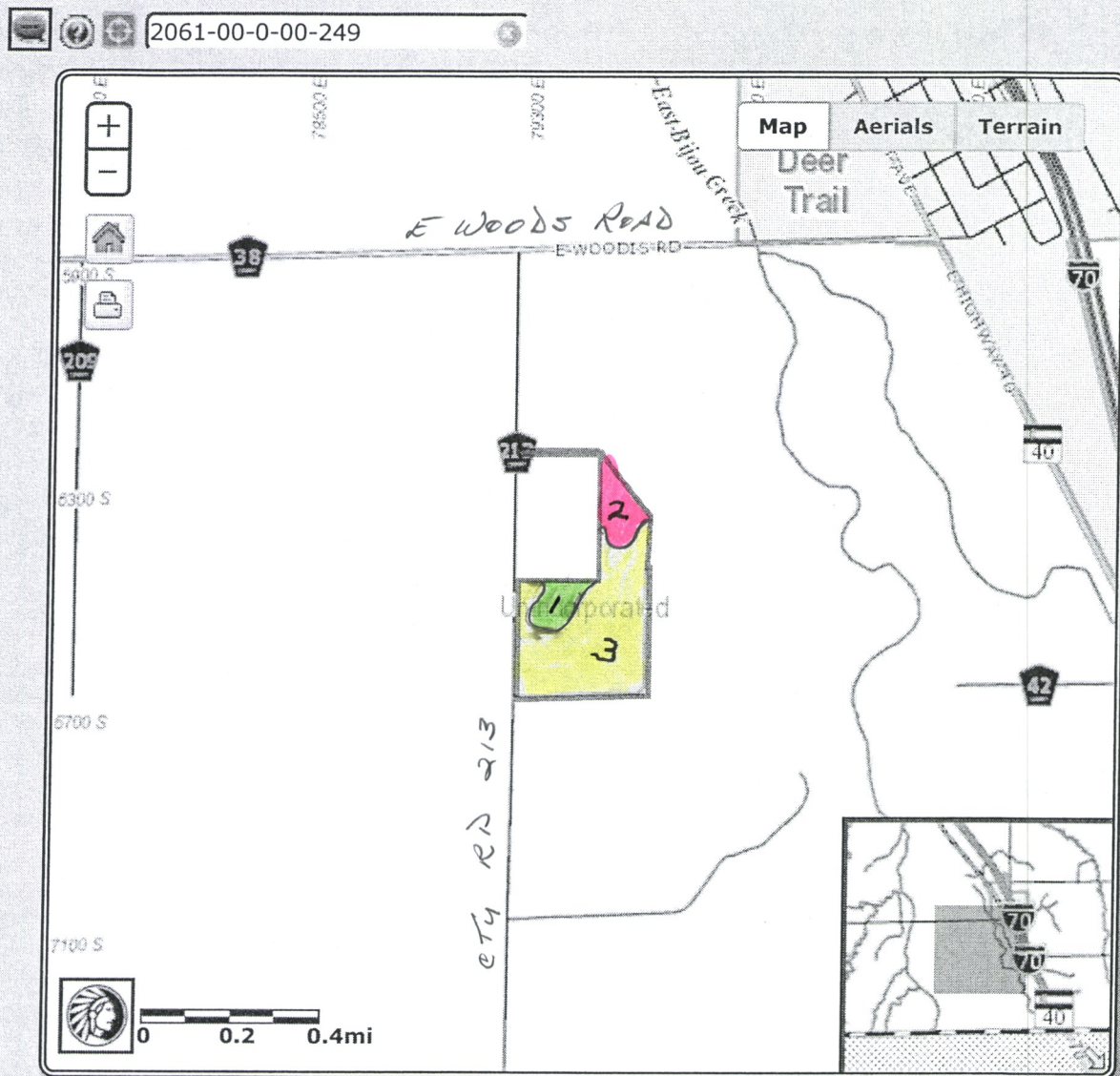

View in ArapaMAP

Division of Reclamation, Mining, and Safety

Fee Receipt for M1988090

TWK Enterprises, Inc.

000000000

Receipt #: 16486

Date: 12/06/2013

Permit: M1988090

Payment Method	Revenue Code	Fee Description/Notes	Amount
1025 msr	4300-01	Minerals Annual Fees M1988-090	\$791.00
Receipt Total:			\$791.00