

L.G. Everist, Inc.
7321 East 88th Ave. Ste. 200
Henderson CO 80640

CERTIFIED MAILTM

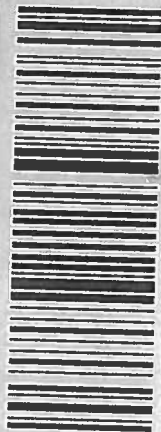

7010 1060 0001 6977 0610

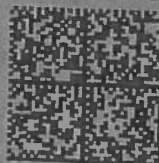

02 1P
000448438
MAILED FROM

Mr. Eric Scott
Division of Reclamation, Mining & Safety
1313 Sherman St., Room 215
Denver, Colorado 80203



ECS

L.G. EVERIST, INC.

ROCK SOLID SINCE 1876

AR01

7321 E. 88TH AVENUE, SUITE 200

HENDERSON, COLORADO 80640

PHONE 303-287-9606 • FAX 303-289-1348

December 9, 2013

Mr. Eric Scott
Colorado Division of Reclamation, Mining and Safety
1313 Sherman Street, Room 215
Denver, CO 80203

RECEIVED

DEC 11 2013

Division of Reclamation,
Mining & Safety

Sent via Certified Mail # 7010 1060 0001 6977 0610

RE: DRMS Permit M-1988-048, Carr Gravel Resource - Acreage Release Request

Dear Mr. Scott:

L.G. Everist, Inc. respectfully submits an Acreage Release Request for the Carr Gravel Resource, DRMS Permit M-1988-048. L.G. Everist is requesting acreage release of fully reclaimed areas of the site, which are generally located in the north half of the site, from the northern boundary of the entire permit area, down to the southern boundary of the "Transload Area" for a total of 618 acres.

The following paragraphs give more details on the areas that are reclaimed.

Carr Gravel Resource "Transload Area" (N 1/2 Section 35, T11N, R67W, 6th PM, Weld County)

In 2011, L.G. Everist amended the Carr Gravel Resource DRMS permit to change the reclamation plan on 303 acres from a post mining land use of rangeland to transload area. The "Transload Area" included a transload area (280 acres) located in the north half of Section 35 and by the existing railroad tracks. It also included a separate equipment storage area (9.75 acres) and haul and access roads (13.25 acres) located generally in Section 27 for post-mining use and access.

As per our discussion during your informal visit to the site in October, L.G. Everist has completed the reclamation in the "Transload Area" as per the approved reclamation plan. We have removed the remaining "mining" equipment, and removed the temporary pond located in the northeast section of the area. So the "Transload Area" is fully reclaimed as the approved reclamation plan. L.G. Everist respectfully requests release of the 303 acres.

Carr Gravel Resource "Van Loo" area (E 1/2 E 1/2 Sec 27, T11N, R67W, 6th PM, Weld County)

In 2000, L.G. Everist amended the Carr Gravel Resource DRMS Permit to add 110 acres of the "Van Loo" property into the mining and reclamation plans. As mentioned above, in 2011, L.G. Everist amended the DRMS Permit to change the reclamation plan on part of the entire site from a post mining land use of rangeland to transload area, and 20 acres of the "Transload Area" are within the "Van Loo" area. Those "transload areas" are the north-south haul road (13.25 acres) along the east side of "Van Loo" and an equipment storage area (9.75 acres) in the south part of the "Van Loo" area. The "Transload Areas" are fully reclaimed, and the remaining 90 acres of the "Van Loo" area have been fully reclaimed for years as rangeland, all as per the reclamation plan. L.G. Everist respectfully requests release of the entire 110 acres.

Carr Gravel Resource "Thomas" area (W 1/2 Section 26, T11N, R67W, 6th PM, Weld County)

The "Thomas" property is the only property within the Carr Gravel Resource that L.G. Everist does not own. L.G. Everist has had a lease with the Thomas family throughout the life of the permit. The property has been mined and reclaimed. The majority of the property has been reclaimed and sustainably vegetated for quite a few years. This past year, L.G. Everist reclaimed the southern section of the

No "V"
Acreage Release

property that had been part of the Carr processing plant area. L.G. Everist installed fencing and a gate for landowner access, graded the area, and topsoiled and seeded with native grasses.

As per our discussion during your informal visit to the site in October, the vast majority of the property is well-vegetated and nicely reclaimed, and if the landowner accepts the reclamation "as is", it would help to allow release of his entire property. L.G. Everist has received that acceptance from the landowner, Mr. Larry Thomas, and is including his signed letter in this submittal. L.G. Everist respectfully requests release of the approximately 225 permitted acres of the Thomas property.

Therefore, the total acreage L.G. Everist is requesting be released from the Carr Gravel Resource site is as follows:

Transload Area	303 acres
Van Loo Area (110 acres - 20 acres accounted for in Transload Area)	90 acres
Thomas Area	<u>225 acres</u>
Total acreage requesting to be released	618 acres

The entire permitted acreage is 1402 acres, so with this release, it would be reduced to 784 acres.

We have attached the signed letter from Mr. Thomas, accepting his property "as is", and a copy of the DRMS Exhibit F1 map, showing the areas we are requesting be released from the permit.

If you have questions, or need additional information prior to scheduling the acreage release inspection of the site, please contact me at 303-286-2247 or lmshults@lgeverist.com. Thank you.

Sincerely,

Lynn Mayer Shults
Regulatory Manager

cc: Dennis Fields
Roger Servold
Larry Thomas



L.G. EVERIST, INC.

ROCK SOLID SINCE 1876

7321 E. 88TH AVENUE, SUITE 200

HENDERSON, COLORADO 80640

PHONE 303-287-9606 • FAX 303-289-1348

November 14, 2013

Mr. Larry Thomas
331 Sioux Drive
Cheyenne, WY 82009

**RE: Carr Gravel Resource, DRMS Permit # M-1988-048
Request for Landowner Approval of Reclamation, Parcel # 020126000001**

Dear Mr. Thomas:

L.G. Everist, Inc. would like to request a final release of the Thomas property that is part of the Carr Gravel Resource, from the Division of Reclamation Mining and Safety (DRMS) Permit M-1988-048.

Your property has been reclaimed and sustainably vegetated for quite a few years. This past year we reclaimed the southern section of your property that had been part of the Carr processing plant area as per the letter agreement of August 31, 2011. We installed fencing and a gate, graded the area, and topsoiled and seeded with native grasses.

I met with a DRMS representative at the Carr site on Wednesday, October 23, 2013. He indicated that the majority of your property looks well vegetated and nicely reclaimed, with only the recently planted southern section possibly needing more time for sustainable native grass growth. He also said he would leave the release decision up to the landowner.

L.G. Everist would like to ask for release of your property from the DRMS permit, and if you accept its reclamation "as is", then please indicate your acceptance by signing below. Once you do, we will formally ask for release from the DRMS, which will take 30-60 days to complete.

Please note that release from the DRMS permit will terminate the Equipment Storage Lease/Payment of \$2,000/year, but has no effect on property easements or water leases with L.G. Everist.

If you have any questions, please contact Lynn Mayer Shults at 303-286-2247 (office), or by email at lmshults@lgeverist.com.

Sincerely,

Lynn Mayer Shults
Regulatory Manager

cc: Dennis Fields, Vice President

Please sign below if you agree that the reclamation is acceptable to you as is and that you would like your property, Parcel # 020126000001 (Part of Section 26, T11N, R67W, 6th PM, Weld County, Colorado), released from the Carr Gravel Resource DRMS Permit # M-1988-048.

Landowner Signature: Larry Thomas

11-15-2013
Date

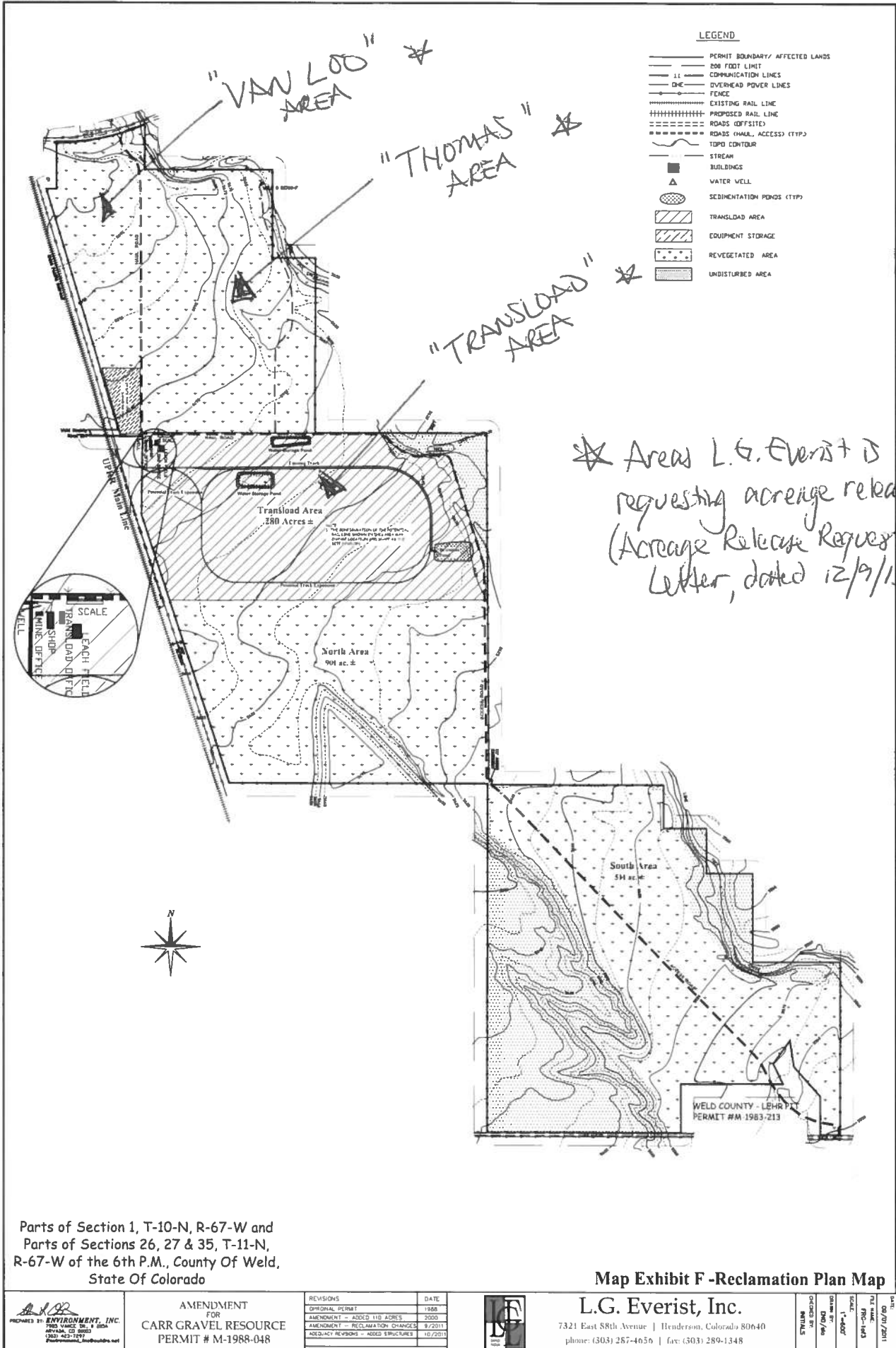

Parts of Section 1, T-10-N, R-67-W and
Parts of Sections 26, 27 & 35, T-11-N,
R-67-W of the 6th P.M., County Of Weld,
State Of Colorado

Map Exhibit F - Reclamation Plan Map

PREPARED BY: **ENVIRONMENT, INC.**
7000 VANCE DR. # 200
ARVADA, CO 80003
1800-467-1975
environment_inc@earthlink.net

AMENDMENT
FOR
CARR GRAVEL RESOURCE
PERMIT # M-1988-048

REVISIONS	DATE
OPTIONAL PERMIT	1988
AMENDMENT - ADDED 110 ACRES	2000
AMENDMENT - RECLAMATION CHANGED	8/2011
ADDITIONAL REVISIONS - ADDED STRUCTURES	10/2011



L.G. Everist, Inc.

7321 East 88th Avenue | Henderson, Colorado 80640
phone: (303) 287-4656 | fax: (303) 289-1348

DATE	BY	REV.	DESCRIPTION
09/07/2011	RL	1	PERMIT #M-1988-048
08/01/2011	RL	2	PERMIT #M-1988-048
07/01/2011	RL	3	PERMIT #M-1988-048
06/01/2011	RL	4	PERMIT #M-1988-048
05/01/2011	RL	5	PERMIT #M-1988-048
04/01/2011	RL	6	PERMIT #M-1988-048
03/01/2011	RL	7	PERMIT #M-1988-048
02/01/2011	RL	8	PERMIT #M-1988-048
01/01/2011	RL	9	PERMIT #M-1988-048
12/01/2010	RL	10	PERMIT #M-1988-048