

NOVEMBER 10, 1978

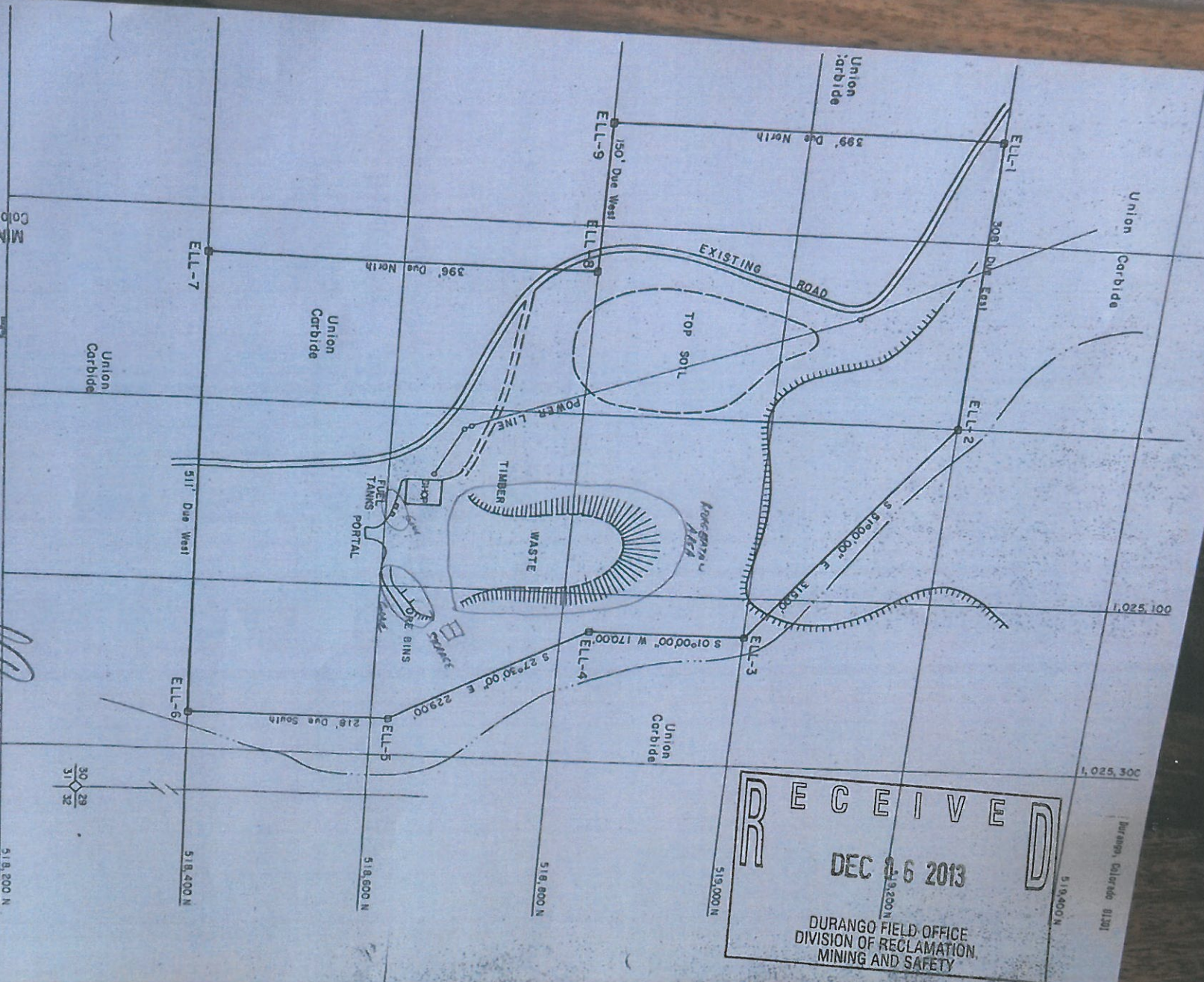

RECEIVED
NOV 10 1978
MINED LAND RECLAMATION
Corp. Dept. of Natural Resources

TR-04
EXHIBIT E

[Signature]
12/16/2013

- ☐ Buildings, Fuel Tanks
- ☐ Proposed Power Line
- ☐ Areas of Steep Slopes
- ☐ Existing Access Roads
- ☐ Proposed Access Roads
- ☐ Perimeter Stations
- ☐ Intermittent Streams or Dry Washes

ELLISON MINE

M-1978-342



PIONEER URAYAN, INC.		
GRAND JUNCTION, COLORADO		
ELLISON MINE		
Section 30, T 44 N, R 18 W		
SAN MIGUEL COUNTY, COLORADO		
PLAN VIEW-C.R. PONCHAK		
90 ACRES		
Date Drawn:	Nov 10, 1978	Revisions
Drawn By:	C.R. Ponchak	

RECEIVED
DEC 16 2013
DURANGO FIELD OFFICE
DIVISION OF RECLAMATION,
MINING AND SAFETY

Durango, Colorado 81301