

STATE OF COLORADO

DIVISION OF RECLAMATION, MINING AND SAFETY
Department of Natural Resources

1313 Sherman St., Room 215
Denver, Colorado 80203
Phone: (303) 866-3567
FAX: (303) 832-8106

ecs

CNØ1



CONSTRUCTION MATERIALS REGULAR (112) OPERATION RECLAMATION PERMIT APPLICATION FORM

SCANNED

CHECK ONE: ☒ There is a File Number Already Assigned to this Operation

Permit # M82 186 - (Please reference the file number currently assigned to this operation)

☐ New Application (Rule 1.4.5)

☐ Amendment Application (Rule 1.10)

☒ Conversion Application (Rule 1.11)

✓ Permit # M 82 186 - (provide for Amendments and Conversions of existing permits)

The application for a Construction Materials Regular 112 Operation Reclamation Permit contains three major parts: (1) the application form; (2) Exhibits A-S, Addendum 1, any sections of Exhibit 6.5 (Geotechnical Stability Exhibit; and (3) the application fee. When you submit your application, be sure to include one (1) complete signed and notarized ORIGINAL and one (1) copy of the completed application form, two (2) copies of Exhibits A-S, Addendum 1, appropriate sections of 6.5 (Geotechnical Stability Exhibit, and a check for the application fee described under Section (4) below. Exhibits should **NOT** be bound or in a 3-ring binder; maps should be folded to 8 1/2" X 11" or 8 1/2" X 14" size. To expedite processing, please provide the information in the format and order described in this form.

GENERAL OPERATION INFORMATION

Type or print clearly, in the space provided, ALL information requested below.

1. Applicant/operator or company name (name to be used on permit): Kit Carson County ✓
 - 1.1 Type of organization (corporation, partnership, etc.): County Government
2. Operation name (pit, mine or site name): Beeson Pit
3. Permitted acreage (new or existing site):

	<u>9.5</u>	permitted acres
3.1 Change in acreage (+)	<u>10.4</u>	acres
3.2 Total acreage in Permit area	<u>19.9</u>	acres
4. Fees:

4.1 New Application	<u>\$2,696.00</u>	application fee
4.2 New Quarry Application	<u>\$3,342.00</u>	quarry application
4.4 Amendment Fee	<u>\$2,229.00</u>	amendment fee
4.5 Conversion to 112 operation (set by statute)	<u>\$2,696.00</u>	conversion fee
5. Primary commodity(ies) to be mined: Sand Gravel

5.1 Incidental commodity(ies) to be mined:	1. <u>N/A</u> - <u>lbs/Tons/yr</u>	2. <u>/</u> <u>lbs/Tons/yr</u>
	3. <u>/</u> <u>lbs/Tons/yr</u>	4. <u>/</u> <u>lbs/Tons/yr</u>
5.2 Anticipated end use of primary commodity(ies) to be mined:	<u>Road Maintenance</u>	
5.3 Anticipated end use of incidental commodity(ies) to be mined:	<u>N/A</u>	

RECEIVED

SEP 04 2013

Division of Reclamation,
Mining & Safety

6. Name of owner of subsurface rights of affected land: Leonard & Agnes Beeson
If 2 or more owners, "refer to Exhibit O".

7. Name of owner of surface of affected land: Leonard & Agnes Beeson

8. Type of mining operation: ☒ Surface ☐ Underground

9. Location Information: The center of the area where the majority of mining will occur:

COUNTY: Kit Carson County

PRINCIPAL MERIDIAN (check one): ☒ 6th (Colorado) ☐ 10th (New Mexico) ☐ Ute

SECTION (write number): S 21

TOWNSHIP (write number and check direction): T 10 ☐ North ☒ South

RANGE (write number and check direction): R 45 ☐ East ☒ West

QUARTER SECTION (check one): ☐ NE ☐ NW ☒ SE ☐ SW

QUARTER/QUARTER SECTION (check one): ☐ NE ☒ NW ☐ SE ☐ SW

GENERAL DESCRIPTION: (the number of miles and direction from the nearest town and the approximate elevation): _____
9 Miles South of Bethune, Co; 1 miles west 1/8 mile South. Elevation 4300

10. Primary Mine Entrance Location (report in either Latitude/Longitude OR UTM):

Latitude/Longitude:

Example: (N) 39° 44' 12.98"
(W) 104° 59' 3.87"

Latitude (N): deg _____ min _____ sec _____ (2 decimal places)

Longitude (W): deg _____ min _____ sec _____ (2 decimal places)

OR

Example: (N) 39.73691°
(W) -104.98449°

Latitude (N) 39 102.48 (5 decimal places)

Longitude(W) 102 2621.95 (5 decimal places)

OR

Universal Tranverse Mercator (UTM)

Example: 201336.3 E NAD27 Zone 13
4398351.2 N

UTM Datum (specify NAD27, NAD83 or WGS 84) Nad 83 Zone 13

Easting _____

Northing _____

11. Correspondence Information:

APPLICANT/OPERATOR (name, address, and phone of name to be used on permit)

Contact's Name: Dave Homung Title: Chairman
Company Name: Kit Carson County
Street/P.O. Box: _____ P.O. Box: 160
City: Burlington
State: Co Zip Code: 80807
Telephone Number: (719) - 346-8139
Fax Number: (719) - 346-7242

PERMITTING CONTACT (if different from applicant/operator above)

Contact's Name: Paula Weeks Title: Administrator
Company Name: Kit Carson County
Street/P.O. Box: _____ P.O. Box: 160
City: Burlington
State: Co Zip Code: 80807
Telephone Number: (719) - 346-8139 x 220
Fax Number: (719) - 346-7242

INSPECTION CONTACT

Contact's Name: Todd Trobee Title: MSHA Compliance Officer
Company Name: Kit Carson County
Street/P.O. Box: _____ P.O. Box: 160
City: Burlington
State: Co Zip Code: 80807
Telephone Number: (402) - 760-0691
Fax Number: (719) - 346-7732

CC: STATE OR FEDERAL LANDOWNER (if any)

Agency: _____
Street: _____
City: _____
State: _____ Zip Code: _____
Telephone Number: () -

CC: STATE OR FEDERAL LANDOWNER (if any)

Agency: _____
Street: _____
City: _____
State: _____ Zip Code: _____
Telephone Number: () -

12. **Primary future (Post-mining) land use (check one):**

- | | | |
|--------------------------------------------------------|------------------------------------------|----------------------------------------------------|
| <input type="checkbox"/> Cropland(CR) | <input type="checkbox"/> Pastureland(PL) | <input type="checkbox"/> General Agriculture(GA) |
| <input checked="" type="checkbox"/> Rangeland(RL) | <input type="checkbox"/> Forestry(FR) | <input type="checkbox"/> Wildlife Habitat(WL) |
| <input type="checkbox"/> Residential(RS) | <input type="checkbox"/> Recreation(RC) | <input type="checkbox"/> Industrial/Commercial(IC) |
| <input type="checkbox"/> Developed Water Resources(WR) | | <input type="checkbox"/> Solid Waste Disposal(WD) |

13. **Primary present land use (check one):**

- | | | |
|--------------------------------------------------------|------------------------------------------|----------------------------------------------------|
| <input type="checkbox"/> Cropland(CR) | <input type="checkbox"/> Pastureland(PL) | <input type="checkbox"/> General Agriculture(GA) |
| <input checked="" type="checkbox"/> Rangeland(RL) | <input type="checkbox"/> Forestry(FR) | <input type="checkbox"/> Wildlife Habitat(WL) |
| <input type="checkbox"/> Residential(RS) | <input type="checkbox"/> Recreation(RC) | <input type="checkbox"/> Industrial/Commercial(IC) |
| <input type="checkbox"/> Developed Water Resources(WR) | | |

14. **Method of Mining:** Briefly explain mining method (e.g. truck/shovel): _____
Surface mining with Trucks

15. **On Site Processing:**

☒ Crushing Screening

13.1 Briefly explain mining method (e.g. truck/shovel): _____
Processing material with a screening plant may be an option in the future.

List any designated chemicals or acid-producing materials to be used or stored within permit area: _____
None

16. **Description of Amendment or Conversion:**

If you are amending or converting an existing operation, provide a brief narrative describing the proposed change(s).

Moving existing boundaries 407ft to the NW and SW, and the SE boundary 226ft south. See attached map.

Maps and Exhibits:

Two (2) complete, unbound application packages must be submitted. One complete application package consists of a signed application form and the set of maps and exhibits referenced below as Exhibits A-S, Addendum 1, and the Geotechnical Stability Exhibit. Each exhibit within the application must be presented as a separate section. Begin each exhibit on a new page. Pages should be numbered consecutively for ease of reference. If separate documents are used as appendices, please reference these by name in the exhibit.

With each of the two (2) signed application forms, you must submit a corresponding set of the maps and exhibits as described in the following references to Rule 6.4, 6.5, and 1.6.2(1)(b):

EXHIBIT A	Legal Description
EXHIBIT B	Index Map
EXHIBIT C	Pre-Mining and Mining Plan Map(s) of Affected Lands
EXHIBIT D	Mining Plan
EXHIBIT E	Reclamation Plan
EXHIBIT F	Reclamation Plan Map
EXHIBIT G	Water Information
EXHIBIT H	Wildlife Information
EXHIBIT I	Soils Information
EXHIBIT J	Vegetation Information
EXHIBIT K	Climate Information
EXHIBIT L	Reclamation Costs
EXHIBIT M	Other Permits and Licenses
EXHIBIT N	Source of Legal Right-To-Enter
EXHIBIT O	Owners of Record of Affected Land (Surface Area) and Owners of Substance to be Mined
EXHIBIT P	Municipalities Within Two Miles
EXHIBIT Q	Proof of Mailing of Notices to County Commissioners and Conservation District
EXHIBIT R	Proof of Filing with County Clerk or Recorder
EXHIBIT S	Permanent Man-Made Structures
Rule 1.6.2(1)(b)	ADDENDUM 1 - Notice Requirements (sample enclosed)
Rule 6.5	Geotechnical Stability Exhibit (any required sections)

The instructions for preparing Exhibits A-S, Addendum 1, and Geotechnical Stability Exhibit are specified under Rule 6.4 and 6.5 and Rule 1.6.2(1)(b) of the Rules and Regulations. If you have any questions on preparing the Exhibits or content of the information required, or would like to schedule a pre-application meeting you may contact the Office at 303-866-3567.

Responsibilities as a Permittee:

Upon application approval and permit issuance, this application becomes a legally binding document. Therefore, there are a number of important requirements which you, as a permittee, should fully understand. These requirements are listed below. Please read and initial each requirement, in the space provided, to acknowledge that you understand your obligations. If you do not understand these obligations then please contact this Office for a full explanation.



1. Your obligation to reclaim the site is not limited to the amount of the financial warranty. You assume legal liability for all reasonable expenses which the Board or the Office may incur to reclaim the affected lands associated with your mining operation in the event your permit is revoked and financial warranty is forfeited;

111 2. The Board may suspend or revoke this permit, or assess a civil penalty, upon a finding that the permittee violated the terms or conditions of this permit, the Act, the Mineral Rules and Regulations, or that information contained in the application or your permit misrepresent important material facts;

111 3. If your mining and reclamation operations affect areas beyond the boundaries of an approved permit boundary, substantial civil penalties, to you as permittee can result;

111 4. Any modification to the approved mining and reclamation plan from those described in your approved application requires you to submit a permit modification and obtain approval from the Board or Office;

111 5. It is your responsibility to notify the Office of any changes in your address or phone number;

111 6. Upon permit issuance and prior to beginning on-site mining activity, you must post a sign at the entrance of the mine site, which shall be clearly visible from the access road, with the following information (Rule 3.1.12):

a. the name of the operator;

b. a statement that a reclamation permit for the operation has been issued by the Colorado Mined Land Reclamation Board; and,

c. the permit number.

111 7. The boundaries of the permit boundary area must be marked by monuments or other markers that are clearly visible and adequate to delineate such boundaries prior to site disturbance.

111 8. It is a provision of this permit that the operations will be conducted in accordance with the terms and conditions listed in your application, as well as with the provisions of the Act and the Construction Material Rules and Regulations in effect at the time the permit is issued.

111 9. Annually, on the anniversary date of permit issuance, you must submit an annual fee as specified by Statute, and an annual report which includes a map describing the acreage affected and the acreage reclaimed to date (if there are changes from the previous year), any monitoring required by the Reclamation Plan to be submitted annually on the anniversary date of the permit approval. Annual fees are for the previous year a permit is held. For example, a permit with the anniversary date of July 1, 1995, the annual fee is for the period of July 1, 1994 through June 30, 1995. Failure to submit your annual fee and report by the permit anniversary date may result in a civil penalty, revocation of your permit, and forfeiture of your financial warranty. It is your responsibility, as the permittee, to continue to pay your annual fee to the Office until the Board releases you from your total reclamation responsibility.

NA 10. For joint venture/partnership operators: the signing representative is authorized to sign this document and a power of attorney (provided by the partner(s)) authorizing the signature of the representative is attached to this application.

NOTE TO COMMENTORS/OBJECTORS:

It is likely there will be additions, changes, and deletions to this document prior to final decision by the Office. Therefore, if you have any comments or concerns you must contact the applicant or the Office prior to the decision date so that you will know what changes may have been made to the application document.

The Office is not allowed to consider comments, unless they are written, and received prior to the end of the public comment period. You should contact the applicant for the final date of the public comment period.

If you have questions about the Mined Land Reclamation Board and Office's review and decision or appeals process, you may contact the Office at (303) 866-3567.

Certification:

As an authorized representative of the applicant, I hereby certify that the operation described has met the minimum requirements of the following terms and conditions:

1. To the best of my knowledge, all significant, valuable and permanent man-made structure(s) in existence at the time this application is filed, and located within 200 feet of the proposed affected area have been identified in this application (Section 34-32.5-115(4)(e), C.R.S.).
2. No mining operation will be located on lands where such operations are prohibited by law (Section 34-32.5-115(4)(f), C.R.S.;
3. As the applicant/operator, I do not have any extraction/exploration operations in the State of Colorado currently in violation of the provisions of the Colorado Land Reclamation Act for the Extraction of Construction Materials (Section 34-32.5-120, C.R.S.) as determined through a Board finding.
4. I understand that statements in the application are being made under penalty of perjury and that false statements made herein are punishable as a Class 1 misdemeanor pursuant to Section 18-8-503, C.R.S.

This form has been approved by the Mined Land Reclamation Board pursuant to section 34-32.5-112, C.R.S., of the Colorado Land Reclamation Act for the Extraction of Construction Materials. Any alteration or modification of this form shall result in voiding any permit issued on the altered or modified form and subject the operator to cease and desist orders and civil penalties for operating without a permit pursuant to section 34-32.5-123, C.R.S.

Signed and dated this 22nd day of May, 2013.

Kit Carson County
Applicant/Operator or Company Name

If Corporation Attest (Seal)

Signed: David L. Hornung

Title: BOCC CHAIR

State of Colorado)
County of Kit Carson) ss.

Signed: Julia M. Carlson
Corporate Secretary or Equivalent
Town/City/County Clerk



The foregoing instrument was acknowledged before me this 22nd day of May, 2013 by David L. Hornung as BOCC Chair of Kit Carson County

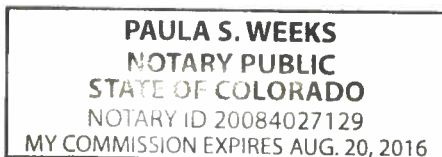

Paula S. Weeks
Notary Public

My Commission expires: Aug 20, 2016

SIGNATURES MUST BE IN BLUE INK

You must post sufficient Notices at the location of the proposed mine site to clearly identify the site as the location of a

proposed mining operation. The following is a sample of the Notice required for Rule 1.6.2(1)(b) that you may wish to use.

NOTICE

This site is the location of a proposed construction materials operation. (Name of the Applicant/Operator) Kit Carson County, whose address and phone number is (Address and Phone Number of the Applicant/Operator) 251 16th St Burlington CO 80807 714-346-8133 (301) has applied for a Reclamation Permit with the Colorado Mined Land Reclamation Board. Anyone wishing to comment on the application may view the application at the (County Name) Kit Carson County County Clerk and Recorder's Office, (Clerk and Recorder's Office Address) 251 16th St Burlington CO 80807, and should send comments prior to the end of the public comment period to the Division of Reclamation, Mining, and Safety, 1313 Sherman St, Room 215, Denver, Colorado 80203.

Certification:

I, DAVID HORNING, hereby certify that I posted a sign containing the above notice for the proposed permit area known as the (Name of Operation) BEEFSON PIT, on (Date Posted) 5-15-13.

David H
SIGNATURE

5-22-13
DATE

AN EXAMPLE PUBLIC NOTICE WHICH MEETS THE REQUIREMENTS OF THE STATUTES IS SHOWN BELOW. THE BLANKS WHICH REQUIRE DATES WILL NEED TO BE FILLED IN ACCORDING TO THE FOLLOWING INSTRUCTIONS. PLEASE READ CAREFULLY.

PUBLICATION INSTRUCTIONS:

Date of commencement and date of completion should represent the dates which you feel most accurately describe the life of the operation.

For all Regular (112) types of operations, this notice must be published once a week for four (4) consecutive weeks, starting within ten (10) days of the date the application is considered to be submitted to the Division. The final date for receiving comments is the 20th day after the fourth publication or the next regular business day.

All notices must be published in a newspaper of general circulation in the locality of the proposed mining operation and mailed to the landowners as set forth in the Colorado Mined Land Reclamation Rules and Regulations. Since the date for consideration of your application may change, DO NOT include it in this notice.

For a complete discussion of the notice procedures and objections, please refer to C.R.S. 34-32.5-112(10), 114 and 115.

PUBLIC NOTICE

(Operator Name) Kit Carson County; (Address and Phone Number) 714-346-8153 (304) 351 16th St Burlington CO 80807
has filed an application for a Regular (112) Construction Materials Operation Reclamation Permit with the Colorado Mined Land Reclamation Board under provisions of the Colorado Land Reclamation Act for the Extraction of Construction Materials.
The proposed mine is known as the (Name of the Mine) Beeson Pit, and is located at or near Section 21, Township 10, Range 45, _____ Prime Meridian.

The proposed date of commencement is _____, _____, and the proposed date of completion is _____. The proposed future use of the land is (Future Landuse) _____. Additional information and tentative decision date may be obtained from the Division of Reclamation, Mining, and Safety, 1313 Sherman Street, Room 215, Denver, Colorado 80203, (303) 866-3567, or at the (County Name) Kit Carson County County Clerk and Recorder's office; (Clerk and Recorder's Address) _____, or the above-named applicant.

Comments must be in writing and must be received by the Division of Reclamation, Mining, and Safety by 4:00 p.m. on (Final Date for Comments) _____.

Please note that under the provisions of C.R.S. 34-32.5-101 et seq. Comments related to noise, truck traffic, hours of operation, visual impacts, effects on property values and other social or economic concerns are issues not subject to this Office's jurisdiction. These subjects, and similar ones, are typically addressed by your local governments, rather than the Division of Reclamation, Mining, and Safety or the Mined Land Reclamation Board.

EXHIBIT A - SE OF THE NW 1/4 * SECTION 33 * TOWNSHIP 11S * RANGE 51W

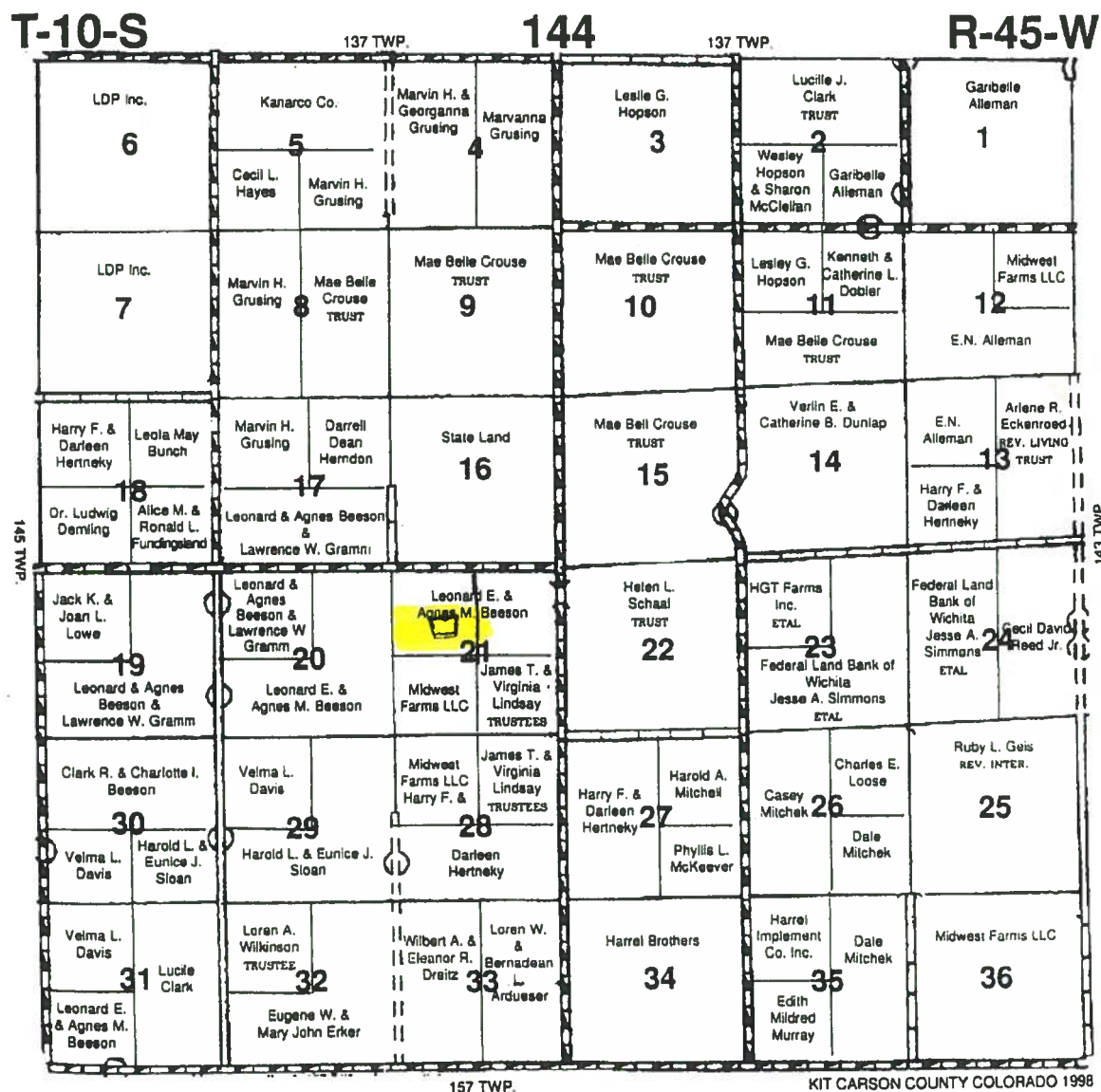
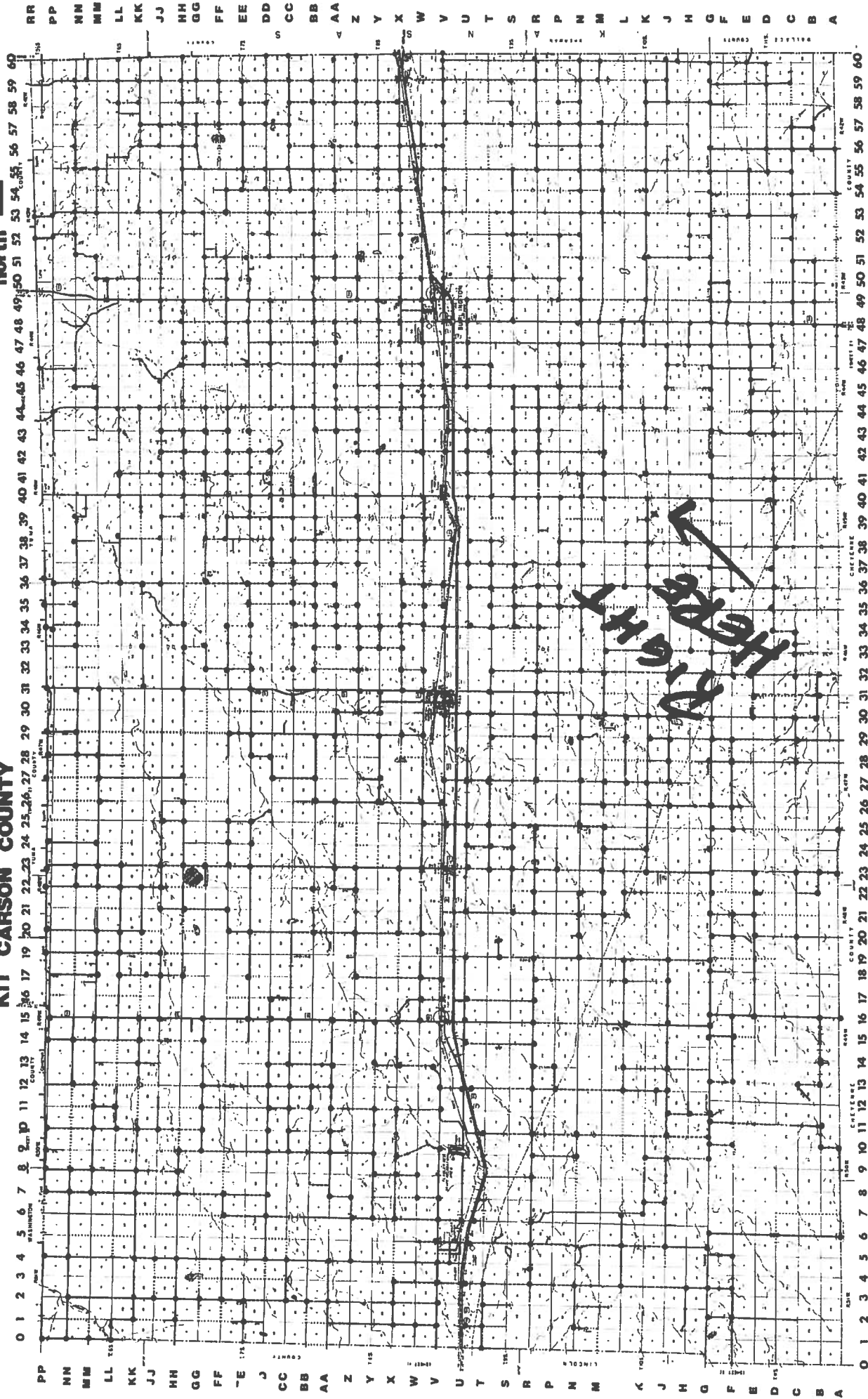

EXHIBIT A - SE OF THE NW 1/4 * SECTION 33 * TOWNSHIP 11S * RANGE 51W

KIT CARSON COUNTY

north



COUNTY ROAD M 5410

COUNTY

COUNTY ROAD L

COUNTY ROAD M

COUNTY ROAD L

COUNTY ROAD K

4300

4300

COUNTY ROAD K

Beeson Pit Entrance

39 10'15.07 N

102 26'30.24 W

Sand Creek

COUNTY ROAD J

Creek

4350

COUNTY ROAD J

COUNTY ROAD K

COUNTY ROAD L 1540

COUNTY ROAD J

4350

The National Map
NOTES: Data available from U.S. Geological Survey, National Geospatial Program.

Exhibit B



Exhibit C (a)

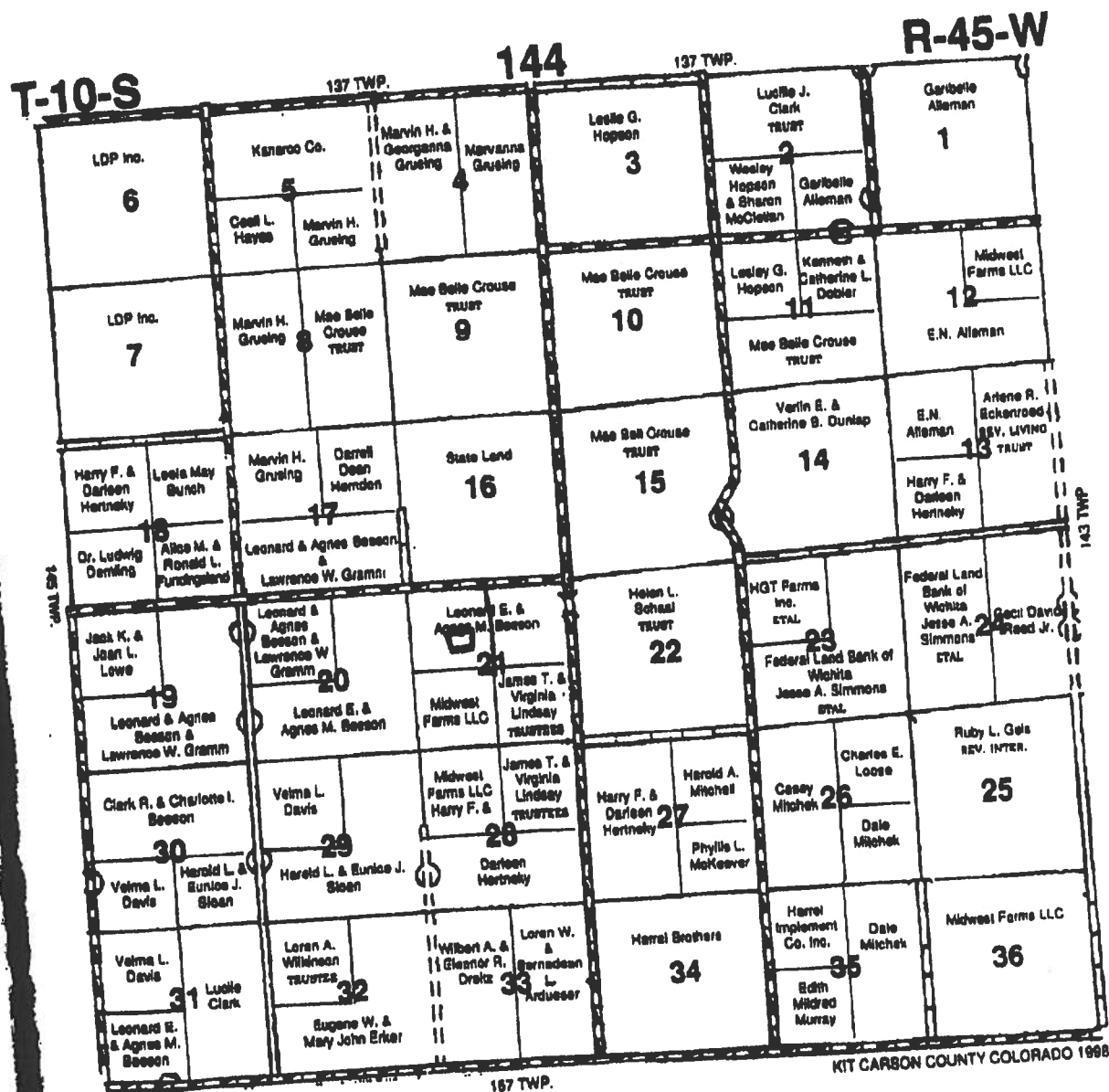

Exhibit C (b)

The only structure within 200ft of the mining area is a three wire fence. The SW boundary is 30ft away to the south, and the SE boundary is 27ft away from the fence.



The USGS Store

Exhibit C (c)

[Log](#)

[<< Back To Store](#)

About: [USGS Maps](#) :: [GeoPDF Maps](#) :: [Map Dates](#) :: [USGS Historical Topographic Maps \(Status](#)

Map Locator & Downloader

[DOI Disclaimer on Google Maps API](#)

Don't see the Map Locator & Downloader? [Help](#) | Having trouble? Call: 1-888-ASK-USGS (1-888-275-8747, Select Option 2) or

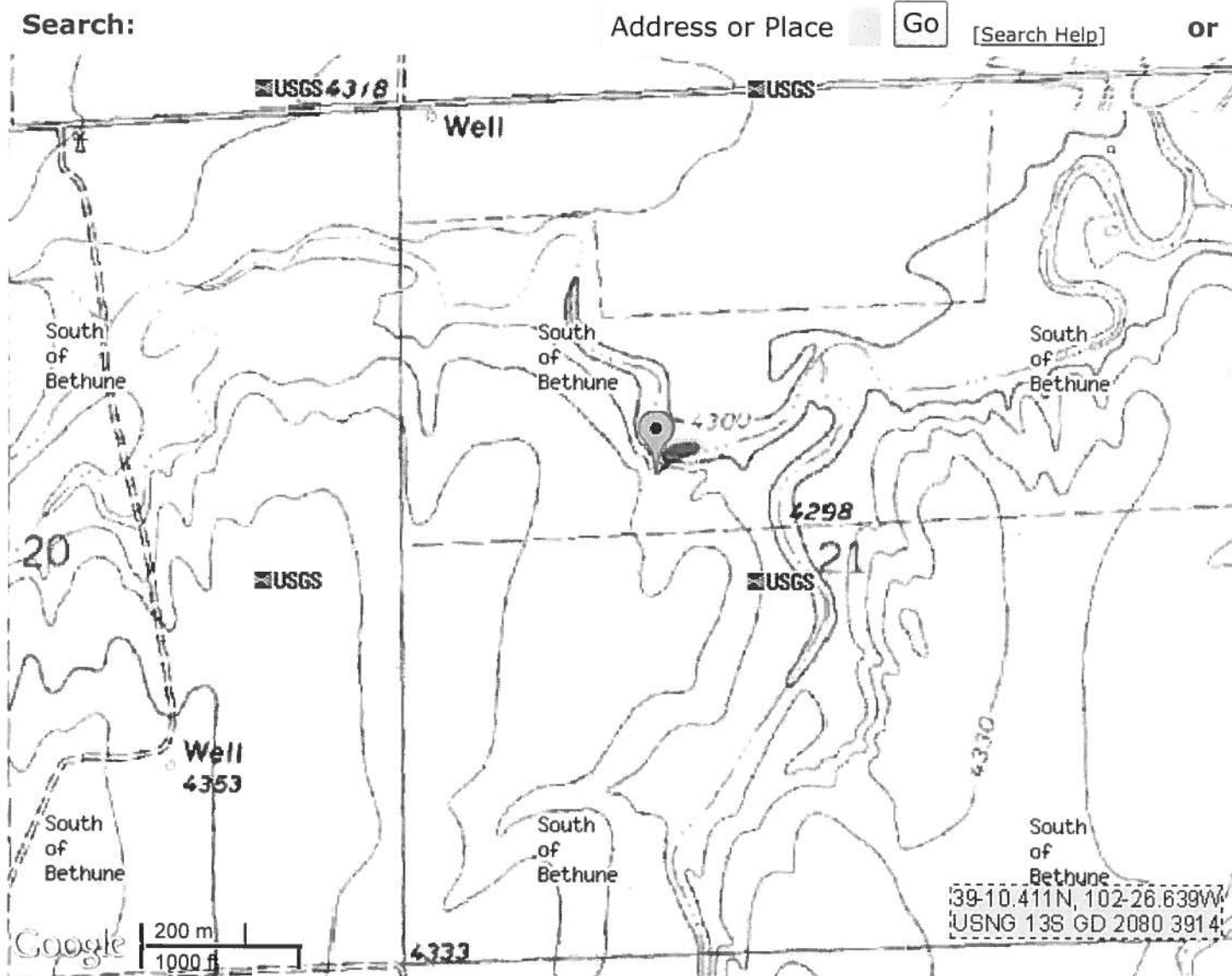

Free plug-in
for Adobe® Reader®

- **ACCESS** geospatial maps & imagery
- **MEASURE** distances & area
- **CAPTURE** field information



**DOWNLOAD
NOW**

Exhibit C (d)



Exhibit C

(e) This site is native pasture. The vegetation includes blue grama, buffalo, western wheat grass and sandhill.

(f) Water resources in the area of the proposed operation consist of rainfall, as there are no streams or creeks to run into it.

(g) There is a fence line within 27ft of the boundary line owned by Elise J Walters Trust.

(h) Soils in the mining site consist of topsoil, sand, gravel, clay, and a mixture of oversized rock.

Exhibit D

(a) The method of mining will be , 1st removing topsoil. 2nd utilizing a dozer and loader.

(b) The loader and trucks will be used in the earthmoving process.

(c,d) No water diversions will be needed. The size of the area to be worked at any one time is less than ½ an acre.

(e) The date of commencement shall be September 1st, 2013 until September 1st, 2033.

(f) Nature, depth and thickness of the deposits will be between 10 and 20 feet, with an average of 12 feet. If overburden is to be removed to reach the gravel deposit, 2 feet will be removed, segregated from the topsoil and salvaged.

(g) The primary commodities are sand and gravel, and the secondary is dirt. The intended use is road construction.

(h) Expected incidental products will be oversized rocks and they will be stockpiled and used for roadbase.

(I) No explosives will be used in this operation.

Exhibit D (r)



Exhibit E

Reclamation Plan:

The gradient of all slopes are 3:1

Vegetation will be established. There is not an area where vegetation will not be established in order to maintain post-mine long-term stability in the area.

The average thickness of the overburden varies from 0-3 feet. When overburden needs to be disturbed , to get the gravel, 2 feet of overburden will be salvaged.

The average thickness of the replaced topsoil will be 6-12 inches

Some reclamation may be implemented during the mining activities, and the final reclamation will occur at the conclusion of mining activities. The operator will follow guidelines in establishing that the area be returned to pastureland use.

Guidelines for reclamation will be followed according to the recommendation of the SCD office.



Grass Seeding: PART I - Planned

Planner:	Kristi Gay		Date:	28-Aug-13	
Producer:	Kit Carson County -Walters/Beeson Pit N1/2 21-10-45				
Primary soil type:	silt loams	Contract/Agreement #:	Item Num:		
Seeding Operation:	Acres to be seeded:	19.9	Program:	Other	
	Seedbed Prep:		Land Use:	non-irrigated drilled	
	Planting Dates:	11/15 to 5/15	Drill Type:	grass	
	Planting Depth (in.):	1/4-1/2"	Drill Spacing (in.):	7-12"	
Fertilizer:	Pounds per acre recommended <i>(requires completion of 590 Job Sheet)</i>				
	Nitrogen (N)	Phosphorus (P)	Potassium (K)		
Weed Control:	Dates:	early summer	<i>(may require completion of Pesticide Mitigation Worksheet / IPM 595 Job Sheet)</i>		
	Description:	mechanical			
Cover / Mulch:	Amount:	1501 - 2000			
	Description:	baled mulch			
	Application Method:	straw spreader			

Seed Recommendations:

Species I = Introduced, N = Native		Variety/Sci. Name (table 6: PMTN 59)	PLS/Ac to use (100%)	% in mix	Rate (PLS lb/ac)	Acres to be seeded	Total PLS
Blue grama	N	Lovington, Hachita, Alma	1.5	35	0.53	19.9	10.45
Little bluestem	N	Pastura	3.5	15	0.53	19.9	10.45
Sideoats grama	N	Vaughn, El Reno, Niner	4.5	20	0.90	19.9	17.91
Buffalograss (bur)	N	Mesa, Sharps, Texoka, Cody, Bowie	8.0	10	0.80	19.9	15.92
Western wheatgrass	N	Arriba, Barton	8.0	20	1.60	19.9	31.84
Totals			25.5	100.0	4.4	19.9	86.6

NOTES: Mowing for weed control should be completed in approx. June - July the summer following grass drilling to reduce competition for moisture for newly emerging grass. A proper grass drill should be used for drilling grass seed.

Notes: Use adapted improved varieties and cultivars in the following order of preference, when available:

1. certified name varieties, 2. named varieties, 3. common seed

PLS = Pure Live Seed

When bare-root stock shrubs are planned: [1. Document planting on Job Sheet 612, Tree and Shrub Establishment.](#)

2. Insert 0 in "% in Mix" column for calculations to function.

Certified Planner:

Kristi Gay

Date:

8/29/13

NOTES: Data available from U.S. Geological Survey, National Geospatial Program.

Reclamation plan topsoil



Exhibit G

(a) Groundwater will not be encountered, nor will surface water be intercepted or disturbed.

Exhibit H

(a) The wildlife on the affected area will consist of but are not limited to, snakes, rabbits, game birds, deer, and field mice.

(b) Most all wildlife listed will use this area in all 4 seasons.

(c) There are no endangered species in the affected area.

(D) There will be no effect on the wildlife in the affected area.

SUITABLE FOR CULTIVATION

The diagram shows a rectangular domain with a central square hole. The domain is divided into four quadrants by a vertical line and a horizontal line. The central square hole is also divided into four quadrants. The domain is labeled with 'a' and 'b' dimensions.

11 - Can be cultivated safely with intensive treatments. Flowers in the 17 to 19 inch and the 18 to 17 inch precipitation zones.

1V - Suited for limited cultivation but must be handled with extreme care. Primarily sloping, thin or sandy soils in the 17 to 19 inch and the 15 to 17 inch precipitation zones. Includes the best land suited for cultivation in the 13 to 15 inch zone.

111

V. Saturated for grazing
with slight or no
floodings. Bed of
intermittent lakes.

NOT SUITABLE FOR CULTIVATION

— 22 —

VI - Subject for discussion
with another limitation
This article on moderately
wired program.

--	--	--	--	--

Vill. suited for grazing with minor limitations. Sheep, wooded, shallow, very sandy, or rough broken land. Needs extreme care.

VIII. Not suited for
cultivation or grazing.
Harrison lake beds, and
riverbank along stream.



STONEHAM SERIES

The Stoneham series consists of well-drained, medium-depth, medium-textured upland soils which are forming on limy, loamy water-lain deposits. Lime occurs within a few inches of the surface. These soils are underlain by outwash sand, silt and clays or by shales at depths below 3 feet.

The Stoneham soils are highly susceptible to wind and water erosion.

SOIL PROFILE:

Mapping Units

Symbol

- 94 (Field Sheet)
- 11 (Published Map)

Generalized Description

Medium-depth, loamy upland soils, with loam surface soils, loam and clay loam subsoils underlain by a limy loamy, water-lain material which grades into gravel with depth.
Occupying

- 93 (Field Sheet)

Medium-depth, upland soils, with sandy loam surface soils and loam subsoils underlain by limy, loamy water-lain materials which grade into sand and gravel at depths of 36 inches.
Occupying

- 94-66 (Field Sheet)

This is an association of two medium depth upland soils—One, a loamy soil underlain by limy, loamy water-lain materials and the other, a clay loam soil developing from shale at depths of 11 - 36 inches.
Occupying

- (0 - 10) Nearly level to gently sloping upland areas with slopes of 0 - 10%.
- (3 - 5%) Sloping areas with 3 - 5% slope.
- (5 - 9%) Strongly sloping areas with 5 - 9% slope.
- (9 - 25%) Steep sloping areas with slopes of 9 - 25%.

United States Department of Agriculture



Natural Resources Conservation Service
138 So. 14th Street
Burlington, CO 80807

719-346-7699 ext.105
www.co.nrcs.usda.gov
kristi.gay@co.usda.gov

Inventory and Evaluation
Of Land, Water, and Related Resources

Date: 8/28/2013

Requested by: Todd Trobee on behalf of KCC Commissioners

Location Name: Ellis J. Walters/Beeson Pit___ Legal Description: N 1/2 21/10/45

Assisted by: Kristi Gay
District Conservationist

___ Individual ___ Group ___ x ___ Unit of Government

SITUATION:

The request is to formally apply to the state of Colorado to expand the existing pit to 19.9 acres. The most common grasses on this ecological site when in native vegetation are blue grama, side oats grama, and little bluestem. Buffalo grass may be present in small amounts along with miscellaneous forbs.

SUGGESTED SOLUTION:

Reclamation for the site when the pit is closed and permit is terminated. Topsoil will be stockpiled for use prior to being disturbed on acreage not previously mined. If needed, this stockpile area should be protected from wind erosion and noxious weeds should be managed, as needed. After mining is completed, the pit area should be smoothed to a 3:1 slope or flatter with the topsoil replaced on top. Drilling of grass is recommended between Nov. 15th-May 15th (dormant season). A straw mulch should then be spread over the site at the rate of one ton per acre to prevent wind erosion after grass seeding. Stabilizing blankets can be substituted for the straw mulch. A three wire fence should be constructed around the seeded site to allow revegetation without livestock disturbance until grass is established (approx. 3 years). Please see grass seeding recommendation sheet ECS-05 for recommended grass mixture and appropriate rates.

NOTE: Seed should be ordered and planted by PURE LIVE SEED pounds (PLS). The exact dimensions of the disturbed area will need to be measured to determine the correct amount of seed to apply when the area is reclaimed.

Participant:

USDA-NRCS District Conservationist:

Date:

Date: 8/28/13

Approved by Burlington Conservation District:

Date: 9-3-13

Helping People Help the Land

An Equal Opportunity Provider and Employer

Exhibit K

This area is often subject to high intensity rain storms with hot, dry periods between these storms.

Exhibit L

N/A This is a County Pit.

Exhibit M

There are no other permits or licenses required.

Water Quality Control Division was contacted and said that counties and municipalities with a population of under 100,000 are exempt from permits in regards to gravel mining.

Air pollution control Division had also been contacted. They have approved grouped APENs by district. All gravel pits in the county will be included in one of 3 APENs specifically for gravel pits.

Exhibit N

August 2013

Kit Carson County

Po Box 160
Burlington co 80807

Re: Amendment to Gravel Pit M-82-186

We Elsie J Walters Trust, do grant Kit Carson County the right to amend the acreage at SE NW S21-T10-R45W for the purpose of expanding the current gravel pit to obtain gravel and eventual reclamation.

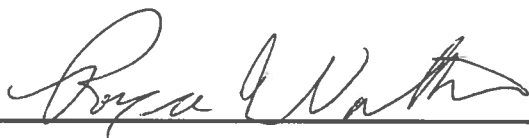

Elsie J Walters Trust.

STATE OF Colorado

COUNTY OF Kit Carson

The forgoing instrument was acknowledged before me this 30 day of Aug, 2013.

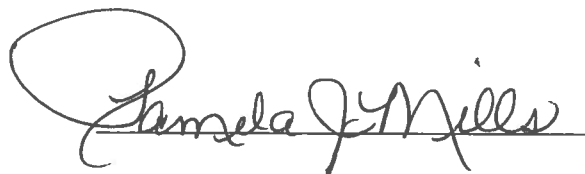
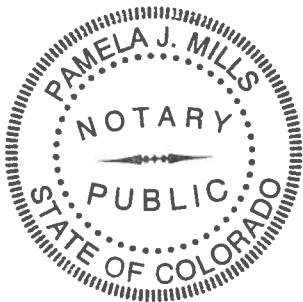

NOTARY PUBLIC

My commission expires: 07/07/2014

Exhibit 0

EXHIBIT A - SE OF THE NW 1/4 * SECTION 33 * TOWNSHIP 11S * RANGE 51W

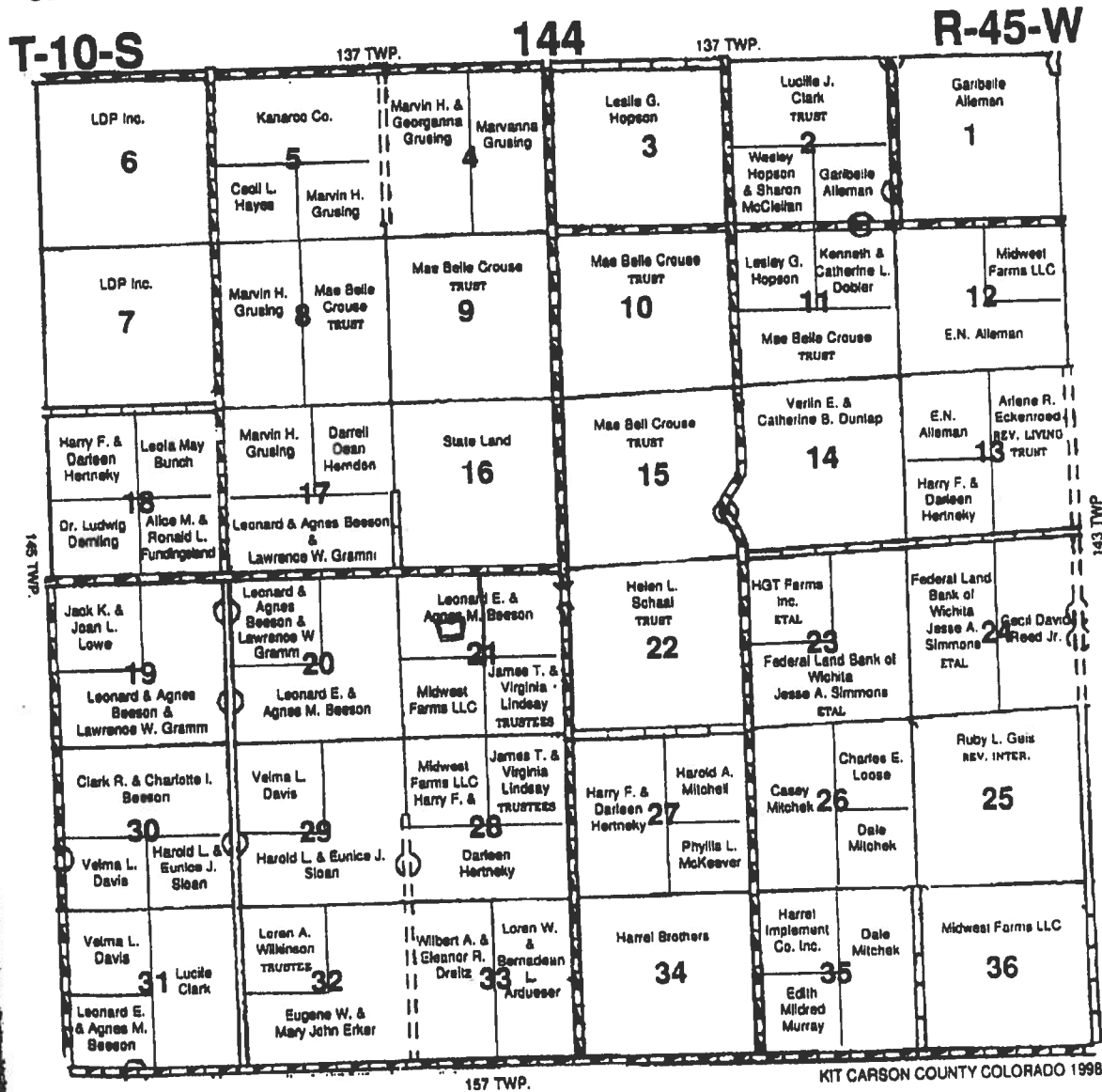

Exhibit P

There are no municipalities within a two- mile radius.

Ex Q

KIT CARSON COUNTY COMMISSIONERS

MINUTES
MAY 22, 2013

8:00 A.M. WORK SESSION FOR COMMISSIONERS
8:00 A.M. REVIEW AND APPROVE PAYABLES
8:30 A.M. ADMIN SIDE ITEMS
9:00 A.M. READ MINUTES
9:30 A.M. REVIEW CONSENT AGENDA FOR APPROVAL
10:30 A.M. MEET WITH KEY PLAYERS FOR INTRODUCTION OF NEW
EMERGENCY MANAGER
12:00 P.M. LUNCH
5:00 P.M. MEETING TO ADJOURN WHEN BUSINESS IS COMPLETE

NEW ITEMS:

- DSL LINE WITH USA VS CENTURYLINK – KATRINA
- AMBULANCE BILL WRITE OFF REQUEST – EMPLOYEE

SIGNATURES:

- DOLA – ENERGY IMPACT GRANT CONTRACT
- BEESON GRAVEL PIT EXPANSION

OLD ITEMS:

- LAST CHANCE/DIRT
- CHANGE JOHN DERE INDUSTRIAL DEALERSHIP – TALK TO ZEB

FYI:

- PLANNING MEETING – TRI-STATE – ASKING FOR VARIANCE BOCC ATTENDANCE REQUESTED

Meeting called to order at 9:20 A.M. by Chairman Dave Hornung. Those present were Dave Hornung, Dave Gwyn, Gary Koop, Paula Weeks and Della Calhoon.

CONSENT AGENDA

MINUTES
PAYABLES

OTHER:

ENERGY IMPACT GRANT
GRAVEL PIT EXPANSION-Beeson
AMBULANCE BILL WRITE OFF
DSL LINE WITH USA
COMPUTERS FOR ELECTION AND LANDFILL
PURCHASE ORDER FOR PH VACCINE
SUMMER INTERN FOR CW

The Board of County Commissioners reviewed the consent agenda. Motion to approve the consent agenda was made by Dave Gwyn, seconded by Gary Koop, motion carried by unanimous vote of Dave Hornung.

Ex Q



Natural Resources Conservation Service
138 So. 14th Street
Burlington, CO 80807

719-346-7699 ext.105
www.co.nrcs.usda.gov
kristi.gay@co.usda.gov

Inventory and Evaluation Of Land, Water, and Related Resources

Date: 8/28/2013

Requested by: Todd Trobee on behalf of KCC Commissioners

Location Name: Ellis J. Walters/Beeson Pit ___ Legal Description: N 1/2 21/10/45

Assisted by: Kristi Gay
District Conservationist

___ Individual ___ Group ___x___ Unit of Government

SITUATION:

The request is to formally apply to the state of Colorado to expand the existing pit to 19.9 acres. The most common grasses on this ecological site when in native vegetation are blue grama, side oats grama, and little bluestem. Buffalo grass may be present in small amounts along with miscellaneous forbs.

SUGGESTED SOLUTION:

Reclamation for the site when the pit is closed and permit is terminated. Topsoil will be stockpiled for use prior to being disturbed on acreage not previously mined. If needed, this stockpile area should be protected from wind erosion and noxious weeds should be managed, as needed. After mining is completed, the pit area should be smoothed to a 3:1 slope or flatter with the topsoil replaced on top. Drilling of grass is recommended between Nov. 15th-May 15th (dormant season). A straw mulch should then be spread over the site at the rate of one ton per acre to prevent wind erosion after grass seeding. Stabilizing blankets can be substituted for the straw mulch. A three wire fence should be constructed around the seeded site to allow revegetation without livestock disturbance until grass is established (approx. 3 years). Please see grass seeding recommendation sheet ECS-05 for recommended-grass mixture and appropriate rates.

NOTE: Seed should be ordered and planted by PURE LIVE SEED pounds (PLS). The exact dimensions of the disturbed area will need to be measured to determine the correct amount of seed to apply when the area is reclaimed.

Participant: [Signature] Date: 9/19/13
USDA-NRCS District Conservationist: Kristi Gay Date: 8/28/13

Approved by Burlington Conservation District: [Signature] Date: 9-3-13

Helping People Help the Land

An Equal Opportunity Provider and Employer

Ex Q

Notice to the Board of County Commissioners
Kit Carson County, Colorado

Kit Carson County Road and Bridge has applied for an expansion to a (112) on an existing Construction Materials Limited Impact (110) Reclamation permit from the Colorado Mined Land Reclamation Board ("the Board") to conduct the extraction of construction materials in Kit Carson County. The expanded pit is the Beeson Pit, permit # M82-186 and is located in the SE ¼ of Section 21, T10S, R45W. The attached information is being provided to notify you of the location and nature of the proposed operation. The entire application is on file with the Division of Minerals and Geology (the "Division") and the local county clerk and recorder.

The applicant/operator proposed to reclaim the affected land for rangeland. Pursuant to Section 34-32.5-116 (4)(m), C.R. S. , the Board may confer with the local Board of County Commissioners before approving the post-mining land use. Accordingly, the Board would appreciate your comments on the proposed operation. Please note that, in order to preserve your right to a hearing before the Board on this application, you must submit written comments on the application within ten (10) days after the date of the applicant's newspaper publication.

If you would like to discuss the proposed post-mining land use, or any other issue regarding this application, please contact the Division of Minerals and Geology, 1313 Sherman Street, Room 215, Denver, Colorado 80203, (303) 866-3567.

Enclosure: Copy of Application

Received this ____ day of _____, 2013.

Acknowledging Receipt and signing on behalf of the Kit Carson County Commissioners

Sent by Certified Mail #7011 0470 0003 4516 0667 9/9/13

Ex R

251 16th St., Suite 201
Burlington, CO 80807
May 22, 2013

Della Calhoon
Kit Carson County Clerk and Recorder
Kit Carson County Courthouse
251 16th St, Suite 203
Burlington, CO 80807

Dear Della,

Kit Carson County Road and Bridge has applied for an expansion to a (112) on an existing Construction Materials Limited Impact (110) Reclamation permit from the Colorado Mined Land Reclamation Board ("the Board") to conduct the extraction of construction materials in Kit Carson County. The expanded pit is the Beeson Pit, permit # M82-186 and is located in the SE ¼ of Section 21, T10S, R45W. The attached information is being provided to notify you of the location and nature of the proposed operation. The entire application is provided at this location to be available for public inspection prior to public hearings at the Colorado Mined Land Reclamation Board concerning this permit request. Please make the copy available until the permit is finalized.

Thank you,

Sincerely,

Paula S. Weeks

Enclosure: Copy of Application

Received this 23rd day of May, 2013.



Acknowledging Receipt and signing on behalf of the Kit Carson County Clerk's Office

Exhibit S

There is a fence line owned by *Barcellos* within the 200 feet of the affected area. Compensation will be provided for any damages to the structure.

Barcellos

Land Owner.

John L. John Kit Carson County

Applicant.

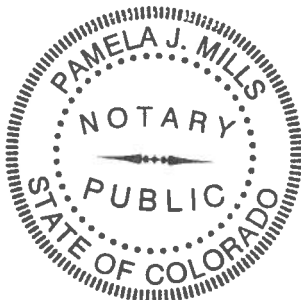

Pamela J. Mills
Pamela J. Mills
NOTARY PUBLIC

My commission expires: 07/07/2014

CERTIFICATION

The Applicant, Kit Carson County (print applicant/company name),
by David L Hornung (print representative's name), as Chairman (print
representative's title), does hereby certify that Elsie J Walters Trust (structure owner) shall
be compensated for any damage from the proposed mining operation to the above listed structure(s)
located on or within 200 feet of the proposed affected area described within Exhibit A, of the Reclamation
Permit Application for Beeson Pit (operation name),
File Number M-82 - 186.

*This form has been approved by the Colorado Mined Land Reclamation Board pursuant to its
authority under the Colorado Land Reclamation Act for the Extraction of Construction Materials and
the Colorado Mined Land Reclamation Act for Hard Rock, Metal, and Designated Mining Operations.
Any alteration or modification to this form shall result in voiding this form.*

NOTARY FOR PERMIT APPLICANT

ACKNOWLEDGED BY:

Applicant Kit Carson County Representative Name David L Hornung

Date May 22, 2013 Title BOCC Chairman

STATE OF Colorado)
) ss.
COUNTY OF Kit Carson)

The foregoing was acknowledged before me this 22 day of May, 2013, by
David L Hornung as Chairman of BOCC Kit Carson County

Paula S Weeks
Notary Public

My Commission Expires: Aug 20, 2016

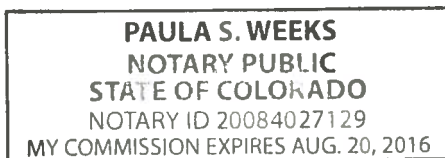

An example Structure Agreement which meets the requirements of the Statutes is shown below.

Structure Agreement

This letter has been provided to you as the owner of a structure on or within two hundred (200) feet of a proposed mine site. The State of Colorado, Division of Reclamation, Mining and Safety ("Division") requires that where a mining operation will adversely affect the stability of any significant, valuable and permanent man-made structure located within two hundred (200) feet of the affected land, the Applicant shall either:

- a) Provide a notarized agreement between the Applicant and the Person(s) having an interest in the structure, that the Applicant is to provide compensation for any damage to the structure; or
- b) Where such an agreement cannot be reached, the Applicant shall provide an appropriate engineering evaluation that demonstrates that such structure shall not be damaged by activities occurring at the mining operation; or
- c) Where such structure is a utility, the Applicant may supply a notarized letter, on utility letterhead, from the owner(s) of the utility that the mining and reclamation activities, as proposed, will have "no negative effect" on their utility. (*Construction Materials Rule 6.3.12 and Rule 6.4.19 & Hard Rock/Metal Mining Rule 6.3.12 and Rule 6.4.20*)

The Colorado Mined Land Reclamation Board ("Board") has determined that this form, if properly executed, represents an agreement that complies with Construction Materials Rule 6.3.12(a), Rule 6.4.19(a), and C.R.S. § 34-32.5-115(4)(e) and with Hard Rock/Metal Mining Rule 6.3.12(a), Rule 6.4.20(a), and C.R.S. § 34-32-115(4)(d). This form is for the sole purpose of ensuring compliance with the Rules and Regulations and shall not make the Board or Division a necessary party to any private civil lawsuit to enforce the terms of the agreement or create any enforcement obligations in the Board or the Division.

The following structures are located on or within 200 feet of the proposed affected area:

- There is a fence line south of the new proposed affected area.
- 1. _____
 - 2. _____
 - 3. _____
 - 4. _____
 - 5. _____

(Please list additional structures on a separate page)

NOTARY FOR STRUCTURE OWNER

ACKNOWLEDGED BY:

Structure Owner LEO, MARD AGNES PERSON Name ROYCE WALTERS

Date 6/19/13 Title PO Elsie J WALTERS Trust

STATE OF Colorado)

COUNTY OF Kit Carson) ss.

The foregoing was acknowledged before me this 19th day of June, 2013, by
Royce Walters as PO of Elsie J Walters Trust

Paula S. Weeks

Notary Public

My Commission Expires: August 20, 2016

