

Water Supply Reserve Account – Grant and Loan Program
Water Activity Summary Sheet
September 18, 2019
Agenda Item 9(j)

Applicant: Beaver Park Water Incorporated

Water Activity Name: Phase 3 - Upper Canal Lining Removal Replacement

Water Activity Purpose: Implementation: Agricultural, Nonconsumptive (Recreational) & Municipal & Industrial

County: Fremont

Drainage Basin: Arkansas

Water Source: Beaver Creek, Brush Hollow Creek & Brush Hollow Reservoir

Amount Requested/Source of Funds:

\$10,000	Arkansas Basin Account
<u>\$100,000</u>	<u>Statewide Account</u>
\$110,000	Total Grant Request

Matching Funds:

Basin Account Match (\$10,000) = 10% of Statewide Account request (meets 10% min.)
Applicant's cash & in-kind Match (\$45,000) = 45% of Statewide Account request (meets 10% min);
Total Match (Basin & Applicant Match of \$55,000 = 55% of Statewide Account request (meets 50% min).
(refer to *Funding Summary/Matching Funds* section)

Staff Recommendation:

Staff recommends approval of up to \$10,000 from the Arkansas Basin Account and \$100,000 from the Statewide account to help fund the project/study titled: Phase 3 – Upper Canal Lining Removal Replacement.

Water Activity Summary:

If funded, the objectives of this project are to: continue Phase 2 to remove failed concrete sections of the Beaver Park Water Inc's (BPWI) Upper Canal and replace them with new formed concrete. A total of 4,526 linear feet of canal side has been identified by the applicant as being in need of removal and replacement. Approximately 3,182 linear feet will have been removed and replaced at the end of Phase 2. The remaining 1,344 linear feet of damaged sections is being proposed for replacement in Phase 3.

This canal diverts water under the water rights owned by BPWI from Beaver Creek and supplies water to direct irrigation use for the shareholders of BPWI. The canal additionally delivers water to BPWI's Brush Hollow Reservoir for delivery to BPWI's Lower Canal for direct irrigation use and

delivers these waters into storage in Brush Hollow Reservoir for later irrigation use. The BPWI Upper Canal additionally delivers Beaver Creek waters to the Penrose Water District (PWD). The PWD has a direct water treatment plant intake from the BPWI Upper Canal and diverts and treats these waters daily to supply its domestic and municipal customers.

The total estimated water efficiency savings from this proposed water activity is 1,100 acre-feet or 275 acre-feet per year. The applicant states the efficiency savings will be used to increase the availability of water supplies to the BPWI, the dependability of water deliveries to the PWD and increase typical storage levels in Brush Hollow Reservoir to the benefit of both the BPWI and wildlife, recreation and fishery interests of the Colorado Parks & Wildlife.

Discussion: The removal and replacement of the canal lining supports Chapter 10 Measurable Objective D: Agriculture Goal in the Colorado Water Plan; *“Maintain Agricultural Viability: Maintain agricultural productivity, support of rural economies and food security”*. By reducing the ditch canal seepage losses, this project helps fulfill the Critical Action: *Support Agricultural Conservation and Efficiency: make it more efficient, resilient and able to reduce water consumption without impacting agricultural productivity*.

Issues/Additional Needs: No issues or additional needs have been identified.

Eligibility Requirements: The application meets requirements of the three subsections of the Eligibility Requirements: General Eligibility, Entity Eligibility, and Water Activity Eligibility.

Eligibility Based on Funding Match Requirements:

The application meets the Statewide Account Matching requirements.

Evaluation Criteria:

This activity has undergone review and evaluation and staff has determined that it satisfies the Evaluation Criteria. Please refer to WSRF Application for applicant’s detailed response.

<u>Funding Source</u>	<u>Cash</u>	<u>In-kind</u>	<u>Total</u>
Beaver Park Water Inc.	\$25,000	\$10,000	\$35,000
Beaver Park Mutual Capital Account	\$5,000	\$0	\$5,000
Penrose Water District	\$5,000	\$0	\$5,000
Sub-total	\$35,000	\$10,000	\$45,000
WSRF Arkansas Basin Account	\$10,000	n/a	\$10,000
WSRF Statewide Account	\$100,000	n/a	\$100,000
Total Project Costs	\$145,000	\$10,000	\$155,000

CWCB Project Manager: Ben Wade

Arkansas Basin Roundtable

July 22, 2019

Via Electronic Mail: ben.wade@state.co.us

Mr. Ben Wade
Colorado Water Conservation Board
1313 Sherman Street, Room 721
Denver, CO 80203

Re: Water Supply Reserve Fund Grant Application: Beaver Park Water Inc.- Upper Canal Lining Removal and Replacement

Dear Ben:

At its July 17, 2019 meeting, the Arkansas Basin Roundtable (ABRT) approved the Beaver Park Water Inc.- Upper Canal Lining Removal and Replacement project grant application for \$10,000 in Basin Funds and \$100,000 in Statewide Funds.

The applicant is providing \$45,000 in matching funds. There were no dissenting opinions expressed in the consensus decision. Regarding the Colorado Water Plan, this project directly supports Objective A., Supply Demand Gap: *Reduces canal losses by approximately 1,100 acre-feet per year which benefits both ag and muni supplies.* In addition, this project meets several goals identified in the Arkansas Basin Implementation Plan including: Provide additional supplies for municipal use in drought years and continuing to sustain an agricultural economy in the Basin by making more efficient use of existing supplies.

This work will complete Phase III of the project and will close out the work to reline the Beaver Park Canal adding multiple benefits to the Penrose area. The ABRT approved supporting this application by consensus and there were no dissenting views.

Should you have any questions or concerns, please feel free to contact me either by telephone, 719-668-8028, or by email, mshea@csu.org.

With warm regards,



Mark Shea
Chair

Copy via email: Applicant; Mr. Ben Wade; ABRT Executive Committee



Last Update: July 23, 2019

Colorado Water Conservation Board

Water Supply Reserve Fund Grant Application

Instructions

All WSRF grant applications shall conform to the current [2016 WSRF Criteria and Guidelines](#).

To receive funding from the WSRF, a proposed water activity must be approved by a Roundtable(s) **AND** the Colorado Water Conservation Board (CWCB). The process for Roundtable consideration and recommendation is outlined in the 2016 WSRF Criteria and Guidelines. The CWCB meets bimonthly according to the schedule on page 2 of this application.

If you have questions, please contact the current CWCB staff Roundtable liaison:

Arkansas

Ben Wade
ben.wade@state.co.us
303-866-3441 x3238

Gunnison | North Platte | South Platte | Yampa/White

Craig Godbout
craig.godbout@state.co.us
303-866-3441 x3210

Colorado | Metro | Rio Grande | Southwest

Megan Holcomb
megan.holcomb@state.co.us
303-866-3441 x3222

WSRF Submittal Checklist (Required)

X	I acknowledge this request for funding was recommended for CWCB approval by the sponsoring Basin Roundtable(s).
X	I acknowledge I have read and understand the 2016 WSRF Criteria and Guidelines .
X	I acknowledge the Grantee will be able to contract with CWCB using the Standard Contract . ⁽¹⁾
Exhibit A	
X	Statement of Work ⁽²⁾ (Word – see Exhibit A Template)
X	Budget & Schedule ⁽²⁾ (Excel Spreadsheet – see Exhibit A Template)
	Letters of Matching and/or Pending 3 rd Party Commitments ⁽²⁾
Exhibit C	
X	Map ⁽²⁾ – Previously submitted with Phase I & II status reports and initial WSRA application.
X	Photos/Drawings/Reports – Previously submittal with Phase I & II status reports.
X	Letters of Support
	Certificate of Insurance ⁽³⁾ (General, Auto, & Workers' Comp.)
Contracting Documents	
	Certificate of Good Standing ⁽³⁾
	W-9 ⁽³⁾
	Independent Contractor Form ⁽³⁾ (If applicant is individual, not company/organization)
	Electronic Funds Transfer (ETF) Form ⁽³⁾

(1) Click "Grant Agreements". For reference only/do not fill out or submit/required for contracting

(2) Required with application if applicable.

(3) Required for contracting. While optional at the time of this application, submission can expedite contracting upon CWCB Board approval.



Last Update: July 23, 2019

Schedule		
CWCB Meeting	Application Submittal Dates	Type of Request
January	December 1	Basin Account; BIP
March	February 1	Basin/Statewide Account; BIP
May	April 1	Basin Account; BIP
July	June 1	Basin Account; BIP
September	August 1	Basin/Statewide Account; BIP
November	October 1	Basin Account/BIP

Desired Timeline	
Desired CWCB Hearing Month:	September 2019
Desired Notice to Proceed Date:	December 1, 2019

Water Activity Summary		
Name of Applicant	Beaver Park Water Incorporated ("Beaver Park")	
Name of Water Activity	Beaver Park Water Inc.- Upper Canal Lining Removal and Replacement	
Approving Roundtable(s)		Basin Account Request(s) ⁽¹⁾
Arkansas Basin Roundtable		\$ 10,000
Basin Account Request Subtotal		\$ 10,000
Statewide Account Request ⁽¹⁾		\$ 100,000
Total WSRF Funds Requested (Basin & Statewide)		\$ 110,000
Total Project Costs		\$ 155,000

(1) Please indicate the amount recommended for approval by the Roundtable(s)



Last Update: July 23, 2019

Grantee and Applicant Information	
Name of Grantee(s)	Beaver Park Water Incorporated
Mailing Address	P.O. Box 286, Penrose CO 81252
FEIN	84-0721934
Grantee's Organization Contact ⁽¹⁾	Gary Ratkovich
Position/Title	Beaver Park Water Inc. Board President
Email	ratkovich@bresnan.net
Phone	719-429-6762
Grant Management Contact ⁽²⁾	Dawn Daniels
Position/Title	Office Manager, Beaver Park
Email	ddaniels@beaverpark.water.net
Phone	719-372-3664 (office)
Name of Applicant (if different than grantee)	
Mailing Address	
Position/Title	
Email	
Phone	

(1) Person with signatory authority

(2) Person responsible for creating reimbursement invoices (Invoice for Services) and corresponding with CWCB staff.

Description of Grantee
Provide a brief description of the grantee's organization (100 words or less).
<p>The Beaver Park Water Inc. (BPWI) is a mutual ditch company. The company owns water rights decreed to be diverted from Beaver Creek and Brush Hollow Creek in Fremont County, Colorado. The water diverted is used for direct irrigation and domestic uses as well as stored for these same uses.</p> <p>BPWI has approximately 575 shareholders with approximately 2,000 acres being irrigated under the BPWI water system. BPWI is additionally the principal water supplier to the Penrose Water District (PWD). PWD serves the domestic, municipal and commercial water needs of the Penrose, CO area.</p> <p>BPWI additionally owns Brush Hollow Reservoir. This reservoir is an on-channel reservoir on Brush Hollow Creek and is principally supplied water from Beaver Creek by BPWI's Upper Canal. This reservoir is principally an irrigation water supply reservoir but additionally stores reserve water supplies for the PWD sourced from PWD's own pump and pipeline system from the Arkansas River. By contract between BPWI and the Colorado Parks & Wildlife, Brush Hollow Reservoir also serves as a fish, wildlife and public recreational water supply by means of a minimum pool reservation.</p>



Last Update: July 23, 2019

Type of Eligible Entity (check one)	
	Public (Government): municipalities, enterprises, counties, and State of Colorado agencies. Federal agencies are encouraged to work with local entities. Federal agencies are eligible, but only if they can make a compelling case for why a local partner cannot be the grant recipient.
	Public (Districts): authorities, Title 32/special districts (conservancy, conservation, and irrigation districts), and water activity enterprises
X	Private Incorporated: mutual ditch companies, homeowners associations, corporations
	Private Individuals, Partnerships, and Sole Proprietors: are eligible for funding from the Basin Accounts but not for funding from the Statewide Account.
	Non-governmental organizations: broadly, any organization that is not part of the government
	Covered Entity: as defined in Section 37-60-126 Colorado Revised Statutes

Type of Water Activity (check one)	
	Study
	Implementation

Category of Water Activity (check all that apply)		
	Nonconsumptive (Environmental)	
X	Nonconsumptive (Recreational)	
X	Agricultural	
X	Municipal/Industrial	
	Needs Assessment	
	Education & Outreach	
	Other	Explain:

Location of Water Activity	
Please provide the general county and coordinates of the proposed activity below in decimal degrees . The Applicant shall also provide, in Exhibit C, a site map if applicable.	
County/Countries	Fremont County
Latitude	N 38° 27.1'
Longitude	W 105° 1.1'



Last Update: July 23, 2019

Water Activity Overview

Please provide a summary of the proposed water activity (200 words or less). Include a description of the activity and what the WSRF funding will be used for specifically (e.g. studies, permitting, construction). Provide a description of the water supply source to be utilized or the water body affected by the activity. Include details such as acres under irrigation, types of crops irrigated, number of residential and commercial taps, length of ditch improvements, length of pipe installed, area of habitat improvements. If this project addresses multiple purposes or spans multiple basins, please explain. The Applicant shall also provide, in Exhibit A, a detailed Statement of Work, Budget, and Schedule.

This project involves the removal and replacement of sections of damaged Beaver Park Upper Canal concrete lining. Due to its use year-round in delivering water for direct irrigation use during the irrigation season and reservoir storage deliveries during the winter season, the Beaver Park Upper Canal has suffered damage and failure to sections of its concrete lining. This damage has caused increased transit losses of water and erosion of soil material. It is thought that freezing and thawing of these seepage waters have also contributed to the failure of the canal sides.

The proposed water activity is to remove the failed concrete sections and replace them with new formed concrete. A total of 4,526 linear feet of this canal lining has been identified as needing removal and replacement. This amount of replacement is planned to be accomplished, pending funding, over a four-year period (2017-2018, 2018-2019, 2019-2020, 2020-2021).

The total estimated water efficiency savings from this proposed water activity is 1,100 acre-feet/year. These water efficiency savings will be used to increase the availability of irrigation water supplies to the Beaver Park shareholders, the dependability of water deliveries to the PWD and increase typical storage levels in Brush Hollow Reservoir for additional recreational and wildlife purposes.

Measurable Results

To catalog measurable results achieved with WSRF funds please provide any of the following values.

	New Storage Created (acre-feet)
	New Annual Water Supplies Developed or Conserved (acre-feet), Consumptive or Nonconsumptive
4,185.62	Existing Storage Preserved or Enhanced (acre-feet)
	Length of Stream Restored or Protected (linear feet)
1,100 acre-feet per year	Efficiency Savings (indicate acre-feet/year OR dollars/year)
	Area of Restored or Preserved Habitat (acres)
4,526 feet of canal	Length of Pipe/Canal Built or Improved



Last Update: July 23, 2019

Water Activity Justification

Provide a description of how this water activity supports the goals of [Colorado's Water Plan](#), the most recent [Statewide Water Supply Initiative](#), and the respective [Roundtable Basin Implementation Plan and Education Action Plan](#) ⁽¹⁾. The Applicant is required to reference specific needs, goals, themes, or Identified Projects and Processes (IPPs), including citations (e.g. document, chapters, sections, or page numbers).

For applications that include a request for funds from the Statewide Account, the proposed water activity shall be evaluated based upon how well the proposal conforms to Colorado's Water Plan criteria for state support (CWP, Section 9.4, pp. 9-43 to 9-44;) (Also listed pp. 4-5 in [2016 WSRF Criteria and Guidelines](#)).

The water activity addresses multiple needs or issues- *The proposed water activity will at least in part address the significant transit losses within the BPWI Upper Canal. The resulting benefit of water savings will benefit BPWI's shareholder irrigation interests, the PWD water supply interests by increasing dependability of BPWI deliveries and reducing the turbidity levels of these deliveries. The increased water savings will additionally result in greater amounts of water delivered to Brush Hollow Reservoir resulting in increased reservoir levels to this reservoir thus providing for greater wildlife, recreation and fishery benefits as sought by the Colorado Parks & Wildlife.*

Promote cooperation and collaboration among traditional consumptive and/or non-consumptive interests- *Support by the Colorado Parks & Wildlife in cooperation with the BPWI will result in a collaboration between the traditional BPWI irrigation consumptive water interest and the Colorado Parks & Wildlife non-consumptive interests at Brush Hollow Reservoir.*

Addresses the gap areas between available water supply and future need as identified in SWSI or a roundtable's basin-wide water needs assessment- *the proposed water activity is ultimately estimated to result in up to 1,100 acre-feet of efficiency savings per year. This water savings will result in a greater irrigation water supply to the historically water short BPWI irrigation system and will potentially during drought periods increase the dependability and quantity of water available from BPWI to the PWD.*

Funding from this Account will reduce the uncertainty that the water activity will be implemented- *due to existing expenses of operating a small mutual irrigation system, BPWI cannot solely fund the proposed water activity. The level and quantity of needed repairs to the principle water delivery component of BPWI's irrigation system is beyond BPWI's sole financial ability to fully repair.*

The water activity helps sustain agriculture & open space, or meets environmental or recreational needs- *One of the principle objectives of the BPWI board of directors is to maintain the irrigated rural atmosphere and environment of the Penrose area. Maintenance and repair of the BPWI irrigation system is paramount to this objective. Inability to maintain the functionality of this irrigation system would ultimately result in the drying up of the presently irrigated 2,000 acres of land, an inability to provide principle physical water supply to the PWD and the cessation of water storage in Brush Hollow Reservoir. Solely funding this water actively by BPWI would require a company share assessment beyond the agricultural economic ability of the shareholders to maintain. This cost increase would entail a negative future benefit of agricultural activities under the BPWI system thus eventually leading to a cessation of irrigation under this system. This would be counter to sustaining agriculture and the corresponding open spaces related to agriculture.*

(1) Access Basin Implementation Plans or Education Action Plans from Basin drop down menu.



Last Update: July 23, 2019

Matching Requirements: Basin Account Requests

Basin (only) Account grant requests require a 25% match (cash and/or in-kind) from the Applicant or 3rd party and shall be accompanied by a **letter of commitment** as described in the 2016 WSRF Criteria and Guidelines (submitted on the contributing entity's letterhead). Attach additional sheet if necessary.

Contributing Entity	Amount and Form of Match (note cash or in-kind)
Total Match	\$
If you requested a Waiver to the Basin Account matching requirements, indicate the percentage you wish waived.	

Matching Requirements: Statewide Account Requests

Statewide Account grant requests require a 50% match as described in the 2016 WSRF Criteria and Guidelines. A minimum of 10% match shall be from Basin Account funds (cash only). A minimum of 10% match shall be provided by the applicant or 3rd party (cash, in-kind, or combination). The remaining 30% of the required match may be provided from any other source (Basin, applicant, or 3rd party) and shall be accompanied by a **letter of commitment**. Attach additional sheet if necessary.

Contributing Entity	Amount and Form of Match (note cash or in-kind):
Beaver Park	\$25,000
Beaver Park Mutual Capital Account	\$5,000
Beaver Park In-Kind	\$10,000
Penrose Water District	\$5,000
Arkansas Basin Roundtable	\$10,000
Total Match	\$55,000
If you requested a Waiver to the Statewide Account matching, indicate % you wish waived. (Max 50% reduction of requirement).	



Last Update: July 23, 2019

Related Studies

Please provide a list of any related studies, including if the water activity is complimentary to or assists in the implementation of other CWCB programs.

This proposal is a continuation of a previously funded WSRF application. This project is complimentary to the CWCB's water conservation and irrigated agricultural programs.

Previous CWCB Grants

List all previous or current CWCB grants (including WSRF) awarded to both the Applicant and Grantee. Include: 1) Applicant name; 2) Water activity name; 3) Approving RT(s); 4) CWCB board meeting date; 5) Contract number or purchase order

Yes, this is a continuation of a previously awarded WSRF grant

- (1) Beaver Park Water Incorporated, (2) Beaver Park Water Incorporated - Upper Canal Lining Removal and Replacement Project (3) Arkansas Basin Roundtable (4) September 2017 (5) 2018-992.

Tax Payer Bill of Rights

The Tax Payer Bill of Rights (TABOR) may limit the amount of grant money an entity can receive. Please describe any relevant TABOR issues that may affect the applicant.

BPWI is a private mutual ditch company. BPWI is not affected by TABOR restrictions.



Last Update: July 23, 2019

Colorado Water Conservation Board	
Water Supply Reserve Fund	
<u>Exhibit A - Statement of Work</u>	
Date:	7/23/2019
Water Activity Name:	Beaver Park Water Incorporated - Upper Canal Lining Removal and Replacement
Grant Recipient:	Beaver Park Water Incorporated
Funding Source:	WSRF
Water Activity Overview and Objectives: (Please provide brief description of the proposed water activity (no more than 200 words). Include a description of the overall water activity and specifically what the WSRF funding will be used for.)	
<p>This project involves the removal and replacement of sections of damaged Beaver Park Upper Canal concrete lining. The proposed water activity is to remove the failed concrete sections and replace them with new formed concrete. A total of 4,526 linear feet of this canal lining has been identified as needing removal and replacement. This amount of replacement is planned to be accomplished, pending funding, over a four-year period (2017-2018, 2018-2019, 2019-2020, 2020-2021).</p> <p>During Phase I of this project, Beaver Park and its contractor were able to replace 1,556 feet of canal lining. Total cost for this Phase I work was \$155,500 (\$100/foot).</p> <p>During Phase II work to date of this project Beaver Park and its contractor were able to replace 1,306 feet of canal lining. Cost for this Phase II work to date has been \$98,800 (\$76/foot). Phase II work has expended 77% of current funding to date. Remaining Phase II funding is estimated to be sufficient to complete an additional 320 feet of canal lining.</p> <p>This application requests grant funds to complete Phase III work of this project. 1,344 feet of canal lining are estimated to remain to be replaced under Phase III of this project. It is estimated that the combination of remaining Phase II funds and this Phase III grant request will provide sufficient funds to complete the entire project. It is further estimated that completion of construction could take place this upcoming (2019-2020) winter season but may also require completion of construction during the (2020-2021) winter season. Contractor availability, winter weather conditions and Beaver Park's requirement for use of this canal are factors that affect the completion timing of this project. For these reasons this Phase III grant request is being made for the stated funds and for a two year period (2019-2020 & 2020-2021) for project completion.</p>	



Last Update: July 23, 2019

Tasks
Provide a detailed description of each task using the following format:
<u>Task 1 – Removal and Replacement of Concrete</u>
Description of Task: Task 1 is the primary task and includes all construction and implementation for this phase of the project. Task 1 will implement the removal and replacement of approximately 1,344 linear feet of the remaining damaged canal lining (of the initially scoped 4,526 linear feet of the total project). This task also includes the disposal and hauling of materials from the site.
Method/Procedure: <ul style="list-style-type: none">• Remove existing failed concrete canal lining on either the north or south half of the canal as appropriate.• Grade and prepare soil for installation of new concrete lining. Form and place new reinforced concrete canal half sections.• Import additional soil as necessary to fill any voids on the back side and top of new concreted lined sections. Place and compact this additional soil as appropriate to prevent infiltration of any surface waters behind new concreted canal sections. Grade and finish soils at new canal sections to proper grade for correct drainage.• Hauling and disposal of any materials
Grantee Deliverable: (Describe the deliverable the grantee expects from this task)
Grantee deliverables include the removal and replacement of damaged sections of the Beaver Park Upper Canal which includes a project total of approximately 4,526 linear feet with 1,344 feet of this amount being completed under the Phase III of this project.
CWCB Deliverable: (Describe the deliverable the grantee will provide CWCB documenting the completion of this task)
The deliverable the grantee will provide the CWCB will be any associated, photographic evidence of the work performed including before and after photographs and contractor invoices.



Last Update: July 23, 2019

Tasks
Provide a detailed description of each task using the following format:
<u>Task 2 – Engineering Inspection, Project Management and Final Reporting</u>
Description of Task: Staff Engineer will provide project management throughout the project process including: engineering inspections of construction preparation, installation, and finishing. The Staff Engineer will also provide a final report for the project.
Method/Procedure: <ul style="list-style-type: none">• Provide project management and engineering inspections throughout the project• Develop a final report and provide documentation of project completion (photos, maps, graphs)
Grantee Deliverable: (Describe the deliverable the grantee expects from this task)
Staff Engineer provides adequate oversight throughout the project timeline and provides a detailed final report.
CWCB Deliverable: (Describe the deliverable the grantee will provide CWCB documenting the completion of this task)
Final engineering report, documentation, and associated invoices.



Last Update: July 23, 2019

Tasks
Provide a detailed description of each task using the following format:
<u>Task 3 – Grant Management</u>
Description of Task: Beaver Park Administrative Staff will provide grant management as an in-kind match for the project duration.
Method/Procedure: <ul style="list-style-type: none">• Provide 6-month progress reports• Provide reimbursement documentation• Provide final deliverables (engineering report, invoicing, reimbursement documents)• Provide management of project deadlines and requirements
Grantee Deliverable: (Describe the deliverable the grantee expects from this task) Successful management of grant funds throughout the project including reporting and grant reimbursements
CWCB Deliverable: (Describe the deliverable the grantee will provide CWCB documenting the completion of this task) Successful delivery of progress reports and reimbursement documentation on time and in completion to CWCB Staff

Last Update: July 23, 2019



COLORADO

Colorado Water
Conservation Board

Department of Natural Resources

Colorado Water Conservation Board

Water Supply Reserve Fund

EXHIBIT B - BUDGET AND SCHEDULE - Direct & Indirect (Administrative) Costs

Date: July 23, 2019

Water Activity Name: Beaver Park Water Inc. - Upper Canal Lining Removal and Replacement (Phase III)

Grantee Name: Beaver Park Water Inc.

<u>Task No.</u> ⁽¹⁾	<u>Description</u>	<u>Start Date</u> ⁽²⁾	<u>End Date</u>	<u>Matching Funds</u> (cash & in-kind) ⁽³⁾	<u>WSRF Funds</u> (Basin & Statewide combined) ⁽³⁾	<u>Total</u>
<u>1</u>	Removal and Replacement	11/15/2019	11/15/2021	\$ 41,600	\$ 110,000	\$ 151,600
2	Engineering Inspection & Management	11/15/2019	11/15/2021	\$ 2,400	\$ -	\$ 2,400
3	Grant Management	11/15/2019	11/15/2021	\$ 1,000	\$ -	\$ 1,000
Total				\$45,000	\$110,000	\$155,000

(1) The single task that include costs for Grant Administration must provide a labor breakdown (see Indirect Costs tab below) where the total WSRF Grant contribution towards that task does not exceed 15% of the total WSRF Grant amount.

(2) Start Date for funding under \$100K - 45 Days from Board Approval; Start Date for funding over \$100K - 90 Days from Board Approval.

(3) Round values up to the nearest hundred dollars.

- Reimbursement eligibility commences upon the grantee's receipt of a Notice to Proceed (NTP)

- NTP will not be accepted as a start date. Project activities may commence as soon as the grantee enters contract and receives formal signed State Agreement.

The CWCB will pay the last 10% of the entire water activity budget when the Final Report is completed to the satisfaction of the CWCB staff project manager. Once the Final Report has been accepted, the final payment has been issued, the water activity and purchase order (PO) or contract will be closed without any further payment. Any entity that fails to complete a satisfactory Final Report and submit to the CWCB with 90 days of the expiration of the PO or contract may be denied consideration for future funding of any type from the CWCB.

- Additionally, the applicant shall provide a progress report every 6 months, beginning from the date of contract execution

- Standard contracting procedures dictate that the Expiration Date of the contract shall be 5 years from the Effective Date.

PENROSE WATER DISTRICT

340 Grant Street "1 Penrose, CO 81240
Phone (719) 372-3289 Fax (719) 372-9347

July 1, 2019

Mr. Gary Ratkovich-President
Beaver Park Water, Inc.
209 Broadway
PO Box 286
Penrose, CO 81240

Re: Assistance in Brush Hollow Supply Canal Repairs

Dear Mr. Ratkovich,

Beaver Park Water, Inc. has requested of Penrose Water District a show of support in your company's continued efforts to perform work necessary to repair damaged portions of the Brush Hollow Supply Canal. Penrose Water District supports that effort.

As you are aware, Penrose Water District receives most of its raw water supply by way of a lease through your company. The physical delivery of our leased water is highly dependent on the integrity of the Brush Hollow Supply Canal. Considering that, the Board of Directors of Penrose Water District not only supports your effort in concept, but has determined that it will also support the financial needs of the repairs by again offering a \$5,000.00 contribution to same.

As you are also aware, the two water companies, Beaver Park and Penrose Water, hold parallel accounts that are set aside for such projects and require consent of both boards to expend matching amounts to a particular project. In offering monetary support of your project, Penrose Water District has determined it appropriate for both companies to utilize \$5,000.00 each from our respective accounts.

Sincerely,



Charlotte Norman
Penrose Water District

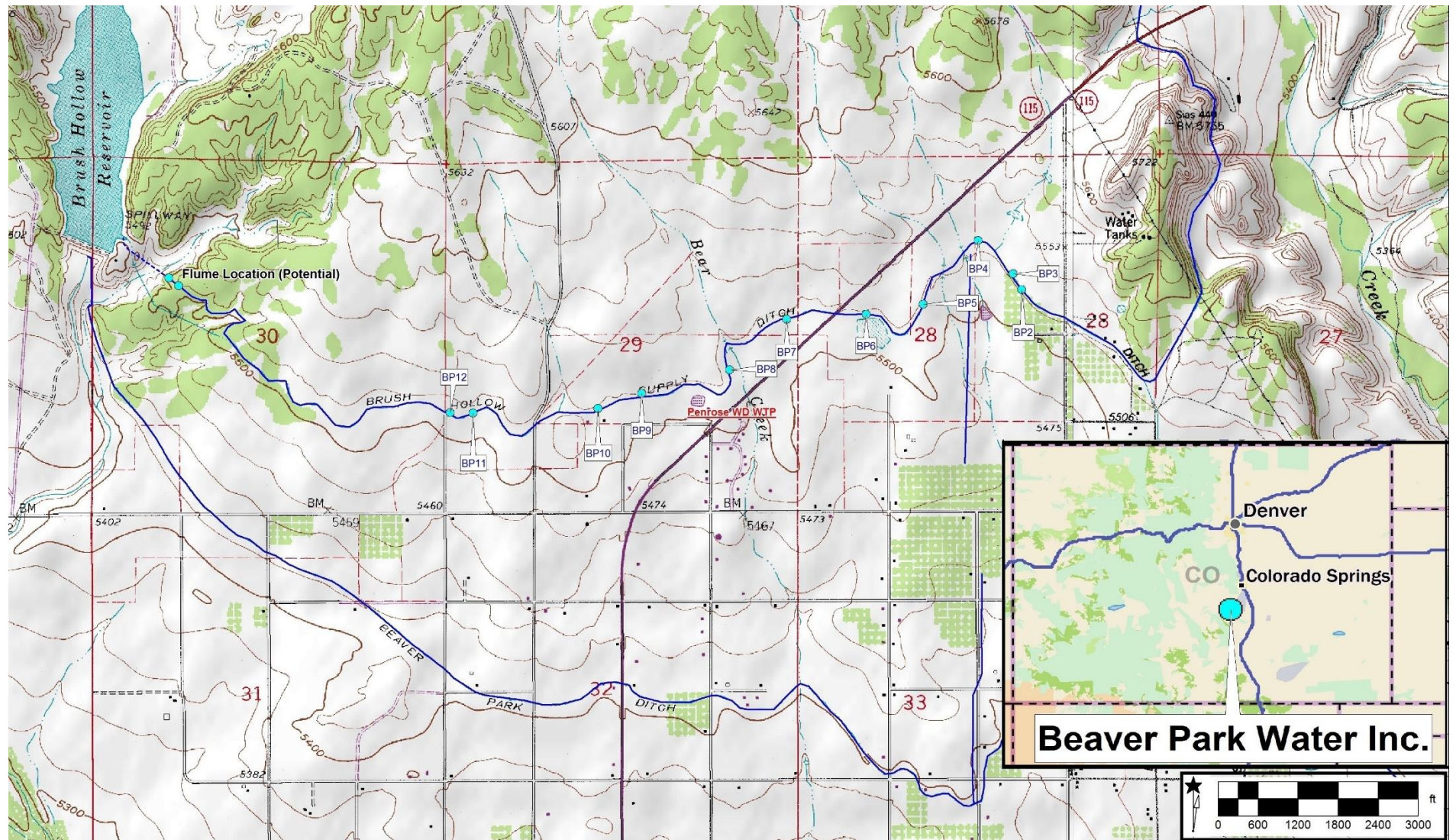

Beaver Park Water Inc. – Upper Canal Work Locations – Initially Scoped (2017).

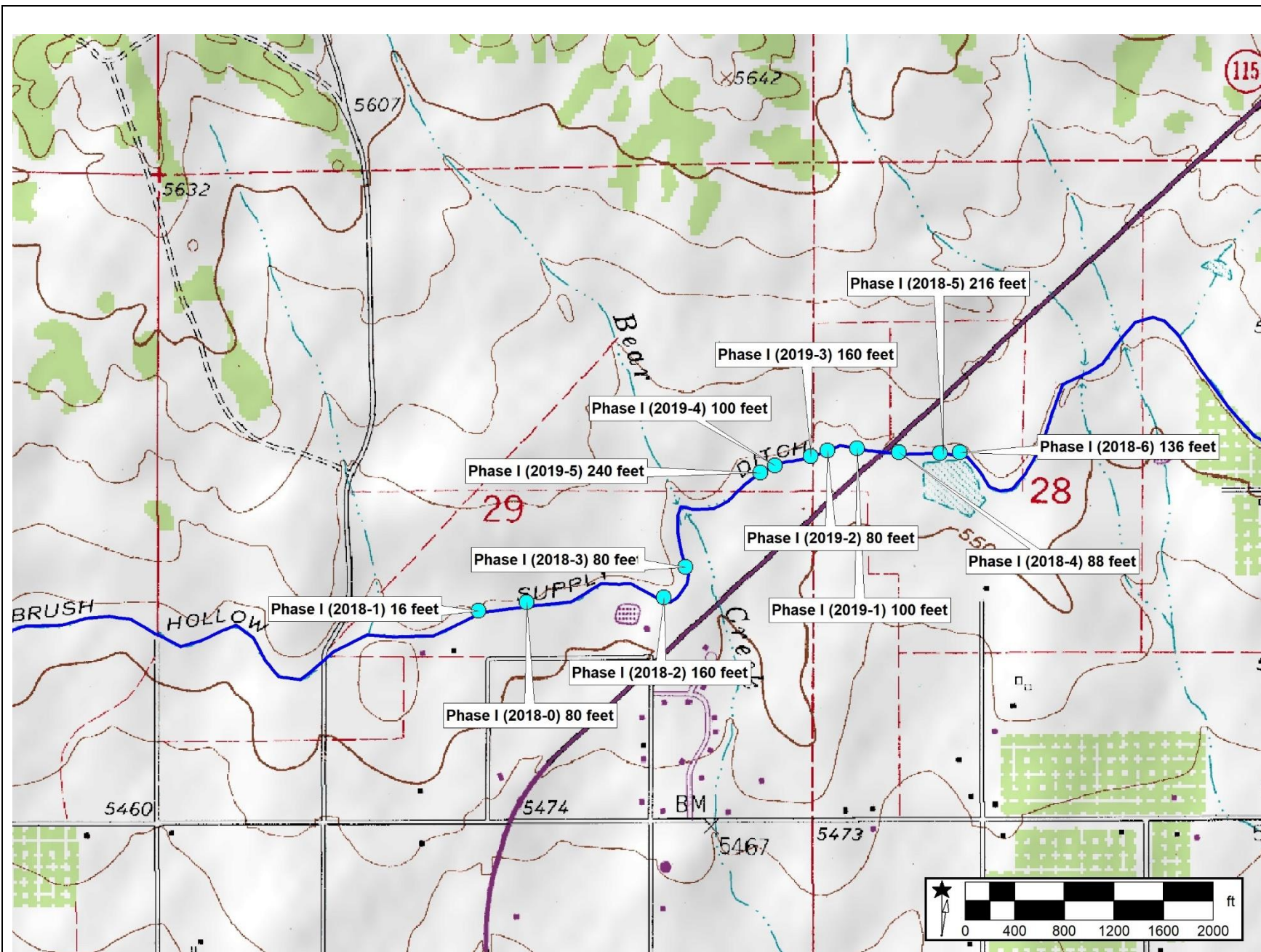

Beaver Park Water Inc. – Upper Canal Work Locations - Phase I (2017-2018).

