



Last Updated: July 2017

## Colorado Water Conservation Board

### Water Plan Grant Application

#### Instructions

To receive funding for a Water Plan Grant, applicant must demonstrate how the project, activity, or process (collectively referred to as “project”) funded by the CWCB will help meet the measurable objectives and critical actions in the Water Plan. Grant guidelines are available on the CWCB website.

If you have questions, please contact CWCB at (303) 866-3441 or email the following staff to assist you with applications in the following areas:

Supply and Demand Gap Projects: Gregory.Johnson@state.co.us

Water Storage Projects: Anna.Mauss@state.co.us

Conservation, Land Use Planning: Kevin.Reidy@state.co.us

Engagement & Innovation Activities: Mara.MacKillop@state.co.us

Agricultural Projects: Brent.Newman@state.co.us

Environmental & Recreation Projects: Linda.Bassi@state.co.us

Applicants interested in submitting an ‘Intent to Apply’ in the future are encouraged to check here ☐ and fill in all sections with the best information available at the time. Exhibits excluded.

This “Intent to Apply” will help CWCB prioritize Projects that are not ready for fully completed Water Plan Grant Application due to the initial timeframe and deadlines required.

#### Water Project Summary

Name of Applicant	St. Charles Mesa Water District	
Name of Water Project	Long-Term Potable Water Supply to the Zinno Subdivision	
CWP Grant Request Amount		\$75,000
Other Funding Sources <u>CWCB WSRA &amp; WE grants</u>		\$124,950
Other Funding Sources <u>Pueblo Cty, DOLA, USDA</u>		\$696,293
Applicant Funding Contribution <u>CWRPDA Loan</u>		\$284,343
Total Project Cost		\$1,180,587



Last Updated: July 2017

Applicant & Grantee Information	
Name of Grantee(s)	St. Charles Mesa Water District
Mailing Address	1397 Aspen Rd, Pueblo, CO 81006
FEIN	84-0530580
Organization Contact	David Simpson
Position/Title	General Manager
Email	David_Simpson@scmwd-pueblo.org
Phone	719-542-4380
Grant Management Contact	<u>Jean Van Pelt</u>
Position/Title	Grant Manager
Email	Jvp31@yahoo.com
Phone	719-251-2845
Name of Applicant (if different than grantee)	
Mailing Address	
Position/Title	
Email	
Phone	

Last Updated: July 2017

### Description of Grantee/Applicant

Provide a brief description of the grantee's organization (100 words or less).

The St. Charles Mesa Water District was formed in 1988, pursuant to the Special District Act for the purpose of providing a complete domestic water system for the District and its inhabitants. The District currently encompasses approximately 64 square miles located in east-central Pueblo County, adjacent to the eastern boundary of the City of Pueblo, and it serves a population of approximately 9,556 people.



Last Updated: July 2017

Type of Eligible Entity (check one)	
	<b>Public (Government):</b> Municipalities, enterprises, counties, and State of Colorado agencies. Federal agencies are encouraged to work with local entities. Federal agencies are eligible, but only if they can make a compelling case for why a local partner cannot be the grant recipient.
X	<b>Public (Districts):</b> Authorities, Title 32/special districts (conservancy, conservation, and irrigation districts), and water activity enterprises.
	<b>Private Incorporated:</b> Mutual ditch companies, homeowners associations, corporations.
	<b>Private Individuals, Partnerships, and Sole Proprietors:</b> Private parties may be eligible for funding.
	<b>Non-governmental organizations (NGO):</b> Organization that is not part of the government and is non-profit in nature.
	<b>Covered Entity:</b> As defined in <a href="#">Section 37-60-126 Colorado Revised Statutes</a> .

Type of Water Project (check all that apply)	
	Study
X	Construction
	Identified Projects and Processes (IPP)
	Other

Category of Water Project (check all that apply and include relevant tasks)	
X	Supply and Demand Gap Projects - Multi-beneficial projects and those projects identified in basin implementation plans to address the water supply and demand gap. <i>Applicable Exhibit A Task(s): Task 1 – 2.</i>
	Water Storage Projects - Projects that facilitate the development of additional storage, artificial recharge into aquifers, and dredging existing reservoirs to restore the reservoirs' full decreed storage capacity. <i>Applicable Exhibit A Task(s):</i>
	Conservation and Land Use Planning Projects - Activities and projects that implement long-term strategies for conservation, land use, and drought planning. <i>Applicable Exhibit A Task(s):</i>
	Engagement & Innovation Projects - Activities and projects that support water education, outreach, and innovation efforts. Please fill out the Supplemental Application available on the website. <i>Applicable Exhibit A Task(s):</i>
	Agricultural Projects - Projects that provide technical assistance and improve agricultural efficiency. <i>Applicable Exhibit A Task(s):</i>
	Environmental & Recreation Projects – Projects that promote watershed health, environmental health, and recreation. <i>Applicable Exhibit A Task(s):</i>



Last Updated: July 2017

	Other	Explain:
--	-------	----------

### Location of Water Project

Please provide the general county and coordinates of the proposed project below in **decimal degrees**. The Applicant shall also provide, in Exhibit C, a site map if applicable.

County/Counties	Pueblo
Latitude	
Longitude	

### Water Project Overview

Please provide a summary of the proposed water project (200 words or less). Include a description of the project and what the CWP Grant funding will be used for specifically (e.g., studies, permitting process, construction). Provide a description of the water supply source to be utilized or the water body affected by the project, where applicable. Include details such as acres under irrigation, types of crops irrigated, number of residential and commercial taps, length of ditch improvements, length of pipe installed, and area of habitat improvements, where applicable. If this project addresses multiple purposes or spans multiple basins, please explain.

The Applicant shall also provide, in Exhibit A, a detailed Statement of Work, Budget, Other Funding Sources/Amounts and Schedule.

The statement of work for this project is to annex the Zinno Subdivision (97 water taps) into the St. Charles Mesa Water District (SCMWD) service area and construct a new distribution system, service lines, and meters. The current sole source of water for the subdivision is a shallow 43 feet deep well. Due to poorly maintained infrastructure power outages, pump failures and main breaks the subdivision has experienced numerous interruptions in service. In addition, the residents have complained about the poor water quality coming from their tap which is considered by most to be undrinkable. Due to the precarious nature of the water service, the residents of the Zinno Subdivision are actively seeking a remedy, which would provide them with continuous, quality, potable water service and stable water rates. SCMWD is willing to assist by including them in their District boundaries and constructing new infrastructure to deliver a secure water supply. SCMWD will provide water to the subdivision using their water rights which include, Bessemer Ditch, Cottonwood Creek, Zoeller Creek, Velazquez Creek, Wells 1,6,8, & 10 and Fry-Ark Project Water rights.

### Measurable Results



Last Updated: July 2017

Measurable Results	
To catalog measurable results achieved with the CWP Grant funds, please provide any of the following values as applicable:	
	New Storage Created (acre-feet)
Conserved through implementation of SCMWD Conservation Plan = 76.6 AF	New Annual Water Supplies Developed or Conserved (acre-feet), Consumptive or Nonconsumptive
	Existing Storage Preserved or Enhanced (acre-feet)
	Length of Stream Restored or Protected (linear feet)
	Efficiency Savings (indicate acre-feet/year OR dollars/year)
	Area of Restored or Preserved Habitat (acres)
	Quantity of Water Shared through Alternative Transfer Mechanisms
	Number of Coloradans Impacted by Incorporating Water-Saving Actions into Land Use Planning
	Other Explain:

Water Project Justification
<p>Provide a description of how this water project supports the goals of <a href="#">Colorado's Water Plan</a>, the most recent <a href="#">Statewide Water Supply Initiative</a>, and the applicable Roundtable <a href="#">Basin Implementation Plan</a> and <a href="#">Education Action Plan</a>. The Applicant is required to reference specific needs, goals, themes, or Identified Projects and Processes (IPPs), including citations (e.g. document, chapters, sections, or page numbers).</p> <p>The proposed water project shall be evaluated based upon how well the proposal conforms to Colorado's Water Plan Framework for State of Colorado Support for a Water Project (CWP, Section 9.4, pp. 9-43 to 9-44;)</p>



Last Updated: July 2017

## Water Project Justification

### Colorado Water Plan:

**Section 1, pg 1-6 - Colorado Water Values.** This project supports 2 of the listed values:

- 1) A productive economy that supports vibrant and sustainable cities, viable and productive agriculture, and a robust skiing, recreation, and tourism industry;
- 2) Efficient and effective water infrastructure promoting smart land use;

**Section 3, pg 3-4 - Basin Challenges:** The Arkansas BIP identified the following issues which this project relates to:

- 1) Concerns over water quality include drinking water in the Lower Valley and the impact of fires and floods in the Fountain Creek watershed.
- 2) Rural areas within the Arkansas Basin have identified water needs, but face challenges in marshalling resources to identify and implement solutions. Support from the Roundtable and CWCB is needed.

**Section 3, pg 3-11** This project fits this identified need. "The remaining challenge is the development of sufficient infrastructure to deliver M&I water where it is needed."

**Section 6, pgs 6-21 & 6-67 & 6-79 – Arkansas Goals & Measurable Outcomes.** This project meets the goals and outcomes.

- 1) Meet the municipal supply gap in each county within the basin.
- 3) Support regional infrastructure development for cost-effective solutions to local water supply gaps.

**Section 6, pg 6-83 –** This project fulfills the Guiding Statement from County Commissioners "Every community can do better on water conservation and efficiency via locally determined measures, such as, but not limited to, reinvestment in aging infrastructure, community education, enhanced building codes, and watersensitive land-use planning."

**Section 6, pg 6-153 –** The needs of this project are identified in this section

- 1) New projects and methods will be critical to Colorado's ability to meet its water supply needs. However, existing infrastructure and currently operational projects and methods require maintenance and upkeep, which are equally important to bringing new methods online.
- 2) Every BIP includes goals to modernize water infrastructure or improve agricultural efficiencies. Through the BIP process, many basins also identified operations, maintenance, and improvements as part of their plan for future needs. In this manner, the basins are preparing for new projects and methods while maintaining the existing supply systems.

**Section 6 – pg 6-155 – BIP Project Support** This project has received CWCB support through their Water Efficiency and WSRF grant programs. Although, additional support is still needed.

"The CWCB will continue to support and assist the basin roundtables in moving forward the municipal, industrial, and agricultural projects and methods they identified in their BIPs. It will accomplish this through technical, financial, and facilitation support when a project proponent requests it."

**Section 8, pg 8-II IBCC Identified No-and-Low Regrets Goals** This project meets the following goals

- 2) Plan and preserve options for existing and new supply.
- 5) Have a high success rate for identified projects and processes.
- 6) Implement storage and other infrastructure.

**Section 9, pg 9-9 Colorado Water Plan Incorporates this Action Plan.** This project intends to utilize funding from a multitude of funding sources, which many of the funding sources are listed in the application and budget.

"Financing long-term, sustainable water supplies and infrastructure projects requires a collaborative effort involving water users and providers, as well as federal, state, and local entities."

**Section 9, pg 9-13 – Current Funding Opportunities** This project includes active participation of the subdivision residents. As the project's end users, the subdivision will pay off a CWRPDA Loan via a special surcharge.

"The State recognizes that water providers are in control of their own short- and long-term capital investments, operation and maintenance costs, and customer base. Therefore, use rates and tap fees could be the primary source of funding where the end user is directly connected with the costs and investments. When broader public interests are in play, there are opportunities to combine financial



Last Updated: July 2017

## Water Project Justification

resources and infrastructure in order to solve complex water supply challenges and accelerate the construction of a project. These sources include the CWCB Water Project Loan Program, the CWCB's WSRA Fund, the Species Conservation Trust Fund, Nonconsumptive funding programs as identified in SWSI 2010 Nonconsumptive Toolbox, and the Water Resources and Power Development Authority's Water Revenue Bond Program (WRBP). Although these programs cannot solely meet the state's financial water needs, they can assist in bridging funding gaps when combined with other funding sources."

**Section 9 pgs 43-44 – State Support for Projects Aligned with Colorado's Water Values.** This project meets the criterium of the State's Water Values in the following ways.

1) Does the project proponent demonstrate a **commitment to collaboration**? The project addresses the water gap and aging infrastructure needs identified in the CWP and the Ark BIP. It involves multiple funding partners & has partnered with local stakeholders, Pueblo County, and federal & state funding agencies.

2) Does the project proponent **address an identified water gap**? The project is included in the Ark BIP as an IPP and is identified as a method to meet the defined M&I gap need in a basin needs assessment. It is also identified as meeting a defined need identified in the SWSI & is part of the no- and low-regrets goals.

3) Does the project proponent **demonstrate sustainability**? SCMWD has an approved CWCB Water Conservation Plan which assists toward implementing the conservation best practices at the high customer participation levels, as defined in the SWSI. The project has no adverse effects to environmental and recreational interests. This project avoids impacts to water quality and will enhance the subdivision's water quality. This project will not cause economic and social impacts on agricultural and rural communities, it will in fact increase land value and resident's quality of life. The project will maximize the use of water resources through improving & modernizing aging infrastructure. The project has partnered with Pueblo County to incorporate best water use practices.

4) Does the project proponent establish the **fiscal and technical feasibility** of the project? This project demonstrates over-all cost-effectiveness, local investment, has the financial capability to repay debt, has collaborated to leverage state grants & a loan with local & federal funding, it has the technical and legal availability of water supplies for the project and is ready to proceed upon receipt of necessary funding and permits.

### State Water Supply Initiative

**Fact Sheet, pg 5.** This project is an identified IPP for the basin.

"IPPs are defined as projects and processes local water providers are counting on to meet future water supply needs. IPPs, if successfully implemented, have the ability to meet some, but not all of Colorado's 2050 M&I water needs. Implementation of these local projects and processes are critical to meeting Colorado's future water supply needs. Colorado faces a significant M&I water supply gap in 2050. The M&I gap is defined as the difference between the projected M&I water demands and supplies from existing sources and the supplies from the IPPs.

**Fact Sheet, pg 8 – SWSI 2010 Recommendations.** This project coincides with the SWSI recommendations list below.

2. Identify and utilize existing and new funding opportunities to assist in implementing projects and methods to meet Colorado's consumptive and non-consumptive water supply needs.

10. Support, encourage, and incentivize water providers in planning for and implementing M&I active conservation best management practices and other demand management strategies.

11. Work with water providers to identify opportunities where additional water could be made available by increased regional cooperation, storage, exchanges, and other creative opportunities.

14. Support local water supply planning.

### Arkansas Basin Implementation Plan

**Pg 6 –** This project is in accordance with the Ark BIP water values.

"The Basin Roundtables have discussed and developed statewide and basin-specific water values and





Last Updated: July 2017

### Water Project Justification

the Colorado Water Plan must incorporate the following:

- 1) A productive economy that supports vibrant and sustainable cities, viable and productive agriculture, and a robust skiing, recreation, and tourism industry;
- 2) Efficient and effective water infrastructure promoting smart land use; and,
- 3) A strong environment that includes healthy watersheds, rivers and streams, and wildlife.

**Pg 14 – Goals for the Arkansas Basin Implementation Plan.** This project meets 2 of the stated goals in the BIP.

- 1) Meet the municipal supply gap in each county within the basin
- 2) Support regional infrastructure development for cost-effective solutions to local water supply gaps

**Pg 208, 4.5.4. Summary and Challenges –** The summary explains basin-wide support for these types of M&I projects.

“Through regular dialogue since SWSI 2010, and particularly in the Portfolio Tool process conducted by all Basin Roundtables in 2012, the Arkansas Basin Roundtable has come to the realization that the timing for a municipal gap is right now..... Municipal projects and methods that attempt to address the immediacy of the civic supply gap will continue to be supported by the Arkansas Basin Roundtable.”

**Master Needs List, Pg 30 –** This project is identified as Project # Ark-2015-0540 and is defined as Aging infrastructure; replace aging infrastructure for agriculture and municipalities, engage qualified parties to develop plans, cost estimates & schedule in collaboration with stakeholders, develop & implement SOW.

#### **Ark Basin PEPO Education Action Plan** (Updated 2017)

**Pg 1 –** This project has benefitted from the EAP scope of work which has and continues to identify and educate others on the various sources and mechanisms that could potentially fund a water project.

“Funding from the EAP for 2017 will be used to provide assistance and sustainability for WSRA grant tasks as well as, provide education and outreach for the needs of 2017. The PEPO Workgroup feels that there should be a focus on funding and funding sources for 2017. As the Workgroup who is charged with providing education and outreach for our basin, we feel it is important to focus on the needs of identifying and educating our basin on additional funding sources and mechanisms. The Workgroup has decided to integrate this need into our already identified EAP tasks and provide education and outreach on this topic for 2017.”

### Related Studies

Please provide a list of any related studies, including if the water project is complementary to or assists in the implementation of other CWCB programs.



Last Updated: July 2017

### Related Studies

### Previous CWCB Grants, Loans or Other Funding

List all previous or current CWCB grants (including WSRF) awarded to both the Applicant and Grantee. Include: 1) Applicant name; 2) Water activity name; 3) Approving RT(s); 4) CWCB board meeting date; 5) Contract number or purchase order; 6) Percentage of other CWCB funding for your overall project.

Applicant Name	Water Activity Name	Approving RT	CWCB board meeting date	Contract or PO #	% of other CWCB funding for project
SCMWD	Long-Term Potable Water Supply to the Zinno Subdivision	Arkansas	May-16	PO 2016-01004	6%
SCMWD	Long-Term Potable Water Supply to the Zinno Subdivision	Arkansas	Sep-16	PO 2018-370	4%

### Taxpayer Bill of Rights

The Taxpayer Bill of Rights (TABOR) may limit the amount of grant money an entity can receive. Please describe any relevant TABOR issues that may affect your application.

The project will be implemented through SCMWD Enterprise Activity and has no TABOR implications.



Last Updated: July 2017

Submittal Checklist	
	I acknowledge the Grantee will be able to contract with CWCB using the <a href="#">Standard Contract</a> .
Exhibit A	
	Statement of Work <sup>(1)</sup>
	Budget & Schedule <sup>(1)</sup> ( <i>Spreadsheet</i> )
	Letters of Matching and/or Pending 3 <sup>rd</sup> Party Commitments <sup>(1)</sup>
Exhibit C	
	Map (if applicable) <sup>(1)</sup>
	Photos/Drawings/Reports
	Letters of Support (Support letter from Basin Roundtable encouraged)
	Certificate of Insurance (General, Auto, & Workers' Comp.) <sup>(2)</sup>
	Certificate of Good Standing with Colorado Secretary of State <sup>(2)</sup>
	W-9 <sup>(2)</sup>
	Independent Contractor Form <sup>(2)</sup> (If applicant is individual, not company/organization)
Engagement & Innovation Grant Applicants ONLY	
	Engagement & Innovation Supplemental Application <sup>(1)</sup>

(1) Required with application.

(2) Required for contracting. While optional at the time of this application, submission can expedite contracting upon CWCB Board approval.

Last Updated: July 5, 2017

Colorado Water Conservation Board	
Water Plan Grant - Exhibit A	

Statement Of Work	
<b>Date:</b>	September 29, 2017
<b>Name of Applicant:</b>	St. Charles Mesa Water District
<b>Name of Water Project:</b>	Long-Term Potable Water Supply to the Zinno Subdivision
<b>Funding Source:</b>	CWP Supply and Demand Gap Projects
<p><b>Water Project Overview:</b> Please provide a summary of the proposed water project (200 words or less). The same summary can be used from Page 5 of the CWP Grant Application.</p> <p>The scope of work for this project is to annex the Zinno Subdivision (97 water taps) into the St. Charles Mesa Water District (SCMWD) service area and construct a new distribution system, service lines, and meters. The current sole source of water for the subdivision is a shallow 43 feet deep well. Due to poorly maintained infrastructure power outages, pump failures and main breaks the subdivision has experienced numerous interruptions in service. In addition, the residents have complained about the poor water quality coming from their tap which is considered by most to be undrinkable. Due to the precarious nature of the water service, the residents of the Zinno Subdivision are actively seeking a remedy, which would provide them with continuous, quality, potable water service and stable water rates. SCMWD is willing to assist by including them in their District boundaries and constructing new infrastructure to deliver a secure water supply. SCMWD will provide water to the subdivision using their water rights which include, Bessemer Ditch, Cottonwood Creek, Zoeller Creek, Velazquez Creek, Wells 1,6,8, &amp; 10 and Fry-Ark Project Water rights.</p>	
<p><b>Objectives:</b> List the objectives of the project.</p> <p>There are three objectives in the proposed scope of work. They are as follows:</p> <ol style="list-style-type: none"> <li>1. Planning for the integration of the Zinno Subdivision into the St. Charles Mesa Water District.</li> <li>2. Construction Project to install water infrastructure to enable the Zinno Subdivision to receive potable water from St. Charles Mesa Water District.</li> <li>3. Provide project and grant management for the project.</li> </ol>	

Last Updated: July 5, 2017

Tasks
Provide a detailed description of each project task using the following format:
<b>Task 1 – 1. Planning for the integration of the Zinno Subdivision into the St. Charles Mesa Water District. (Task 1 is the only task to be paid by CWP funding.)</b>
Description of Task:
<ul style="list-style-type: none"> <li>A. Annexation of the Zinno Subdivision into the St. Charles Mesa Water District (SCMWD) service area.</li> <li>B. Colorado Department of Public Health and Environment (CDPHE) Approval</li> <li>C. Geotechnical Testing</li> <li>D. Surveying</li> <li>E. Construction Plans</li> <li>F. Contract Documents</li> </ul>
Method/Procedure:
<ul style="list-style-type: none"> <li>A. Annexation of the Zinno Subdivision into the St. Charles Mesa Water District (SCMWD) service area – The proposed service area is required to be annexed into the SCMWD in order to receive service. This will be conducted by SCMWD in cooperation with the Zinno Water Users Association and is currently in process.</li> <li>B. Colorado Department of Public Health and Environment (CDPHE) Approval – Submittal to the CDPHE is required, including the Preliminary Engineering Report and all construction documents and specifications. SCMWD will submit the necessary documents to CDPHE for approval.</li> <li>C. Geotechnical Testing – The final design of the proposed pavement section shall be based on the bearing capacity of the underlying soil, as determined by the geotechnical testing and Pueblo County requirements. SCMWD will be responsible for contracting for the geotechnical testing and for working with Pueblo County’s regulations.</li> <li>D. Surveying – A detailed Utility, Right-of-Way and Topographic Survey of the Existing Street shall be required. SCMWD will contract to have the surveys completed.</li> <li>E. Construction Plans – Detailed plans shall be required for the construction of the proposed potable water distribution system, and the proposed street reconstruction. SCMWD will be responsible for developing the construction of the new water distribution system. Pueblo County will provide the street construction plans and perform the work of reconstructing the streets.</li> <li>F. Contract Documents – Additionally, detailed contract documents and technical specifications shall be required. SCMWD will have the responsibility of securing all detailed contracts and specifications.</li> </ul>
Grantee Deliverable: Describe the deliverable the grantee expects from this task

Last Updated: July 5, 2017

Tasks
SCMWD will complete all pre-construction tasks.
CWCB Deliverable: Describe the deliverable the grantee will provide CWCB documenting the completion of this task
SCMWD will deliver to CWCB all supporting documents pertaining to CDPHE approval, Geotech testing, survey results, pertinent construction plans and contract documents.

Tasks
Provide a detailed description of each task using the following format:
<b>Task 2 – 2. Construction Project to install water infrastructure to enable the Zinno Subdivision to receive potable water from St. Charles Mesa Water District.</b>
Description of Task:
<ul style="list-style-type: none"> <li>A. SCMWD will contract construction surveying and traffic control contractors</li> <li>B. Pueblo County Road and Bridges Department will perform the demolition of existing streets.</li> <li>C. SCMWD will contract with contractors for the installation of the proposed potable water system.</li> <li>D. SCMWD will contract with contractors for the installation of proposed individual user taps and water meters.</li> <li>E. Pueblo County Road and Bridges crews will reconstruct the roadways.</li> <li>F. Partially fund the purchase of a TR-840 filter.</li> </ul>
Method/Procedure:



Last Updated: July 5, 2017

Tasks
<ul style="list-style-type: none"><li>A. SCMWD will contract with reputable and experienced construction surveying and traffic control contractors to successfully complete this task.</li><li>B. Pueblo County Road and Bridges Department will perform the demolition of existing streets. This may include roto-milling of existing roadway material for incorporation as base course for the proposed roadway.</li><li>C. SCMWD will contract with reliable and skilled contractors for the installation of the proposed potable water system. This includes approximately 600 lineal feet of 12-inch diameter pipe, C900 PVC Water Main, 4,278 lineal feet of 6-inch diameter pipe, C900 PVC Water main, 4 Proposed Fire Hydrant Assemblies and various appurtenant valves and fittings.</li><li>D. SCMWD will contract with reliable and skilled contractors for the installation of proposed individual user taps and water meters. This includes the installation of approximately 2,700 lineal feet of ¾-inch diameter type K Copper pipe, 100 Tap Saddle Assemblies, and 100 Badger BC 25 Radio-Read meters.</li><li>E. Pueblo County Road and Bridges crews will reconstruct the roadways.</li><li>F. Partially fund the purchase of a new TR-840 filter which will be installed at the water treatment plant in the near future.</li></ul>
Grantee Deliverable: Describe the deliverable the grantee expects from this task
The long-potable water supply to the Zinno Subdivision construction project will be completed and a secure water supply will be delivered to the residents. A new filter will be installed at the water treatment plant.
CWCB Deliverable: Describe the deliverable the grantee will provide CWCB documenting the completion of this task
SCMWD will deliver to CWCB all documents pertaining to Task 1 that the CWP grant supports.

Tasks
Provide a detailed description of each project task using the following format:
<b>Task 3 – Project and Grant Management</b>
Description of Task:



Last Updated: July 5, 2017

Tasks	
<p>SCMWD requires assistance to handle the management of documents for the construction project. SCMWD also requires an expert in grant management to be able to organize &amp; secure documentation for reimbursement from several different funding sources.</p>	
Method/Procedure:	
<ul style="list-style-type: none"><li>A. The project / grant manager will manage all pertinent pre-construction documents for the project (ie: to CDPHE approval, Geotech testing, survey results, pertinent construction plans and contract documents).</li><li>B. The project / grant manager will manage all pertinent construction documents (ie: Surveying and traffic control, installation of the proposed potable water system, installation of proposed individual user taps and water meters, and the purchase of a TR-840 filter).</li><li>C. The project / grant manager will be responsible to organize, develop and monitor all grant/loan reimbursements for the project.</li></ul>	
Grantee Deliverable: Describe the deliverable the grantee expects from this task	
<p>SCMWD will possess all contract documents, receipts for work performed, and requests for reimbursement from grants/loans.</p>	
CWCB Deliverable: Describe the deliverable the grantee will provide CWCB documenting the completion of this task	
<p>Project / grant manager will deliver all pertinent documents related to the tasks the CWP grant supports.</p>	

Budget and Schedule
<p>This Statement of Work shall be accompanied by a combined Budget and Schedule that reflects the Tasks identified in the Statement of Work and shall be submitted to CWCB in excel format.</p>



Last Updated: July 5, 2017

Reporting Requirements
<p><b>Progress Reports:</b> The applicant shall provide the CWCB a progress report every 6 months, beginning from the date of issuance of a purchase order, or the execution of a contract. The progress report shall describe the status of the tasks identified in the statement of work, including a description of any major issues that have occurred and any corrective action taken to address these issues. The CWCB may withhold reimbursement until satisfactory progress reports have been submitted.</p>
<p><b>Final Report:</b> At completion of the project, the applicant shall provide the CWCB a Final Report on the applicant's letterhead that:</p> <ul style="list-style-type: none"> <li>• Summarizes the project and how the project was completed.</li> <li>• Describes any obstacles encountered, and how these obstacles were overcome.</li> <li>• Confirms that all matching commitments have been fulfilled.</li> <li>• Includes photographs, summaries of meetings and engineering reports/designs.</li> </ul> <p>The CWCB will withhold disbursement the last 10% of the budget until the Final Report is completed to the satisfaction of CWCB staff. Once the Final Report has been accepted, and final payment has been issued, the purchase order or grant will be closed without any further payment.</p>

St. Charles Mesa Water District - Full Funding Budget

CWP Grant - Long-Term Potable Water Supply to the Zinno Subdivision														
Tasks	Schedule		Applicant Matching Funds					Other CWCB Funding Requests			WSRF Requests		Total	
	Start Date	End Date	Pueblo County	CWRDA Loan	DOLA Grant	USDA Grant		Water Efficiency Grant Approved May 2016 PO 2016-1004	WSRF - Approved March 2017 PO 2018-370	CWP - Supply & Demand Grant Application	Basin Funds	State Funds	Total Project	
1. Planning for the integration of the Zinno Subdivision into the St. Charles Mesa Water District.	1-Jun-18	30-Sep-18								\$ 75,000	0	\$ -	\$ 75,000	
2. Construction Project to install water infrastructure to enable the Zinno Subdivision to receive potable water from St. Charles Mesa Water District.	1-Oct-18	28-Feb-19	\$ 200,000	\$ 269,343	\$ 342,743	\$ 153,550		\$ 49,950	\$ 75,000		0	\$ -	\$ 1,090,586	
3. Project and Grant Management	1-Apr-18	30-Apr-19		\$ 15,000									\$ 15,000	
TOTAL			\$ 200,000	\$ 284,343	\$ 342,743	\$ 153,550		\$ 49,950	\$ 75,000	\$ 75,000	\$ -	\$ -	\$ 1,180,586	
% of Funding			17%	24%	29%	13%		4%	6%	6%				
										CWP Total Request		\$75,000		
										Applicant Match		\$ 980,636		



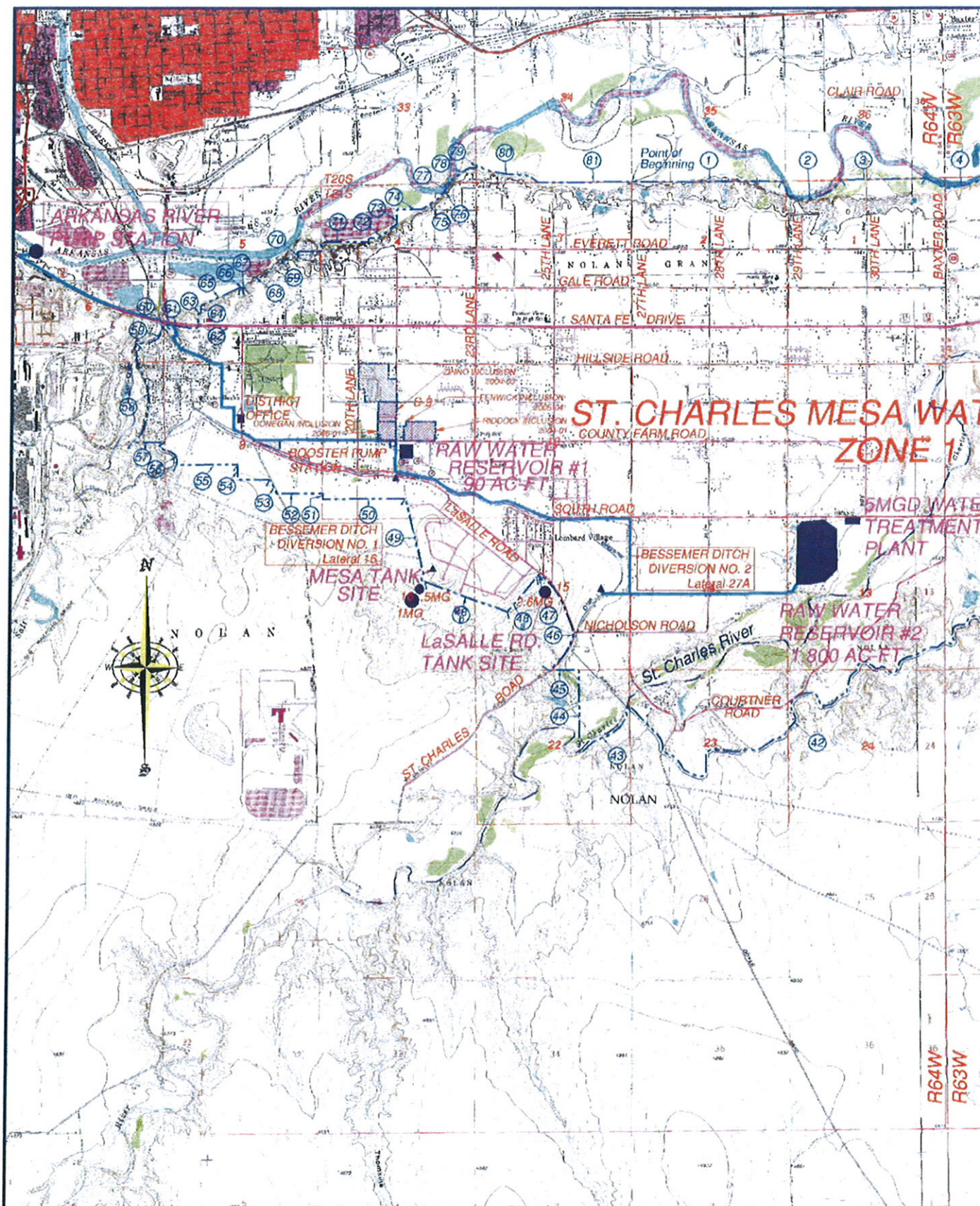

#### Computer File Information

Creation Date:	12/23/2009	Initials:	KAY
Last Modification Date:	5/27/2010	Initials:	KAY
Full Path:	C:\Work\SCM1\Overall DB Map 5272010		
Drawing File Name:	Plat1		
Acad Version:	2004	Scale:	1"=2000 Units:
			feet

**Young  
Technology  
Group**

Civil Engineering  
Planning & Development  
Construction Management  
Product Development

2,000 0 2,000  
Scale: 1"=2,000'



# Zinno Water Users Association

August 24, 2017

Greg Johnson  
Colorado Water Conservation Board  
1313 Sherman St., Room 721  
Denver, CO 80203

Dear Mr. Johnson,

On behalf of the Zinno Water Users Association I am writing in support of St. Charles Mesa Water District CWCB Colorado Water Plan grant application.

There are approximately 97 residences in Zinno Subdivision who, for years, have been receiving water from a small, private water provider. The residents have experienced power outages, pump failures and main breaks that have caused numerous interruptions in their water service provided. The interruptions in service are mostly due to aging infrastructure that has been neglected for many years. In addition, the residents have complained about poor water quality. The water has a foul taste and is considered by most to be undrinkable. Due to the precarious nature of this water service, the residents of the Zinno Subdivision are actively seeking a remedy, which would provide them with continuous, quality, potable water service and stable rates.

For years the Zinno Water Users Association have been exploring solutions to the problems experienced by the residents of the Subdivision with their water supply. Zinno Water Users Association supports efforts by the St. Charles Mesa Water District to include them in their District boundaries and to provide service to residents who desire to purchase water service from the District. Making water available from St. Charles Mesa Water District is the most sustainable solution for the residents of the Subdivision in securing a safe potable water supply at a reasonable price.

It is our understanding that St. Charles Mesa Water District will have to secure grants and loans to develop infrastructure and a water supply to serve the members of Zinno Water Users Association. This project is a priority for our Water Users Association because we understand the need and the value it will have to the residents in the Zinno Subdivision when the project is constructed. This project will reduce the health and safety concerns caused by a tenuous water supply and will provide the residents of the subdivision a safe and reliable water supply. This water supply will be dependable for many years to come and will not be subject to excessive water rate increases. We urge the CWCB board of directors and staff to strongly consider funding this valuable project.

Yours sincerely,



Daniel Molello  
President, Zinno Water Users Association